

NOTES CONTINUED:
 5. SCRIBE, ENGRAVE (A VIBRATORY TOOL MAY BE USED), LASER MARK OR MECHANICALLY STAMP (NO INKS OR DYES) DRAWING PART NUMBER, REVISION (AND VARIANT OR 'TYPE' IF APPLICABLE) ON NOTED SURFACE OF PART FOLLOWED ON THE NEXT LINE WITH A THREE DIGIT SERIAL NUMBER. SERIAL NUMBERS START AT 001 FOR THE FIRST ARTICLE AND PROCEED CONSECUTIVELY. USE MINIMUM 0.12" HIGH CHARACTERS, UNLESS THE SIZE OF THE PART DICTATES SMALLER CHARACTERS. EXAMPLE: DXXXXXX-VY, TYPE-XX, S/N XXX

- 6. ALL PARTS SHALL BE MANUFACTURED IN ACCORDANCE WITH LIGO SPECIFICATION E0900364.
- 7. ALL MATERIAL IS TO BE VIRGIN MATERIAL (i.e. NO WELD REPAIRS, PLUGS OR RECYCLED MATERIAL), NO REPAIRS SHALL BE MADE UNLESS APPROVED IN ADVANCE, AND IN WRITING, BY LIGO LABORATORY. REFER TO LIGO-E0900364.
- 8. SURFACE FINISH TO BE AS-PROCESSED FROM MILL/SUPPLIER, FREE FROM SCRATCHES OR GOUGES.

REV.	DATE	DCN #	DRAWING TREE #
v1	30 JUL 2015	E1500326-x0	-
-	-	-	-
-	-	-	-

AS VIEWED FROM FRONT OF SURFACE S1

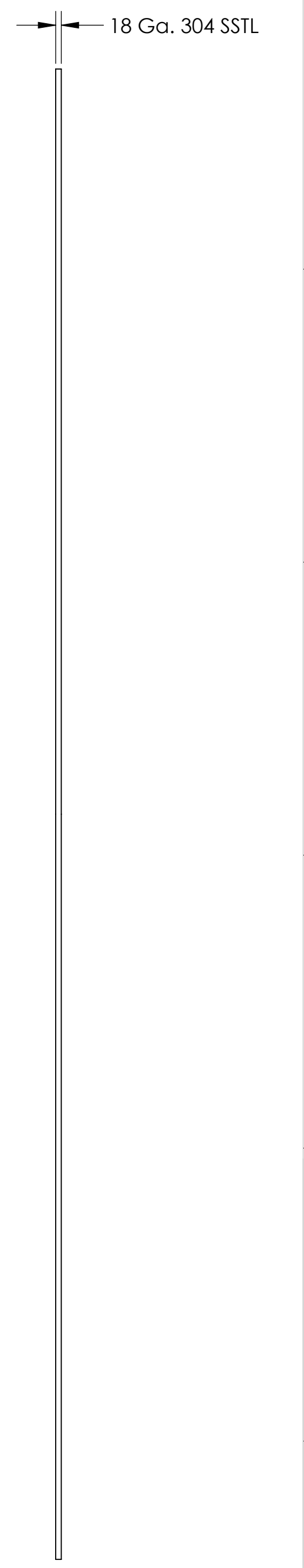
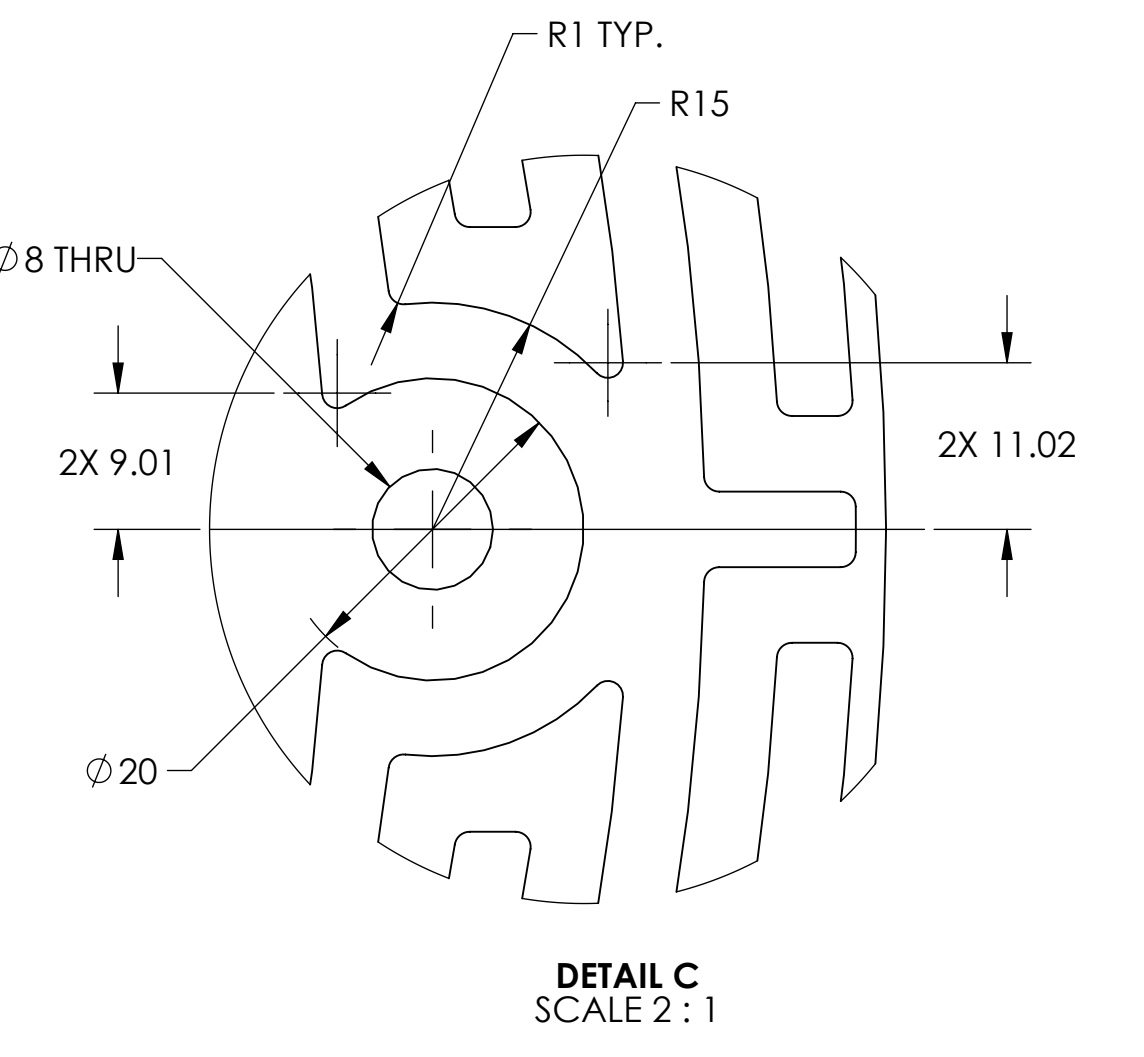
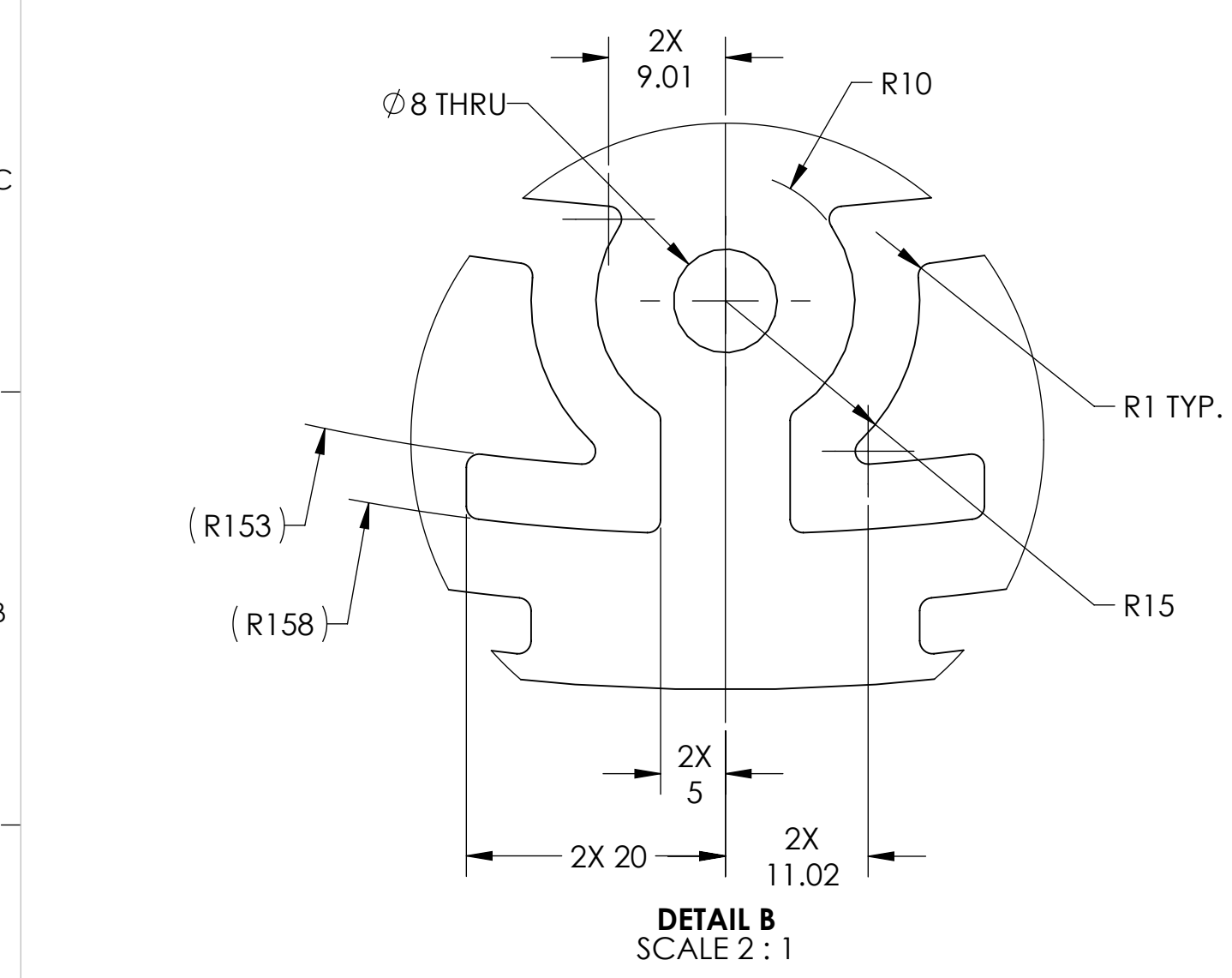
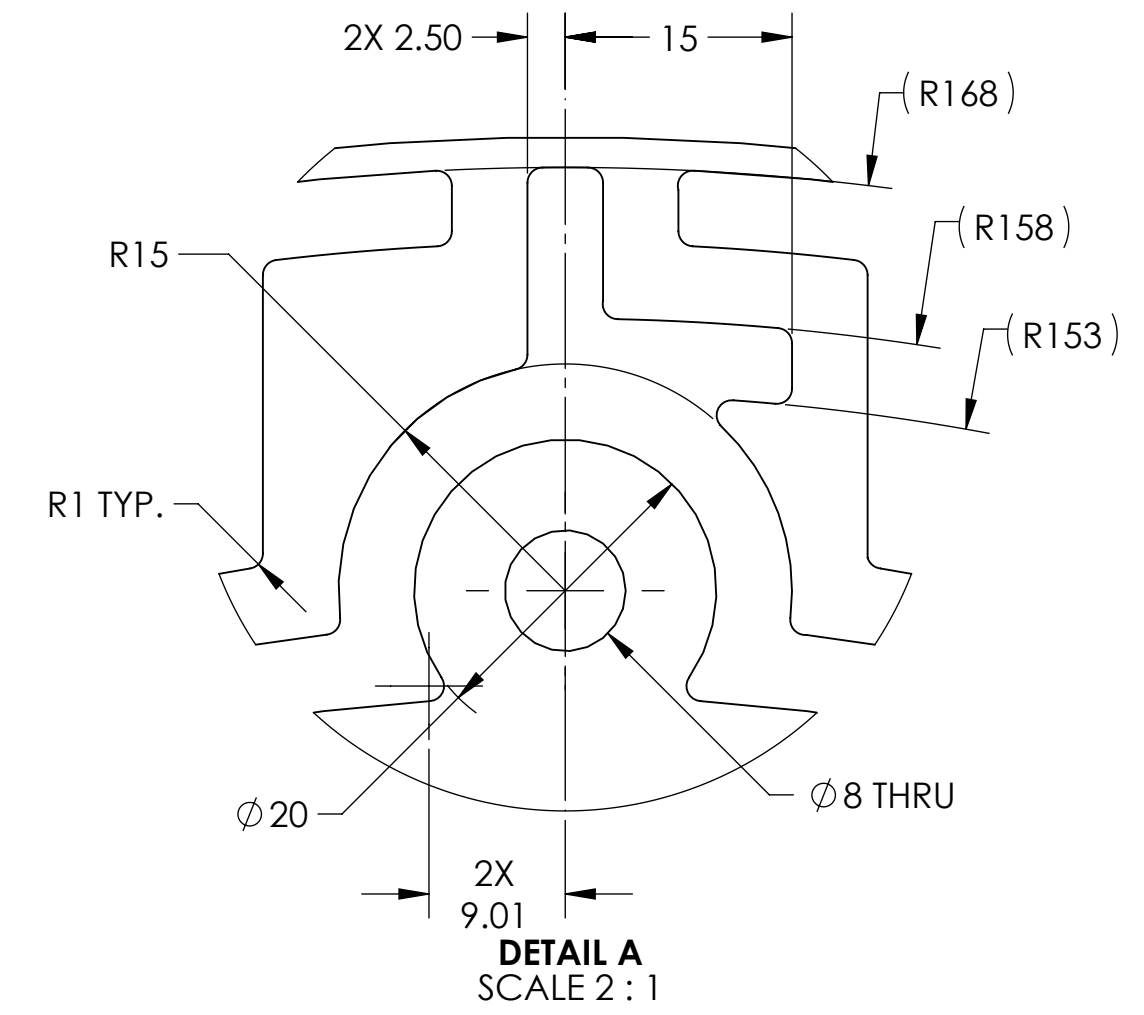
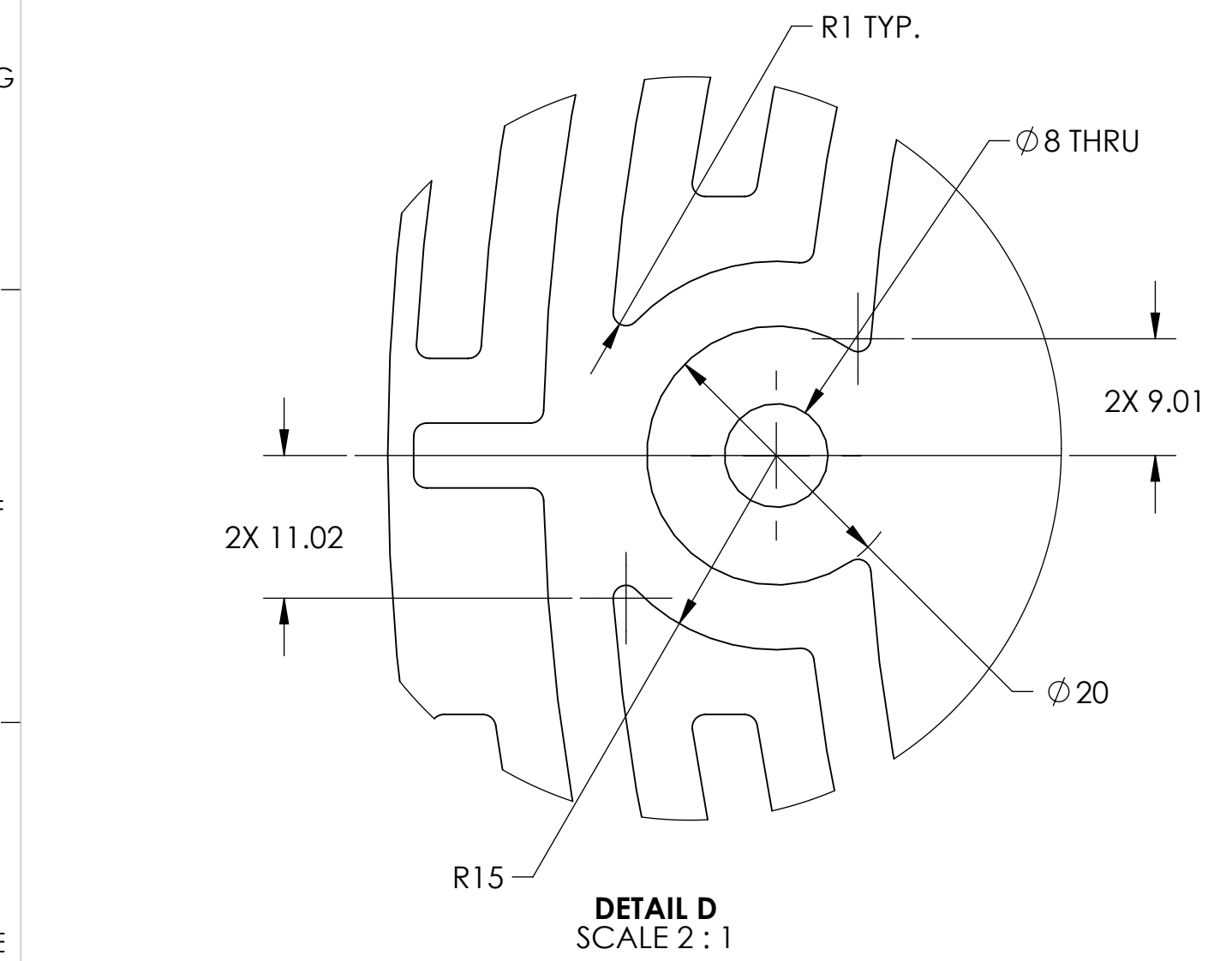
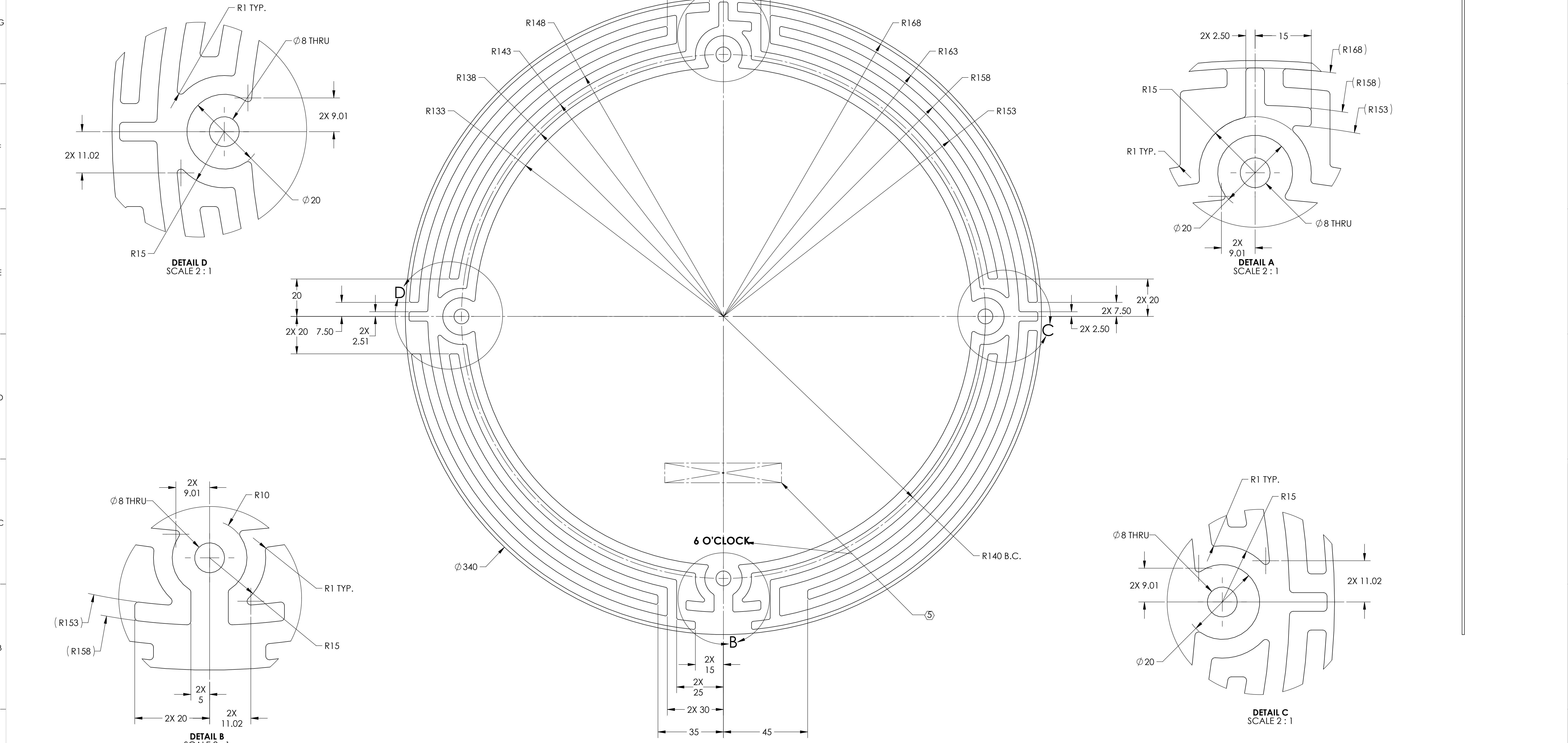

INTERNAL NOTE: MASK DETAIL GENERATED FROM LIGO D080177-v4.

DIMENSIONS ARE IN MILLIMETERS		TOLERANCES:		ANGULAR ± 0.5°		MATERIAL		FINISH		NEXT ASSY		SYSTEM		SUB-SYSTEM		PART NAME														
.X	± .10	.XX	± .25			18 Ga. 304 SSSL	32	µinch		N/A			ADVANCED LIGO	COC	Compensation Plate, Au Coating Mask															
NOTES AND TOLERANCES: (UNLESS OTHERWISE SPECIFIED) 1. INTERPRET DRAWING PER ASME Y14.5-1994. 2. REMOVE ALL SHARP EDGES, .005-.015, FOR MACHINED PARTS. ROUND ALL EDGES APPROXIMATELY R.02 FOR SHEET METAL PARTS. 3. DO NOT SCALE FROM DRAWING. 4. ALL MACHINING FLUIDS MUST BE FULLY SYNTHETIC, FULLY WATER SOLUBLE AND FREE OF SULFUR, SILICONE, AND CHLORINE.												DESIGNER	E.SANCHEZ	30 JUL 2015	SIZE	D	DWG. NO.	D1500217		REV.	v1	APPROVAL		SEE DCC	SEE DCC	SCALE:	1:1	PROJECTION:		SHEET 1 OF 1

D1500217-LIGO, COMPENSATION PLATE, Au COATING MASK, PART PDM, REV-X-005, DRAWING PDM, REV. X-004