

8

7

6

5

4

3

2

1

NOTES CONTINUED:

- 5. BAG AND TAG WITH PART AND SERIAL NUMBERS
- 6. APPROXIMATE WEIGHT = X.XXX LB.
- 7. MACHINE ALL SURFACES TO REMOVE OXIDES AND MILL FINISH. USE OF ABRASIVE REMOVAL TECHNIQUES IS NOT ALLOWED.
- 8. ALL PARTS SHALL BE MANUFACTURED IN ACCORDANCE WITH LIGO SPECIFICATION E0900364.

REV.	DATE	DCN #	DRAWING TREE #
v1	10 DEC 2013	E1300940-x0	-
-	-	-	-
-	-	-	-

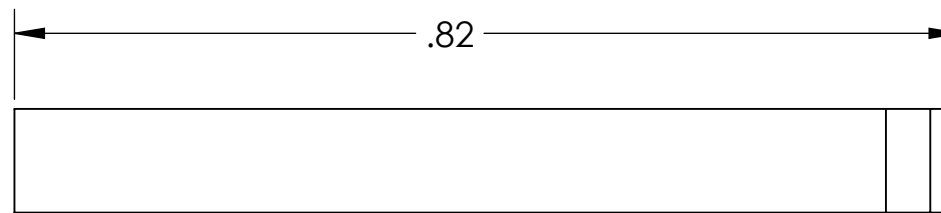
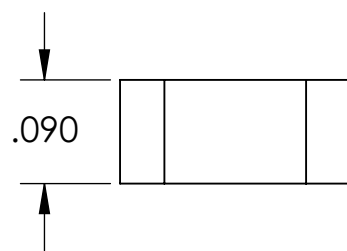
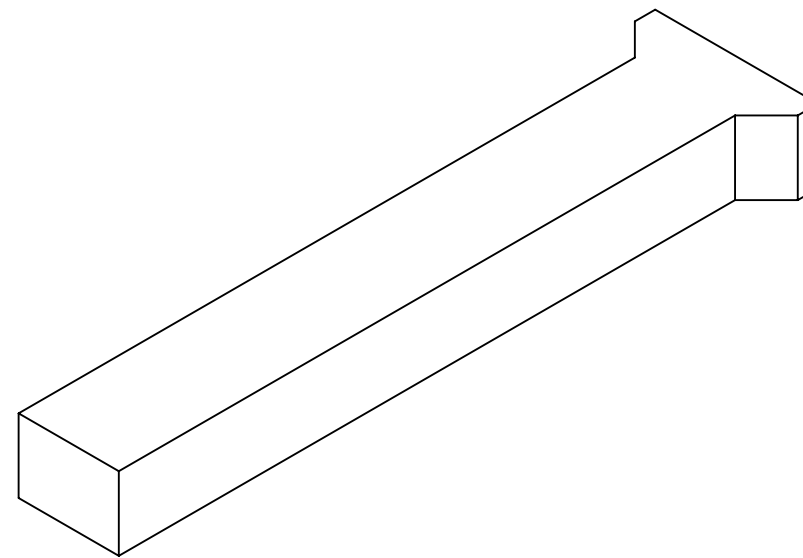
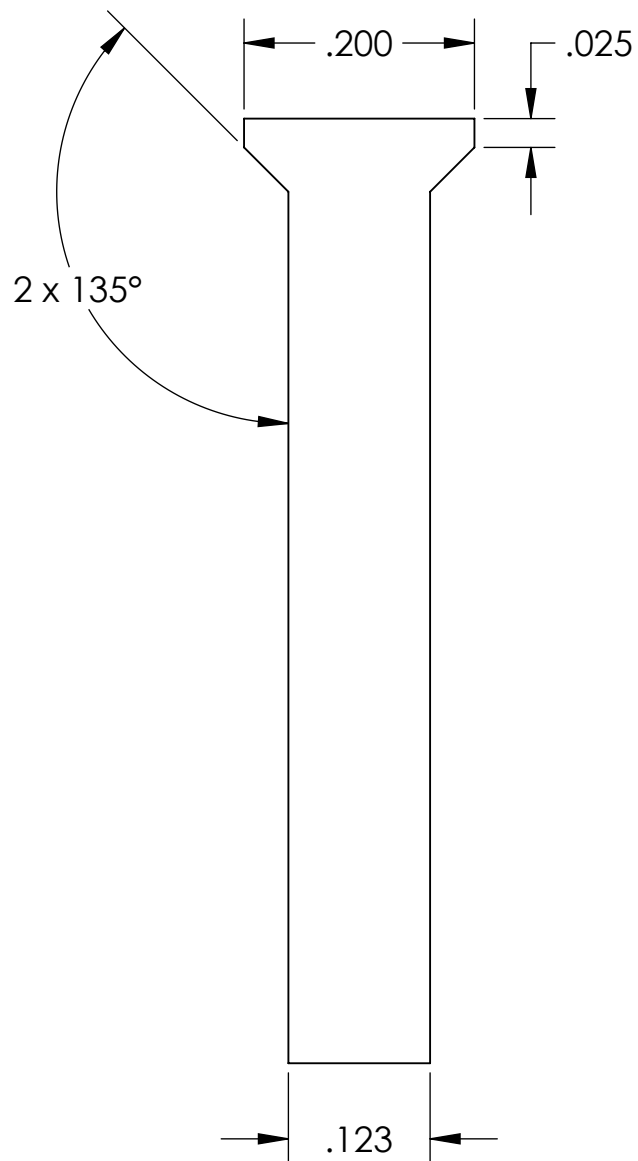

D1301023 Key, ISC Fast Shutter, PART PDM REV: X-000, DRAWING PDM REV: X-001

NOTES AND TOLERANCES: (UNLESS OTHERWISE SPECIFIED)				LIGO CALIFORNIA INSTITUTE OF TECHNOLOGY MASSACHUSETTS INSTITUTE OF TECHNOLOGY		PART NAME			
DIMENSIONS ARE IN		1. INTERPRET DRAWING PER ASME Y14.5-1994. 2. REMOVE ALL SHARP EDGES .005-.015. 3. DO NOT SCALE FROM DRAWING. 4. ALL MACHINING FLUIDS MUST BE FULLY SYNTHETIC, FULLY WATER SOLUBLE AND FREE OF SULFUR, SILICONE, AND CHLORINE.		SYSTEM		SUB-SYSTEM		KEY, ISC FAST SHUTTER	
TOLERANCES: .XX ± .01 .XXX ± .005		MATERIAL		ADVANCED LIGO		ISC		DESIGNER J.LEWIS 9 DEC 2013	
ANGULAR ± 5°		6061-T6 (SS)		NEXT ASSY		D1003318		DRAFTER J.LEWIS 9 DEC 2013	
		FINISH						SIZE DWG. NO.	
		63 μinch						B D1301023	
								CHECKER	
								APPROVAL	
								SCALE: 6:1 PROJECTION: SHEET 1 OF 1	

8

7

6

5

4

3

2

1