

NOTES CONTINUED:

④ SCRIBE, ENGRAVE (A VIBRATORY TOOL MAY BE USED), LASER MARK OR MECHANICALLY STAMP (NO INKS OR DYES) DRAWING PART NUMBER, REVISION, AND A THREE DIGIT SERIAL NUMBER ON NOTED SURFACE OF PART. SERIAL NUMBERS START AT 001 FOR THE FIRST ARTICLE AND PROCEED CONSECUTIVELY. USE MINIMUM 0.10" HIGH CHARACTERS. EXAMPLE: D1301032-V2, S/N 001

D 5. WEIGHT: 0.02 LB.

⑥ USE STANDARD STI TAP IF H11 STI TAP IS NOT AVAILABLE.

⑦ EMHART 1185-2EN164 (8-32 HELI-COIL, NITRONIC 60, 1D) TO BE PROCURED AND INSTALLED BY LIGO.

REV.	DATE	DCN #	DRAWING TREE #
v1	07 DEC 2013	E1300936-x0	-
v2	09 DEC 2013	E1300936-x0	-
-	-	-	-

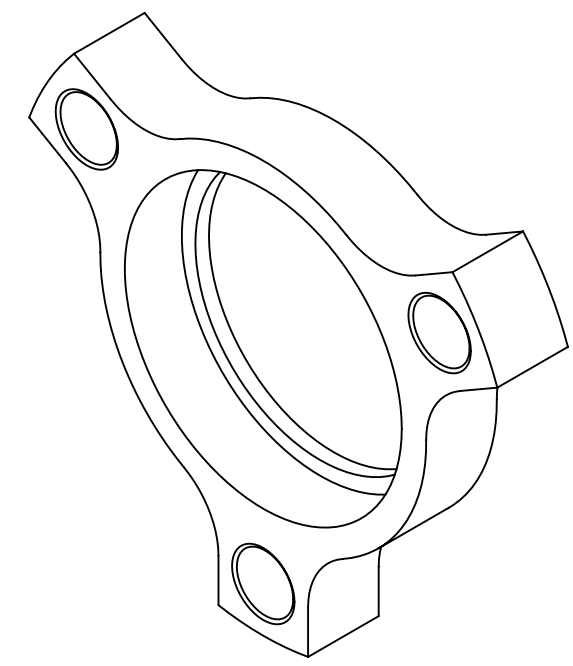
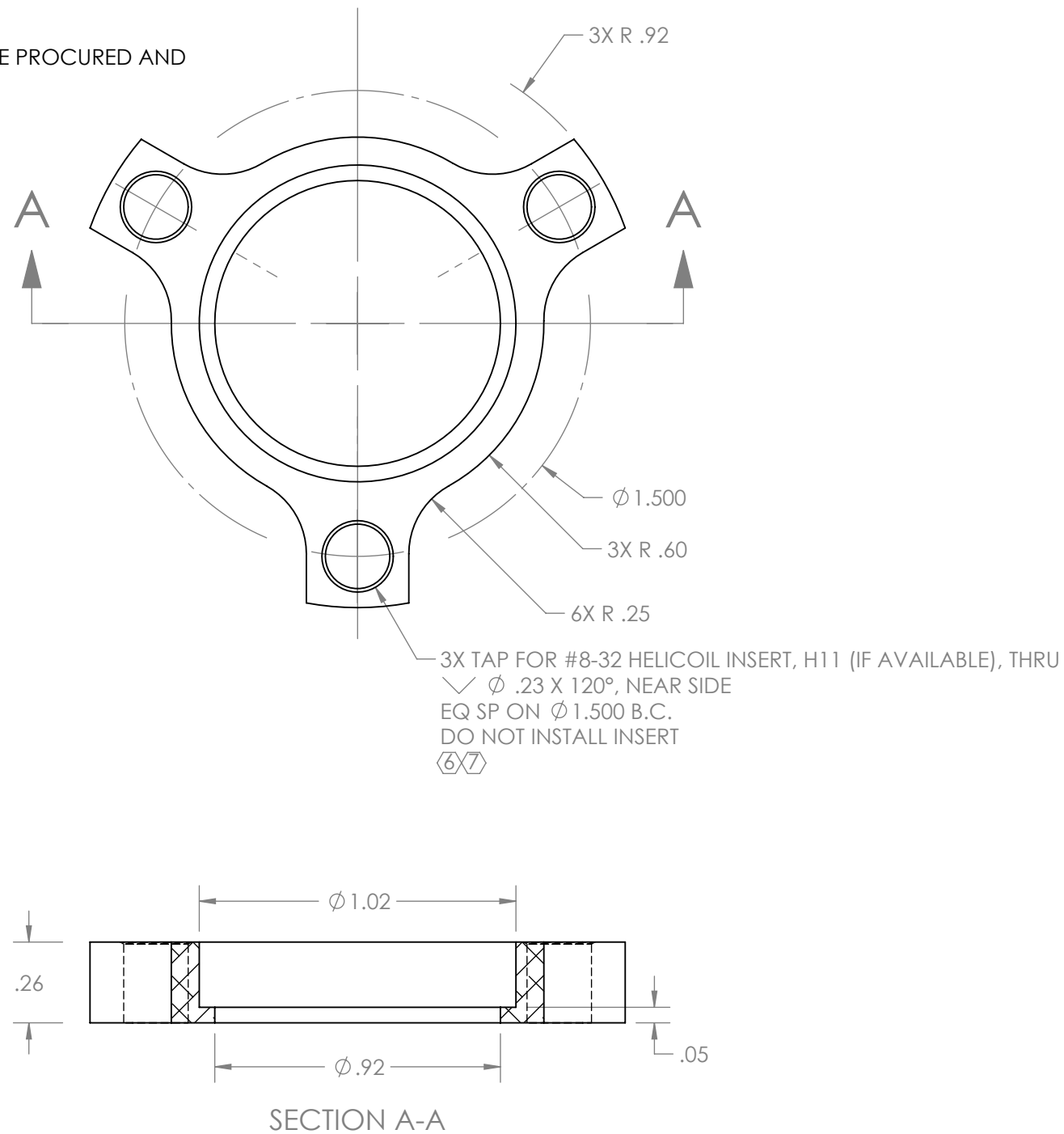

OBLIQUE FRONT VIEW

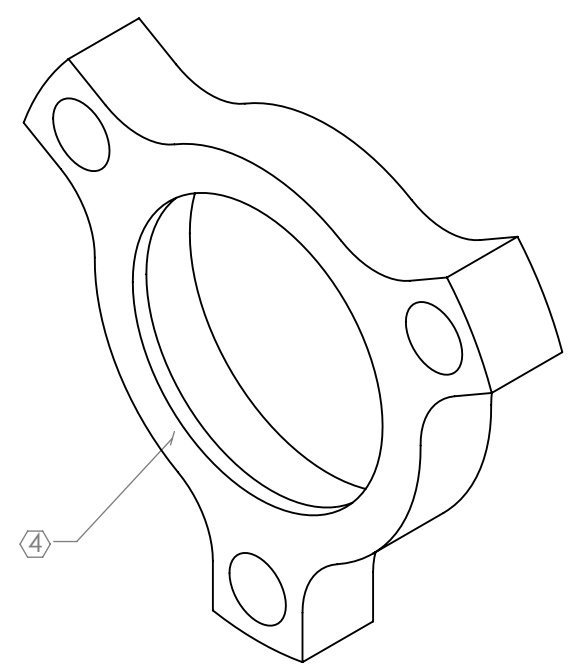

OBLIQUE BACK VIEW

D1301022 aLIGO Pcal Tooling, 1 in. Mirror Clamp, PART PDM REV: X-004, DRAWING PDM REV: X-007

NOTES AND TOLERANCES: (UNLESS OTHERWISE SPECIFIED)				LIGO CALIFORNIA INSTITUTE OF TECHNOLOGY MASSACHUSETTS INSTITUTE OF TECHNOLOGY		PART NAME	
DIMENSIONS ARE IN INCHES				SYSTEM		aLIGO PCAL TOOLING, 1" MIRROR CLAMP	
TOLERANCES: .XX ± .01 .XXX ± .005				ADVANCED LIGO		SIZE DWG. NO.	
ANGULAR ± 0.5°				SUB-SYSTEM		B	
MATERIAL 6061-T6 Al				NEXT ASSY		D1301016	
FINISH 125 μ inch Ra MAX				DESIGNER		R. SAVAGE	
				DRAFTER		C. CONLEY	
				CHECKER		SEE DCN	
				APPROVAL		SEE DCN	
				DATE		07 DEC 2013	
				REVISION		v2	
				SCALE: NONE		PROJECTION:	
						SHEET 1 OF 1	