

D1300483 aLIGO Pcal Tooling, Periscope Target Clockpiece Assembly, PART PDM REV: X-015, DRAWING PDM REV: X-002

8 7 6 5 4 3 2 1

NOTES:

REV.	DATE	DCN #	DRAWING TREE #
v1	16 JUL 2013	-	-
-	-	-	-
-	-	-	-

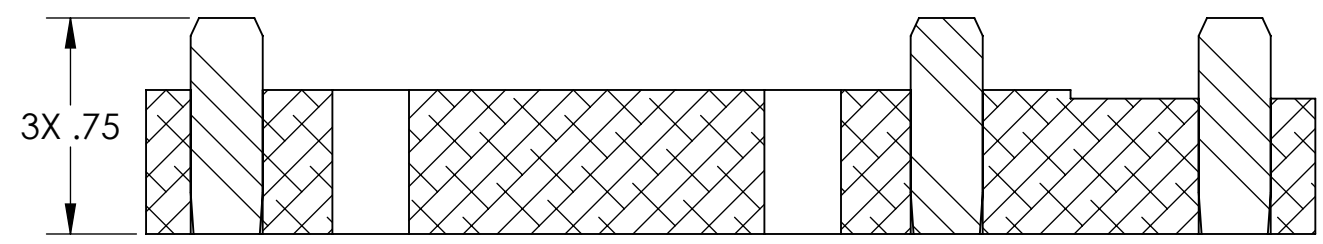
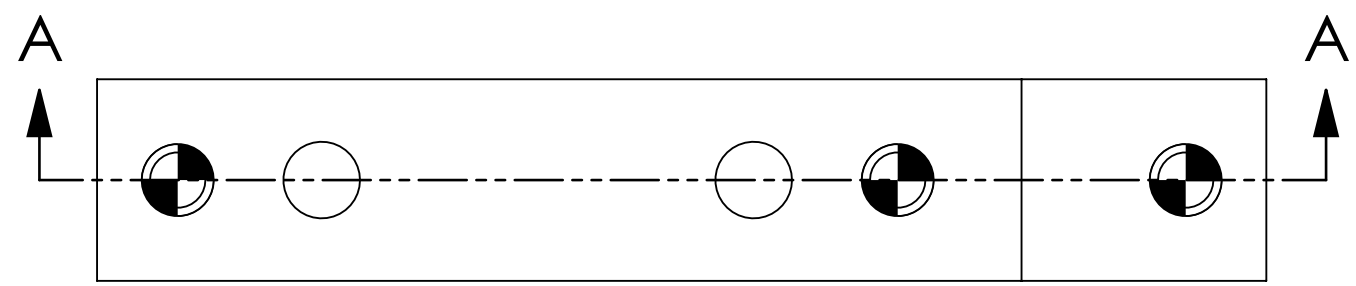

SECTION A-A

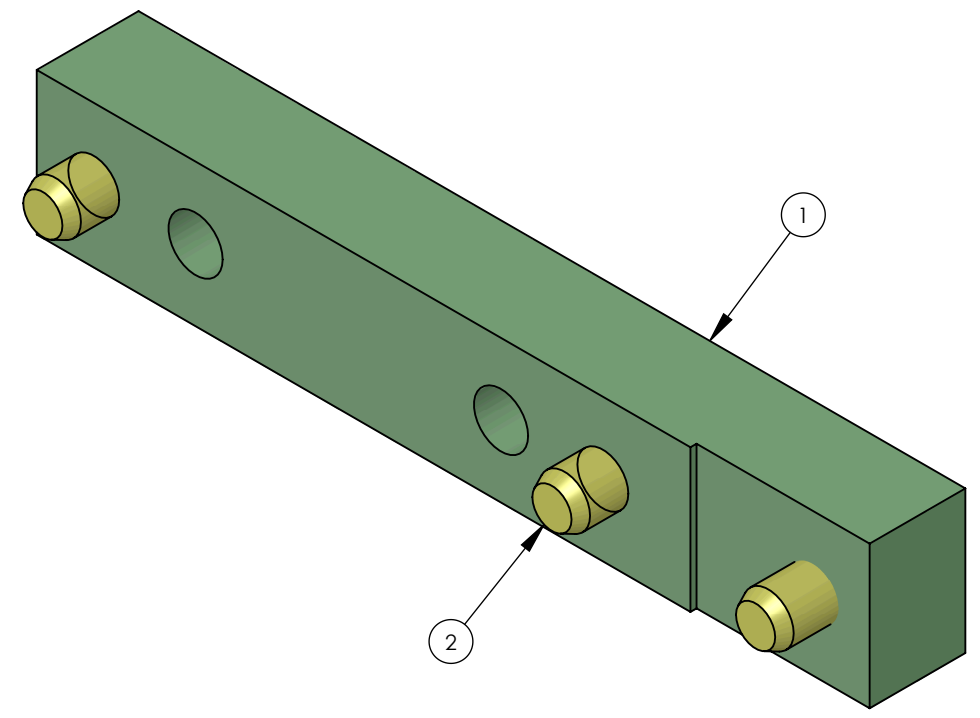

ITEM NO.	PART NUMBER	DESCRIPTION	REV.	MATERIAL	QTY.	SPARE	TOTAL
2	MS16555-646	DOWEL PIN, 1/4D, 3/4L	-	416 SSSL	3		3
1	D1300454	aLIGO PCAL TOOLING, PERISCOPE INSTALLATION CENTER TARGET CLOCKPIECE	v1	6061-T6 Al	1		1

PARTS LIST

NOTES AND TOLERANCES: (UNLESS OTHERWISE SPECIFIED)	
DIMENSIONS ARE IN INCHES	
TOLERANCES:	
.XX ±	
.XXX ±	
ANGULAR ± °	
MATERIAL	N/A
FINISH	N/A μinch

CALIFORNIA INSTITUTE OF TECHNOLOGY MASSACHUSETTS INSTITUTE OF TECHNOLOGY	PART NAME		aLIGO PCAL TOOLING, PERISCOPE TARGET CLOCKPIECE ASSEMBLY			
	SYSTEM ADVANCED LIGO	SUB-SYSTEM AOS	DESIGNER R. SAVAGE	DATE 09 MAY 2013	SIZE B	DWG. NO. D1300483
DRAFTER C. CONLEY	CHECKER C. CONLEY	DATE 16 JUL 2013	SCALE: NONE PROJECTION: SHEET 1 OF 1			
NEXT ASSY D1300437						

8 7 6 5 4 3 2 1