

8 7 6 5 4 3 2 1

NOTES CONTINUED:

④ SCRIBE, ENGRAVE (A VIBRATORY TOOL MAY BE USED), LASER MARK OR MECHANICALLY STAMP (NO INKS OR DYES) DRAWING PART NUMBER, REVISION (AND VARIANT OR "TYPE" IF APPLICABLE) ON NOTED SURFACE OF PART FOLLOWED ON THE NEXT LINE WITH A THREE DIGIT SERIAL NUMBER. SERIAL NUMBERS START AT 001 FOR THE FIRST ARTICLE AND PROCEED CONSECUTIVELY. USE MINIMUM 0.12" HIGH CHARACTERS, UNLESS THE SIZE OF THE PART DICTATES SMALLER CHARACTERS. EXAMPLE: DXXXXXX-VY, TYPE XX, S/N XXX

5. WEIGHT: 7.58 LB.

⑥ SCRIBE PART ALL ACROSS AT NOTED LOCATIONS, .015 WIDE MAX.

7. ALL UNSPECIFIED CUT-OUTS ACCORDING TO CAD MODEL PROVIDED BY LIGO, ±.03.

REV.	DATE	DCN #	DRAWING TREE #
v1	21 MAY 2013	-	-
-	-	-	-
-	-	-	-

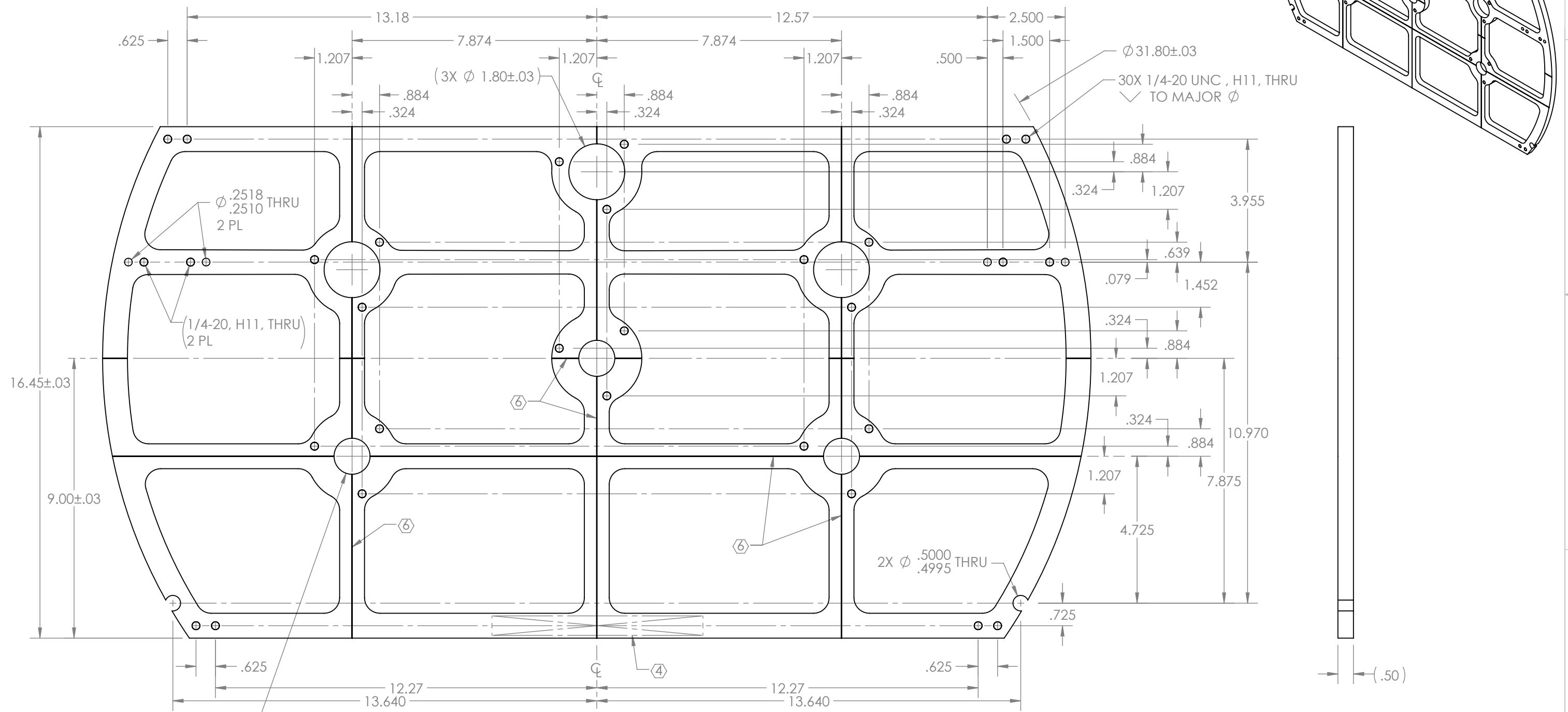
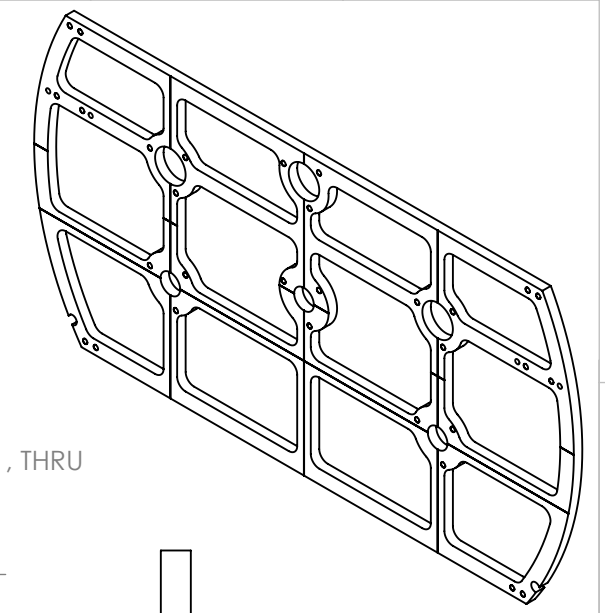

D1300384 qLIGO Pcal Tooling, Periscope Installation Center Target Plate, PART PDM REV: X-013, DRAWING PDM REV: X-010

NOTES AND TOLERANCES: (UNLESS OTHERWISE SPECIFIED)

DIMENSIONS ARE IN INCHES

TOLERANCES:
 .XX ± .01
 .XXX ± .005
 ANGULAR ± 0.5°

MATERIAL: ALUMINUM TOOLING PLATE, 1/2"
 FINISH: N/A

LIGO CALIFORNIA INSTITUTE OF TECHNOLOGY MASSACHUSETTS INSTITUTE OF TECHNOLOGY		PART NAME: qLIGO PCAL TOOLING, PERISCOPE INSTALLATION CENTER TARGET PLATE	
SYSTEM: ADVANCED LIGO NEXT ASSY: D1300437	SUB-SYSTEM: AOS	DESIGNER: R. SAVAGE DRAFTER: C. CONLEY CHECKER: C. CONLEY APPROVAL:	DATE: 05 MAY 2013 SIZE: B DWG. NO.: D1300384 REV.: v1
		SCALE: NONE PROJECTION: SHEET 1 OF 1	

8 7 6 5 4 3 2 1