

D1300231 2in. MIRROR MOUNT, RH HOLDER, 4in. BEAM HEIGHT, ISC, aLIGO, PART PDM REV: X-001, DRAWING PDM REV: X-001

8 7 6 5 4 3 2 1

REV.	DATE	DCN #	DRAWING TREE #
-	-	-	-
-	-	-	-
-	-	-	-

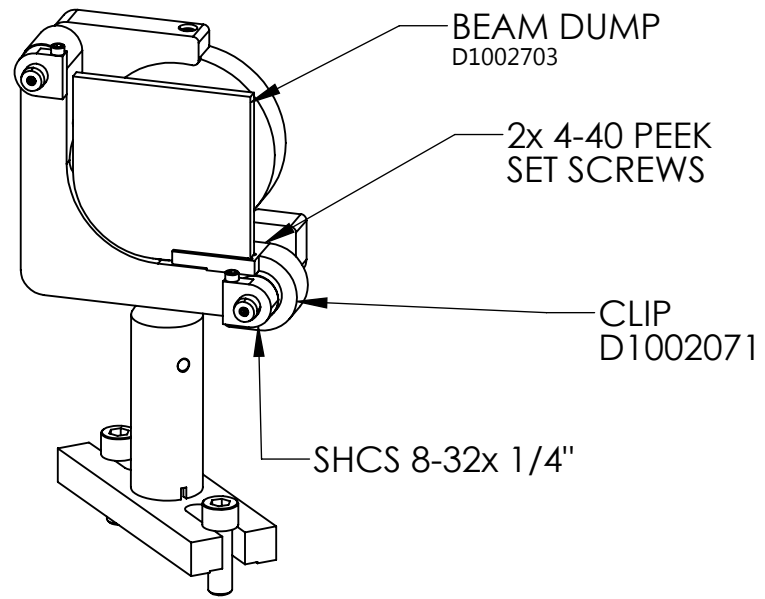
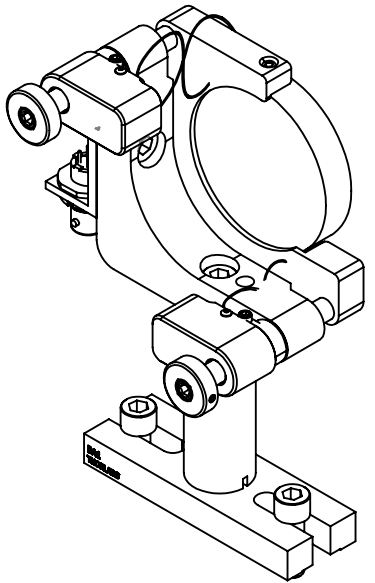
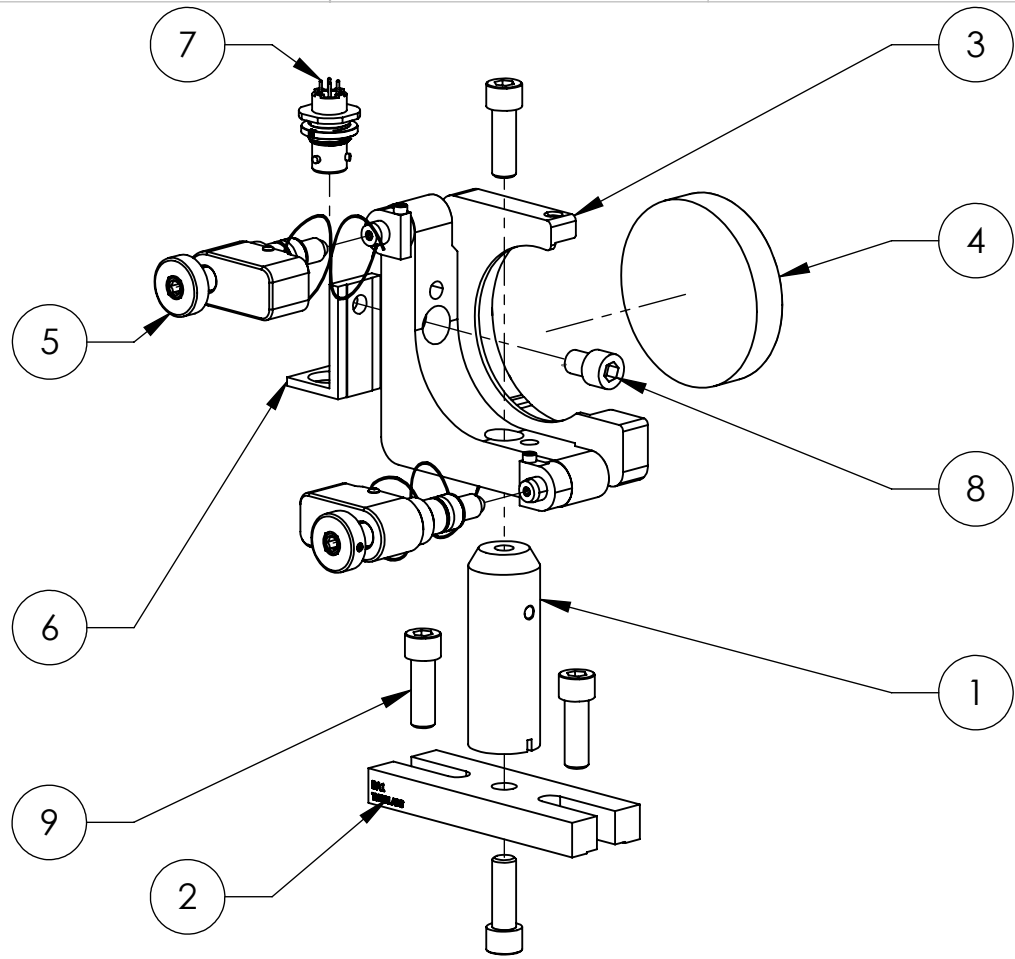
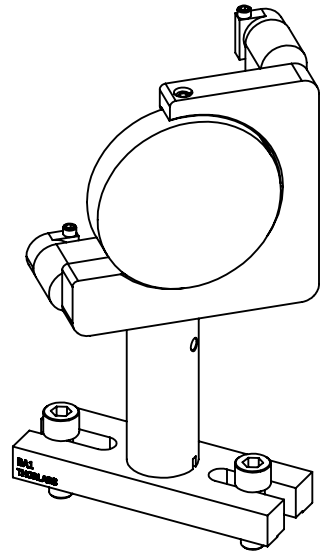

9	MCMMASTER_92196A540 or Equivalent	SHCS, 1/4"-20x0.75" (Fully Threaded)	18-8 SSSL	4
8	92196A534	SHCS 1/4"-20 X 0.313" 18-8 SST	18-8 SSSL	1
7	SEE DESC.	SWPC_BNC_Glenair_803-003-07M6-4PN-598A	-	1
6	D1002763	ISC Panel Bracket for Glenair Coupling	6061-T6 Al	1
5	8301UHV	NewFocus, PICO MOTOR	6061-T6 Al	2
4		MIRROR	GLASS	1
3	IXM200.C2-RH	2" MIRROR MOUNT - RH. SISKIYOU	6061-T6 Al	1
2	BA1	ThorLabs BA1 - MOUNTING BASE	6061-T6 Al	1
1	D1000926	TRANSMON - 3/4" O.D. MIRROR MOUNT POST	6061-T6 Al	1
ITEM NO.	PART NUMBER	DESCRIPTION	MATERIAL	-QTY.

NOTES AND TOLERANCES: (UNLESS OTHERWISE SPECIFIED)

MATERIAL N/A FINISH N/A μinch

CALIFORNIA INSTITUTE OF TECHNOLOGY MASSACHUSETTS INSTITUTE OF TECHNOLOGY		PART NAME 2" Mirror Mount, RIGHT HAND Holder, 4" Beam Height,+Pico Motors	
SYSTEM ADVANCED LIGO	SUB-SYSTEM ISC	DESIGNER SBARNUM	DATE 12 MAR 2012
CHECKER PFRITSCHL	APPROVAL PFRITSCHL	SIZE DWG. NO. B	DWG. NO. D1300231
SCALE: 1:2		PROJECTION:	
		SHEET 1 OF 1	

8 7 6 5 4 3 2 1