

D1300074 Cable Post Assembly, TMS, ISC, aLIGO, PART PDM REV: X-000, DRAWING PDM REV: X-000

REV.	DATE	DCN #	DRAWING TREE #
V1	1/31/2013	E1300100	-
-	-	-	-
-	-	-	-

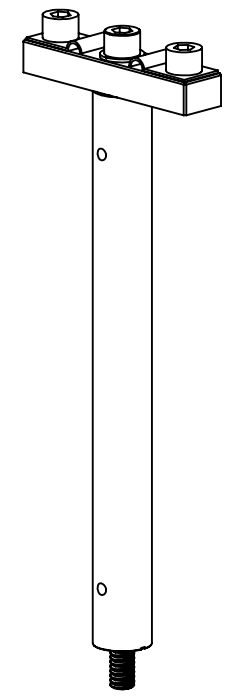
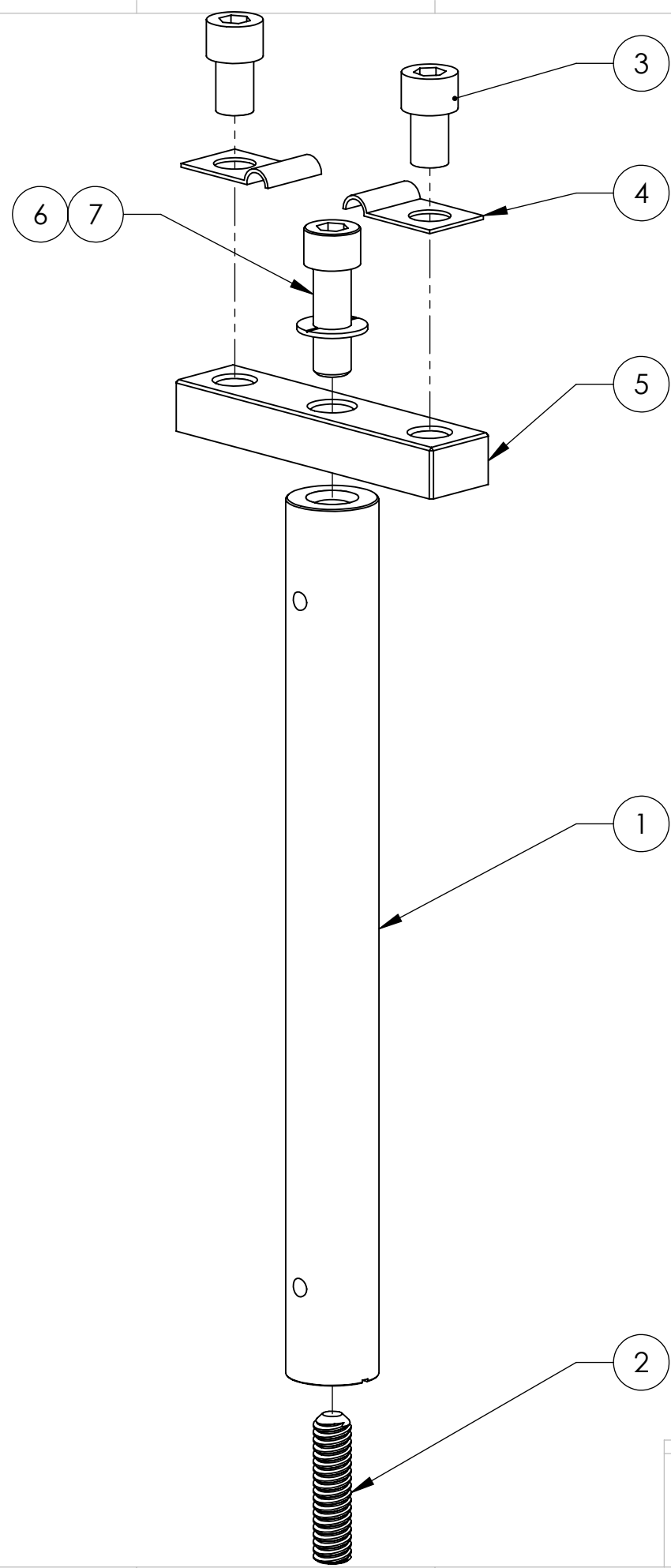

ITEM NO.	PART NUMBER	DESCRIPTION	MATERIAL	With C-Clips/QTY.	SPARE	TOTAL
7	MCMaster_92 196A540 or Equivalent	SHCS, 1/4"-20x0.75" (Fully Threaded)	18-8 SSTL	1		0
6	WFV-25	Flat Washer, Vented .255 ID, .46 OD, .032 THK	18-8 SSTL	1		0
5	D1300082	Cable Post T-Top, TMS, ISC, aLIGO	6061-T6 Al	1		0
4	F402-003C	Franklin Fastener F402-003C Half Clip 3/16"	18-8 SSTL	2		0
3	MCMaster_92 200A535	SHCS 1/4"-20 x 3/8" 18-8 SST	18-8 SSTL	2		0
2	MCMaster 92313A542	SSS 1/4"-20 x 1" 18-8 SST	18-8 SSTL	1		0
1	D1300073	Cable Post, TMS, ISC, aLIGO	6061-T6 Al	1		0

PARTS LIST

NOTES AND TOLERANCES: (UNLESS OTHERWISE SPECIFIED)

MATERIAL	FINISH
	N/A

CALIFORNIA INSTITUTE OF TECHNOLOGY MASSACHUSETTS INSTITUTE OF TECHNOLOGY	
SYSTEM	SUB-SYSTEM
ADVANCED LIGO	ISC
NEXT ASSY	D1000484

PART NAME				Cable Post Assembly, TMS, ISC, aLIGO	
DESIGNER	SBARNUM	29 Jan 2013	SIZE	DWG. NO.	REV.
DRAFTER	SBARNUM	31 JAN 2013	B	D1300074	v1
CHECKER	SBARNUM	31 JAN 2013	SCALE:	1:1	PROJECTION:
APPROVAL	PFRITSHCEL	31 JAN 2013	SHEET 1 OF 2		

D1300074 Cable Post Assembly, TMS, ISC, aLIGO, PART PDM REV: X-000, DRAWING PDM REV: X-000

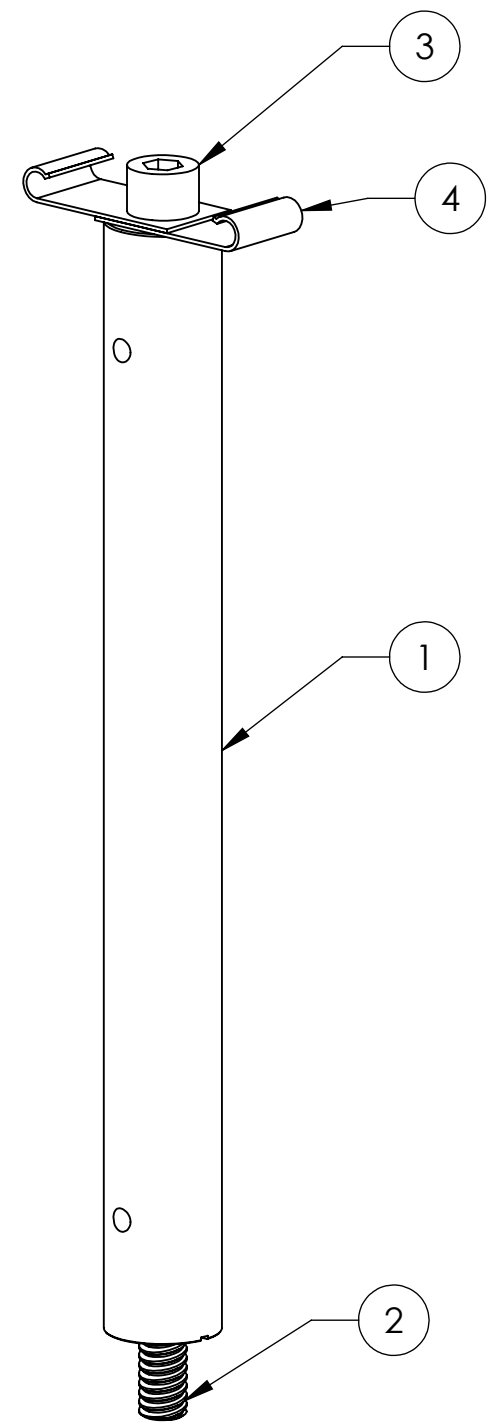

OPTION WITH 3/16" J-CLIPS

4	FRANKLIN F442-003C	FRANKLIN FASTENER F442-003C J-Clip 3/16" 18-8	18-8 SSTL	2		0
3	McMASTER_92200A535	SHCS 1/4"-20 x 3/8" 18-8 SST	18-8 SSTL	1		0
2	McMASTER 92313A542	SSS 1/4"-20 x 1" 18-8 SST	18-8 SSTL	1		0
1	D1300073	Cable Post, TMS, ISC, aLIGO	6061-T6 Al	1		0
ITEM NO.	PART NUMBER	DESCRIPTION	MATERIAL	With J-Clips/QTY.	SPARE	TOTAL
PARTS LIST						

CALIFORNIA INSTITUTE OF TECHNOLOGY
MASSACHUSETTS INSTITUTE OF TECHNOLOGY

SIZE	DWG. NO.	REV.
B	D1300074	v1
SCALE: 1:1		PROJECTION:
		SHEET 2 OF 2