

REV.	DATE	DCN #	DRAWING TREE #
v2	5 DEC 2013	E1300933-x0	-
-	-	-	-
-	-	-	-

SECONDARY MOUNTING HOLE OPTION FOR #10-32

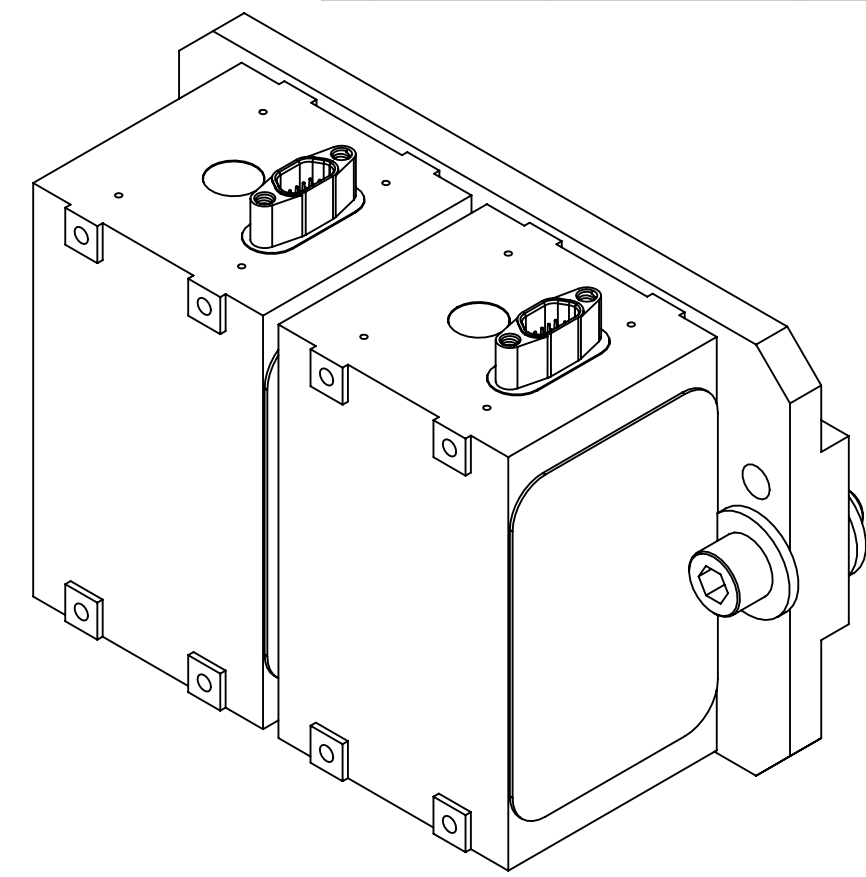
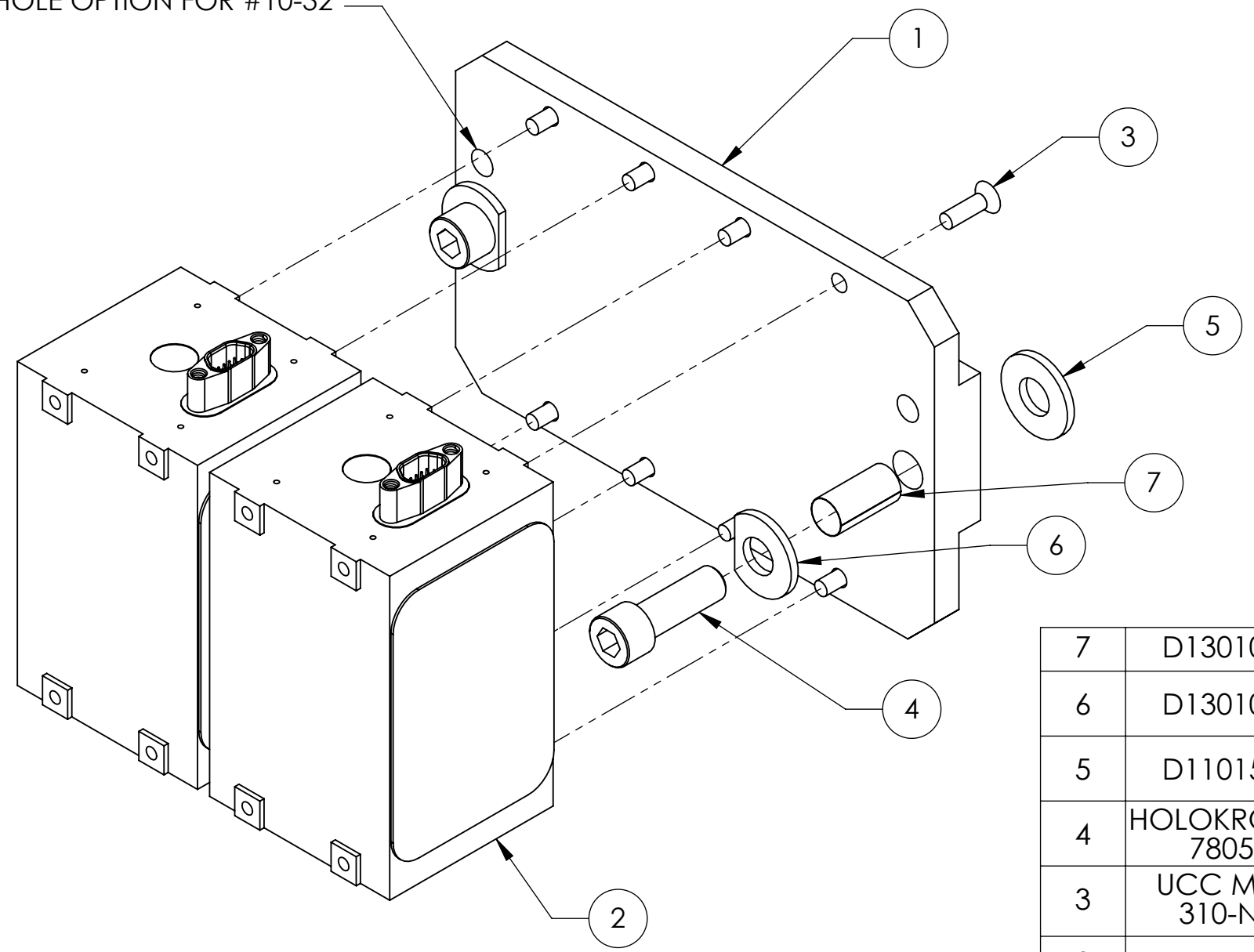

7	D1301013	Kapton Sleeve	Kapton	2	0	
6	D1301012	FLAT WASHER, NATURAL BEIGE COLOR, .25 SCREW, MODIFIED	PEEK	2	0	
5	D1101529	FLAT WASHER, NATURAL BEIGE COLOR, .25 SCREW	PEEK	2	0	
4	HOLOKROME_78058	SCREW SHCS, 1/4-20 X 3/4 LG.	18-8 SS	2	0	
3	UCC MFA-310-NA	FSHCS M3 x .5 x 10, Ag, DIN7991, A2	18-8 SSSL	8	0	
2	No Assm P/N	Preamp Assembly, OMC	-----	2	0	
1	D1201501	Bracket, Preamp, OMC, aLIGO	6061-T6 Al	1	0	
ITEM NO.	PART NUMBER	DESCRIPTION	MATERIAL	Def ault /RE Q	SPA RE	TOT AL

PARTS LIST

NOTES AND TOLERANCES: (UNLESS OTHERWISE SPECIFIED)

MATERIAL		FINISH		NEXT ASSY		CALIFORNIA INSTITUTE OF TECHNOLOGY MASSACHUSETTS INSTITUTE OF TECHNOLOGY SYSTEM ADVANCED LIGO SUB-SYSTEM ISC		PART NAME Bracket and Preamp Assembly, OMC, aLIGO		DESIGNER SBARNUM 2 JAN 2013 DRAFTER SBARNUM Apr 2013 CHECKER JLEWIS Jan 2013 APPROVAL PFRITSCHL Jan 2013		SIZE DWG. NO. B D1201502		REV. v2	
N/A		N/A		D0900295						SCALE: 1:1		PROJECTION:		SHEET 1 OF 1	

D1201502 Bracket and Preamp Assembly, OMC, aLIGO, PART PDM REV: X-005, DRAWING PDM REV: X-001