

D1201421\_ZnSe VP BEAM BLOCK, SHORT, PART PDM REV: X-006, DRAWING PDM REV: X-001

- NOTES CONTINUED:**
- 5. SCRIBE, ENGRAVE (A VIBRATORY TOOL MAY BE USED), LASER MARK OR MECHANICALLY STAMP (NO INKS OR DYES) DRAWING PART NUMBER, REVISION (AND VARIANT OR "TYPE" IF APPLICABLE) ON NOTED SURFACE OF PART FOLLOWED ON THE NEXT LINE WITH A THREE DIGIT SERIAL NUMBER. SERIAL NUMBERS START AT 001 FOR THE FIRST ARTICLE AND PROCEED CONSECUTIVELY. USE MINIMUM 0.12" HIGH CHARACTERS, UNLESS THE SIZE OF THE PART DICTATES SMALLER CHARACTERS. EXAMPLE: DXXXXXX-VY, TYPE-XX, S/N XXX
  - 6. APPROXIMATE WEIGHT = .43 LB.
  - 7. MACHINE ALL SURFACES TO REMOVE OXIDES AND MILL FINISH. USE OF ABRASIVE REMOVAL TECHNIQUES IS NOT ALLOWED. REFER TO LIGO-E0900364
  - 8. ALL PARTS SHALL BE MANUFACTURED IN ACCORDANCE WITH LIGO SPECIFICATION E0900364.
  - 9. ALL MATERIAL IS TO BE VIRGIN MATERIAL (i.e. NO WELD REPAIRS, PLUGS OR RECYCLED MATERIAL). NO REPAIRS SHALL BE MADE UNLESS APPROVED IN ADVANCE, AND IN WRITING, BY LIGO LABORATORY. REFER TO LIGO-E0900364.

TYPE	DESCRIPTION
-01	D1101627 BOTTOM WALL
-02	D1101627 TOP WALL

REV.	DATE	DCN #	DRAWING TREE #
v1	DEC 05 2012	E1200247-x0	E1200248-v1
-	-	-	-
-	-	-	-

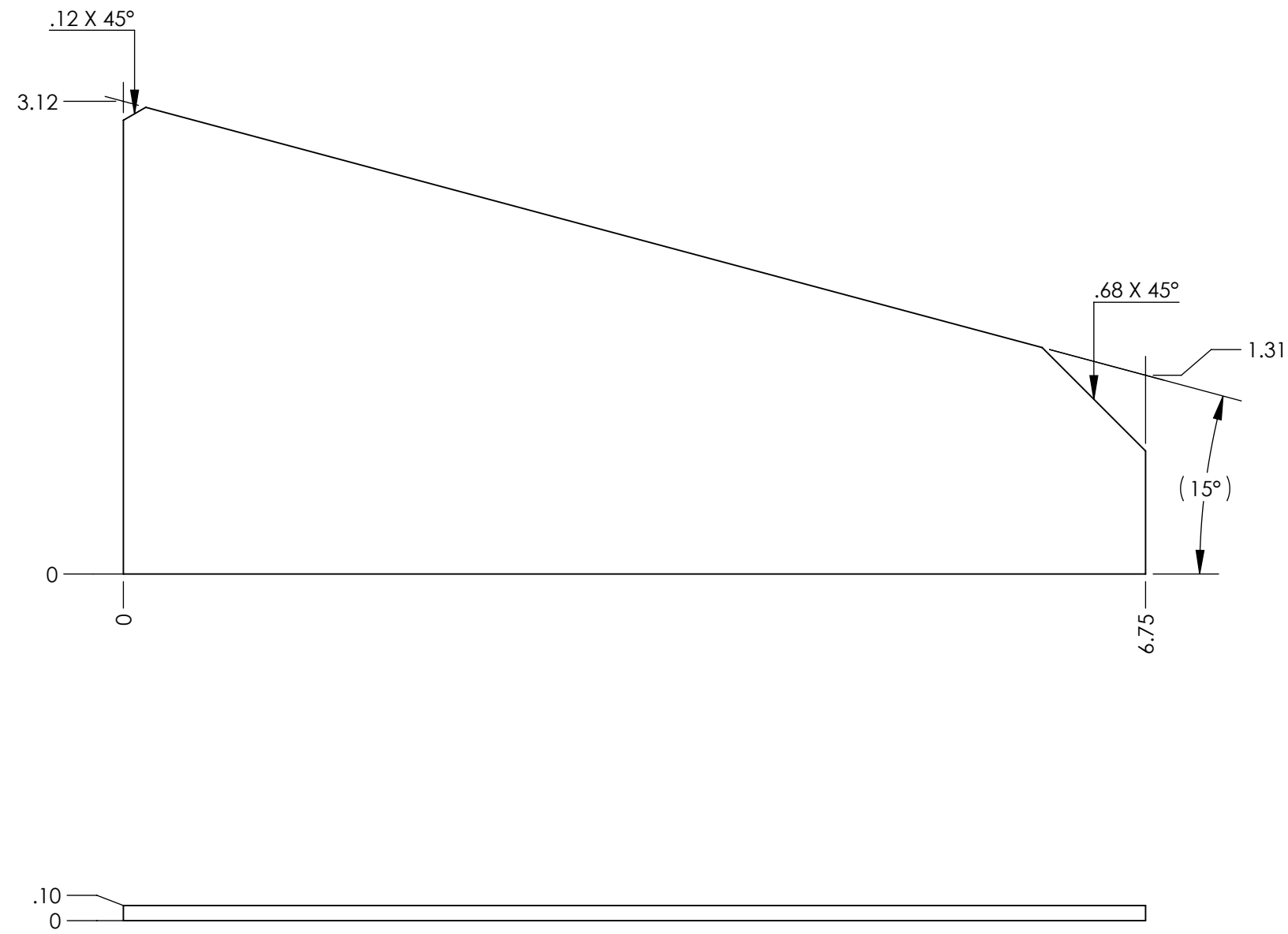

**BLANK**

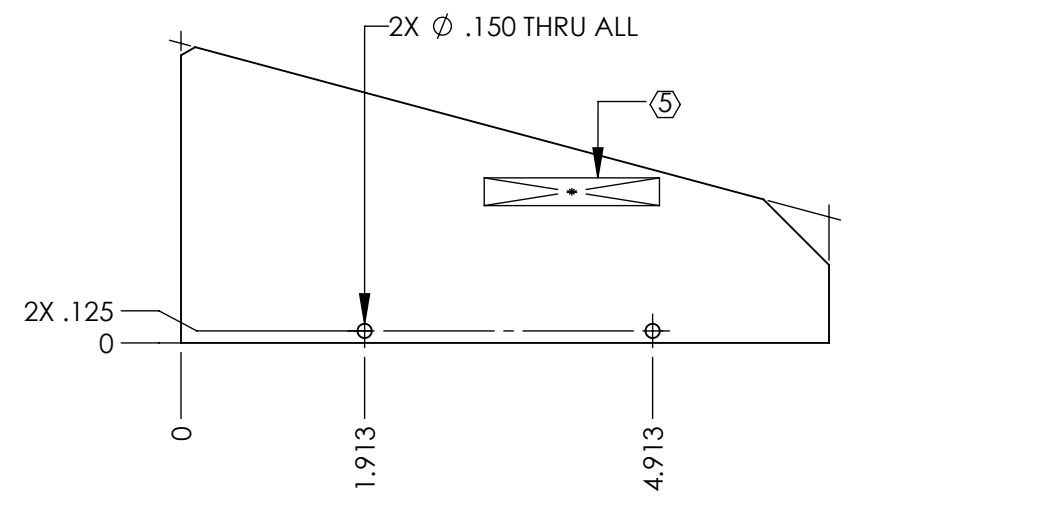

**-01 DETAIL**

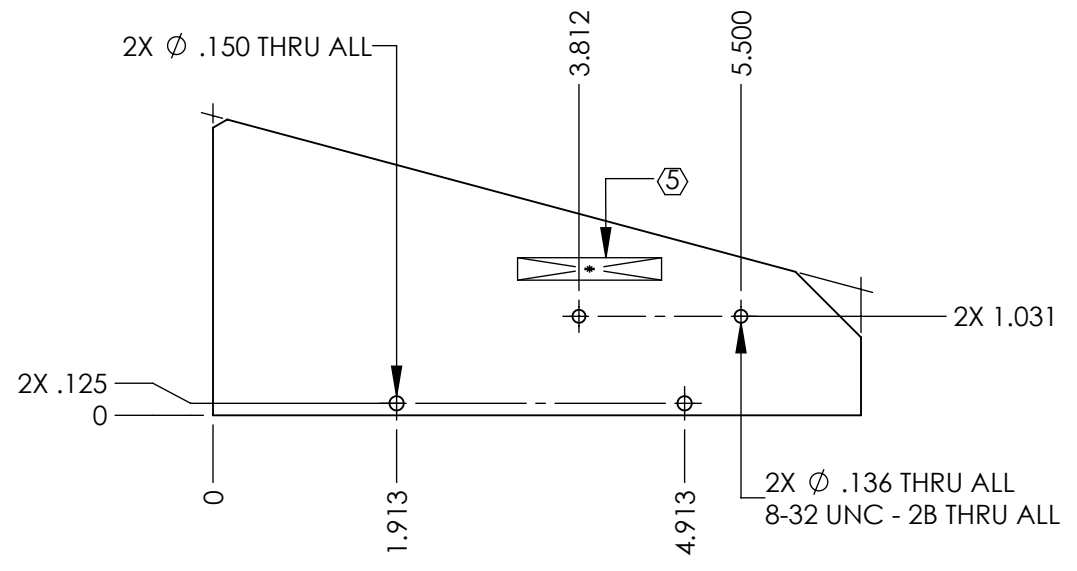

**-02 DETAIL**

NOTES AND TOLERANCES: (UNLESS OTHERWISE SPECIFIED)	
DIMENSIONS ARE IN INCHES	
TOLERANCES: .XX ± .01 .XXX ± .005 ANGULAR ± 1.0°	
MATERIAL	FINISH
AISI 304	63 μinch

CALIFORNIA INSTITUTE OF TECHNOLOGY MASSACHUSETTS INSTITUTE OF TECHNOLOGY		PART NAME <b>ZnSe VIEWPORT BEAM BLOCK, SHORT</b>	
SYSTEM	SUB-SYSTEM	DESIGNER	DATE
ADVANCED LIGO	AOS	M. JACOBSON	23-OCT-2012
NEXT ASSY	D1101627	DRAFTER	DATE
		E. SANCHEZ	DEC 05 2012
		CHECKER	DATE
		M. JACOBSON	DEC 05 2012
		APPROVAL	DATE
		M. JACOBSON	DEC 05 2012
SIZE DWG. NO. <b>B D1201421</b>		REV.	v1
SCALE: 1:1 PROJECTION:		SHEET 1 OF 1	