

NOTES (CONTINUED):  
4. WEIGHT: 1.34 LB.

REV.	DATE	DCN #	DRAWING TREE #
v1	21 DEC 2012	-	-
v2	09 JAN 2013	-	-

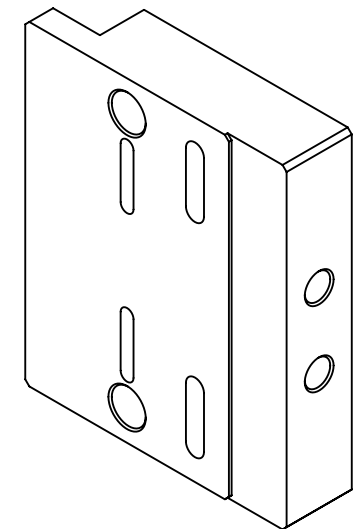
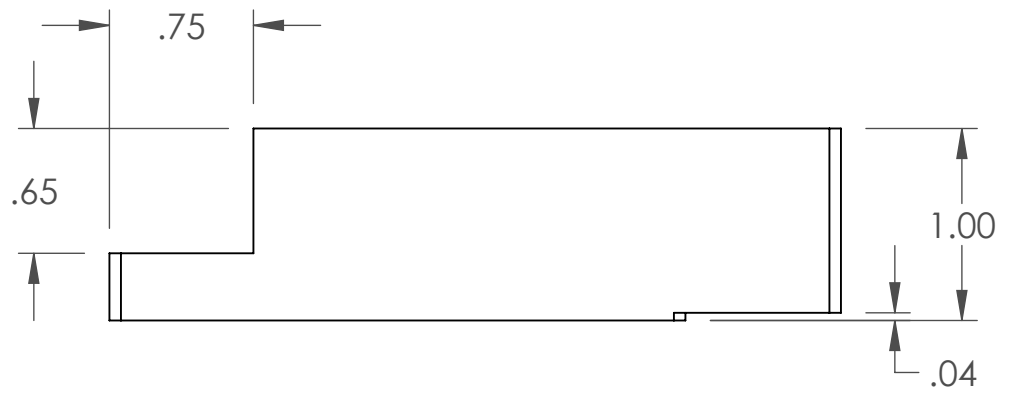

3/8-16 UNC, H11,  $\nabla$  1.01  
(.005 OVERSIZE) BOTH DRILL & TAP  
 $\nabla$  TO MAJOR  $\phi$  NEAR SIDE

2X .266 X .75 SLOT THRU  
2X .563 X .75 SLOT,  $\nabla$  .23

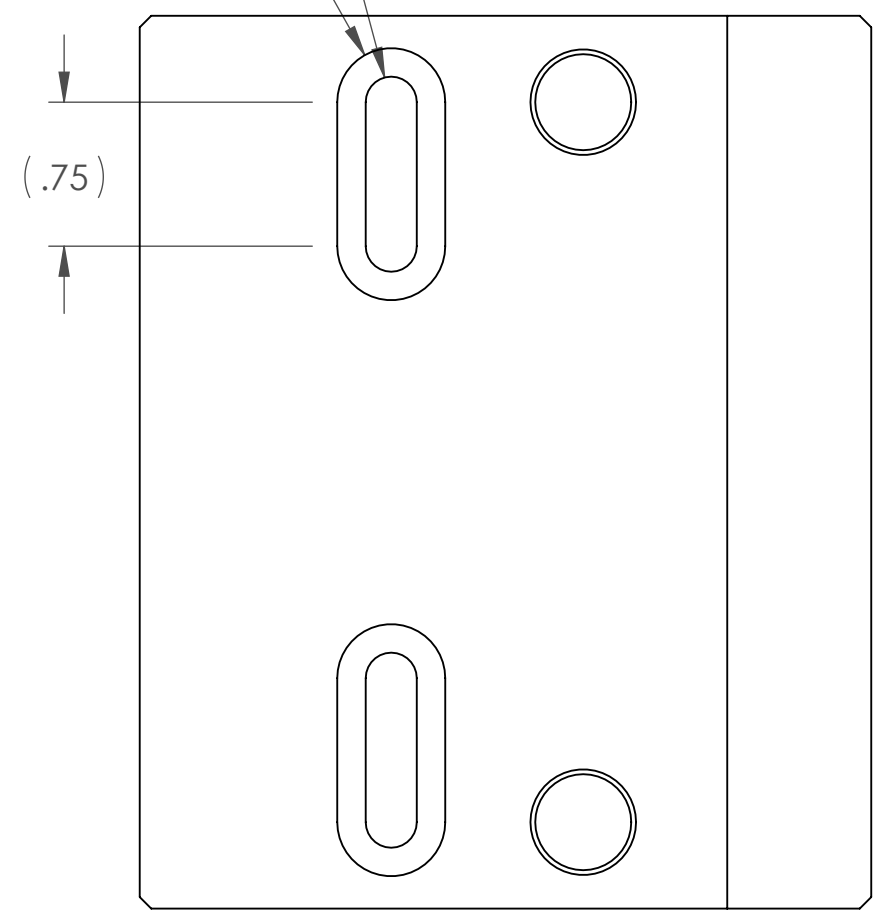
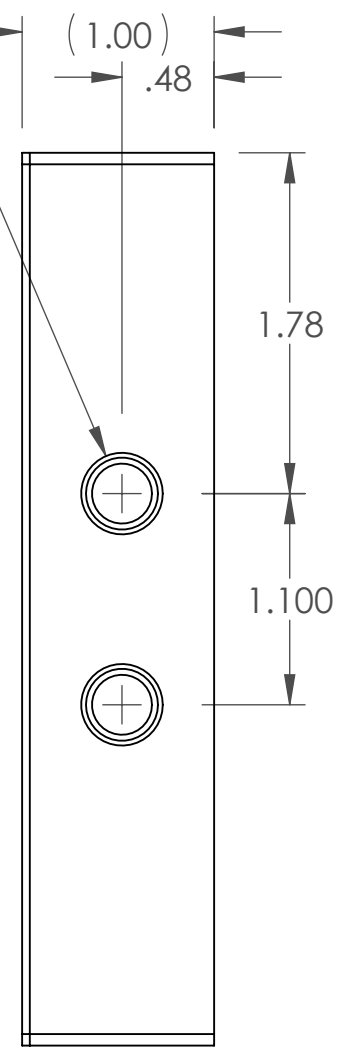
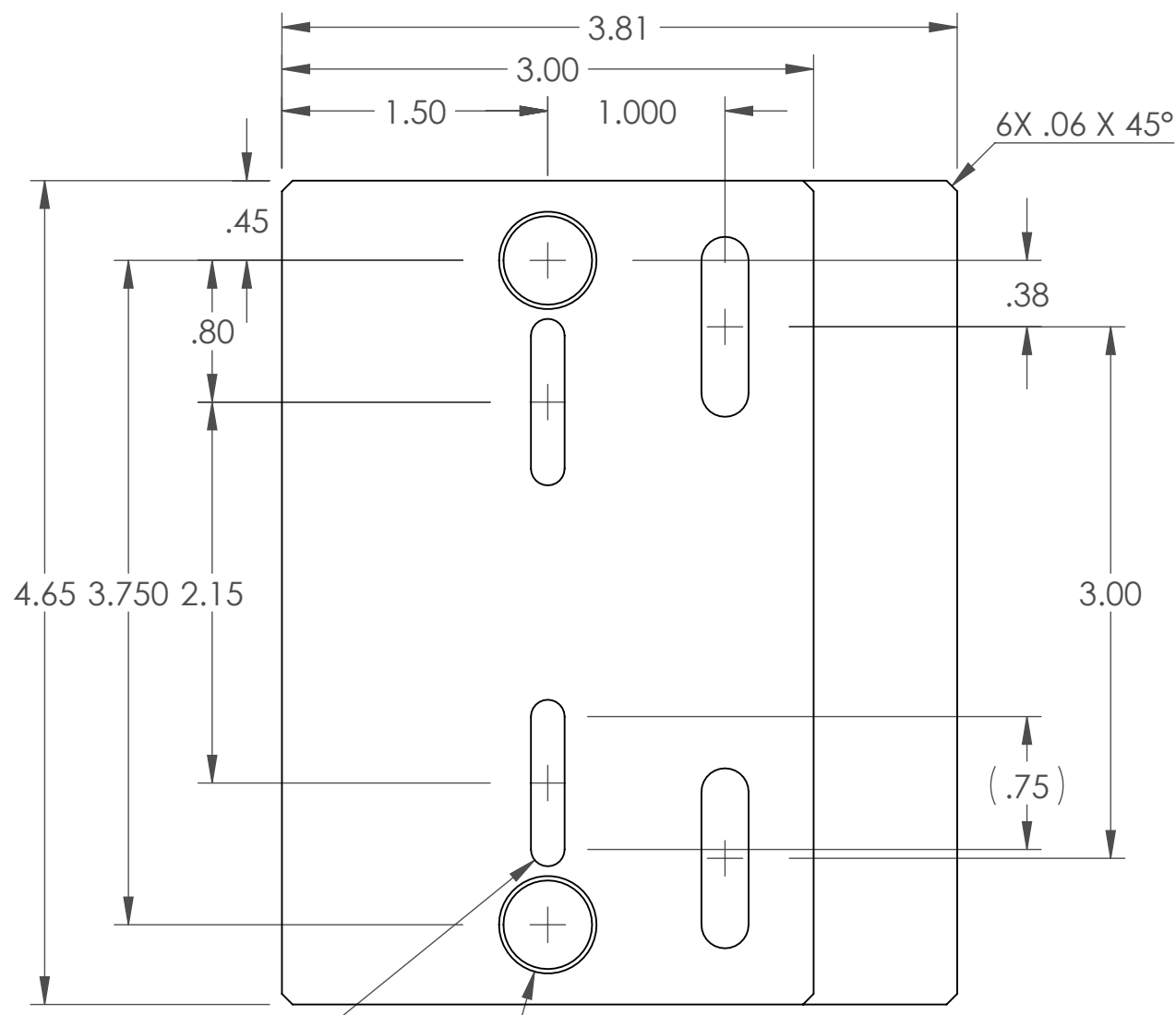

2X .190 X .75 SLOT,  $\nabla$  .23

2X 1/2-13 UNC - 2B, H11, THRU  
(.005 OVERSIZE) BOTH DRILL & TAP  
 $\nabla$  TO MAJOR  $\phi$  BOTH SIDES

NOTES AND TOLERANCES: (UNLESS OTHERWISE SPECIFIED)

- INTERPRET DRAWING PER ASME Y14.5-1994.
- REMOVE ALL SHARP EDGES, .03 MIN.
- DO NOT SCALE FROM DRAWING.

DIMENSIONS ARE IN INCHES

TOLERANCES:  
.XX  $\pm$  .01  
.XXX  $\pm$  .005  
ANGULAR  $\pm$  1.0°

MATERIAL	FINISH
6061-T6 Al	N/A

CALIFORNIA INSTITUTE OF TECHNOLOGY MASSACHUSETTS INSTITUTE OF TECHNOLOGY		PART NAME	
SYSTEM	SUB-SYSTEM	DESIGNER	R. SAVAGE
ADVANCED LIGO	AOS	DRAFTER	C. CONLEY
NEXT ASSY	D1201544	CHECKER	C. CONLEY
		APPROVAL	

PART NAME		gLIGO PCAL TOOLING, BEARING MOUNT	
DESIGNER	R. SAVAGE	DATE	19 OCT 2012
DRAFTER	C. CONLEY	DATE	21 DEC 2012
CHECKER		SIZE	B
APPROVAL		DWG. NO.	D1201414
		REV.	v2
SCALE: NONE		PROJECTION:	
		SHEET 1 OF 1	

D1201414 gLIGO Pcal Tooling, Bearing Mount, PART PDM REV: X-032, DRAWING PDM REV: X-008