

8 7 6 5 4 3 2 1

NOTES CONTINUED:
 ⑤ SCRIBE, ENGRAVE (A VIBRATORY TOOL MAY BE USED), LASER MARK OR MECHANICALLY STAMP (NO INKS OR DYES) DRAWING PART NUMBER, REVISION (AND VARIANT OR "TYPE" IF APPLICABLE) ON NOTED SURFACE OF PART FOLLOWED ON THE NEXT LINE WITH A THREE DIGIT SERIAL NUMBER. SERIAL NUMBERS START AT 001 FOR THE FIRST ARTICLE AND PROCEED CONSECUTIVELY. USE MINIMUM 0.12" HIGH CHARACTERS, UNLESS THE SIZE OF THE PART DICTATES SMALLER CHARACTERS. EXAMPLE: DXXXXXX-VY, TYPE-XX, S/N XXX

REV.	DATE	DCN #	BOM #
v1	22 AUG 2012	-	-
-	-	-	-
-	-	-	-

6. WEIGHT: 0.40 LB.

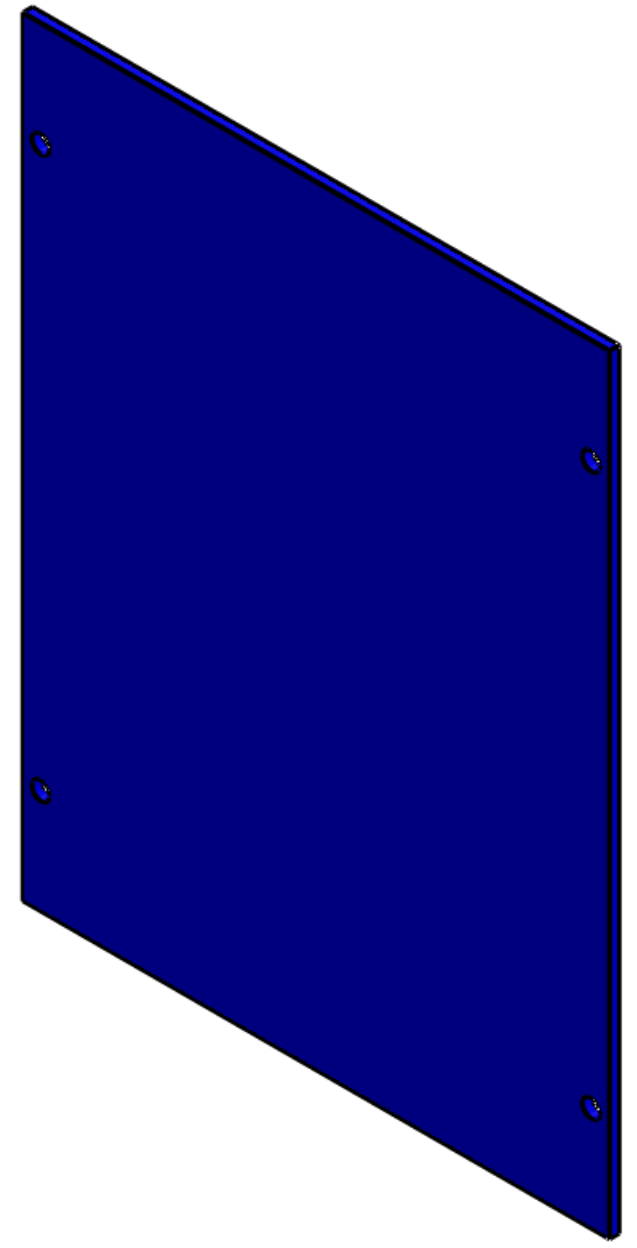
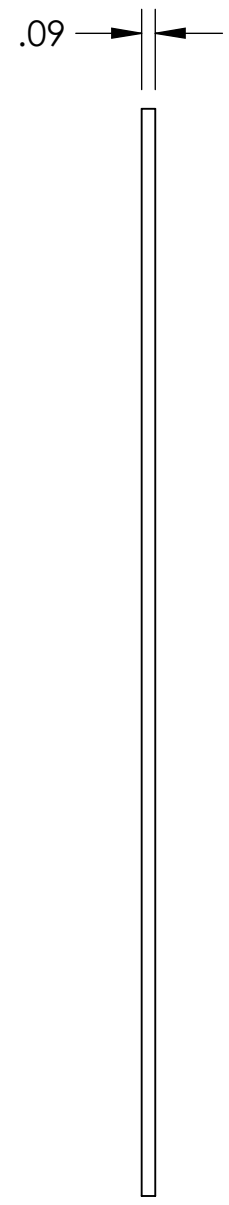
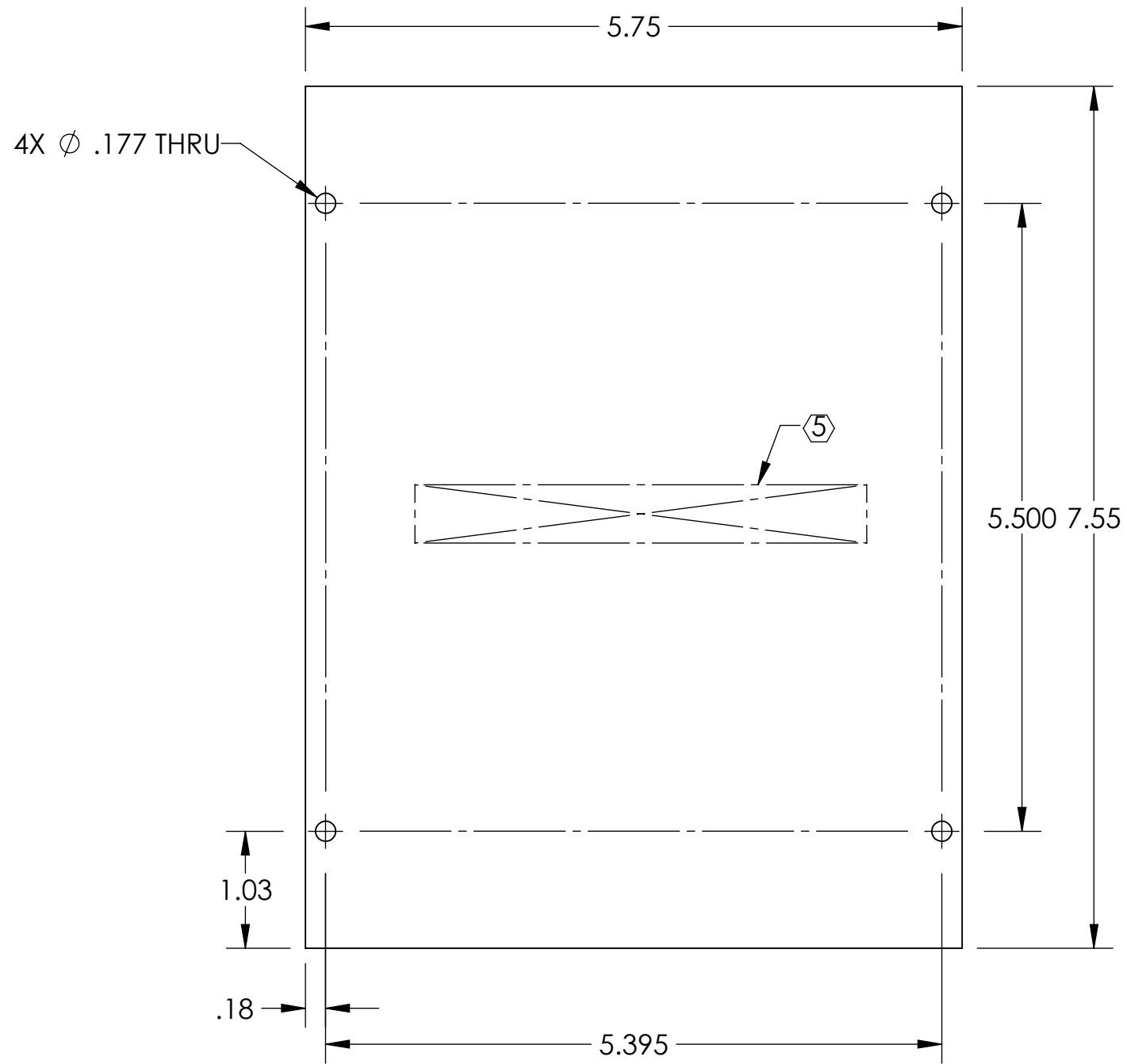

D1201174 aLIGO PCal 5in X 7in Mirror Storage Cover, PART PDM REV: X-002, DRAWING PDM REV: X-003

A

A

B

B

C

C

D

D

NOTES AND TOLERANCES: (UNLESS OTHERWISE SPECIFIED)				LIGO CALIFORNIA INSTITUTE OF TECHNOLOGY MASSACHUSETTS INSTITUTE OF TECHNOLOGY		PART NAME	
DIMENSIONS ARE IN INCHES				ADVANCED LIGO		aLIGO PCal 5" X 7" MIRROR STORAGE COVER	
TOLERANCES: .XX ± .01 .XXX ± .005				SUB-SYSTEM AOS		DESIGNER C. CONLEY 21 AUG 2012	
ANGULAR ± 0.1°				NEXT ASSY D1201175		DRAFTER C. CONLEY 22 AUG 2012	
MATERIAL 6061-T6 Al				FINISH N/A		CHECKER	
						APPROVAL	
						SIZE DWG. NO. B D1201174	
						REV. v1	
						SCALE: NONE PROJECTION: SHEET 1 OF 1	

8 7 6 5 4 3 2 1