

NOTES CONTINUED:

- 5. SCRIBE, ENGRAVE, LASER MARK OR MECHANICALLY STAMP (NO DYES OR INKS) A UNIQUE THREE DIGIT SERIAL NUMBER & REVISION NUMBER ON EACH PART. SERIAL NUMBERS START AT 001 FOR THE FIRST ARTICLE AND PROCEED CONSECUTIVELY. BAG AND TAG PARTS WITH THEIR DRAWING PART NUMBER, REVISION, VARIANT OR "TYPE" (IF APPLICABLE), AND QUANTITY, IF PARTS ARE TOO SMALL TO SCRIBE, BAGGING AND TAGGING ALONE IS SUFFICIENT.
EXAMPLE (PART): 001-v1
EXAMPLE (TAG): DXXXXXX-VY, TYPE-XX, QTY: TBD
- 6. PART TO BE MADE FROM STOCK VENTED 1" 1/4-20 UNC-2A BOLT.
UC Components part number C-2016

| REV. | DATE | DCN # | DRAWING TREE # |
|------|-------------|----------|----------------|
| v1 | 14 AUG 2012 | E1200756 | - |
| - | - | - | - |
| - | - | - | - |

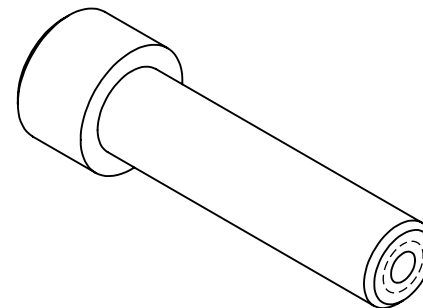

ISOMETRIC VIEW

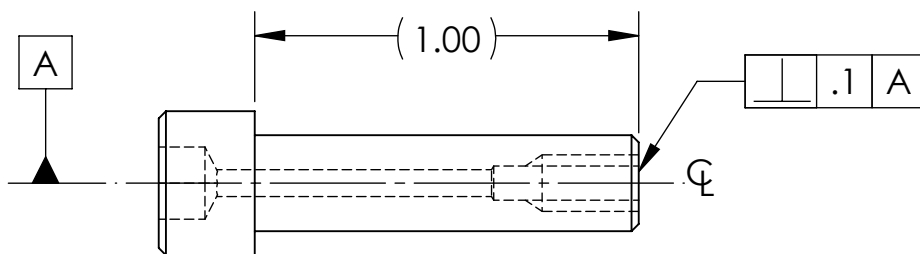

Ø .03/.07 VENT HOLE

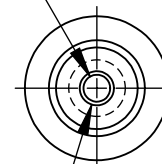

DRILL AND TAP FOR #4-40 ∇ .252
+.005 OVERSIZE TAP

NOTES AND TOLERANCES: (UNLESS OTHERWISE SPECIFIED)

DIMENSIONS ARE IN INCHES

TOLERANCES:
.XX ± .01
.XXX ± .005

ANGULAR ± 0.5°

- 1. INTERPRET DRAWING PER ASME Y14.5-1994.
- 2. REMOVE ALL SHARP EDGES .005-.015. FOR MACHINED PARTS. ROUND ALL EDGES APPROXIMATELY R.02 FOR SHEET METAL PARTS.
- 3. DO NOT SCALE FROM DRAWING.
- 4. ALL MACHINING FLUIDS MUST BE FULLY SYNTHETIC, FULLY WATER SOLUBLE AND FREE OF SULFUR, SILICONE, AND CHLORINE.

MATERIAL 304, 316 OR 302 SSSL **FINISH** 63 μ inch

LIGO CALIFORNIA INSTITUTE OF TECHNOLOGY
MASSACHUSETTS INSTITUTE OF TECHNOLOGY

SYSTEM ADVANCED LIGO **SUB-SYSTEM** SUS

NEXT ASSY D1201152

| | | | | | |
|---|-----------------|--|--------------------------------------|------------------------|--------------------|
| PART NAME EARTHQUAKE STOP ADJUSTER, SHORT, BS | | | DESIGNER LWLMUT 13 Dec. 2006 | SIZE DWG. NO. A | REV. v1 |
| DRAFTER B. MOORE 14 AUG 2012 | D1201151 | | CHECKER C. TORRIE 14 AUG 2012 | SCALE: 2:1 | PROJECTION: |
| APPROVAL | SHEET 1 OF 1 | | | | |