

NOTES CONTINUED:
 5) SCRIBE, ENGRAVE (A VIBRATORY TOOL MAY BE USED), LASER MARK OR MECHANICALLY STAMP (NO INKS OR DYES) DRAWING PART NUMBER, REVISION (AND VARIANT OR "TYPE" IF APPLICABLE) ON NOTED SURFACE OF PART FOLLOWED ON THE NEXT LINE WITH A THREE DIGIT SERIAL NUMBER. SERIAL NUMBERS START AT 001 FOR THE FIRST ARTICLE AND PROCEED CONSECUTIVELY. USE MINIMUM 0.12" HIGH CHARACTERS, UNLESS THE SIZE OF THE PART DICTATES SMALLER CHARACTERS. EXAMPLE: DXXXXXX-VY, TYPE-XX, S/N XXX

- 6 APPROXIMATE WEIGHT = 11.334 LB
- 7 MACHINE ALL SURFACES TO REMOVE OXIDES AND MILL FINISH. USE OF ABRASIVE REMOVAL TECHNIQUES IS NOT ALLOWED. REFER TO LIGO-E0900364
- 8 ALL PARTS SHALL BE MANUFACTURED IN ACCORDANCE WITH LIGO SPECIFICATION E0900364.
- 9 ALL HELI-COIL HOLES TO BE PREPARED ACCORDING TO EMHART HELI-COIL PRODUCT CATALOG, HC2000, REV 4
- 10 ALL HELI-COIL INSERTS TO BE INSTALLED BY LIGO PERSONNEL. AFTER DELIVERY OF FINISHED PARTS, USE NITRONIC 60 THREADED INSERTS.
- 11 ALL MATERIAL IS TO BE VIRGIN MATERIAL (i.e. NO WELD REPAIRS, PLUGS OR RECYCLED MATERIAL). NO REPAIRS SHALL BE MADE UNLESS APPROVED IN ADVANCE, AND IN WRITING, BY LIGO LABORATORY. REFER TO LIGO-E0900364.

12) (LAMBDA/10) FINISH FOR 10.6 um LASER
 99% REFLECTIVITY
 20-10 SCRATCH-DIG
 HARD GOLD COATING

REV.	DATE	DCN #	DRAWING TREE #
v1	06-MAR-12	E1200002-v1	E1200003-v1
v2	09-JAN-2013	E1300022-x0	E1200929-v1
-	-	-	-

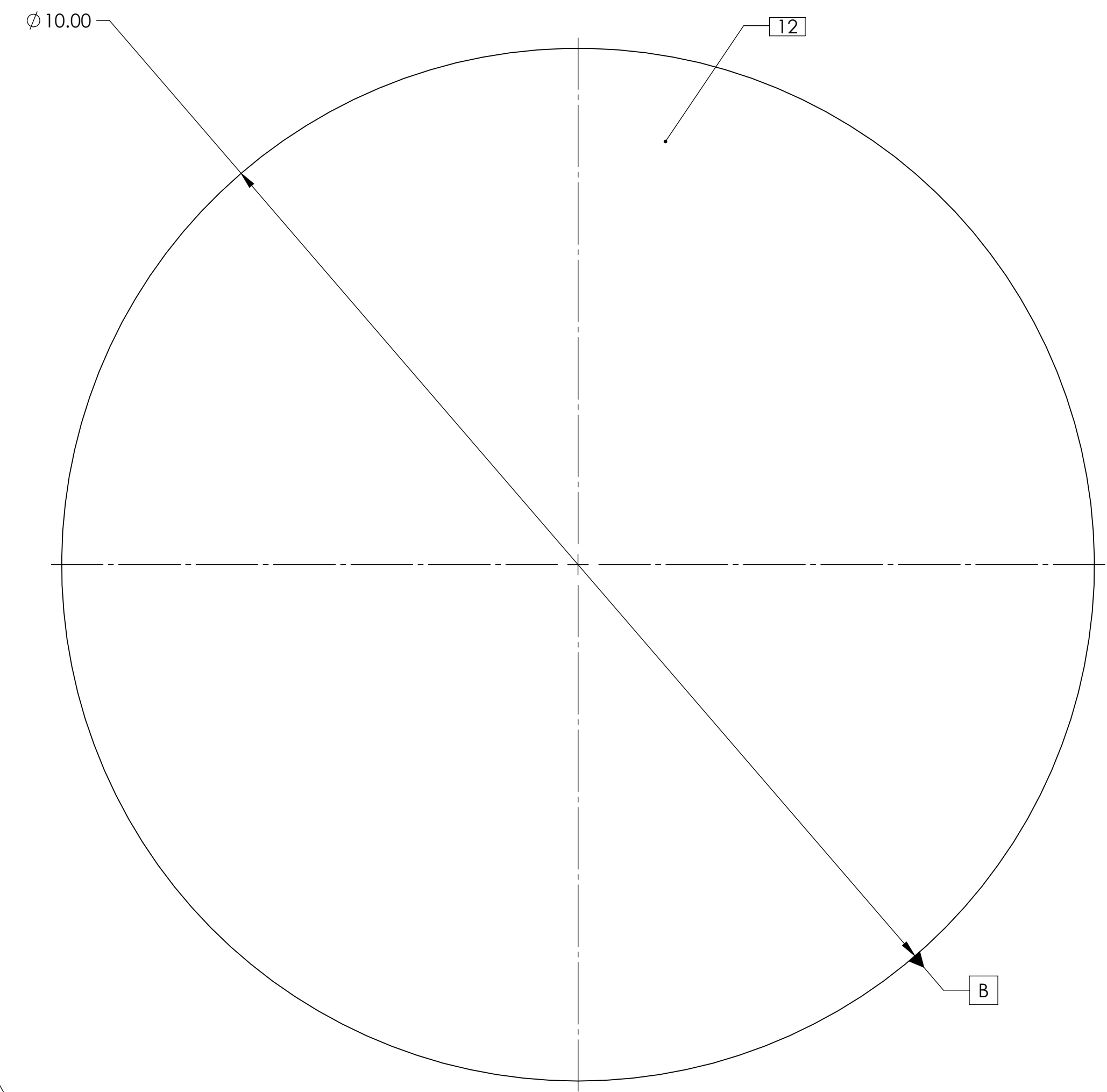
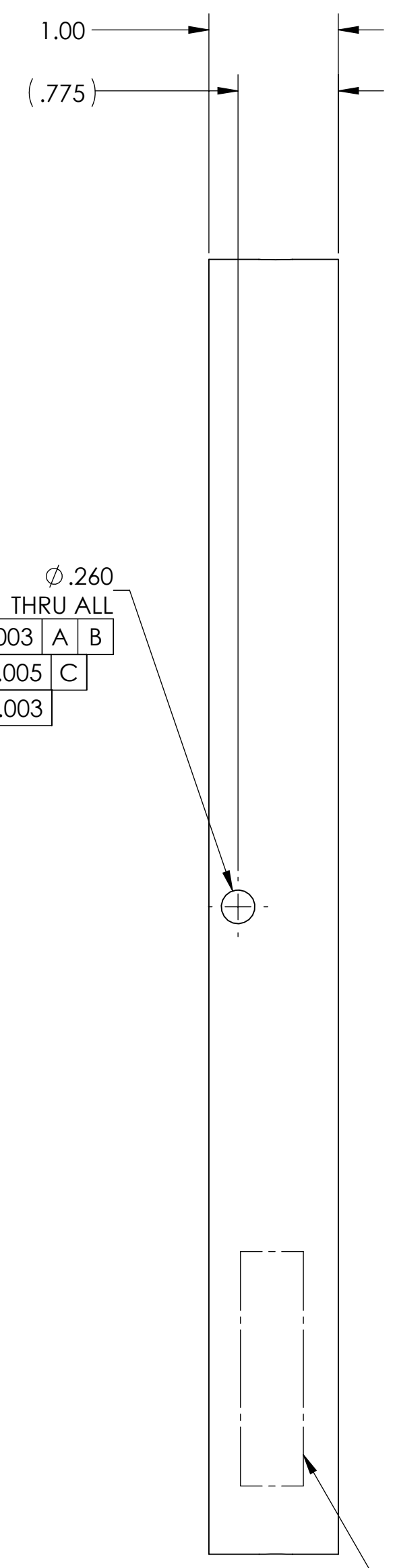
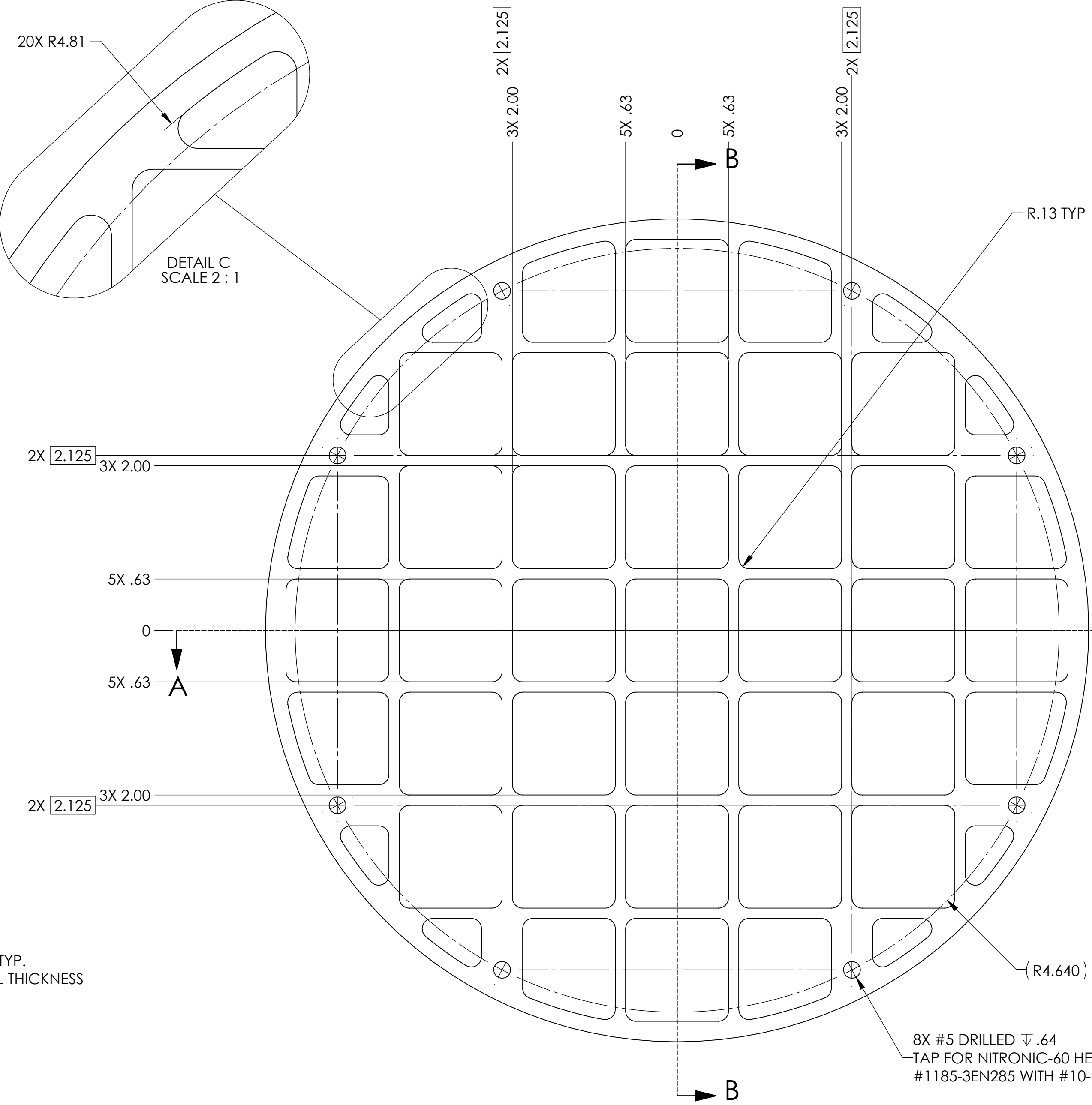
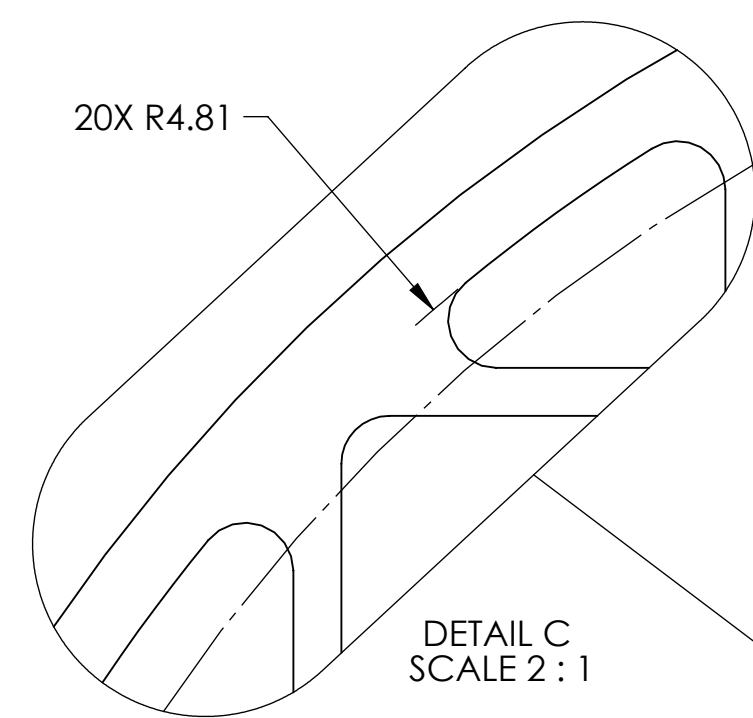
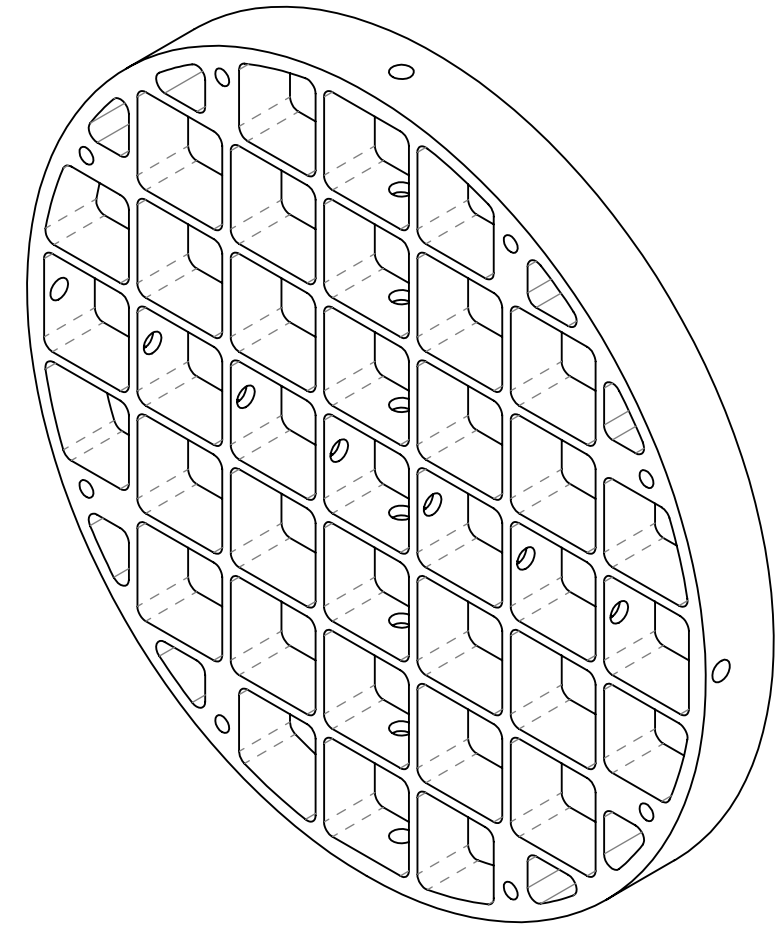
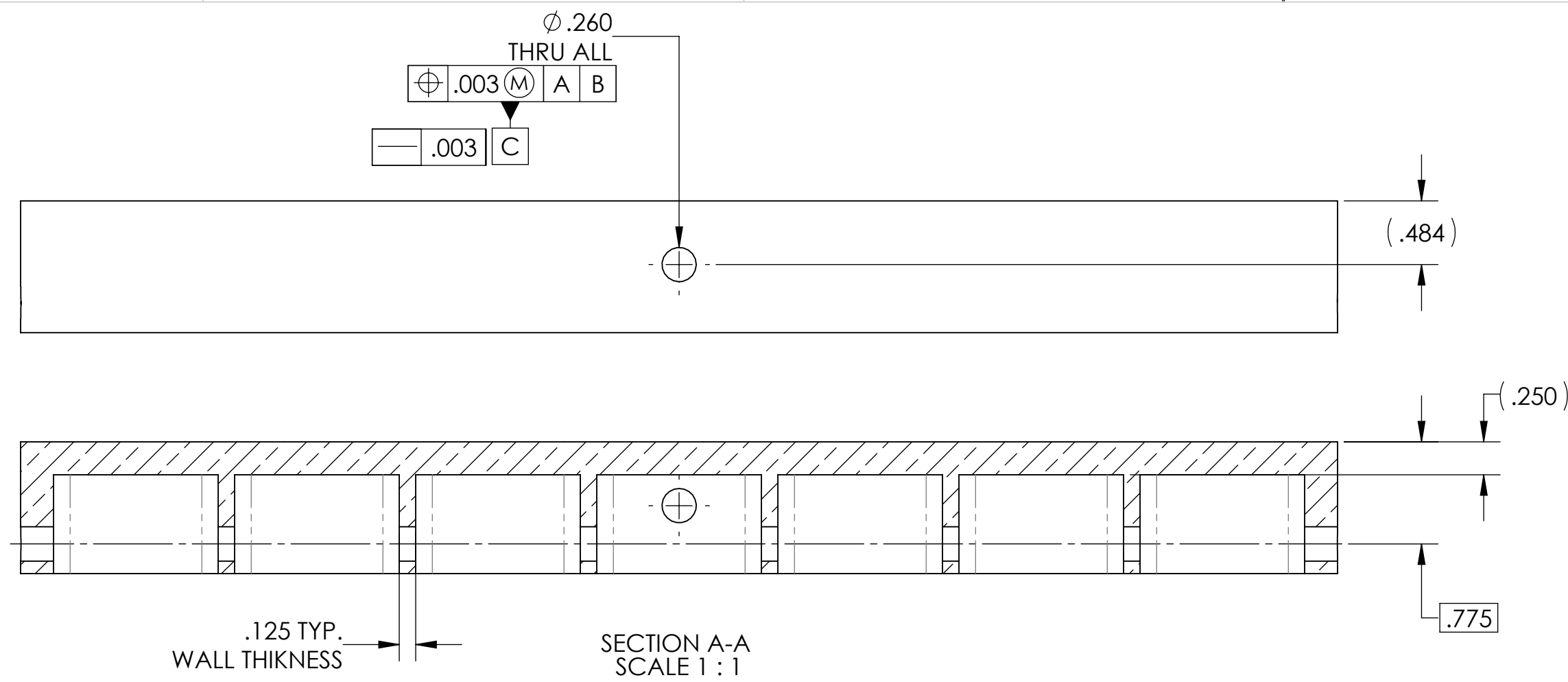

SECTION B-B

NOTES AND TOLERANCES: (UNLESS OTHERWISE SPECIFIED)

- INTERPRET DRAWING PER ASME Y14.5-1994.
- REMOVE ALL SHARP EDGES, .005-.015, FOR MACHINED PARTS.
- DO NOT SCALE FROM DRAWING.
- ALL MACHINING FLUIDS MUST BE FULLY SYNTHETIC, FULLY WATER SOLUBLE AND FREE OF SULFUR, SILICONE, AND CHLORINE.

DIMENSIONS ARE IN INCHES

TOLERANCES:
 .XX ± .01
 .XXX ± .005

ANGULAR ± 1.0°

MATERIAL	FINISH
Cu, 110 Alloy	63 μinch

LIGO CALIFORNIA INSTITUTE OF TECHNOLOGY
 MASSACHUSETTS INSTITUTE OF TECHNOLOGY

SYSTEM: ADVANCED LIGO SUB-SYSTEM: AOS

NEXT ASSY: D1101851-1, D1101851-2

PART NAME: TCS CO2P STEERING MIRROR 2, H1-L1			
DESIGNER	M. JACOBSON	08 DEC 2011	SIZE DWG. NO.
DRAFTER	M. JACOBSON	05-MAR-12	D
CHECKER	J.LEWIS	09-JAN-13	D1102171
APPROVAL	A. HEPTONSTALL	05-MAR-12	SCALE: 1:1
PROJECTION:		SHEET 1 OF 1	

D1102171_LIGO_TCS_CO2P_STEERING_MIRROR_2_H1-L1_PART_PDM_REV-X.021_DRAWING_PDM_REV-X.018