

D1102119\_Advanced\_LIGO\_SUS\_HXTS\_Blade\_Pulldown\_Support, PART PDM REV., DRAWING PDM REV:

REV.	DATE	DCN #	DRAWING TREE #
v1	24 OCT 2011	E1101054	-
-	-	-	-
-	-	-	-

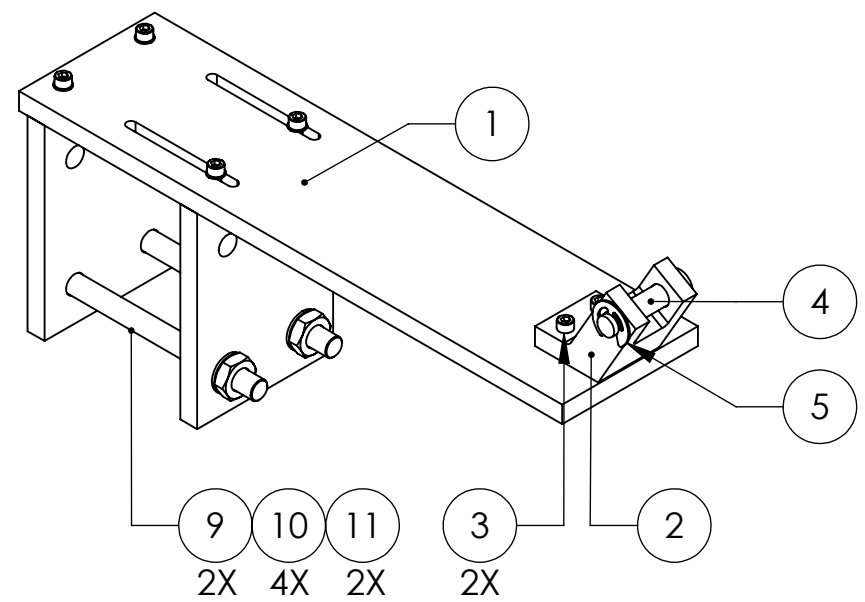

HLTS CONFIGURATION

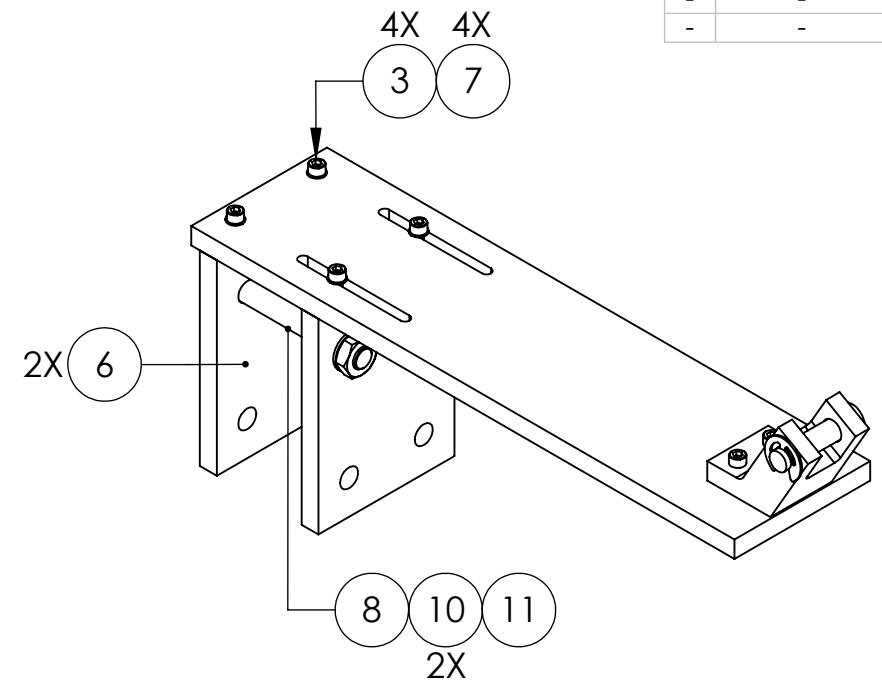

HSTS CONFIGURATION

ITEM NO.	PART NUMBER	DESCRIPTION	MATERIAL	REQ	SPARE	TOTAL
11	-	JAM NUT, 1/4-20	300 SSSL	2	1	3
10	-	WASHER, FLAT, VENTED, 1/4 (U-C COMPONENTS P/N WFV-25 OR EQUIVALENT)	300 SSSL	4	1	5
9	-	SCREW, SOCKET HEAD CAP, 1/4-20 UNC-2A X 3 LONG	300 SSSL	2	1	3
8	-	SCREW, SOCKET HEAD CAP, 1/4-20 UNC-2A X 2 LONG	300 SSSL	1	1	2
7	-	WASHER, FLAT, VENTED, #4 (U-C COMPONENTS P/N WFV-04 OR EQUIVALENT)	300 SSSL	4	1	5
6	D1102125	CLAMP, BLADE PULLDOWN SUPPORT	6061-T6 Al	2	0	2
5	98408A120	RETAINING RING (MCMaster-CARR P/N)	300 SSSL	1	1	2
4	92735A230	CLEVIS PIN (MCMaster-CARR P/N)	300 SSSL	1	1	2
3	-	SCREW, SOCKET HEAD CAP, #4-40 UNC-2A X 0.5 LONG	300 SSSL	6	2	8
2	D0900563	PIN SUPPORT, WIRE JIG	6061-T6 Al	1	0	1
1	D1102124	MAIN BODY, BLADE PULLDOWN SUPPORT	6061-T6 Al	1	0	1

PARTS LIST

NOTES AND TOLERANCES: (UNLESS OTHERWISE SPECIFIED)

MATERIAL: N/A  
FINISH: N/A μinch

**LIGO** CALIFORNIA INSTITUTE OF TECHNOLOGY  
MASSACHUSETTS INSTITUTE OF TECHNOLOGY  
SYSTEM: ADVANCED LIGO SUB-SYSTEM: SUS  
NEXT ASSY: MULTIPLE ASSYS

PART NAME: BLADE PULLDOWN SUPPORT, HAM TRIPLE  
DESIGNER: D. BRIDGES 01 NOV 2011  
DRAFTER: D. BRIDGES 01 NOV 2011  
CHECKER: B. MOORE 01 NOV 2011  
APPROVAL: [Signature]  
SIZE: B DWG. NO.: D1102119 REV.: v1  
SCALE: 1:2 PROJECTION: [Symbol] SHEET 1 OF 1

8 7 6 5 4 3 2 1

D C B A