

REV.	DATE	DCN #	DRAWING TREE #
V4	30 AUG 2012	E1200796	-
V5	11 SEP 2012	E1200819	-
-	-	-	-

SOCKET IS WELDED INTO THE BODY AND IS NOT REMOVABLE

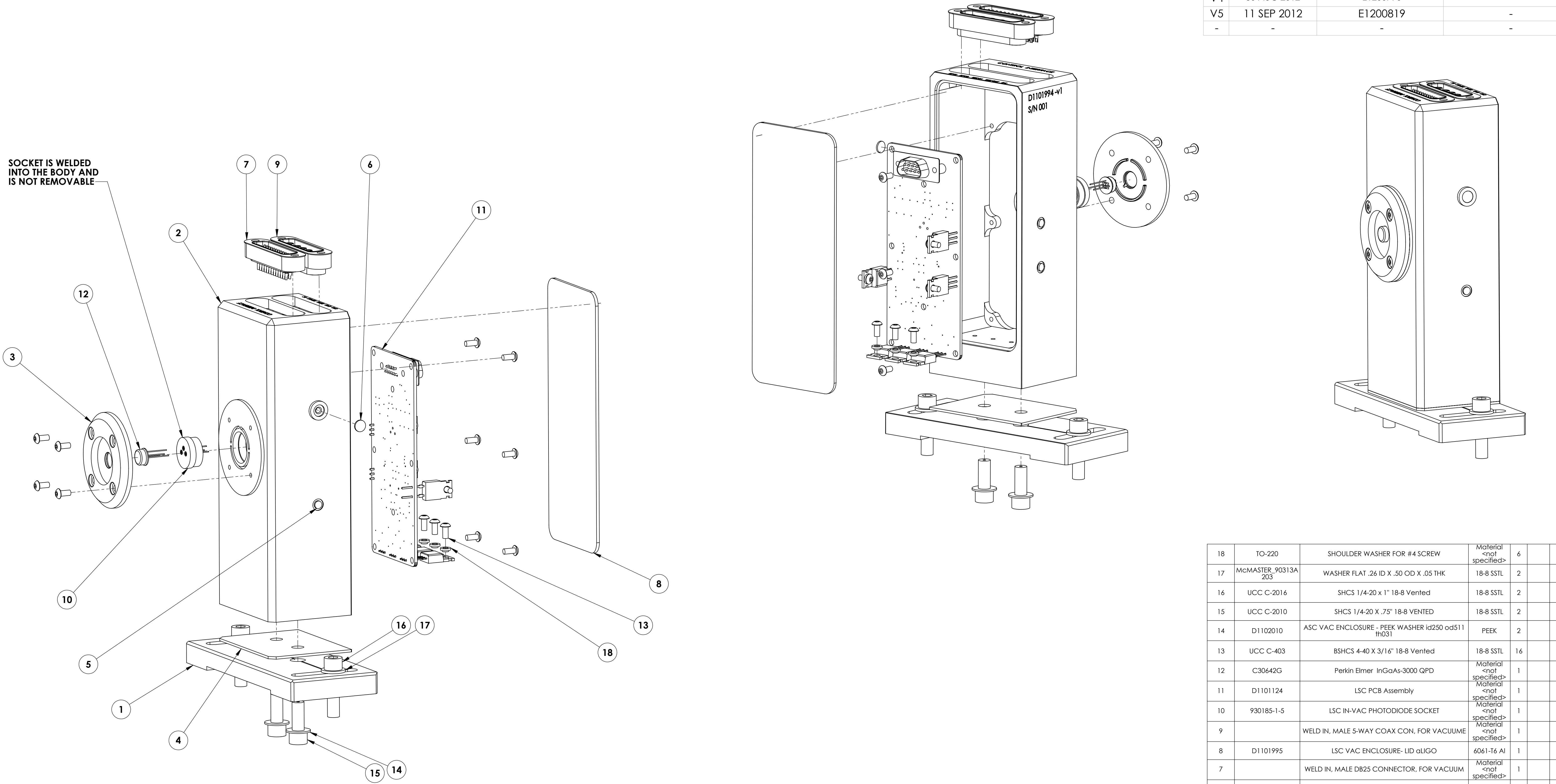

ITEM NO.	PART NUMBER	DESCRIPTION	MATERIAL	REQ	SPARE	TOTAL
18	TO-220	SHOULDER WASHER FOR #4 SCREW	Material <not specified>	6		6
17	McMASTER_90313A_203	WASHER FLAT .26 ID X .50 OD X .05 THK	18-8 SSSL	2		2
16	UCC C-2016	SHCS 1/4-20 x 1" 18-8 Vented	18-8 SSSL	2		2
15	UCC C-2010	SHCS 1/4-20 X .75" 18-8 VENTED	18-8 SSSL	2		2
14	D1102010	ASC VAC ENCLOSURE - PEEK WASHER id250 od511 th031	PEEK	2		2
13	UCC C-403	BSHCS 4-40 X 3/16" 18-8 Vented	18-8 SSSL	16		16
12	C30642G	Perkin Elmer InGaAs-3000 QPD	Material <not specified>	1		1
11	D1101124	LSC PCB Assembly	Material <not specified>	1		1
10	930185-1-5	LSC IN-VAC PHOTODIODE SOCKET	Material <not specified>	1		1
9		WELD IN, MALE 5-WAY COAX CON, FOR VACUUME	Material <not specified>	1		1
8	D1101995	LSC VAC ENCLOSURE- LID αLIGO	6061-T6 Al	1		1
7		WELD IN, MALE DB25 CONNECTOR, FOR VACUUM	Material <not specified>	1		1
6		WELD PLUG, FILL PORT, GAS	6061-T6 Al	1		1
5		WELD PLUG, TAPPED HOLES	6061-T6 Al	6		6
4	D1101997	LSC VAC ENCLOSURE - alumina spacer αLIGO	ALUMINA	1		1
3	D1101996	LSC VAC Enclosure - photo hood mount αLIGO	6061-T6 Al	1		1
2	D1101994	LSC IN VAC ENCLOSURE-MAIN BODY αLIGO	6061-T6 Al	1		1
1	D1101993	LSC VAC Enclosure - base αLIGO	6061-T6 Al	1		1

NOTES AND TOLERANCES: (UNLESS OTHERWISE SPECIFIED)

DIMENSIONS ARE IN INCHES

MATERIAL	FINISH	NEXT ASSY
	μinch	HAM1 HAM6

LIGO CALIFORNIA INSTITUTE OF TECHNOLOGY MASSACHUSETTS INSTITUTE OF TECHNOLOGY

SYSTEM: ADVANCED LIGO SUB-SYSTEM: ISC

PART NAME: LSC VAC ENCLOSURE - TOP ASSEMBLY αLIGO

DESIGNER: EBROWN 7 MAY 2012 SIZE: DWG. NO. D1101992 REV. v5

DRAFTER: SBARNUM 11 SEP 2012

CHECKER: RABBOIT

APPROVAL: PFRITSCHL

SCALE: 1:1 PROJECTION: SHEET 1 OF 1

D1101992 LSC VAC ENCLOSURE - TOP ASSEMBLY αLIGO PART PDM REV. X-000 DRAWING PDM REV. X-000