

D1101876- custom length aluminum alignment rod, PART PDM REV: X-000, DRAWING PDM REV: X-001

8 7 6 5 4 3 2 1

REV.	DATE	DCN #	DRAWING TREE #
-	-	-	-
-	-	-	-
-	-	-	-

D

D

C

C

B

B

A

A

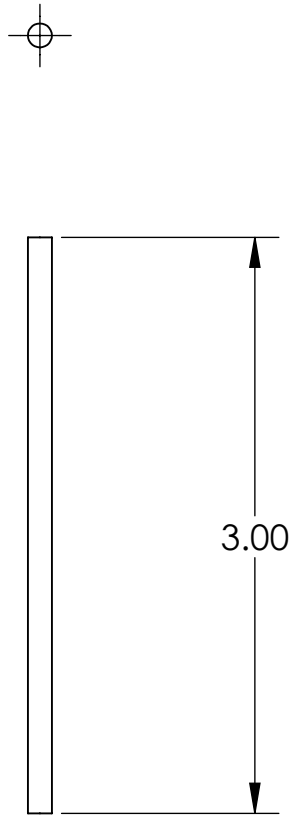

NOTE: Start with McMaster-Carr part# 9062K243, tight tolerance, precision ground, 1/8" diameter aluminum rod. Cut to specified length.

NOTES AND TOLERANCES: (UNLESS OTHERWISE SPECIFIED)				LIGO CALIFORNIA INSTITUTE OF TECHNOLOGY MASSACHUSETTS INSTITUTE OF TECHNOLOGY		PART NAME	
DIMENSIONS ARE IN		1. INTERPRET DRAWING PER ASME Y14.5-1994. 2. REMOVE ALL SHARP EDGES, R.02 MIN. 3. DO NOT SCALE FROM DRAWING. 4. ALL MACHINING FLUIDS MUST BE FULLY SYNTHETIC, FULLY WATER SOLUBLE AND FREE OF SULFUR, SILICONE, AND CHLORINE.		SYSTEM	ISC	SUB-SYSTEM	custom length alignment rod
TOLERANCES:		MATERIAL		NEXT ASSY		DESIGNER	S WALDMAN
.XX ± .01		McMaster part 9062K243		D1100642		DRAFTER	S FOLEY
.XXX ± .005		FINISH				CHECKER	NOV 9 2011
ANGULAR ± *		μinch				APPROVAL	
						SIZE	DWG. NO.
						B	D1101876
						SCALE	1:1
						PROJECTION:	1st Angle
						SHEET 1 OF 1	
						REV. v1	

8 7 6 5 4 3 2 1