

NOTES CONTINUED:  
 5. SEE SHEETS 2 AND 3 FOR LAYOUT DIMENSIONS  
 6. ALL DIMENSIONS ARE WRT HAM4 0.0,0 LOCAL CS.  
 7. #8-32 TORQUE TO 20 in-lb, MAX  
 8. 1/4-20 TORQUE TO 65 in-lb, MAX

REV.	DATE	DCN #	DRAWING TREE #
v1	02-MAY-12	E1100986-v1	E1100987-v1
v4	29 NOV 2017	E1700400-x0	-
v5	22 OCT 2019	E1900331-x0	-

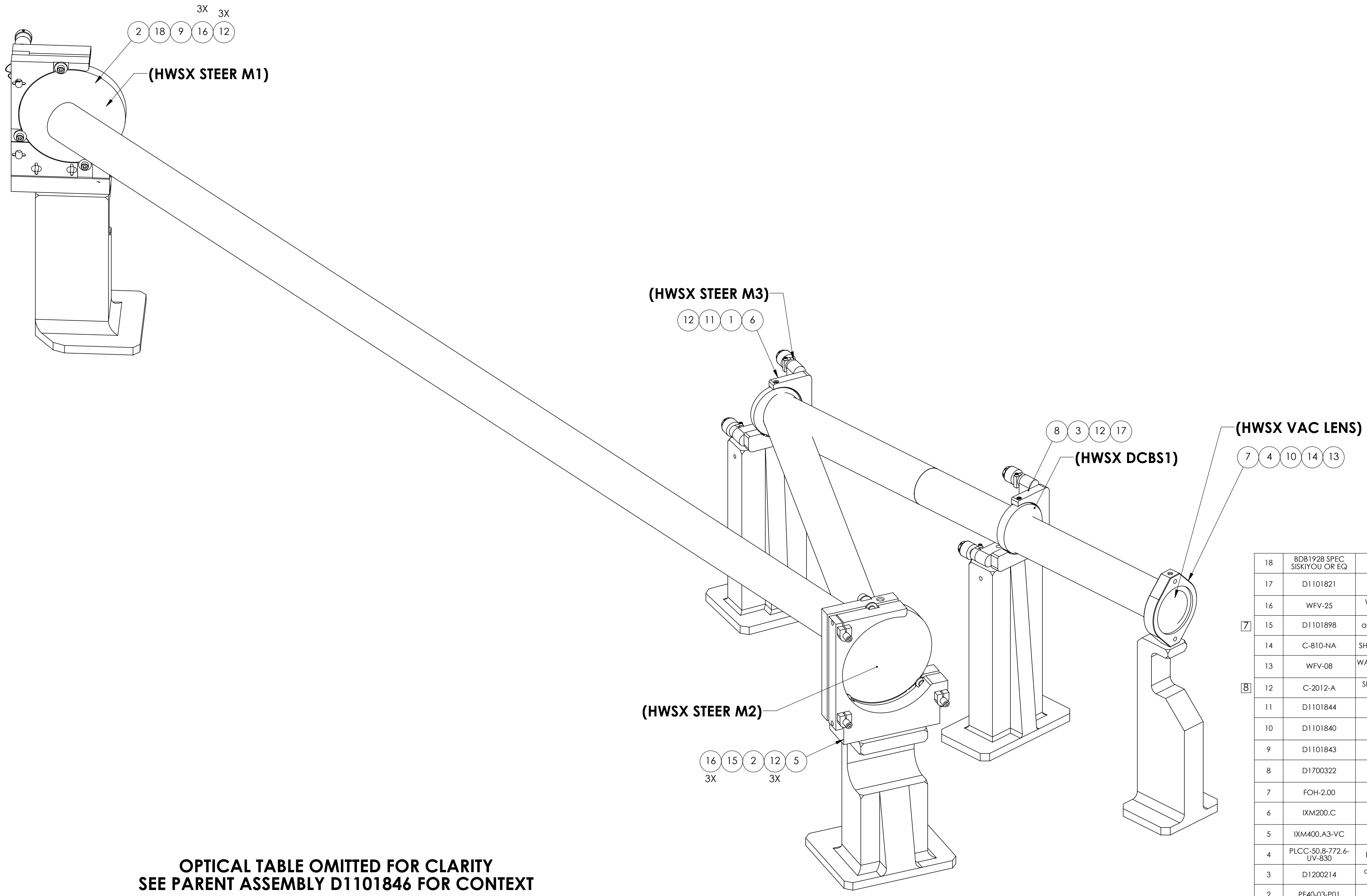

ITEM NO.	PART NUMBER	DESCRIPTION	MATERIAL	REQ	SPARE	TOTAL
18	BDB1928 SPEC SISKIYOU OR EQ	LIGO 4IN OPTIC MOUNT.SISKIYOU	6061 Alloy	1		1
17	D1101821	αLIGO, PEDESTAL, 2IN MIRROR MOUNT (7.567in)	6061 Alloy	1	-	1
16	WFV-25	WASHER, VENTED FLAT, .255 ID X .468 OD X .031TK. UC-COMPONENTS	Stainless Steel (ferritic)	5	2	7
15	D1101898	αLIGO PEDESTAL HAM4 HWSX-M2 4IN MIRROR MOUNT	6061 Alloy	1	0	1
14	C-810-NA	SHCS 8-32 X .625 LONG, SILVER PLATED, UC-COMPONENTS	18-8 SSTL, Au PLT	1	2	3
13	WFV-08	WASHER, VENTED FLAT, #8 .169ID X .304OD X .032THK. UC-COMPONENTS	Alloy Steel (SS)	1	2	3
12	C-2012-A	SHCS, 1/4-20 UNC-2A X 3/4LG, VENTED, SILVER PLATED. UC-COMPONENTS	18-8 SSTL, Au PLT	7	3	10
11	D1101844	αLIGO, PEDESTAL, 2IN MIRROR MOUNT (7.331in)	6061 Alloy	1	0	1
10	D1101840	αLIGO PEDESTAL HWSX 2IN OPTIC MOUNT	6061 Alloy	1	0	1
9	D1101843	αLIGO, PEDESTAL HAM4 HWSX 4IN MIRROR MOUNT	6061 Alloy	1		1
8	D1700322	MIRROR MOUNT, 2" (SISKIYOU IXM200.C3)	Material <not specified>	1		1
7	FOH-2.00	FIXED OPTIC HOLDER. SISKIYOU	6061 ALLOY	1	0	1
6	IXM200.C	MOUNT, 100TPI, 2IN OPTIC CUTAWAY,RH. SISKIYOU	6061 Alloy	1	0	1
5	IXM400.A3-VC	LIGO 4IN OPTIC MOUNT.SISKIYOU	6061 Alloy	1	0	1
4	PLCC-50.8-772.6-UV-830	LASER QUALITY_CONCAVE LENSE. CVI MELLES GRIOT	Glass	1	0	1
3	D1200214	αLIGO TCS HWS DICHOIC BEAM SPLITTER. PRECISION PHOTONICS	Glass	1	0	1
2	PF40-03-P01	4IN METALLIC MIRROR, THORLABS	N-BK7 w-PROT. AU PLT	2	0	2
1	PF20-03-P01-10	2IN METALLIC MIRROR, THORLABS	N-BK7 w-PROT. AU PLT	1	0	1
PARTS LIST						

**OPTICAL TABLE OMITTED FOR CLARITY  
 SEE PARENT ASSEMBLY D1101846 FOR CONTEXT**

NOTES AND TOLERANCES: (UNLESS OTHERWISE SPECIFIED)	
1. INTERPRET DRAWING PER ASME Y14.5-1994. 2. REMOVE ALL SHARP EDGES, .005-.015, FOR MACHINED PARTS. 3. DO NOT SCALE FROM DRAWING. 4. ALL MACHINING FLUIDS MUST BE FULLY SYNTHETIC, FULLY WATER SOLUBLE AND FREE OF SULFUR, SILICONE, AND CHLORINE.	
DIMENSIONS ARE IN INCHES  TOLERANCES: .XX ± .01 .XXX ± .005  ANGULAR ± 1.0°	MATERIAL N/A  FINISH N/A μinch

<b>LIGO</b> CALIFORNIA INSTITUTE OF TECHNOLOGY MASSACHUSETTS INSTITUTE OF TECHNOLOGY		PART NAME <b>αLIGO TCS HWS OPTO MECHANICAL LAYOUT, ITMX, L1</b>			
SYSTEM <b>ADVANCED LIGO</b>	SUB-SYSTEM <b>AOS</b>	DESIGNER A. BROOKS	DATE 02 DEC 2010	SIZE <b>D</b>	DWG. NO. <b>D1101847</b>
NEXT ASSY <b>D1101846</b>	FINISH N/A μinch	CHECKER M. JACOBSON	DATE 07-FEB-13	SCALE 1:4	PROJECTION FIRST ANGLE
		APPROVAL A. BROOKS	DATE 07-FEB-13	SHEET 1 OF 3	REV. <b>v5</b>

8

7

6

5

4

3

2

1

H

H

G

G

F

F

E

E

D

D

C

C

B

B

A

A

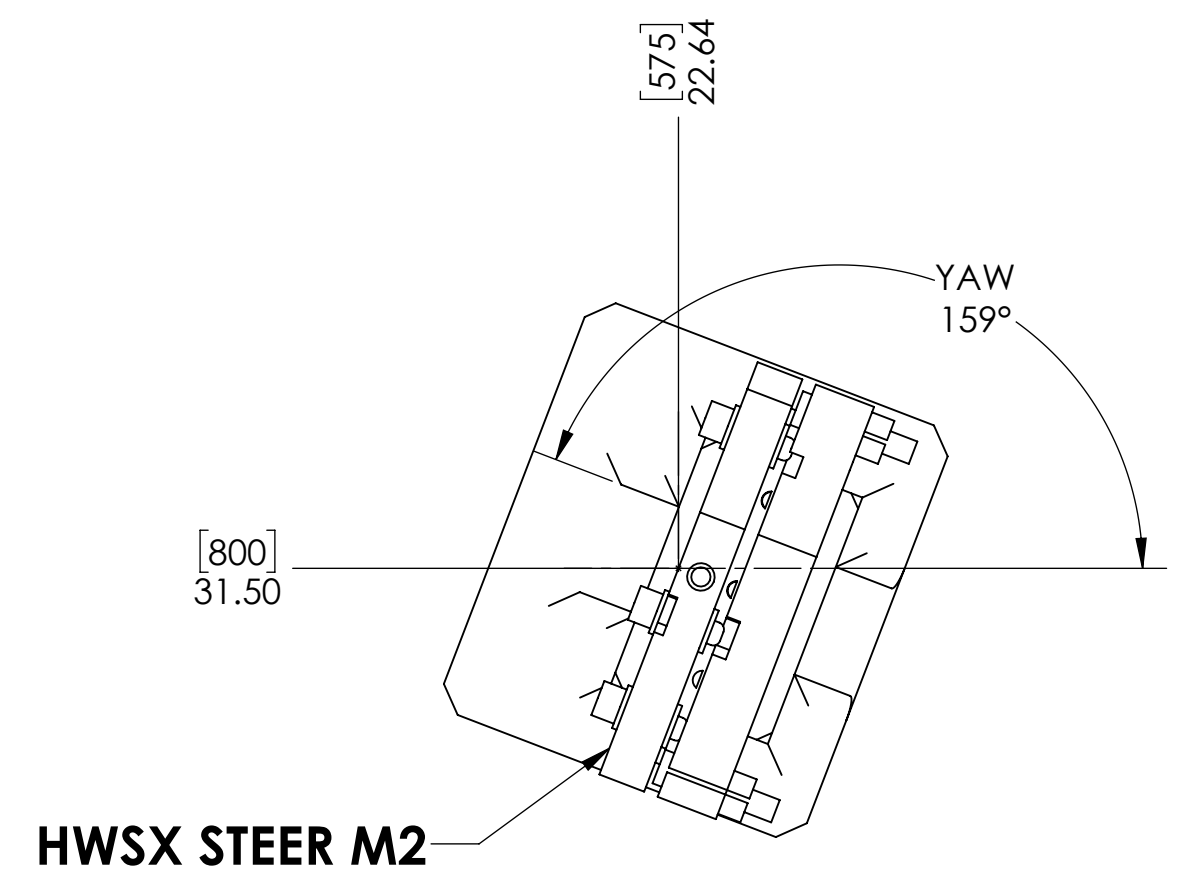
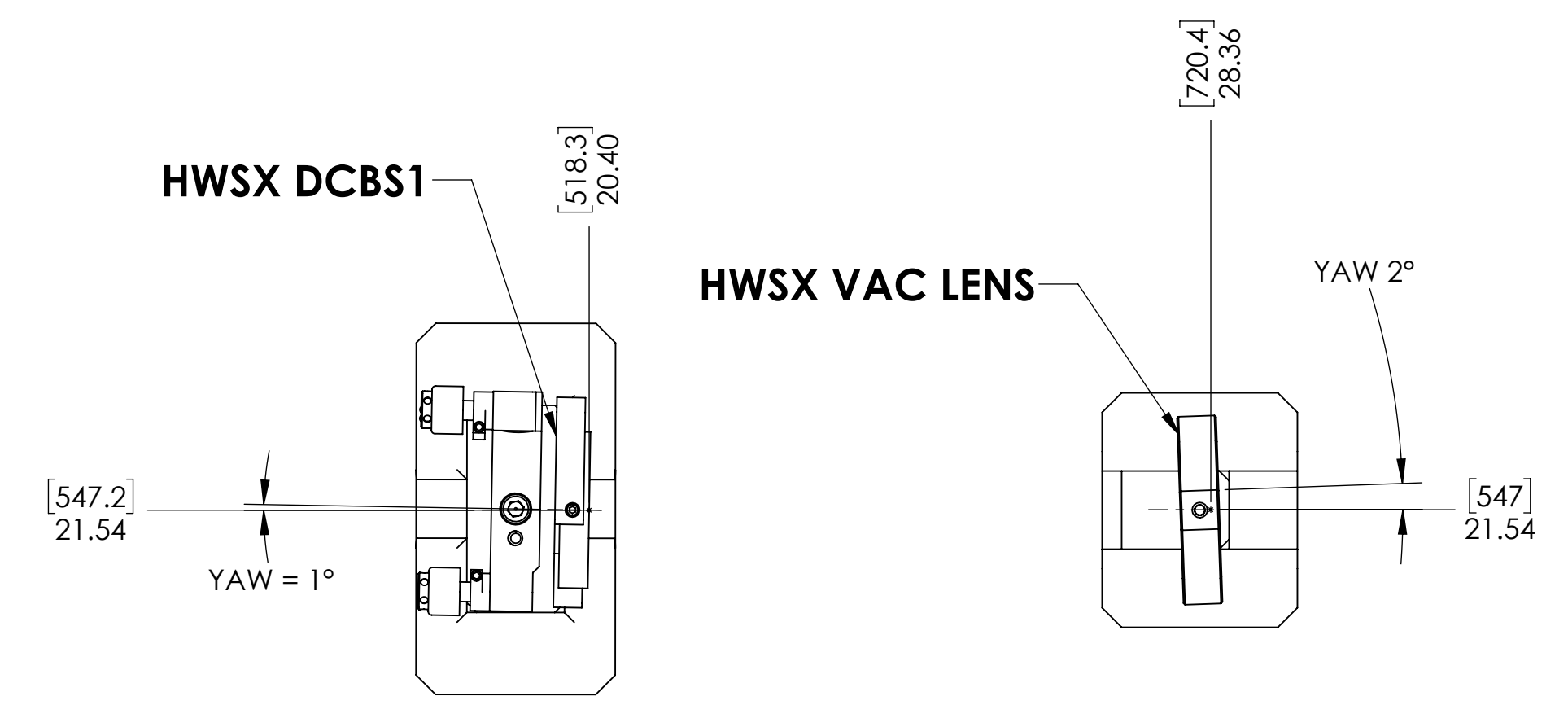
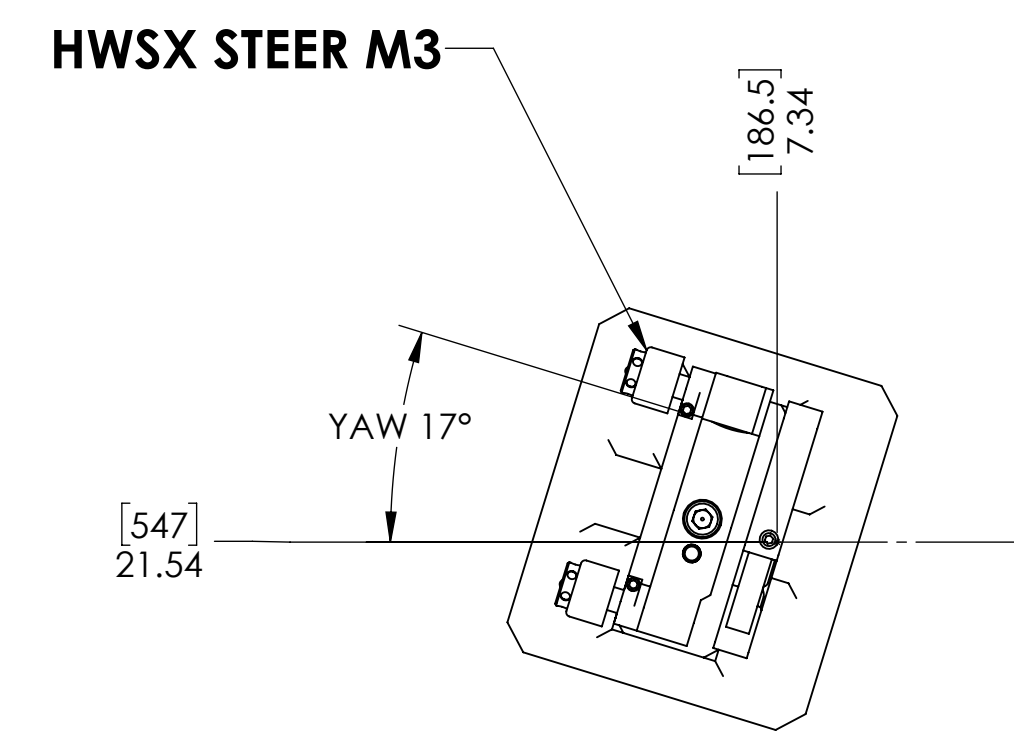
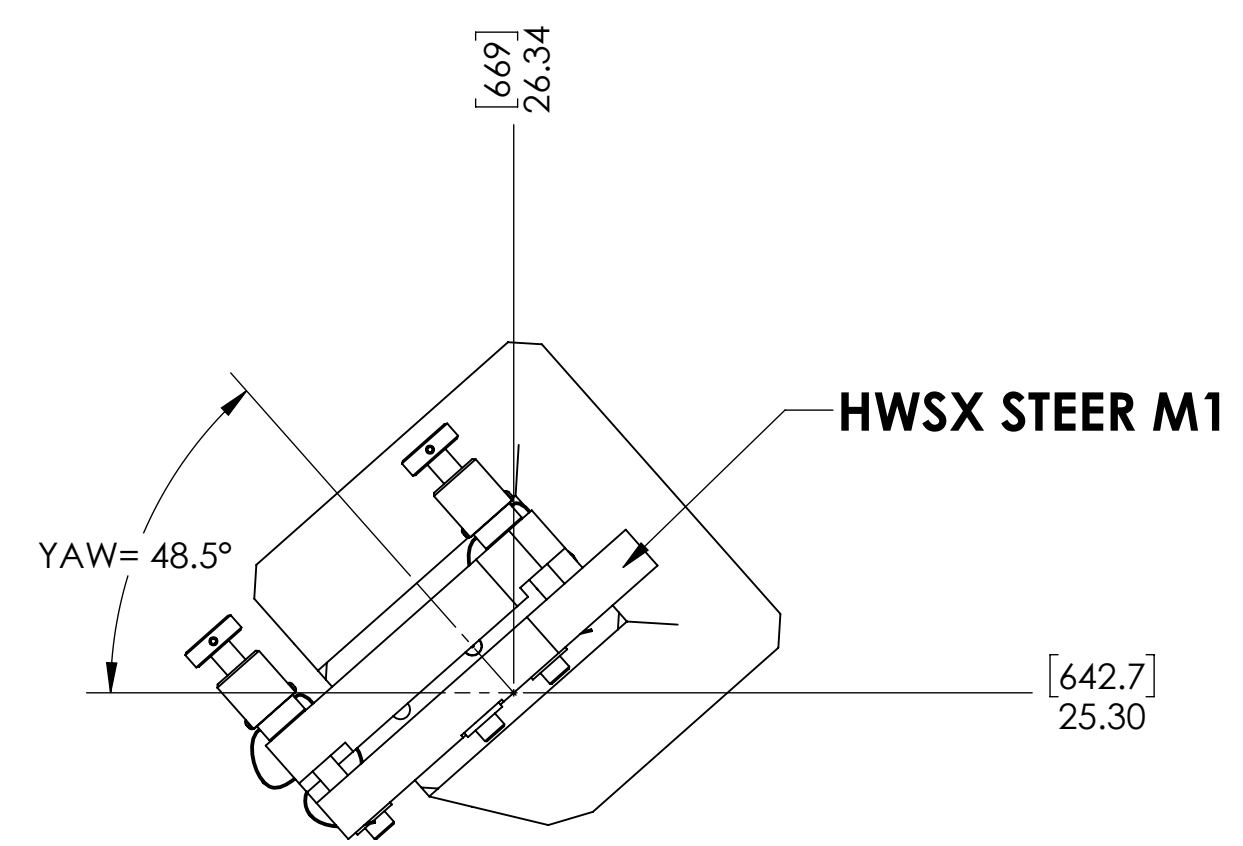
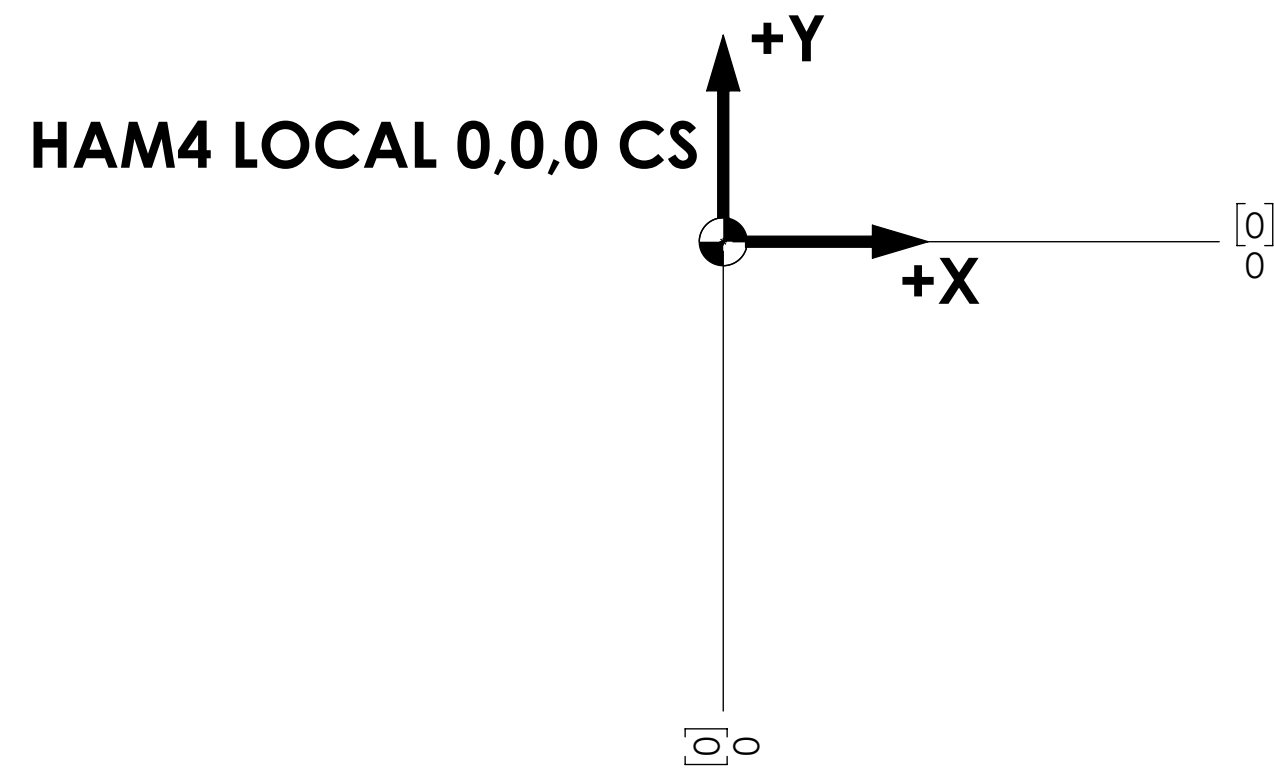

<b>LIGO</b> CALIFORNIA INSTITUTE OF TECHNOLOGY MASSACHUSETTS INSTITUTE OF TECHNOLOGY	
SIZE DWG. NO.	REV.
<b>D</b> <b>D1101847</b>	<b>v5</b>
SCALE: 1:4	PROJECTION:
SHEET 2 OF 3	

8 7 6 5 4 3 2 1

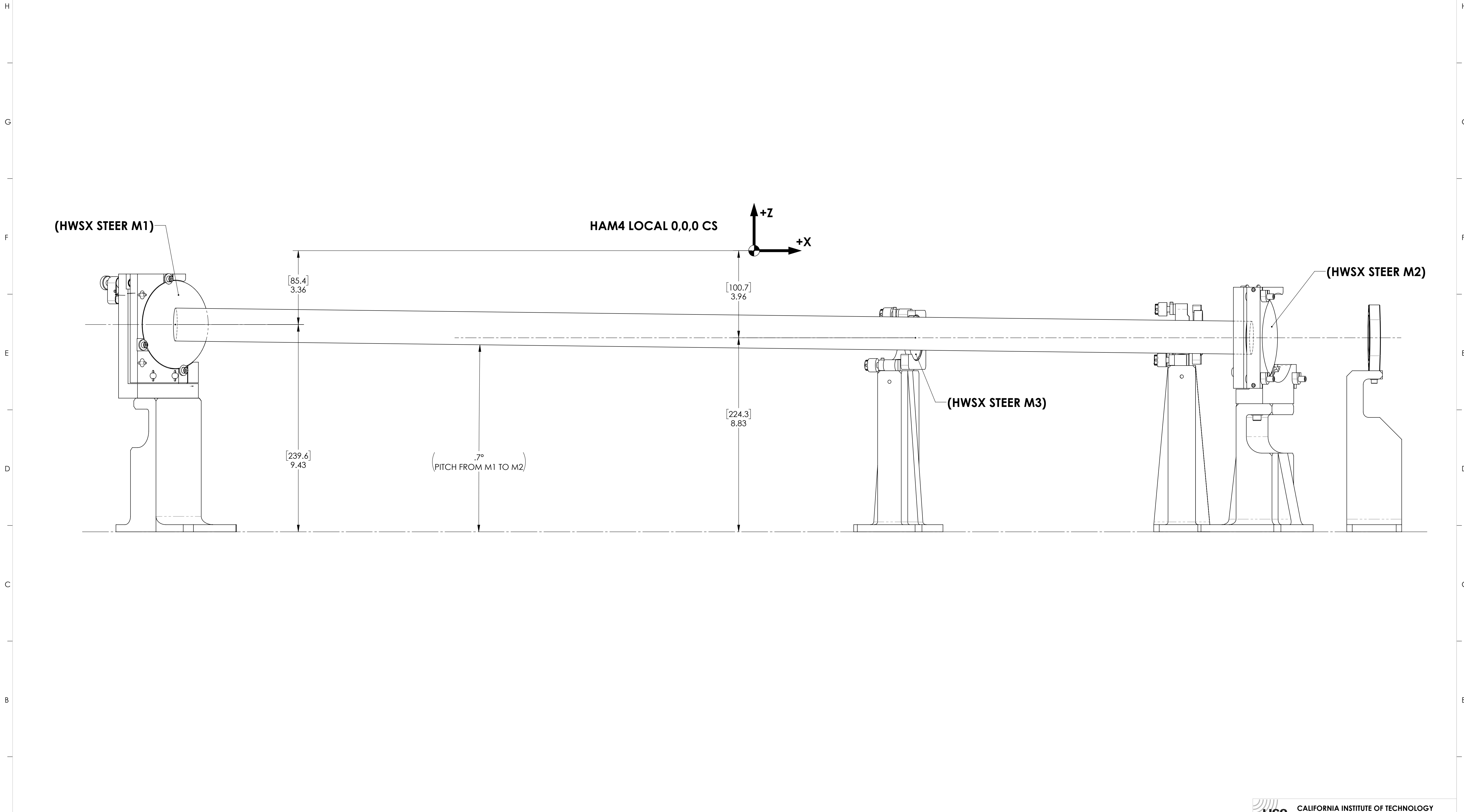

**LIGO** CALIFORNIA INSTITUTE OF TECHNOLOGY  
 MASSACHUSETTS INSTITUTE OF TECHNOLOGY

SIZE	DWG. NO.	REV.
D	D1101847	v5

SCALE: 1:4    PROJECTION:    SHEET 3 OF 3

8 7 6 5 4 3 2 1