

D1101780\_Advanced\_LIGO\_SUS\_HLTS\_Dowel\_Pin\_Insertion\_Fixture\_Assembly\_Sapphire\_Prism\_Holder, PART PDM REV: X-000, DRAWING PDM REV:

REV.	DATE	DCN #	DRAWING TREE #
v1	02 SEP 2011	E1100826	-
-	-	-	-
-	-	-	-

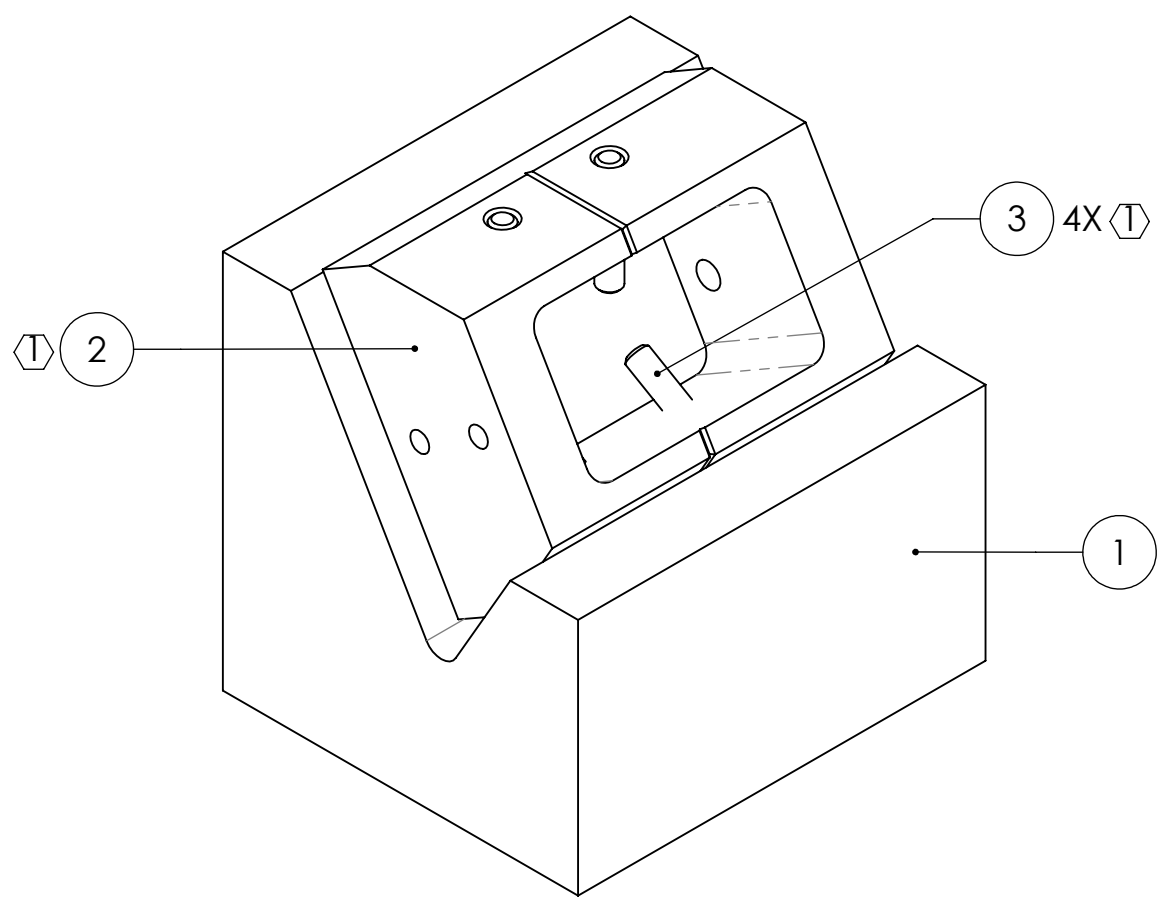

HLTS CONFIGURATION

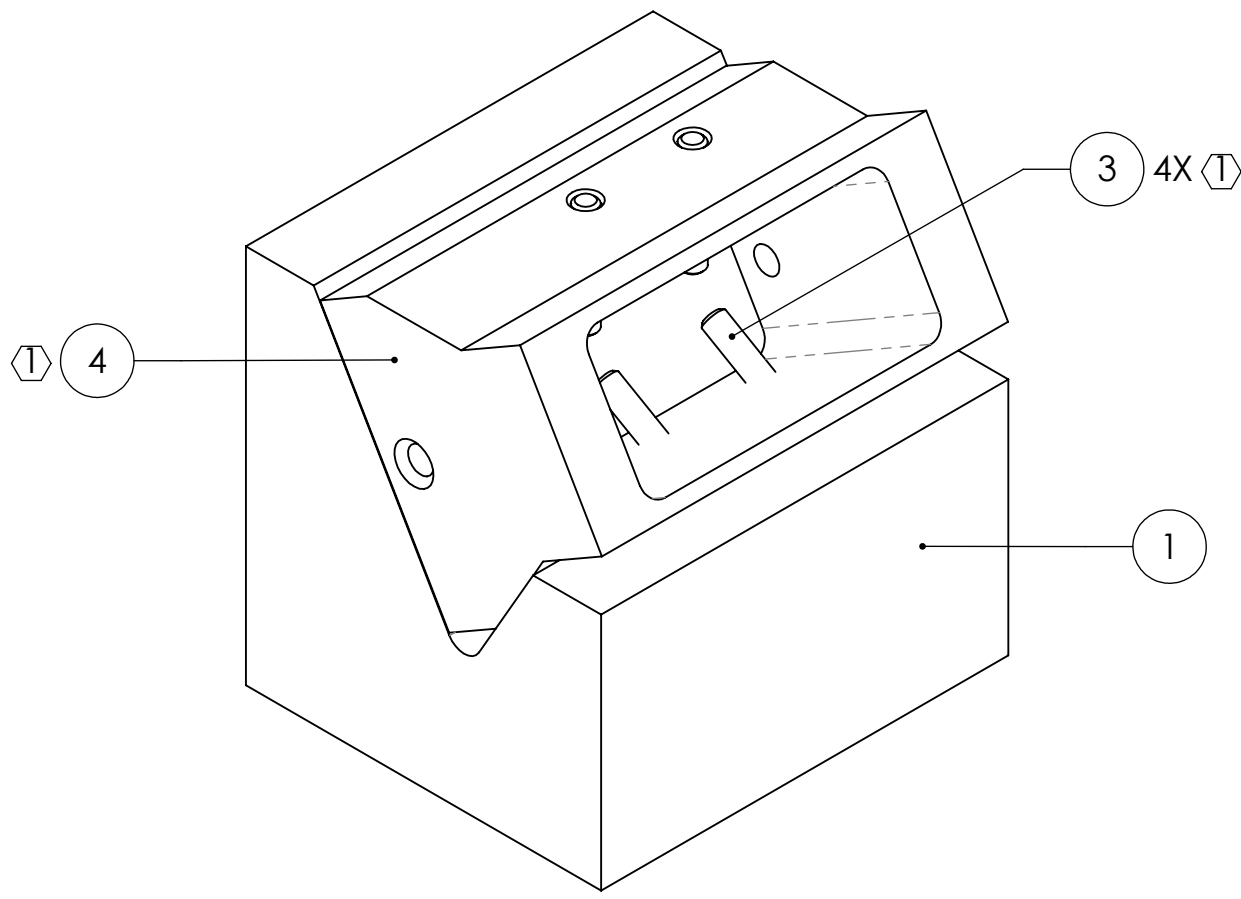

HSTS CONFIGURATION

ITEM NO.	PART NUMBER	DESCRIPTION	MATERIAL	QTY.	SPARE	TOTAL
4	D1100415	PRISM HOLDER, HSTS PRISM FIXTURE (T)	6061-T6 Al	1	0	1
3	91585A018	DOWEL PIN, $\phi$ 2 mm X 10 mm LONG (MCMASTER CARR P/N) (T)	300 SSTL	4	2	6
2	D0902664	SAPPHIRE PRISM HOLDER, HLTS (T)	6061-T6 Al	1	0	1
1	D1101779	DOWEL PIN INSERTION FIXTURE, SAPPHIRE PRISM HOLDER	6061-T6 Al	1	0	1

PARTS LIST

NOTES AND TOLERANCES: (UNLESS OTHERWISE SPECIFIED)

(T) PRESS FIT DOWEL PINS INTO HOLES FLUSH WITH PRISM HOLDER SURFACE, AFTER ALL PARTS ARE CLEANED AND BAKED.

CALIFORNIA INSTITUTE OF TECHNOLOGY MASSACHUSETTS INSTITUTE OF TECHNOLOGY		PART NAME DOWEL PIN INSERTION FIXTURE ASSY, SAPPHIRE PRISM HOLDER	
SYSTEM ADVANCED LIGO	SUB-SYSTEM SUS	DESIGNER D. BRIDGES 08 SEP 2011	SIZE DWG. NO. B D1101780
DRAFTER D. BRIDGES 08 SEP 2011	CHECKER B. MOORE 09 SEP 2011	APPROVAL	REV. v1
MATERIAL N/A		FINISH N/A $\mu$ inch	
NEXT ASSY N/A		SCALE: 2:1 PROJECTION:  SHEET 1 OF 1	

8 7 6 5 4 3 2 1

D

C

B

A

8 7 6 5 4 3 2 1