

D1101704 Slide Bracket Mount, Eddie current damper, UIM Tooling, aLIGO, PART PDM REV.: , DRAWING PDM REV.:

**NOTES CONTINUED:**  
 5. SCRIBE, ENGRAVE (A VIBRATORY TOOL MAY BE USED), LASER MARK OR MECHANICALLY STAMP (NO INKS OR DYES) DRAWING PART NUMBER, REVISION (AND VARIANT OR "TYPE" IF APPLICABLE) ON NOTED SURFACE OF PART FOLLOWED ON THE NEXT LINE WITH A THREE DIGIT SERIAL NUMBER. SERIAL NUMBERS START AT 001 FOR THE FIRST ARTICLE AND PROCEED CONSECUTIVELY. USE MINIMUM 0.12" HIGH CHARACTERS, UNLESS THE SIZE OF THE PART DICTATES SMALLER CHARACTERS. EXAMPLE: DXXXXXX-VY, TYPE-XX, S/N XXX

- 6. APPROXIMATE WEIGHT = X.XXX LB.
- 7. MACHINE ALL SURFACES TO REMOVE OXIDES AND MILL FINISH, REFER TO LIGO-E0900364
- 8. ALL PARTS SHALL BE MANUFACTURED IN ACCORDANCE WITH LIGO SPECIFICATION E0900364.

REV.	DATE	DCN #	DRAWING TREE #
-	-	-	-
-	-	-	-
-	-	-	-

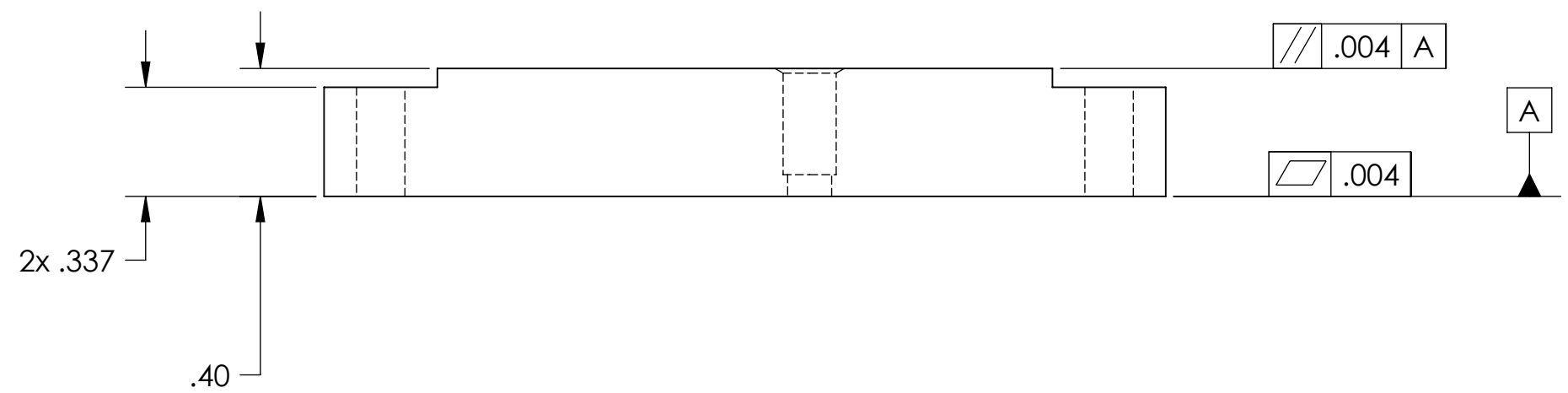
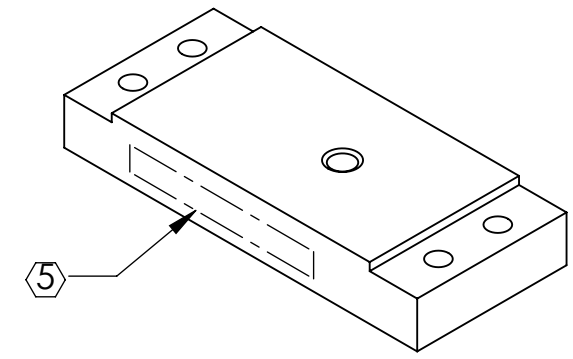
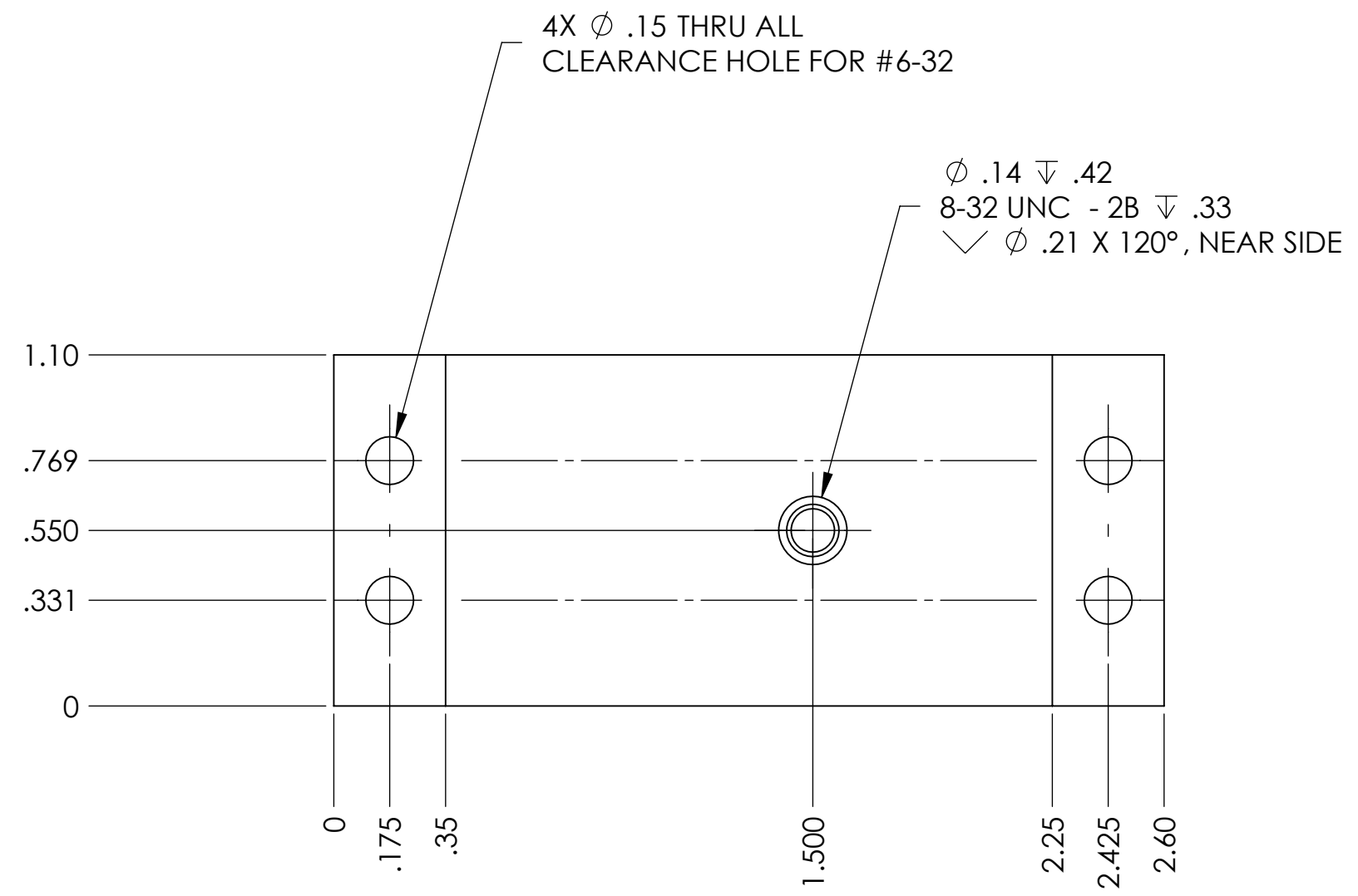

NOTES AND TOLERANCES: (UNLESS OTHERWISE SPECIFIED)				LIGO CALIFORNIA INSTITUTE OF TECHNOLOGY MASSACHUSETTS INSTITUTE OF TECHNOLOGY		PART NAME	
DIMENSIONS ARE IN INCHES TOLERANCES: .XX $\pm$ .01 .XXX $\pm$ .005 ANGULAR $\pm$ 0.5°				1. INTERPRET DRAWING PER ASME Y14.5-1994. 2. REMOVE ALL SHARP EDGES, .005-.015, FOR MACHINED PARTS. ROUND ALL EDGES APPROXIMATELY R.02 FOR SHEET METAL PARTS. 3. DO NOT SCALE FROM DRAWING. 4. -		Slide Bracket Mount, Eddie current damper, UIM Tooling, aLIGO	
MATERIAL		FINISH		SYSTEM	SUB-SYSTEM	DESIGNER	DATE
6061-T6 Al		125 $\mu$ inch		ADVANCED LIGO	SUS	SBARNUM	25 AUG 2011
NEXT ASSY				D1101702		DRAFTER	DATE
						SBARNUM	26 AUG 2011
						CHECKER	DATE
						SBARNUM	26 AUG 2011
						APPROVAL	DATE
						MBARTON	26 AUG 2011
SCALE: 2:1		PROJECTION:		SIZE DWG. NO.		REV.	
				B D1101704		v1	
				SHEET 1 OF 1			