

D1100477\_TCS Viewports Spherical Bearing Periscope Assembly, CO2 Laser Projection, PART PDM REV: X-001, DRAWING PDM REV: X-002

8

7

6

5

4

3

2

1

**NOTES CONTINUED:**

5 SCRIBE, ENGRAVE, LASER MARK OR MECHANICALLY STAMP (NO DYES OR INKS) A UNIQUE THREE DIGIT SERIAL NUMBER & REVISION NUMBER ON EACH PART. SERIAL NUMBERS START AT 001 FOR THE FIRST ARTICLE AND PROCEED CONSECUTIVELY. BAG AND TAG PARTS WITH THEIR DRAWING PART NUMBER, REVISION, VARIANT OR "TYPE" (IF APPLICABLE), AND QUANTITY. IF PARTS ARE TOO SMALL TO SCRIBE, BAGGING AND TAGGING ALONE IS SUFFICIENT.  
EXAMPLE (PART): 001-v1  
EXAMPLE (TAG): DXXXXXX-VY, TYPE-XX, QTY: TBD

6 INTERFACE TO LIGO-D1003221

7 INTERFACE TO IN-AIR CO2 LASER PROJECTION TABLE ENCLOSURE

REV.	DATE	DCN #	DRAWING TREE #
-	-	-	-
-	-	-	-
-	-	-	-

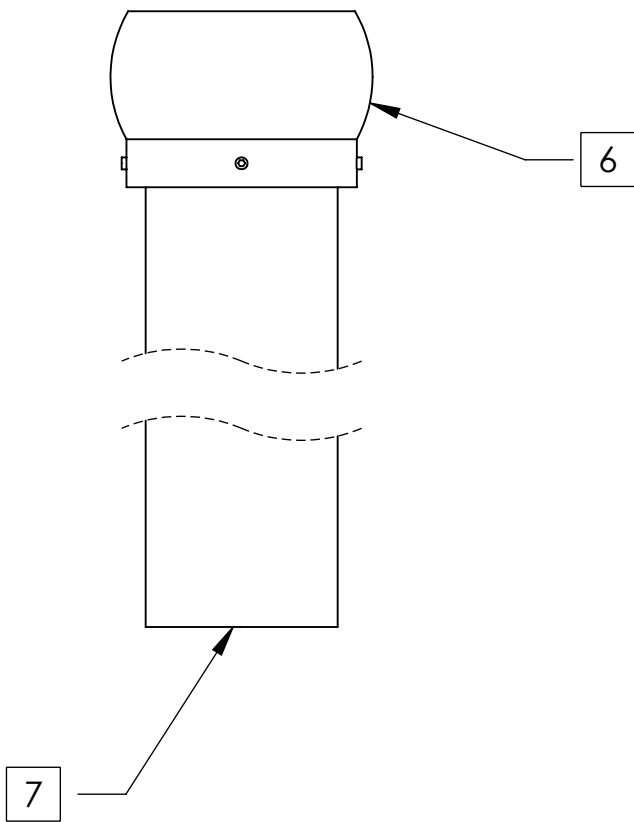
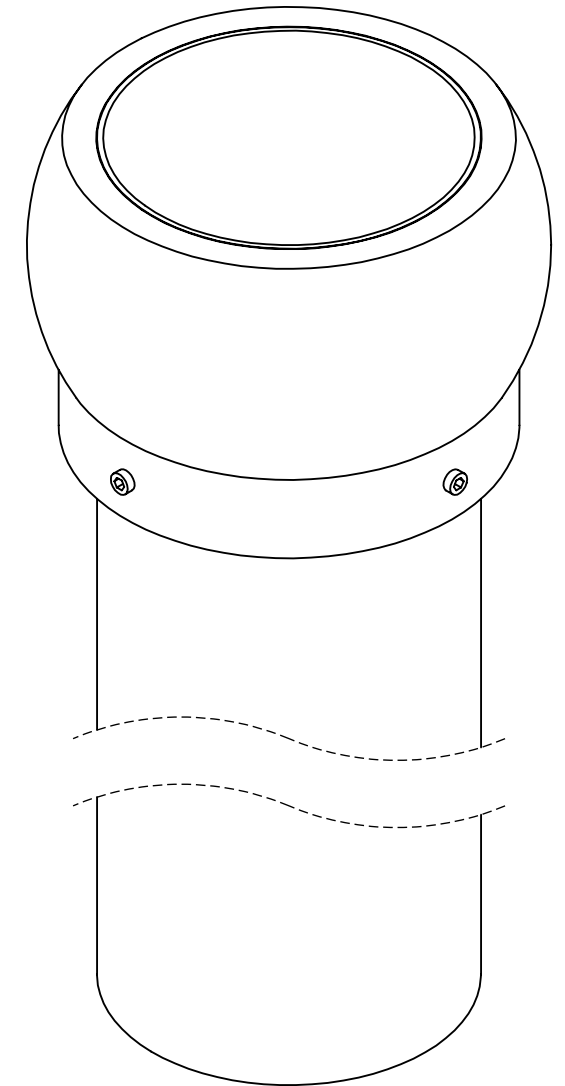
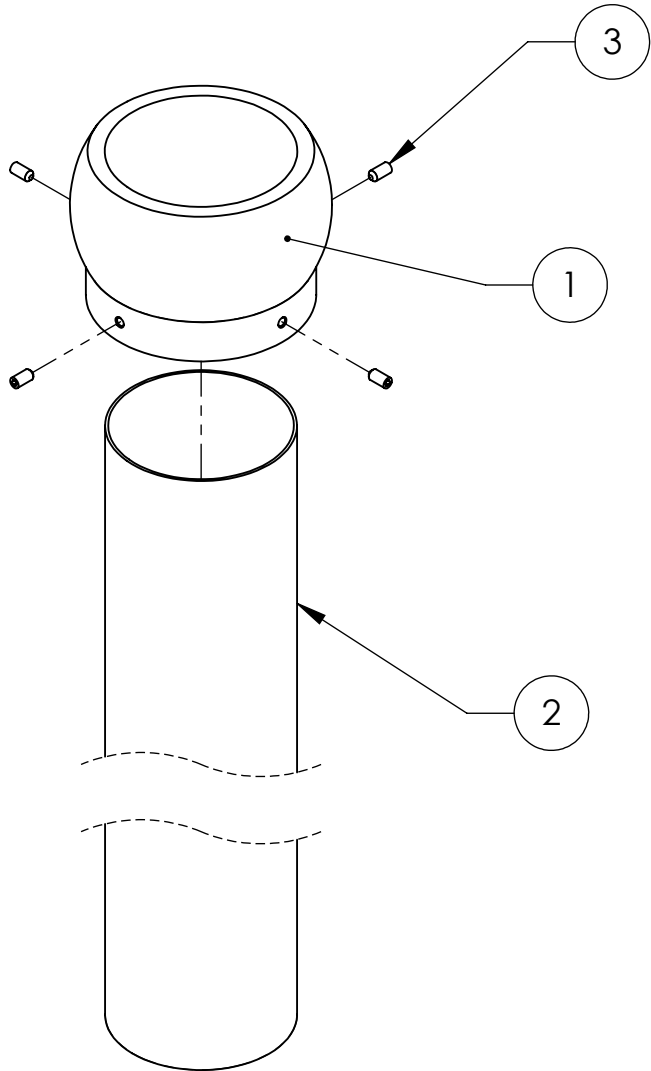

ITEM NO.	PART NUMBER	DESCRIPTION	MATERIAL	REQ	SPARE	TOTAL
3	T-2008-N	SCREW, SOCKET SET, 0.25-20 UNC-2A X 0.5 LONG	18-8 SSSL	4	1	5
2	D1100299	PERISCOPE TUBE, CO2P VP ENCLOSURE	6061 Alloy	1		1
1	D1100416	SPHERICAL BEARING, CO2P VP ENCLOSURE	6061 Alloy	1		1

**PARTS LIST**

<p><b>NOTES AND TOLERANCES: (UNLESS OTHERWISE SPECIFIED)</b></p> <p>DIMENSIONS ARE IN INCHES</p> <p>TOLERANCES: .XX ± .01 .XXX ± .005 ANGULAR ± 0.5°</p>		<p>1. INTERPRET DRAWING PER ASME Y14.5-1994. 2. REMOVE ALL SHARP EDGES, .005-.015, FOR MACHINED PARTS. ROUND ALL EDGES APPROXIMATELY R.02 FOR SHEET METAL PARTS. 3. DO NOT SCALE FROM DRAWING. 4. ALL MACHINING FLUIDS MUST BE FULLY SYNTHETIC, FULLY WATER SOLUBLE AND FREE OF SULFUR, SILICONE, AND CHLORINE.</p>		<p><b>LIGO</b> CALIFORNIA INSTITUTE OF TECHNOLOGY MASSACHUSETTS INSTITUTE OF TECHNOLOGY</p>		<p><b>PART NAME</b> SPHERICAL BEARING PERISCOPE ASSY, CO2P</p>	
<p><b>MATERIAL</b> N/A</p>		<p><b>FINISH</b> N/A μinch</p>		<p><b>SYSTEM</b> ADVANCED LIGO</p>		<p><b>SUB-SYSTEM</b> AOS</p>	
<p><b>NEXT ASSY</b> D1003193</p>		<p><b>DESIGNER</b> A. LANGLEY</p>		<p><b>DATE</b> 15 MAR 2011</p>		<p><b>SIZE DWG. NO.</b> B D1100477</p>	
<p><b>APPROVAL</b> P. WILLEMS</p>		<p><b>DATE</b> 30 MAR 2011</p>		<p><b>CHECKER</b> M. JACOBSON</p>		<p><b>DATE</b> 29 MAR 2011</p>	
<p><b>SCALE:</b> 1:12</p>		<p><b>PROJECTION:</b> </p>		<p><b>SHEET</b> 1 OF 1</p>		<p><b>REV.</b> v1</p>	

8

7

6

5

4

3

2

1