

1. REFER TO LIGO T0900475 FOR ASSEMBLY INSTRUCTIONS.

REV.	DATE	DCN #	DRAWING TREE #
v1	05 JAN 2017	-	-
-	-	-	-
-	-	-	-

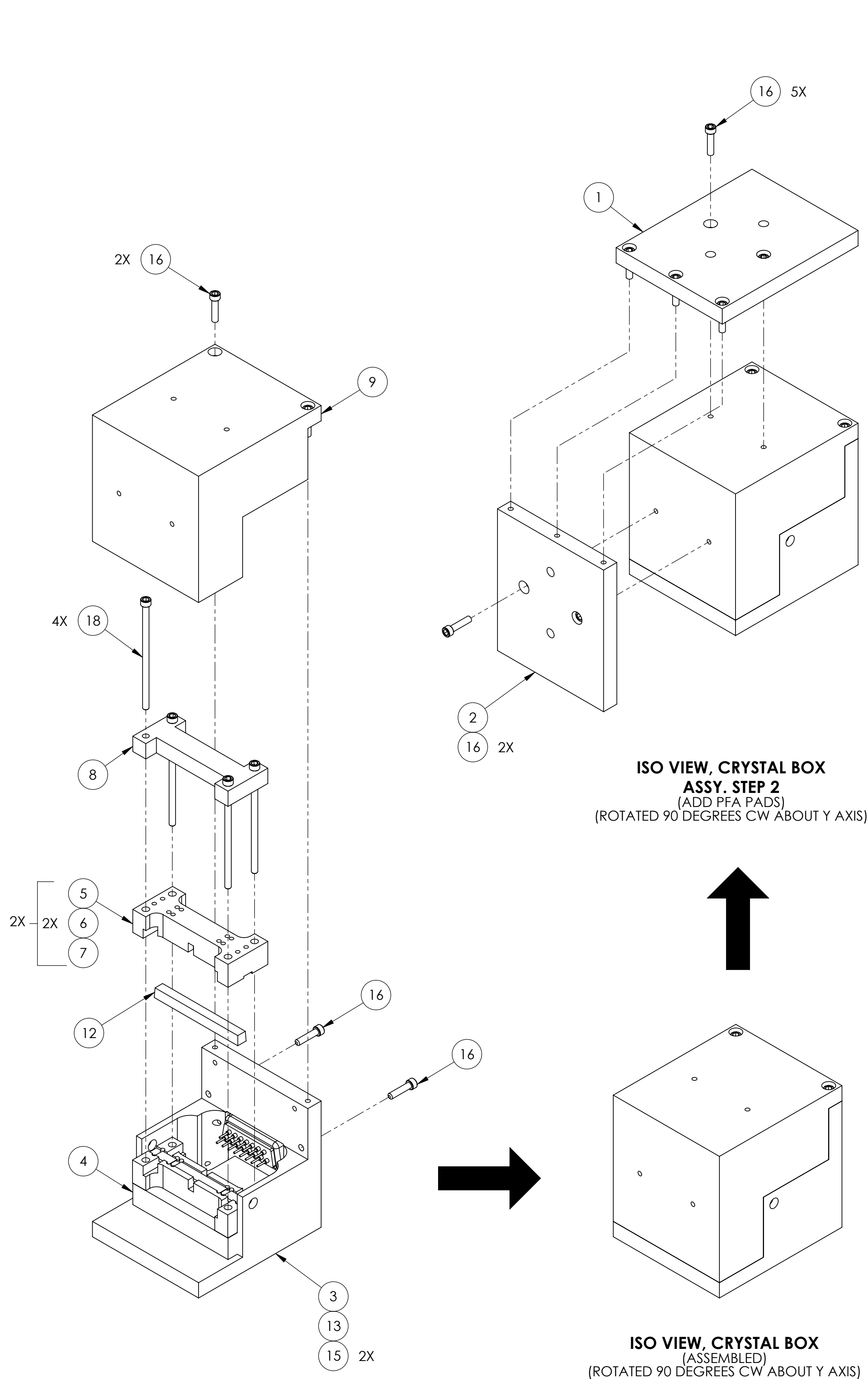

ISO VIEW, CRYSTAL BOX ASSY. STEP 1
(ROTATED 90 DEGREES CW ABOUT Y AXIS)

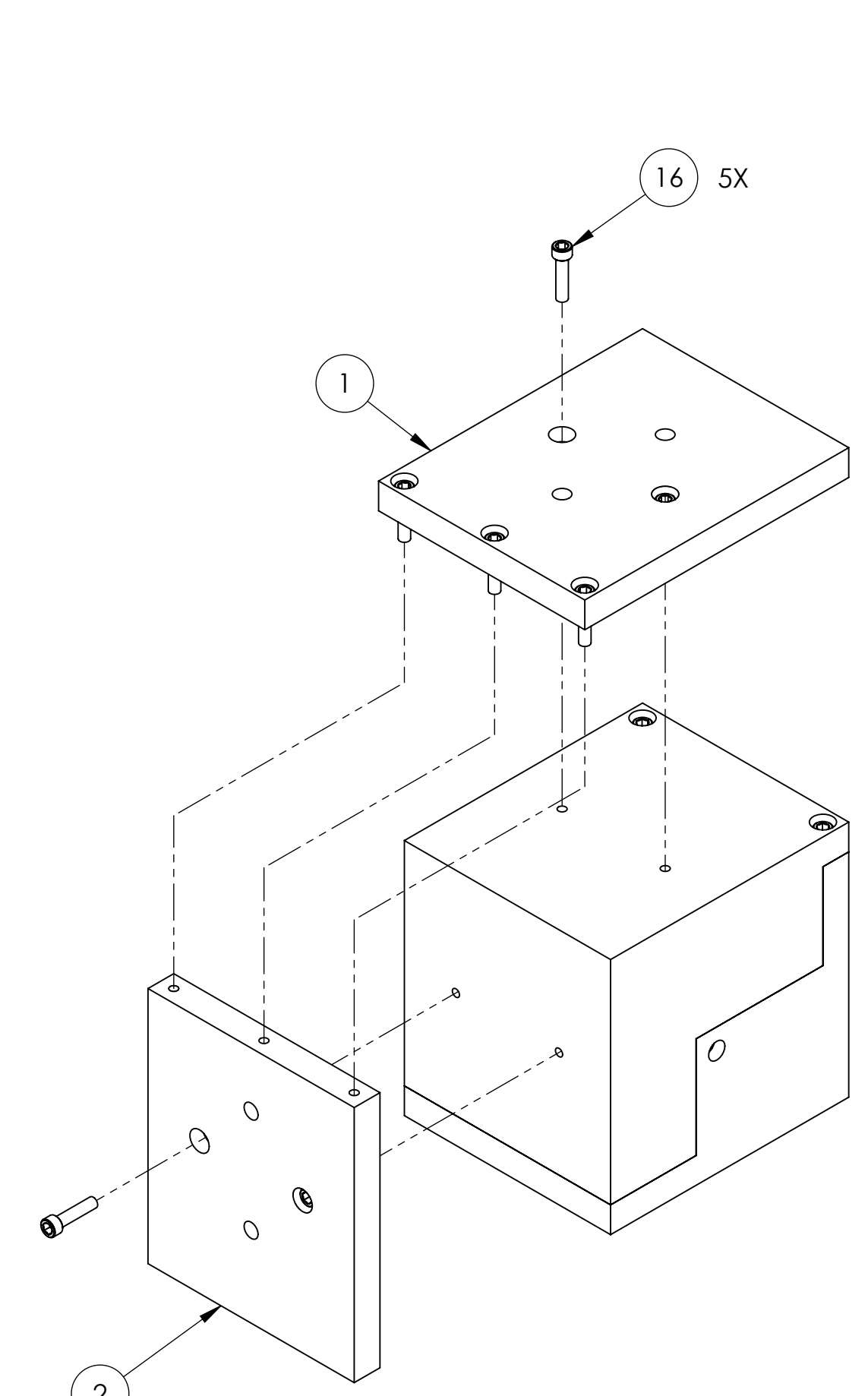

ISO VIEW, CRYSTAL BOX ASSY. STEP 2
(ADD PFA PADS)
(ROTATED 90 DEGREES CW ABOUT Y AXIS)

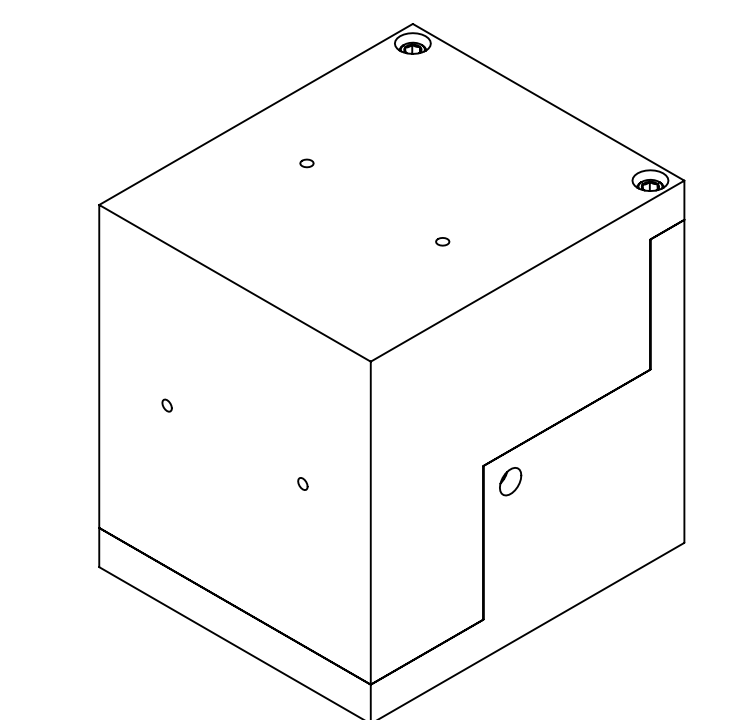

ISO VIEW, CRYSTAL BOX (ASSEMBLED)
(ROTATED 90 DEGREES CW ABOUT Y AXIS)

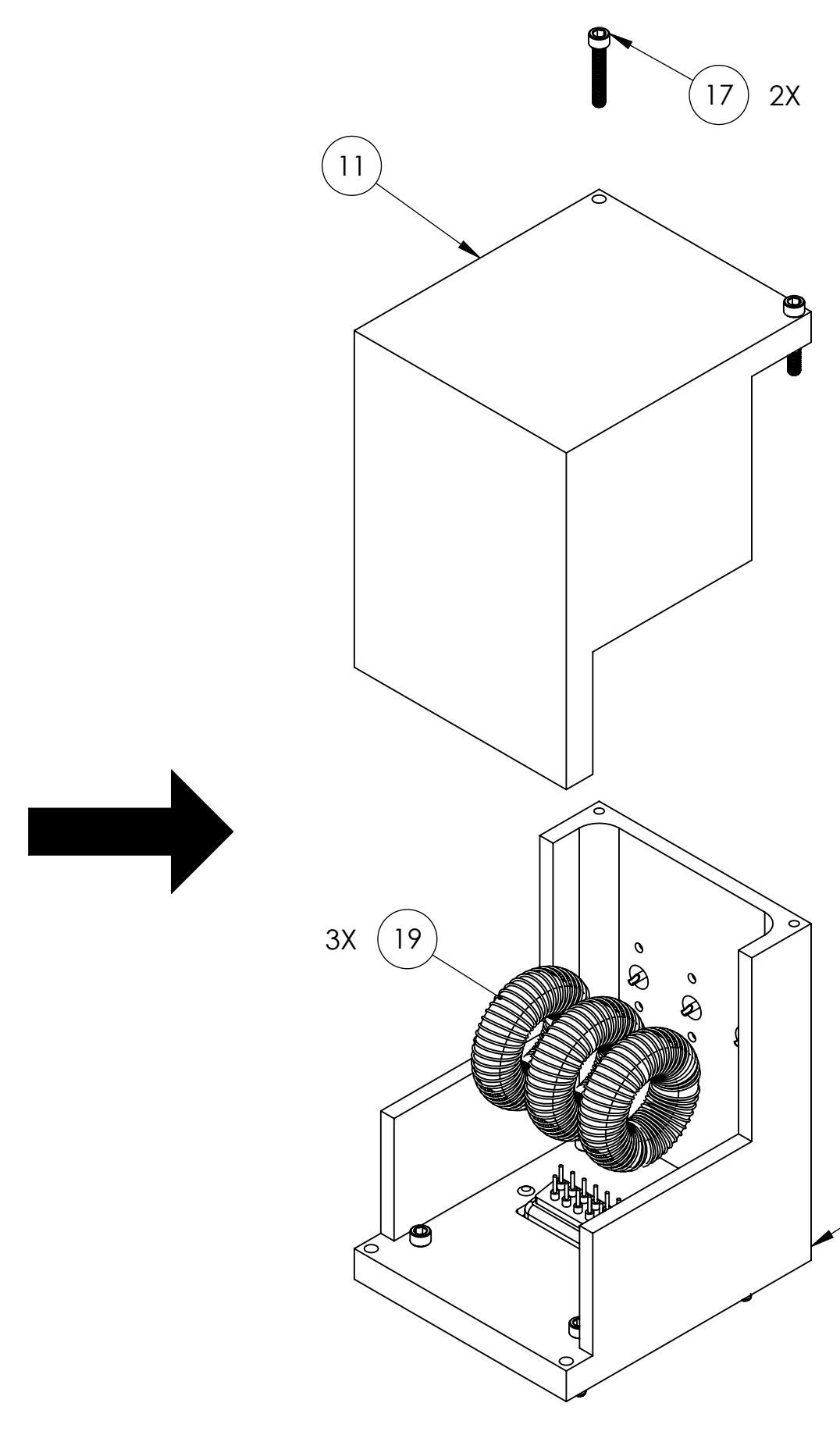

ISO VIEW, ELECTRONICS BOX ASSY. STEP 3
(ELECTRONICS BOX WIRING, NOT SHOW)

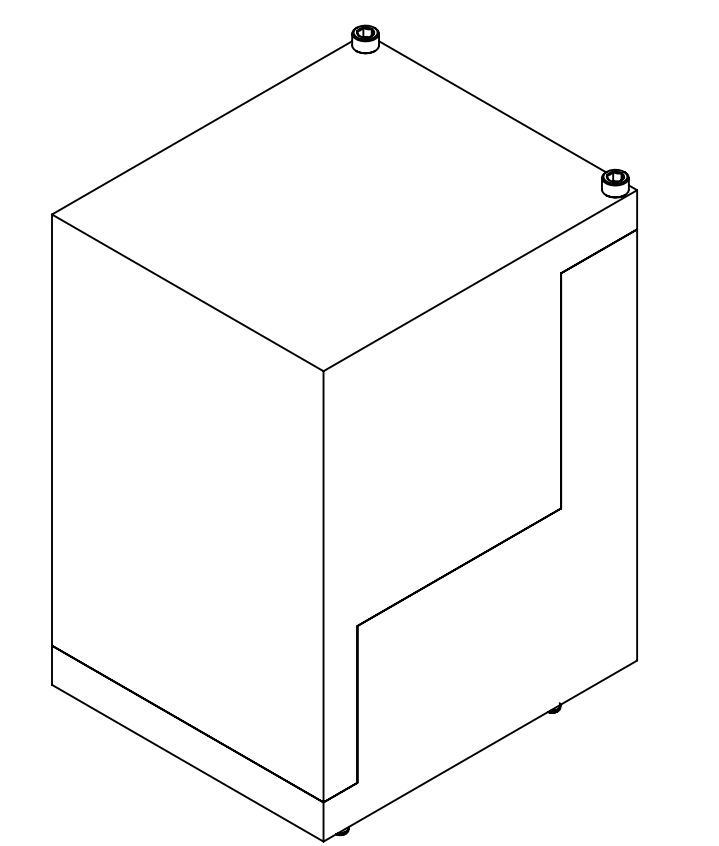

ISO VIEW, ELECTRONICS BOX (ASSEMBLED)

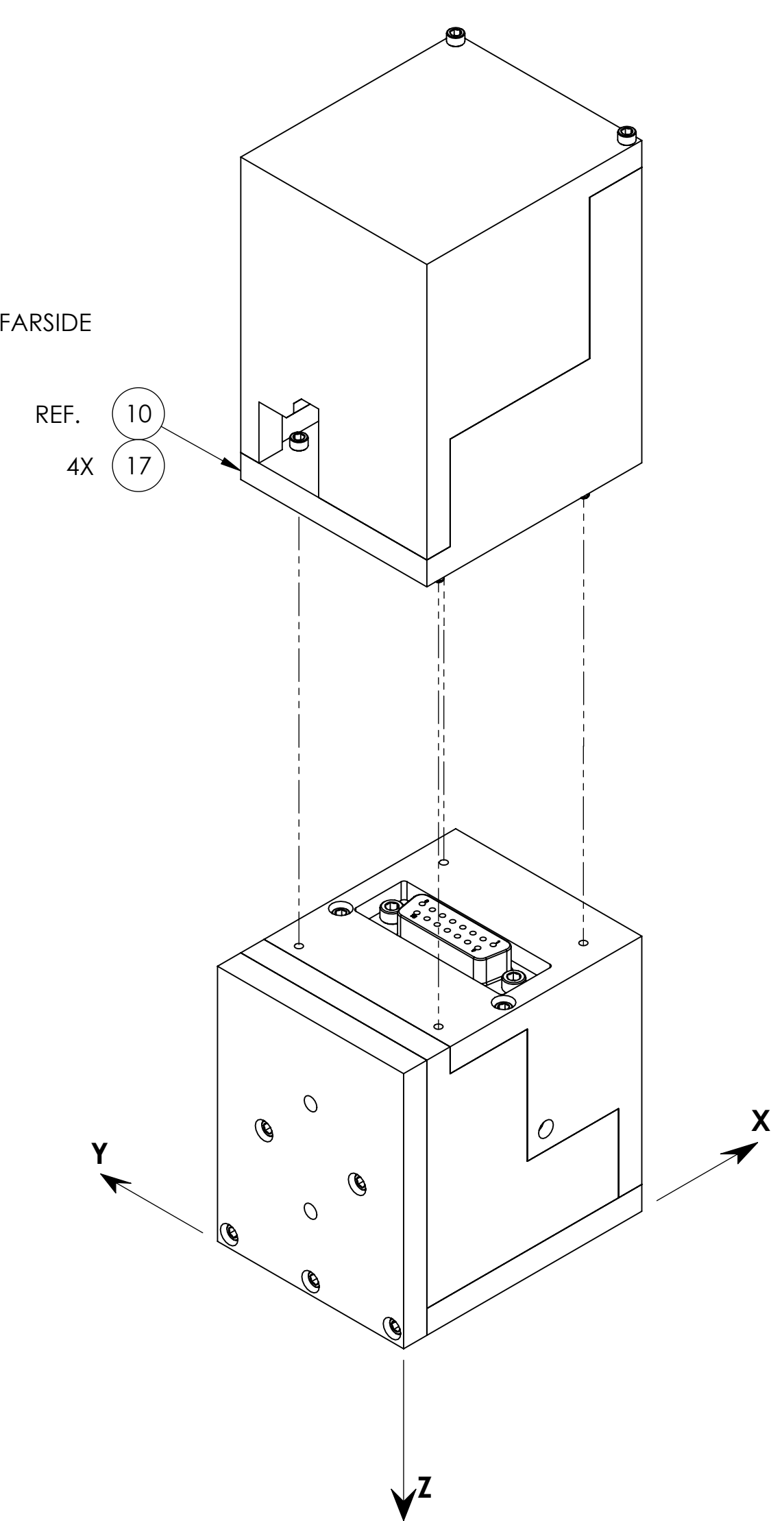

ISO VIEW, REAR-LEFT EXPLODED

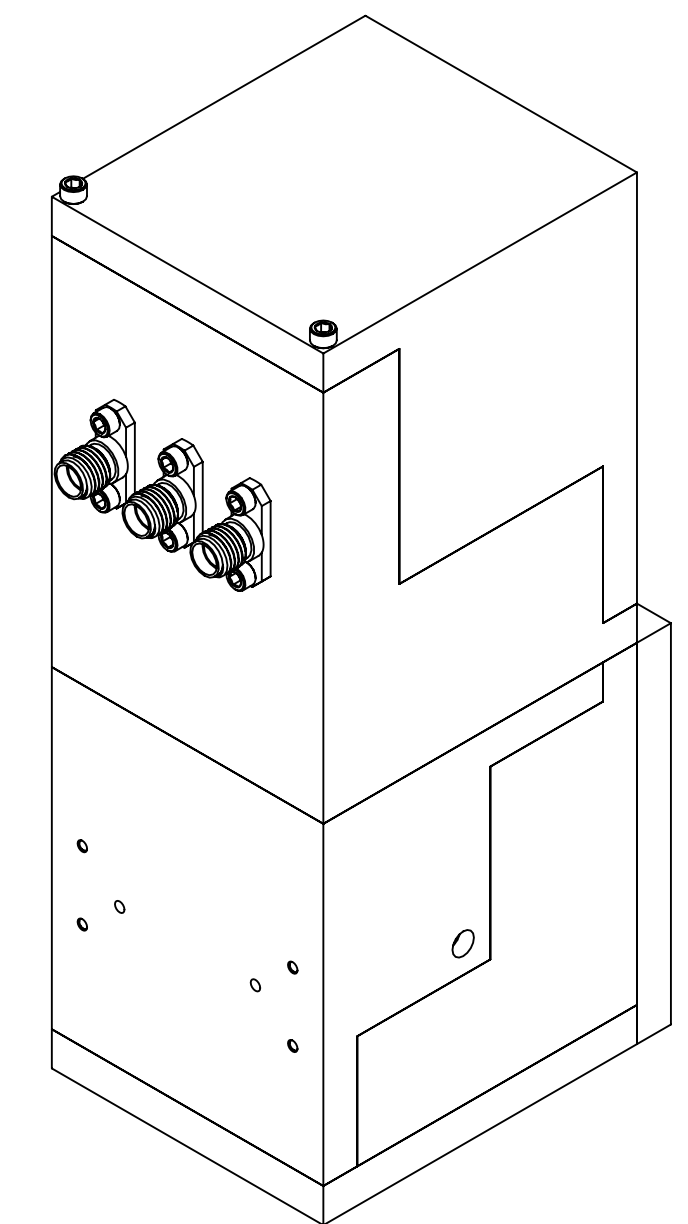

ISO VIEW, FRONT-RIGHT (ASSEMBLED)

ITEM NO.	PART NUMBER	DESCRIPTION	MATERIAL	QTY.
21	92196A075 MCMMASTER-CARR OR EQ.	SCREW, SHC, 2-56 X 5/32 Lg.	18-8 SSSL	6
20	TBD	PANEL RECEPTABLE JACK, COAX	-	3
19	94045K212 MCMMASTER-CARR	FLAT DISC SPRING .5 ID X .88 OD.	-	3
18	92196A947 MCMMASTER-CARR OR EQ.	SCREW, SHC, 2-56 X 1.75 LG.	18-8 SSSL	4
17	92196A162 MCMMASTER-CARR OR EQ.	SCREW, SHC, 2-56 X .50 Lg.	18-8 SSSL	6
16	MS16995-3 OR EQ.	SCREW, SHC, 2-56 X .38 LG.	18-8 SSSL	11
15	MS16995-9 OR EQ.	SCREW, SHC, 4-40 X .25 LG.	18-8 SSSL	4
14	TBD	CONN D-SUB PLUG 15 POS	-	1
13	TBD	CONN D-SUB RCPT 15 POS	-	1
12	E080128	αLIGO RTP CRYSTALS FOR PHASE MODULATORS	-	1
11	D0902180	αLIGO, IO, EOM TOP COVER	6061-T6 Al	1
10	D0902179	αLIGO, IO, EOM INDUCTOR BOX	6061-T6 Al	1
9	D0902178	αLIGO, IO, EOM BOX UPPER	6061-T6 Al	1
8	D0902177	αLIGO, IO, EOM STIFFENER	6061-T6 Al	1
7	D0902176	αLIGO, IO, EOM ELECTRODE 22mm	COPPER	2
6	D0902175	αLIGO, IO, EOM ELECTRODE 7mm	COPPER	4
5	D0902174	αLIGO, IO, EOM CRYSTAL MOUNT	-	2
4	D0902173	αLIGO, IO, EOM CRYSTAL RISER	-	1
3	D0902172	αLIGO, IO, EOM BOX LOWER	6061-T6 Al	1
2	D0902171	D0902171 αLIGO, IO, EOM SHORT TEFLON SPACER	PFA	1
1	D0902170	αLIGO, IO, EOM LONG TEFLON SPACER	PFA	1

NOTES AND TOLERANCES: (UNLESS OTHERWISE SPECIFIED)

DIMENSIONS ARE IN INCHES

MATERIAL: N/A, FINISH: N/A μinch

LIGO CALIFORNIA INSTITUTE OF TECHNOLOGY MASSACHUSETTS INSTITUTE OF TECHNOLOGY

SYSTEM: ADVANCED LIGO, SUB-SYSTEM: IO, NEXT ASSY: -

PART NAME: αLIGO, IO, EOM ASSEMBLY

DESIGNER: L.WILLIAMS, DRAFTER: E.SANCHEZ, CHECKER: SEE DCC, APPROVAL: SEE DCC

DATE: 05 JAN 2017, DWG. NO.: D1100392, SCALE: 1:1, PROJECTION: 1st Angle, SHEET 1 OF 1

D1100392 αLIGO, IO, EOM ASSEMBLY, PART FROM REV. X-001, DRAWING FROM REV. X-002