

| REV. | DATE         | DCN #    | DRAWING TREE # |
|------|--------------|----------|----------------|
| v1   | 2 Mar 2011   | E1100216 | E1100217       |
| v2   | 17 Aug. 2011 | E1100335 | -              |
| -    | -            | -        | -              |

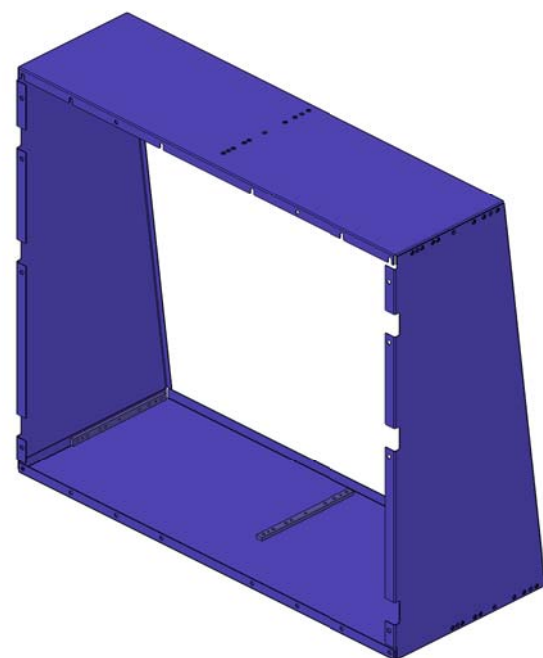
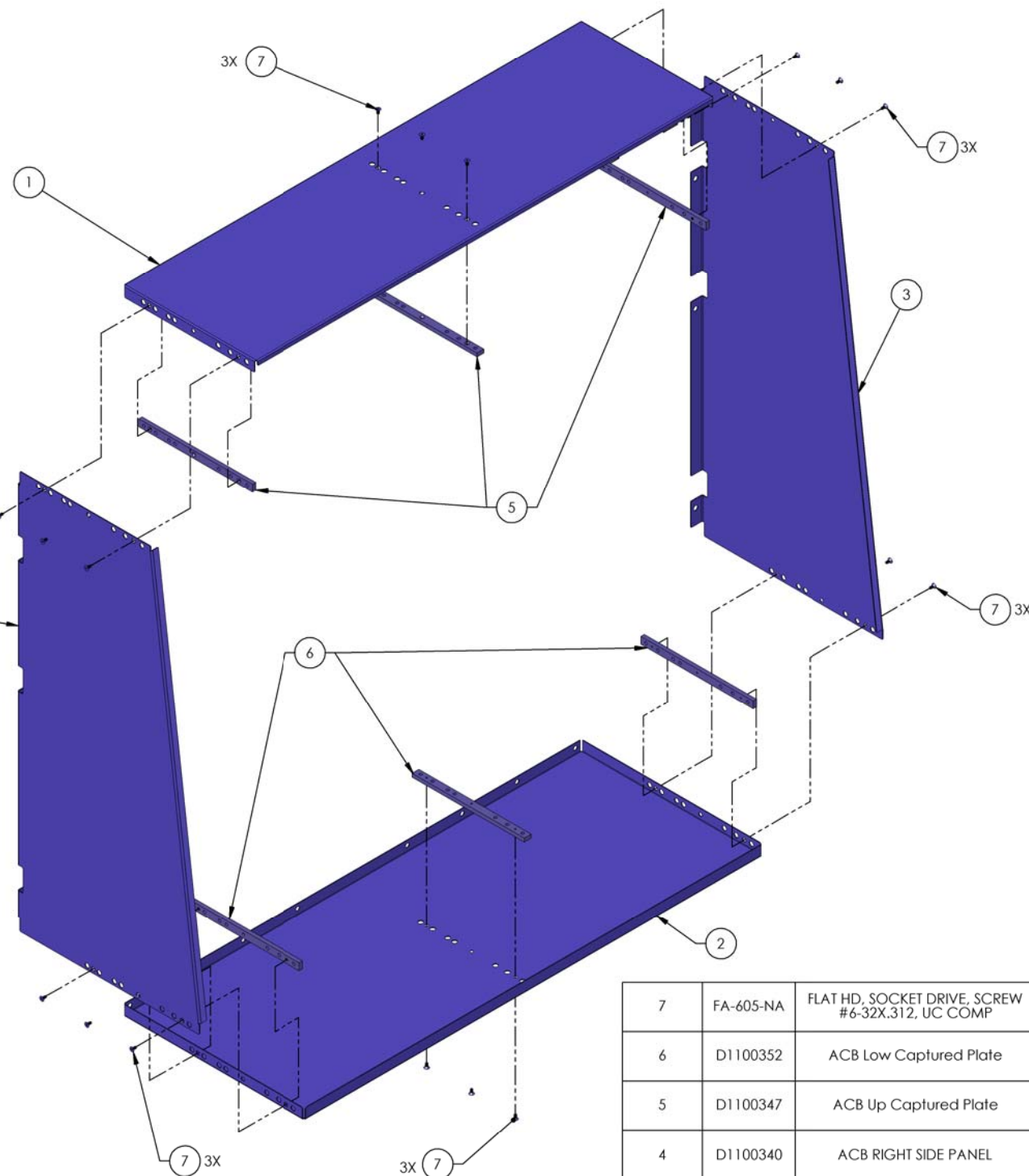
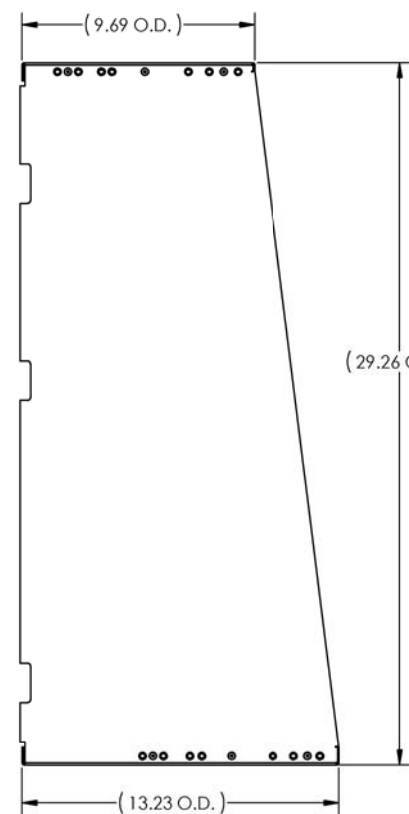
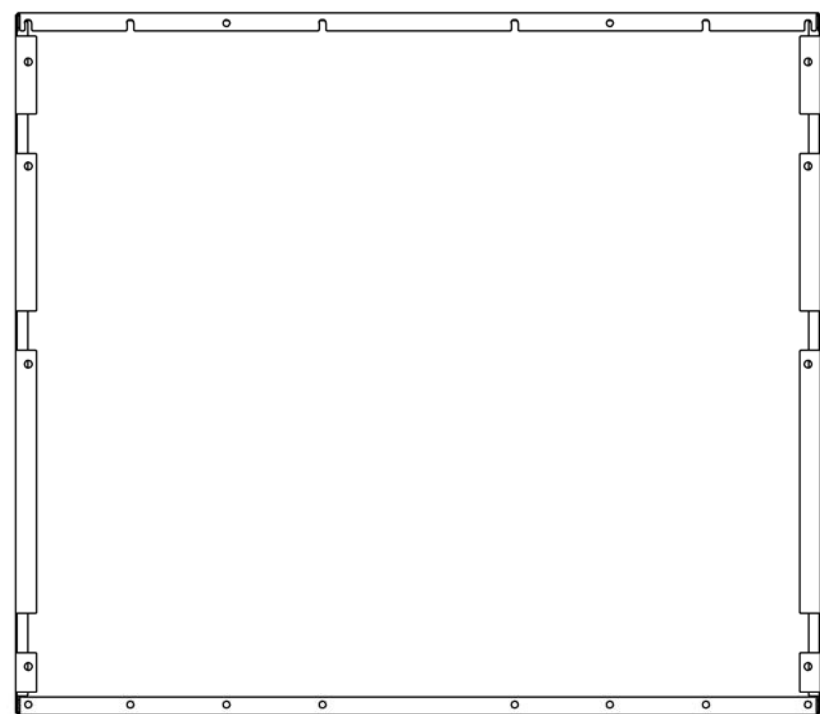
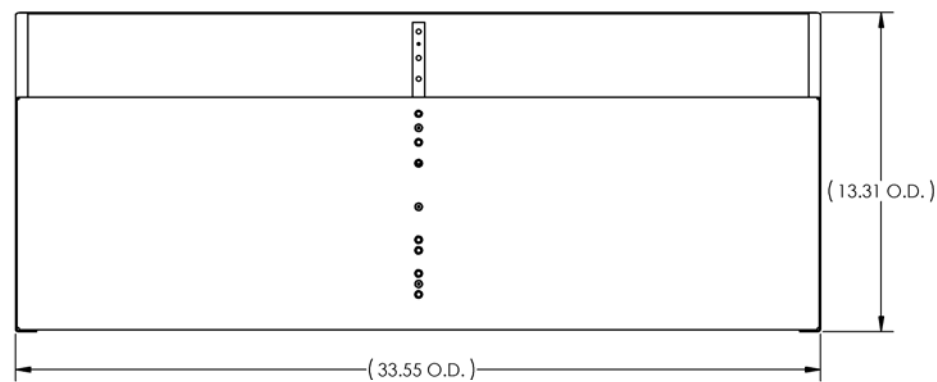

| ITEM NO. | PART NUMBER | DESCRIPTION                                      | MATERIAL          | REQ | SPARE | TOTAL |
|----------|-------------|--|-------------------|-----|-------|-------|
| 7        | FA-605-NA   | FLAT HD, SOCKET DRIVE, SCREW #6-32X.312, UC COMP | Ag-18-8 SSSL      | 18  | 6     | 24    |
| 6        | D1100352    | ACB Low Captured Plate                           | 304 SSSL          | 3   |       | 3     |
| 5        | D1100347    | ACB Up Captured Plate                            | 304 SSSL          | 3   |       | 3     |
| 4        | D1100340    | ACB RIGHT SIDE PANEL                             | 18 GAUGE 304 SSSL | 1   |       | 1     |
| 3        | D1100327    | ACB LEFT SIDE PANEL                              | 18 GAUGE 304 SSSL | 1   |       | 1     |
| 2        | D1001027    | ARM CAVITY BAFFLE LOWER LEAF                     | 18 GAUGE 304 SSSL | 1   |       | 1     |
| 1        | D1001026    | ARM CAVITY BAFFLE UP LEAF                        | 18 GAUGE 304 SSSL | 1   |       | 1     |

| NOTES AND TOLERANCES: (UNLESS OTHERWISE SPECIFIED)  |           |
|---|-----------|
| 1. INTERPRET DRAWING PER ASME Y14.5-1994.   |           |
| 2. REMOVE ALL SHARP EDGES, .005-.015. FOR MACHINED PARTS. ROUND ALL EDGES APPROXIMATELY R.02 FOR SHEET METAL PARTS. |           |
| 3. DO NOT SCALE FROM DRAWING.   |           |
| 4. ALL MACHINING FLUIDS MUST BE FULLY SYNTHETIC, FULLY WATER SOLUBLE AND FREE OF SULFUR, SILICONE, AND CHLORINE.    |           |
| MATERIAL  | N/A       |
| FINISH  | N/A μinch |

|   |               |
|---|---------------|
| CALIFORNIA INSTITUTE OF TECHNOLOGY<br>MASSACHUSETTS INSTITUTE OF TECHNOLOGY |               |
| SYSTEM  | ADVANCED LIGO |
| SUB-SYSTEM  | AOS           |
| NEXT ASSY   | D1000977      |

|           |          |             |            |                |              |  |
|-----------|----------|-------------|------------|----------------|--------------|--|
| PART NAME |          |             |            | ACB SHELF ASSY |              |  |
| DESIGNER  | N.Nguyen | 01 Mar 2011 | SIZE       | DWG. NO.       | REV.         |  |
| DRAFTER   | N.Nguyen | 2 Mar 2011  | D          | D1100391       | v2           |  |
| CHECKER   | M. Smith | 10 Mar 2011 | SCALE: 1:1 | PROJECTION:    | SHEET 1 OF 1 |  |
| APPROVAL  | D. Coyne | 20 Mar 2011 |            |                |              |  |

D1100391\_LAB/COO\_LAB/ACB Shelf Assy\_PART FROM REV: A134\_DRAWING FROM REV: X014