

8 7 6 5 4 3 2 1

**NOTES CONTINUED:**  
 5. SCRIBE, ENGRAVE (A VIBRATORY TOOL MAY BE USED), LASER MARK OR MECHANICALLY STAMP (NO INKS OR DYES) DRAWING PART NUMBER, REVISION (AND VARIANT OR "TYPE" IF APPLICABLE) ON NOTED SURFACE OF PART FOLLOWED ON THE NEXT LINE WITH A THREE DIGIT SERIAL NUMBER. SERIAL NUMBERS START AT 001 FOR THE FIRST ARTICLE AND PROCEED CONSECUTIVELY. USE MINIMUM 0.12" HIGH CHARACTERS, UNLESS THE SIZE OF THE PART DICTATES SMALLER CHARACTERS. EXAMPLE: DXXXXXX-VY, TYPE-XX, S/N XXX

6. APPROXIMATE WEIGHT = X.XXX LB.  
 7. MACHINE ALL SURFACES TO REMOVE OXIDES AND MILL FINISH. REFER TO LIGO-E0900364

**(NON FABRICATION NOTE)**  
 The InnoLight Prometheus laser has a beam height of ~60 mm from the flat base (not the 4 little extrusions) to the centre of the beam shutters.

REV.	DATE	DCN #	DRAWING TREE #
V3	1 JUL 2013	E1300516	-
-	-	-	-
-	-	-	-

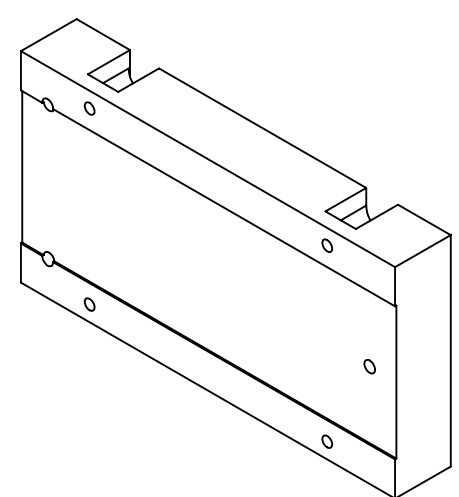
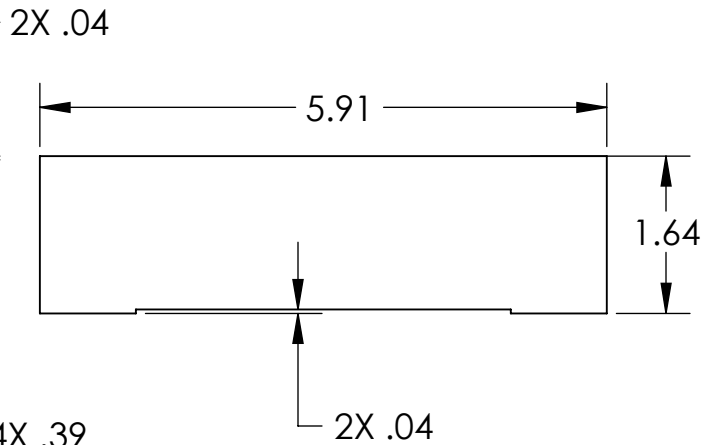
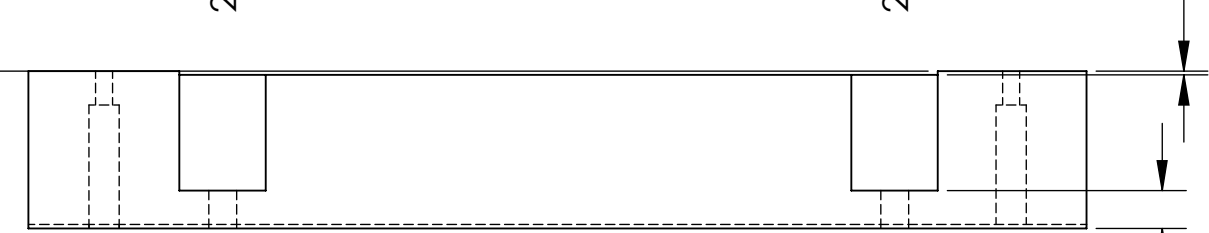
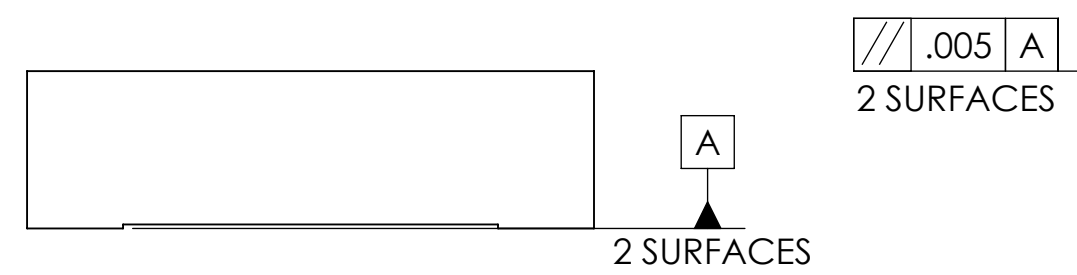
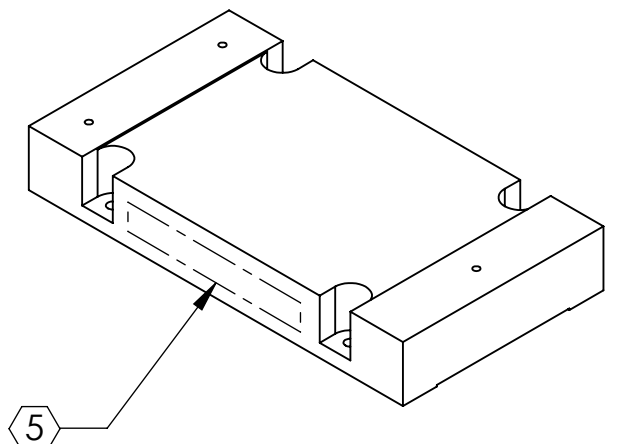
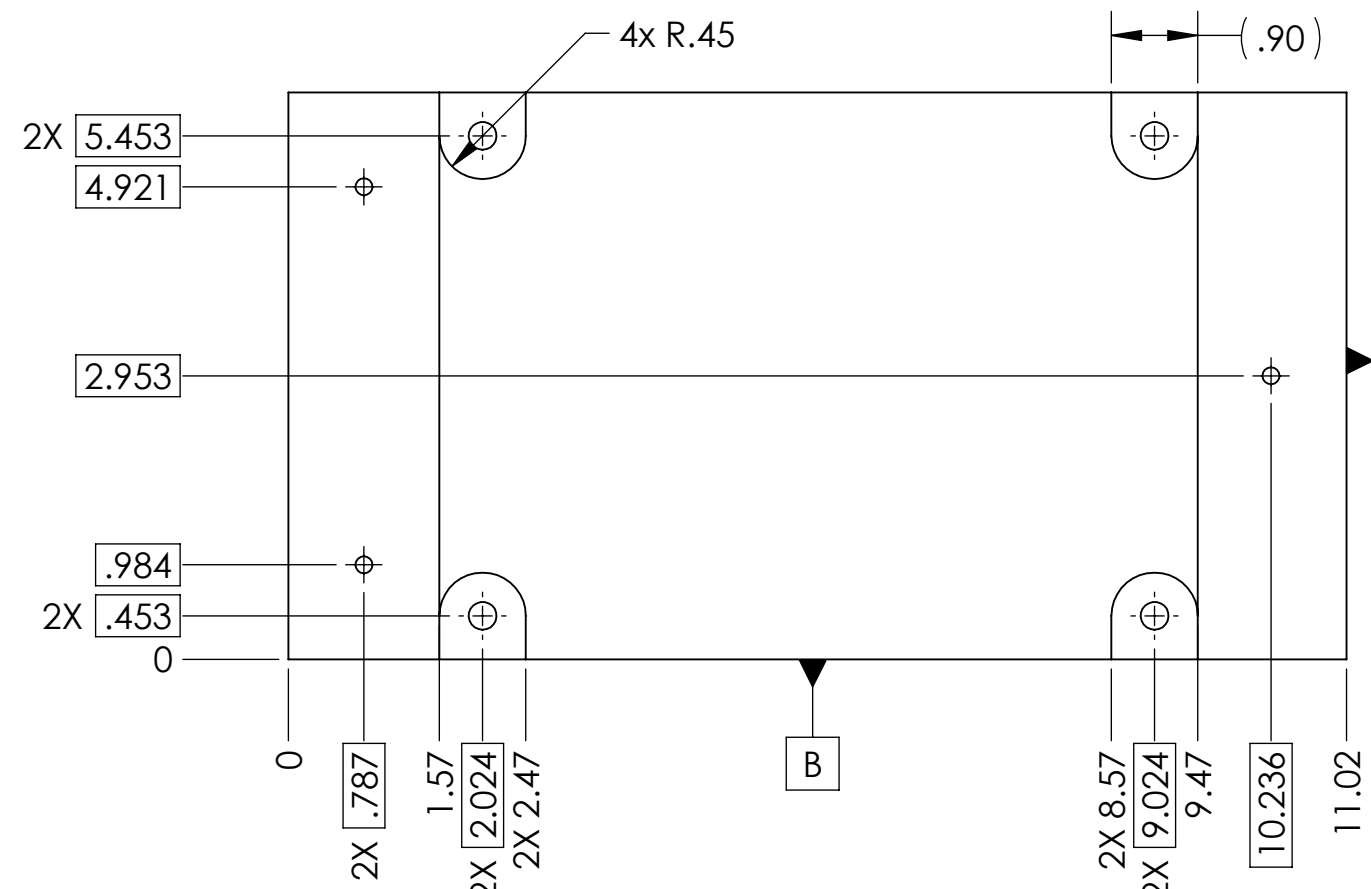

4X  $\phi$  .29 THRU  
 $\phi$  .014 (M) A B C

3X  $\phi$  .177 THRU ALL  
 $\phi$  .315  $\nabla$  1.283  
 $\phi$  .012 (M) A B C

**NOTES AND TOLERANCES: (UNLESS OTHERWISE SPECIFIED)**

DIMENSIONS ARE IN INCHES [MM]

TOLERANCES:  
 .XX  $\pm$  .01  
 .XXX  $\pm$  .005  
 ANGULAR  $\pm$  °

1. INTERPRET DRAWING PER ASME Y14.5-1994.  
 2. REMOVE ALL SHARP EDGES, .005-.015, FOR MACHINED PARTS. ROUND ALL EDGES APPROXIMATELY R.02 FOR SHEET METAL PARTS.  
 3. DO NOT SCALE FROM DRAWING.  
 4. ALL MACHINING FLUIDS MUST BE FULLY SYNTHETIC, FULLY WATER SOLUBLE AND FREE OF SULFUR, SILICONE, AND CHLORINE.

**MATERIAL** 6061-T6 Al **FINISH** 125  $\mu$ inch

<b>LIGO</b> CALIFORNIA INSTITUTE OF TECHNOLOGY MASSACHUSETTS INSTITUTE OF TECHNOLOGY		<b>PART NAME</b> Base InnoLight Prometheus	
<b>SYSTEM</b> ADVANCED LIGO	<b>SUB-SYSTEM</b> ISC	<b>DESIGNER</b> BJJ Slagmolen	<b>SIZE DWG. NO.</b> B D1100314
<b>DRAFTER</b> B. Slagmolen	25 Feb 2001	<b>CHECKER</b> SBARNUM	1 JUL 2013
<b>APPROVAL</b> PFRITSCHEL	1 JUL 2013	<b>REV.</b> v3	SHEET 1 OF 1

D1100314\_Base\_InnoLight\_Prometheus, PART PDM REV: X-000, DRAWING PDM REV: X-000

8 7 6 5 4 3 2 1