

NOTES CONTINUED:

- 4. VENDOR REFERENCES ARE PROVIDED AS EXAMPLES OF PARTS MEETING ALL REQUIRED SPECIFICATIONS. EQUIVALENTS ARE ALWAYS ACCEPTABLE UNLESS OTHERWISE SPECIFIED.
- 5. REFER TO LIGO E0900357 FOR ASSEMBLY AND LOADING PROCEDURE.

REV.	DATE	DCN #	DRAWING TREE #
v1	7 Mar 2011	E1100015	E1100016

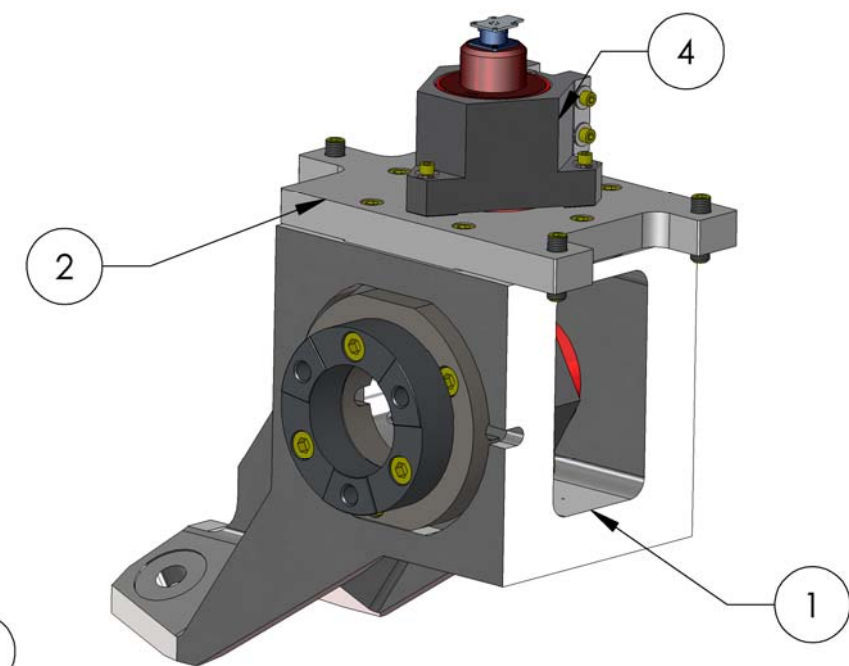
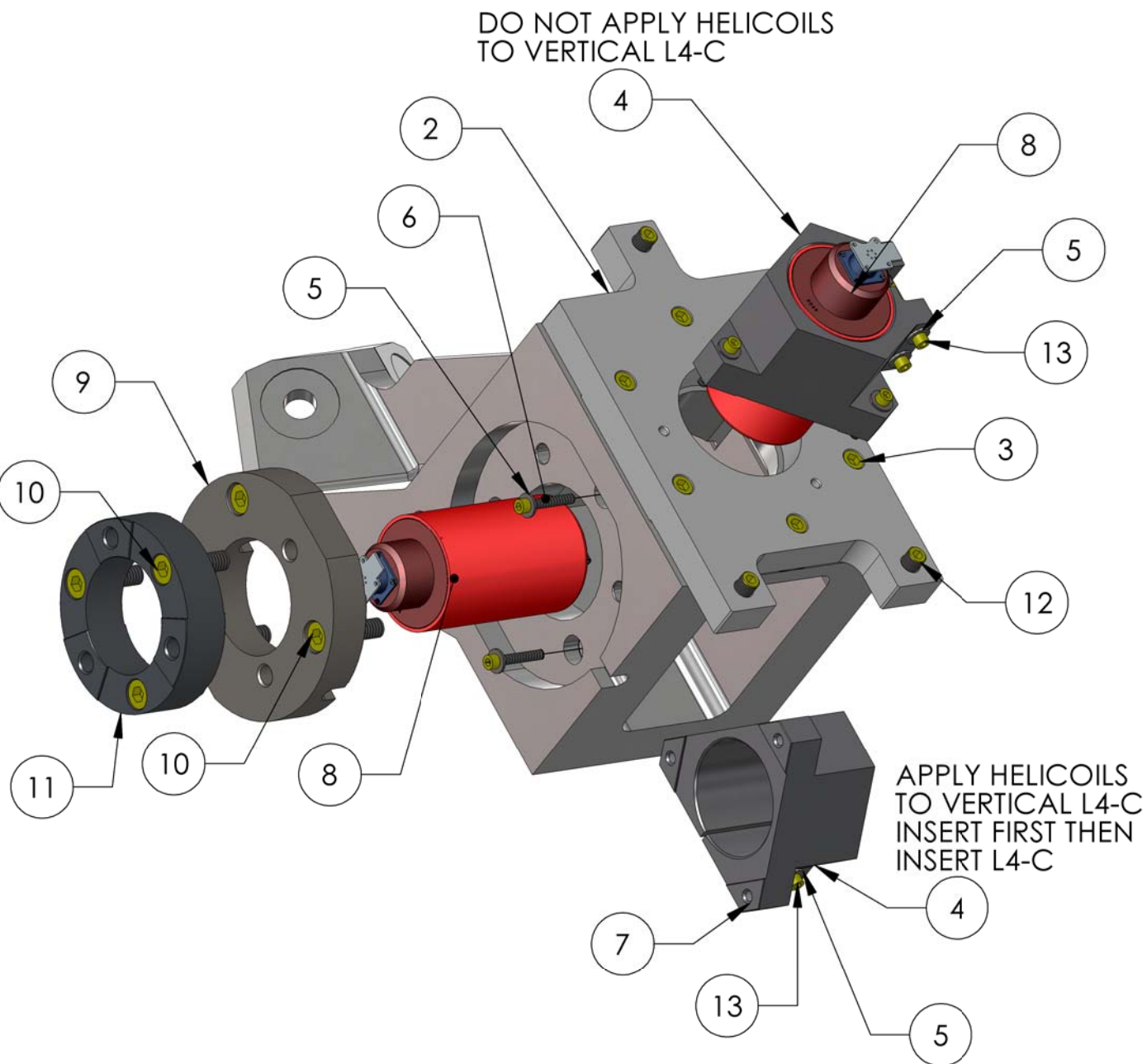

13	McMASTER_92196A553	SCREW 1/4-20 X 2 3/4 LG SHCS, 1" TO FULLY THREADED	18-8 SSTL	4
12	McMASTER_92311A747	SET SCREW, CUP POINT, 1/2-20 X 1.75 LG.	18-8 SSTL	3
11	D080548	HAM HEPI Horz Actuator Adapter 2	AISI 1020 Steel, Cold Rolled	1
10	McMASTER_92196A387	SCREW 1/2-20 X 1 1/2 LG SCHS	18-8 SSTL	6
9	D080547	HAM HEPI Horz Actuator Adapter 1	AISI 1020 Steel, Cold Rolled	1
8	L4-C	SEISMOMETER ASSEMBLY	SEE BOM	2
7	1185-4EN500	HELICOIL 1/4-20 X 2DIA	NITRONIC 60	5
6	HOLOKROME 78066	SCREW 1/4-20 X 1 1/2 LG SHCS	18-8 SSTL	6
5	McMASTER_90126A029	WASHER .281 ID X .63 OD X .05-0.8 THK	Alloy Steel	10
4	D030586	HEPI L4-C Mount	6061-T6 Al	2
3	HOLOKROME_78100	SCREW, 3/8-16 X 1 1/4 LG, SHCS	18-8 SSTL	6
2	D080546	HAM HEPI VERT L4-C ADAPTOR	AISI 1018 Steel, Cold Rolled	1
1	D020195-03	HEPI CROSSBEAM FOOT LEFT, aLIGO HAM	Low Carbon Steel	1
ITEM NO.	PART NUMBER	DESCRIPTION	MATERIAL	QTY

**NOTES AND TOLERANCES: (UNLESS OTHERWISE SPECIFIED)**

1. INTERPRET DRAWING PER ASME Y14.5-1994.  
 2. REMOVE ALL SHARP EDGES, .03 x 45°.  
 3. DO NOT SCALE FROM DRAWING.

DIMENSIONS ARE IN INCHES  
 TOLERANCES:  
 .XX ± N/A  
 .XXX ± N/A  
 ANGULAR ± N/A\*

**LIGO** CALIFORNIA INSTITUTE OF TECHNOLOGY MASSACHUSETTS INSTITUTE OF TECHNOLOGY  
 PART NAME: HEPI CROSSBEAM ATTACHMENT, aLIGO HAM LEFT

DESIGNER	A. STEIN	15 Apr, 2009	SIZE	DWG. NO.	REV.
DRAFTER	M.HILLARD	7 Mar 2011	B	D1100145	v1
CHECKER	K.MASON	7 Mar 2011	SCALE	1:4	PROJECTION
APPROVAL	K.MASON	7 Mar 2011	SHEET	1 OF 1	

MATERIAL: SEE BOM      FINISH: N/A μinch      NEXT ASSY: D1100144

D1100145 HEPI CROSSBEAM ATTACHMENT, aLIGO HAM LEFT, PART PDM REV: X-005, DRAWING PDM REV: X-001