

NOTES CONTINUED:  
 [5] TORQUE TO 30 IN-LB (3.4 N-M)  
 [6] TORQUE TO 5 IN-LB (0.5 N-M)  
 [7] TORQUE TO 11.5 IN-LB (1.3 N-M)  
 8 APPROXIMATE WEIGHT: 11.20 LB

TYPE (CONFIGURATION)	DESCRIPTION
-01	αLIGO, TCS, H2, X-ARM (SHOWN LEFT)
-02	αLIGO, TCS, H2, Y-ARM (MIRROR OF -01, SHOWN RIGHT)

REV.	DATE	DCN #	DRAWING TREE #
v3	22 AUG 2011	E1100655-v1	E1100656-v1

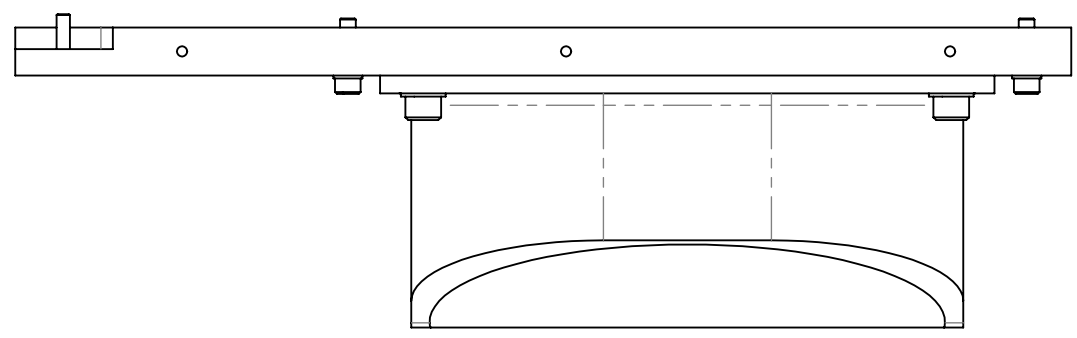
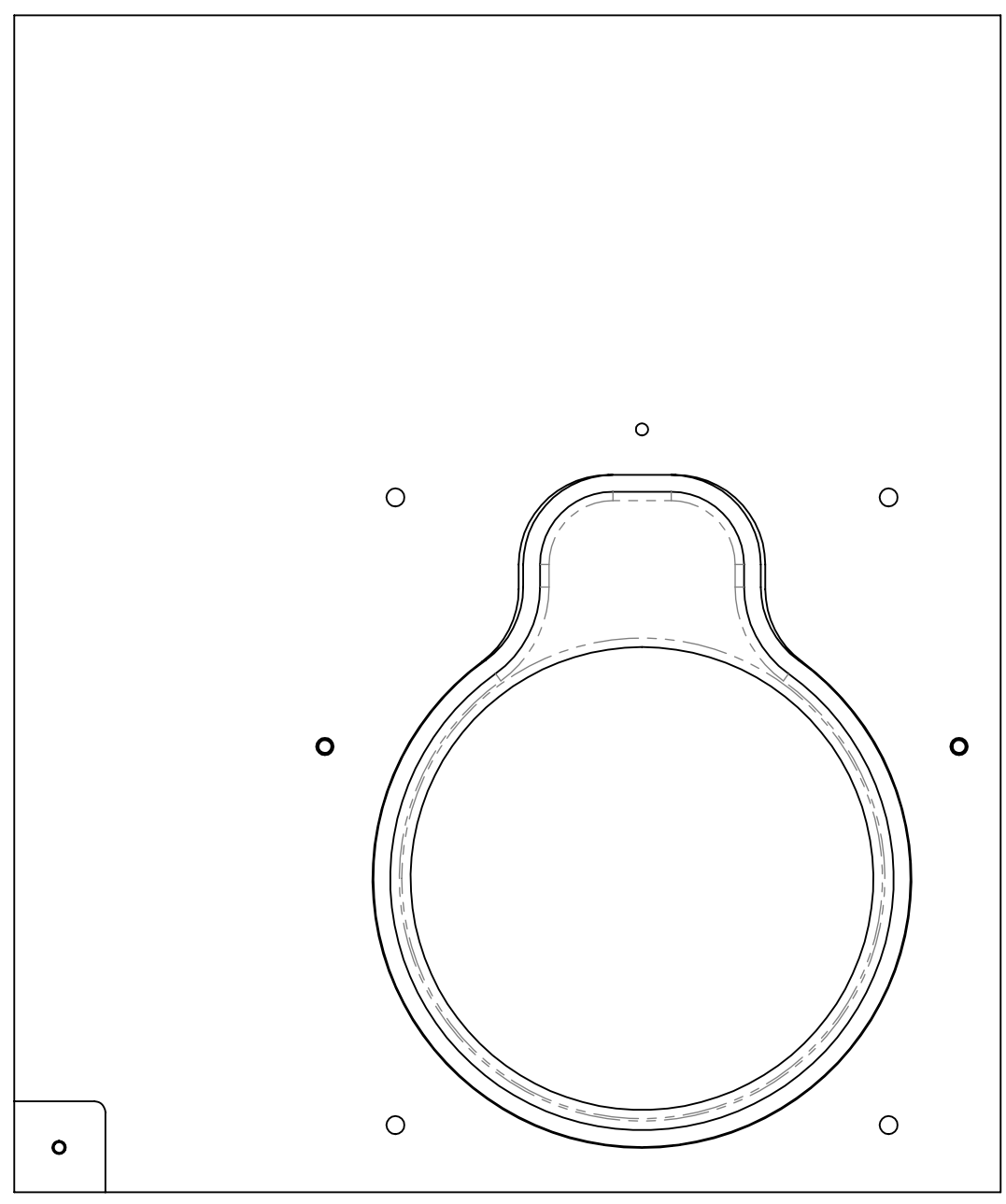
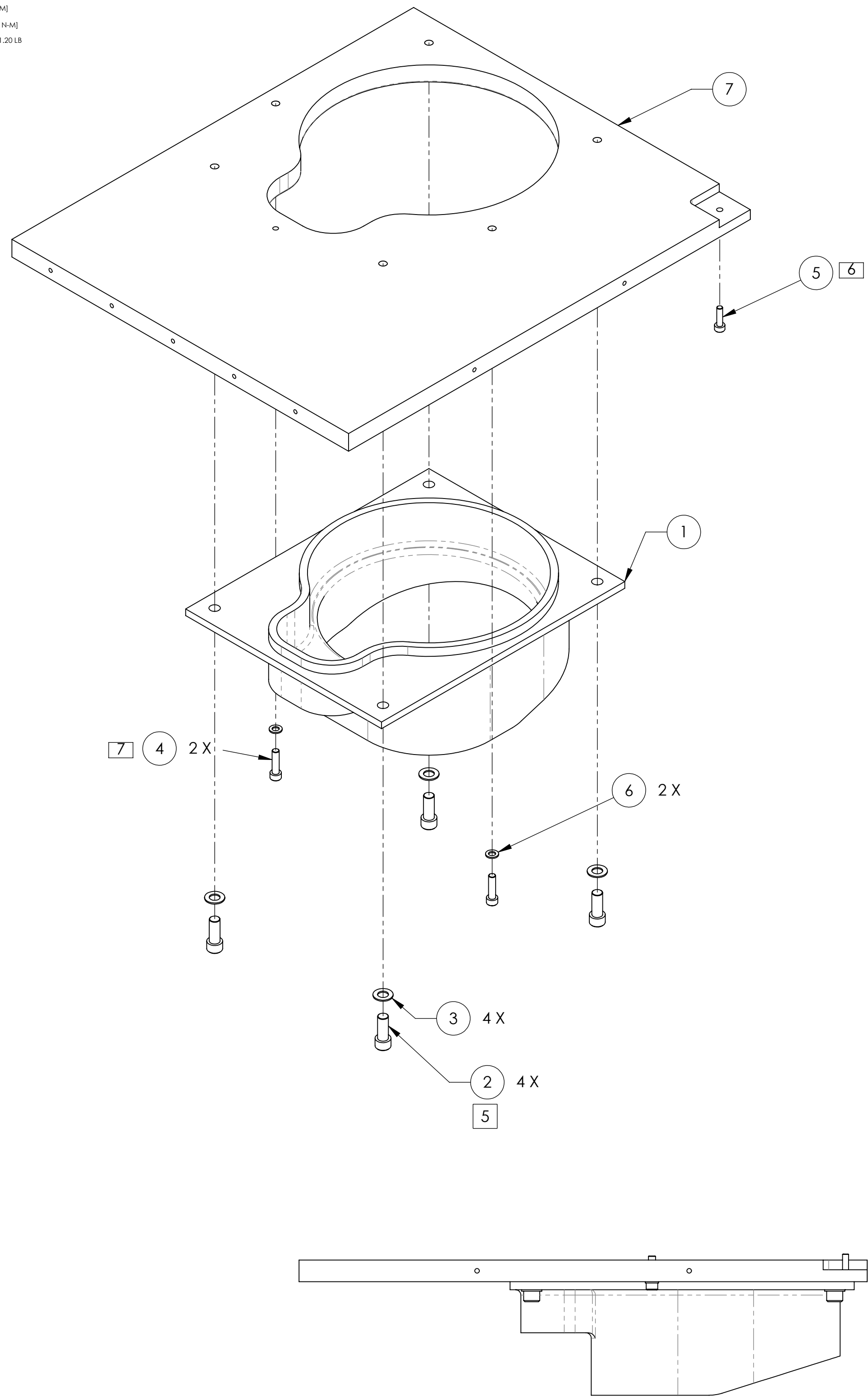

TYPE -01

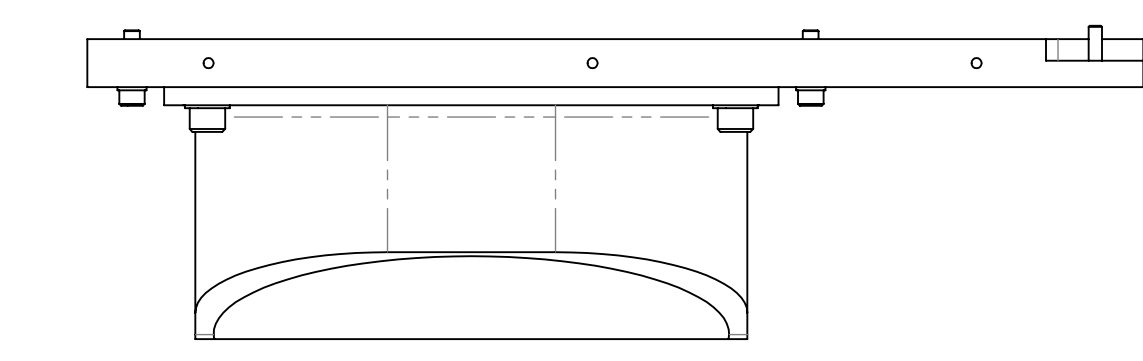
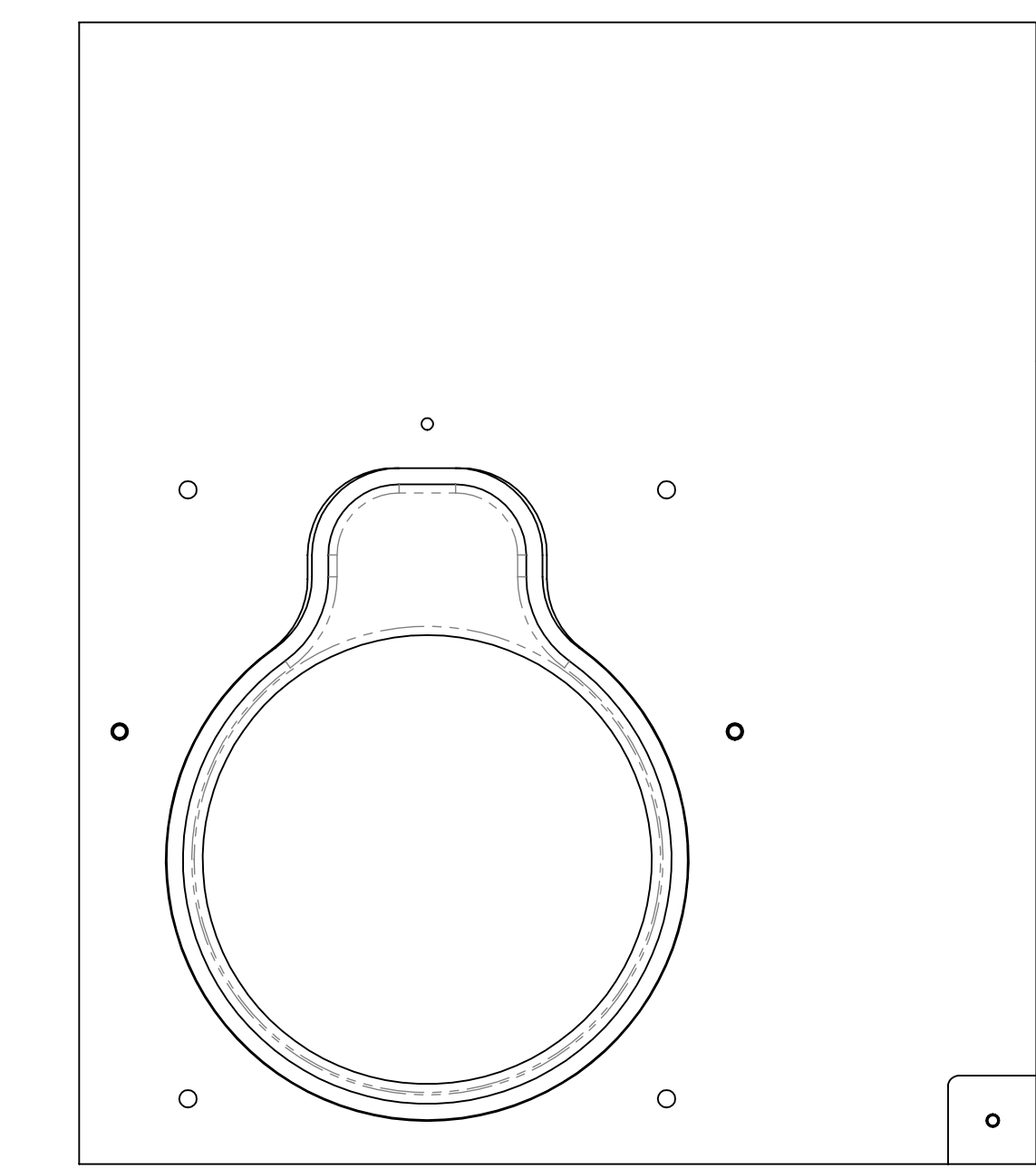

TYPE -02

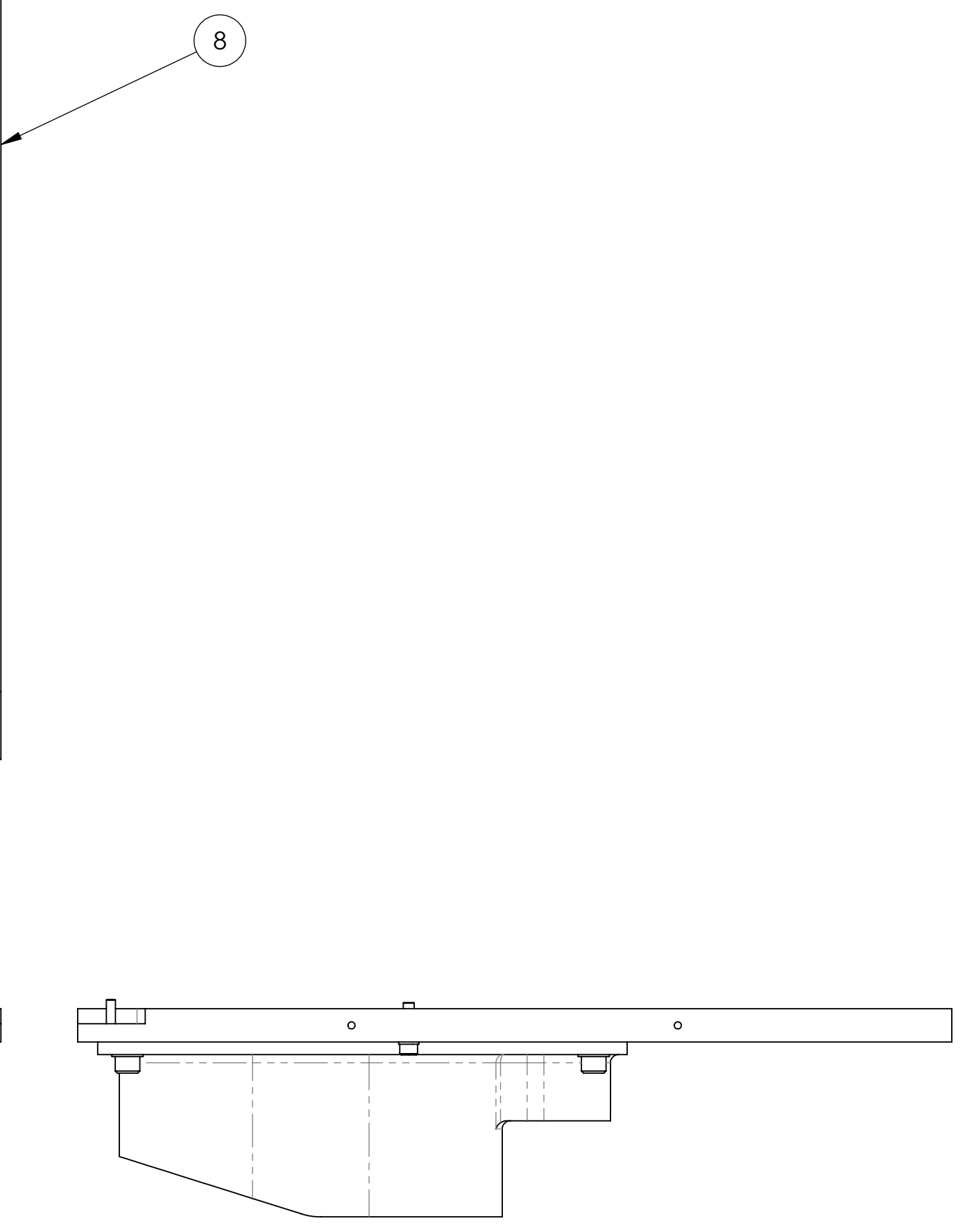

ITEM NO.	PART NUMBER	DESCRIPTION	MATERIAL	REQ/-01	REQ/-02	SPARE	TOTAL
8	D1003220-02	BOTTOM WALL, CO2P VP ENCLOSURE	6061 Alloy	-	1	0	1
7	D1003220-01	BOTTOM WALL, CO2P VP ENCLOSURE	6061 Alloy	1	-	0	1
6	WF-08	FLAT WASHER, #8, .169 ID, .304 OD, .032 THK	18-8 SSSL	2	2	2	6
5	C-608-N	SHCS #6-32 X 0.5	18-8 SSSL	1	1	2	4
4	C-810-N	SHCS #8-32 X 0.625	18-8 SSSL	2	2	2	6
3	WF-25	0.25in, FLAT WASHER, .255 ID, .468 OD, .032 Thick	18-8 SSSL	4	4	2	10
2	C-2010-N	SHCS 0.25-20 X 0.625	18-8 SSSL	4	4	2	10
1	D1003222	PERISCOPE INTERFACE FLANGE, FEMALE	AISI 304	1	1	0	2

NOTES AND TOLERANCES: (UNLESS OTHERWISE SPECIFIED)	
1. INTERPRET DRAWING PER ASME Y14.5-1994. 2. REMOVE ALL SHARP EDGES, .005-.015, FOR MACHINED PARTS. ROUND ALL EDGES APPROXIMATELY R.02 FOR SHEET METAL PARTS. 3. DO NOT SCALE FROM DRAWING. 4. ALL MACHINING FLUIDS MUST BE FULLY SYNTHETIC, FULLY WATER SOLUBLE AND FREE OF SULFUR, SILICONE, AND CHLORINE.	
DIMENSIONS ARE IN INCHES	
TOLERANCES: .XX ± .01 .XXX ± .005	
ANGULAR ± °	
MATERIAL	N/A
FINISH	N/A μinch

**LIGO** CALIFORNIA INSTITUTE OF TECHNOLOGY  
 MASSACHUSETTS INSTITUTE OF TECHNOLOGY

SYSTEM: ADVANCED LIGO      SUB-SYSTEM: AOS

NEXT ASSY: D1003193

PART NAME: VP ENCLOSURE LOWER WALL ASSY, CO2P

DESIGNER	A. LANGLEY	21 MAR 2011	SIZE	DWG. NO.	REV.
DRAFTER	A. LYNCH	08 AUG 2011	D	D1003221	v3
CHECKER	M. JACOBSON	22 AUG 2011			
APPROVAL	A. BROOKS	23 AUG 2011	SCALE: 1:2	PROJECTION:	SHEET 1 OF 1

D1003221\_VP ENCLOSURE LOWER WALL ASSY, CO2P, PART PDM REV: X-058, DRAWING PDM REV: X-023