

NOTES CONTINUED:

5. SCRIBE, ENGRAVE (A VIBRATORY TOOL MAY BE USED), LASER MARK OR MECHANICALLY STAMP (NO INKS OR DYES) DRAWING PART NUMBER, REVISION (AND VARIANT OR 'TYPE' IF APPLICABLE) ON NOTED SURFACE OF PART FOLLOWED ON THE NEXT LINE WITH A THREE DIGIT SERIAL NUMBER. SERIAL NUMBERS START AT 001 FOR THE FIRST ARTICLE AND PROCEED CONSECUTIVELY. USE MINIMUM 0.12" HIGH CHARACTERS, UNLESS THE SIZE OF THE PART DICTATES SMALLER CHARACTERS. EXAMPLE: DXXXXXX-VY, TYPE-XX, S/N XXX

6. APPROXIMATE WEIGHT = 4.998 LB.

7. MACHINE ALL SURFACES TO REMOVE OXIDES AND MILL FINISH. USE OF ABRASIVE REMOVAL TECHNIQUES IS NOT ALLOWED. REFER TO LIGO-E0900364

8. ALL PARTS SHALL BE MANUFACTURED IN ACCORDANCE WITH LIGO SPECIFICATION E0900364.

9. ALL MATERIAL IS TO BE VIRGIN MATERIAL (i.e. NO WELD REPAIRS, PLUGS OR RECYCLED MATERIAL). NO REPAIRS SHALL BE MADE UNLESS APPROVED IN ADVANCE, AND IN WRITING, BY LIGO LABORATORY. REFER TO LIGO-E0900364.

TYPE (CONFIGURATION)	DESCRIPTION
-01	αLIGO, TCS, H2, X-ARM (SHOWN)
-02	αLIGO, TCS, H2, Y-ARM (MIRROR OF -01)

REV.	DATE	DCN #	DRAWING TREE #
v1	25 JUL 2011	E1100655-v1	E1100656-v1
-	-	-	-
-	-	-	-

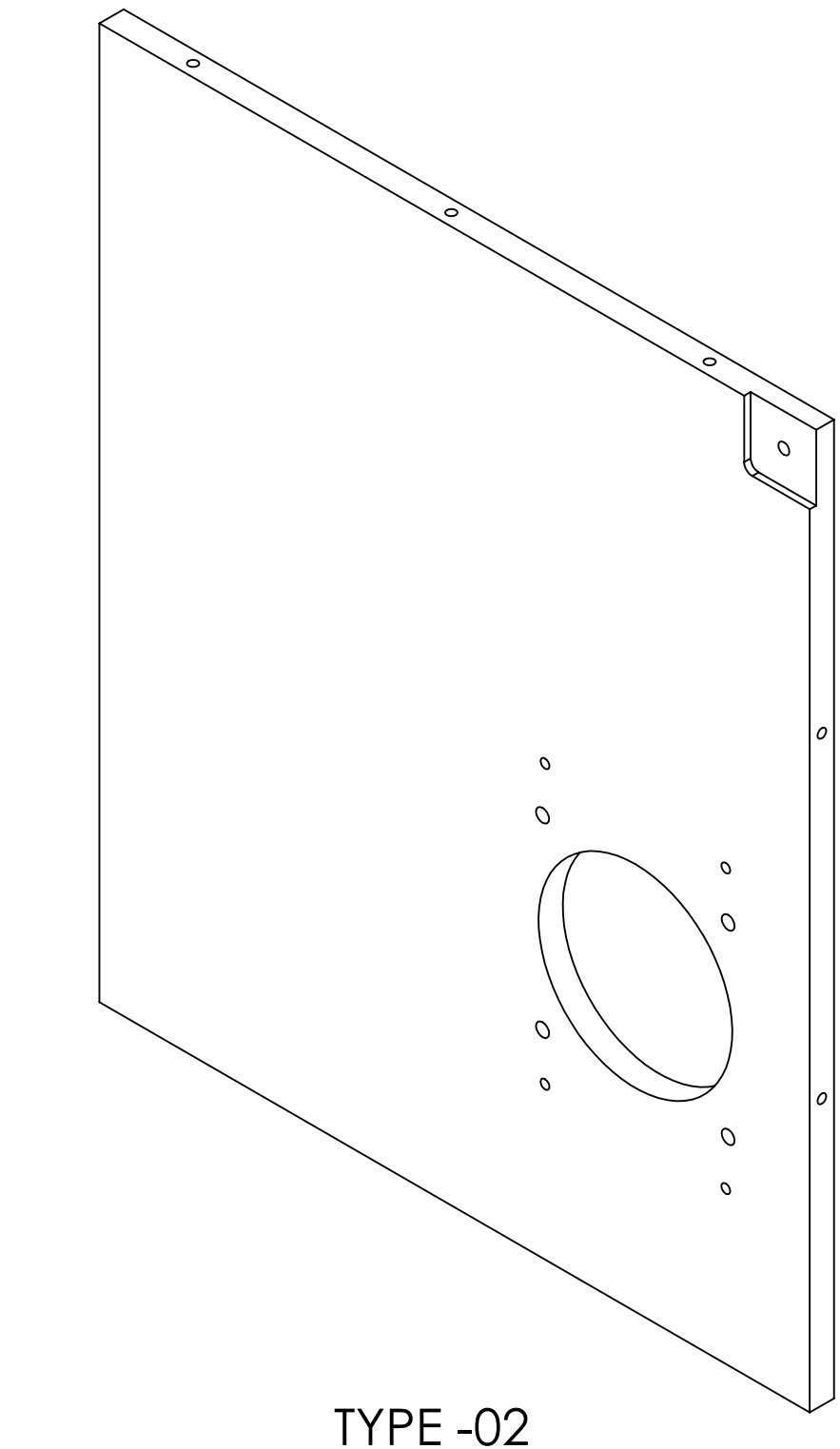
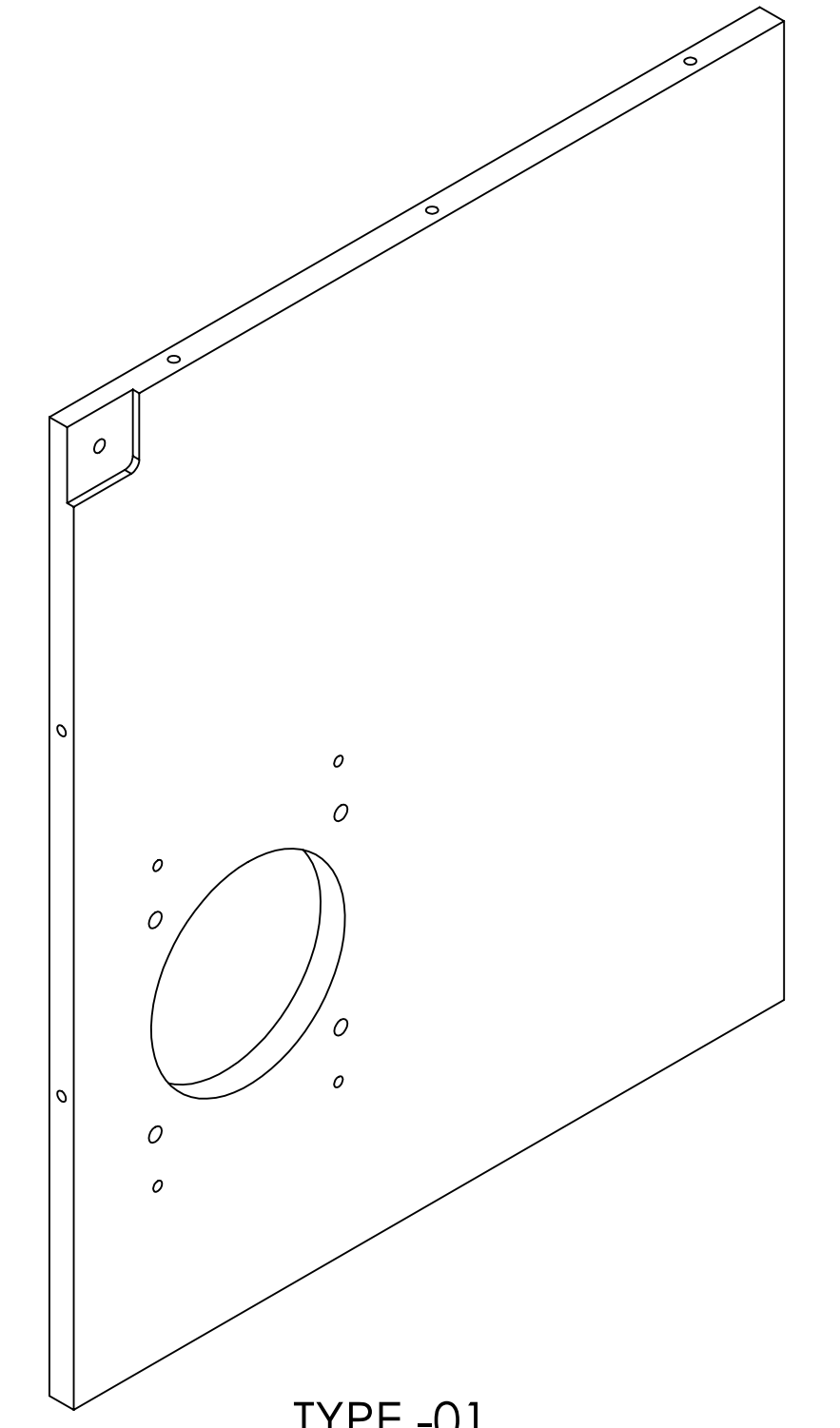
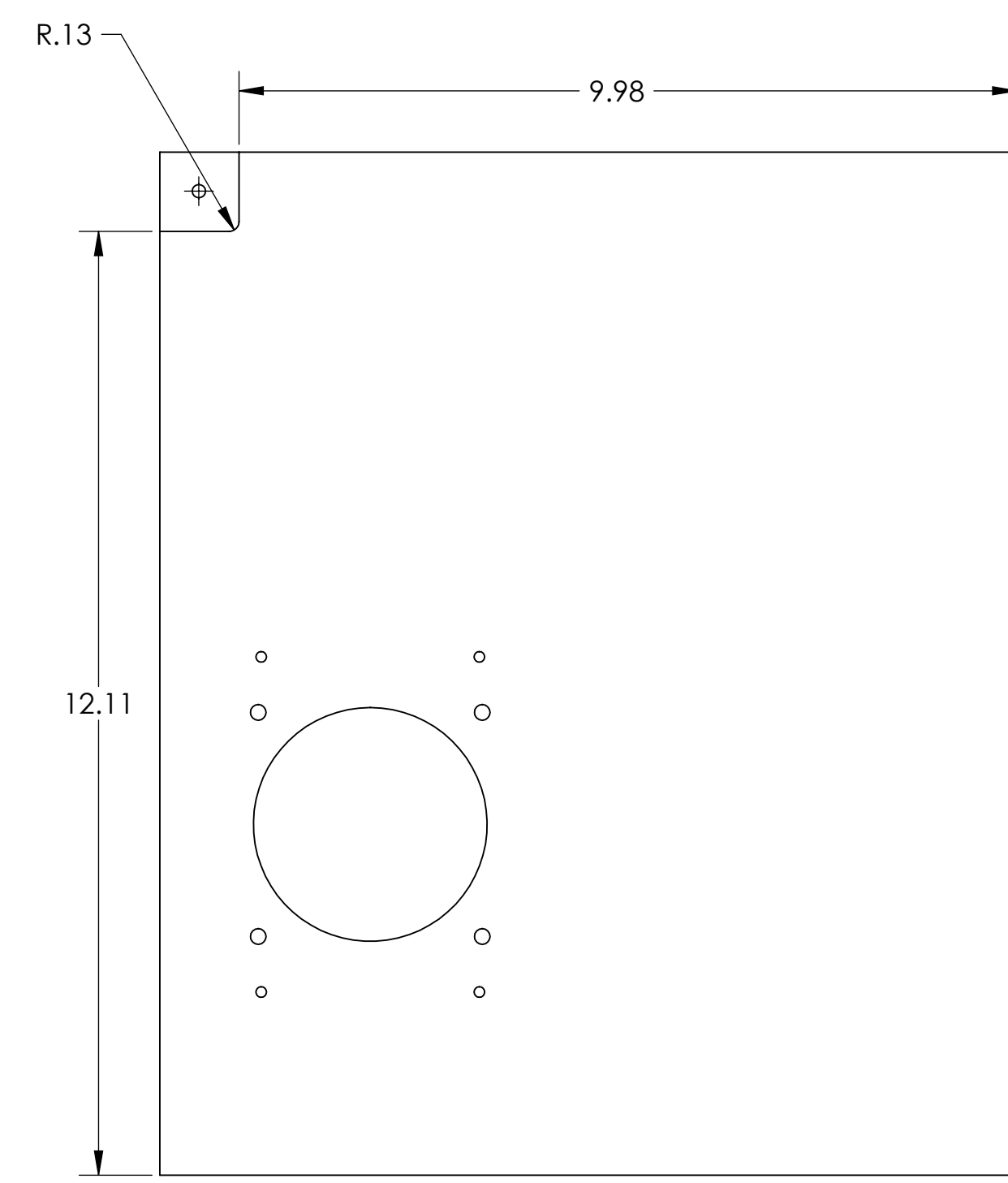
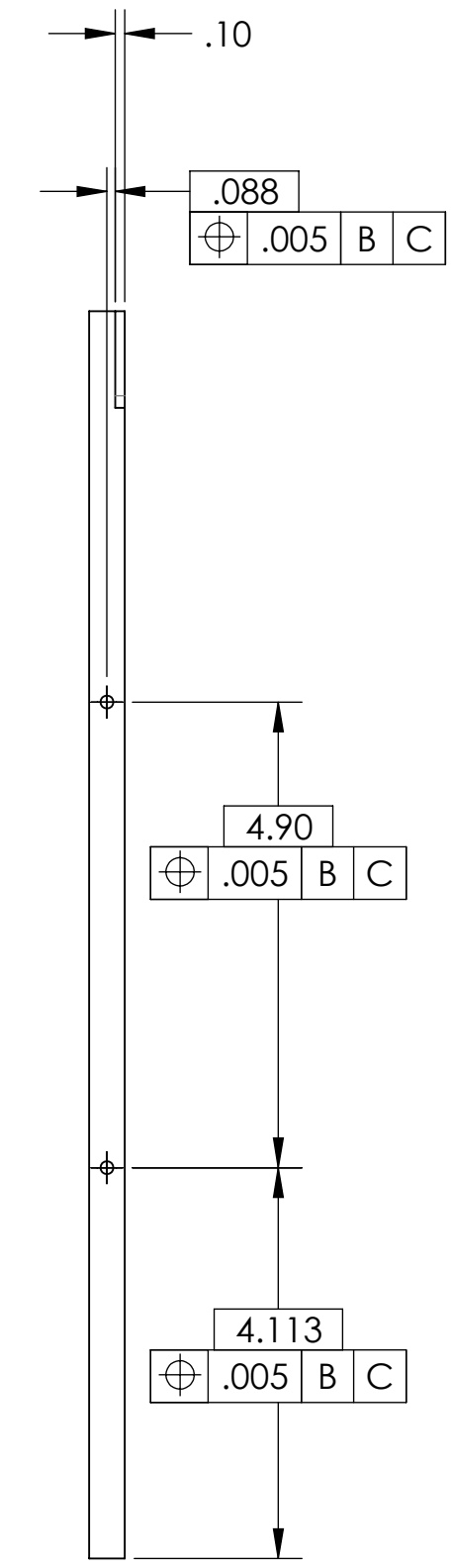
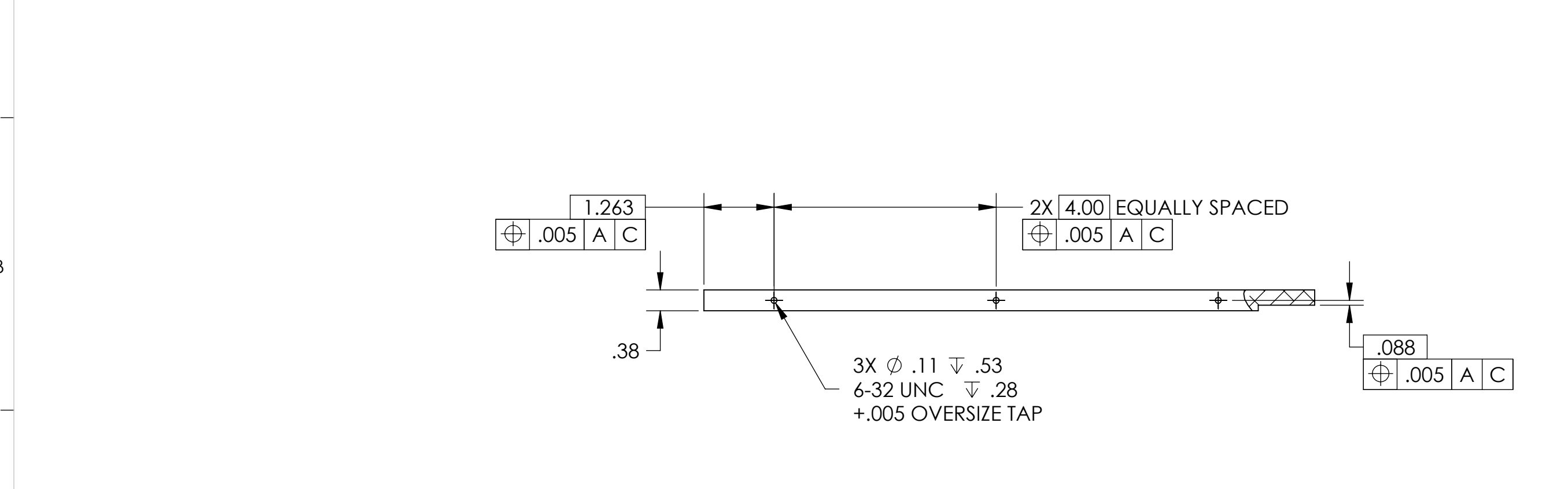
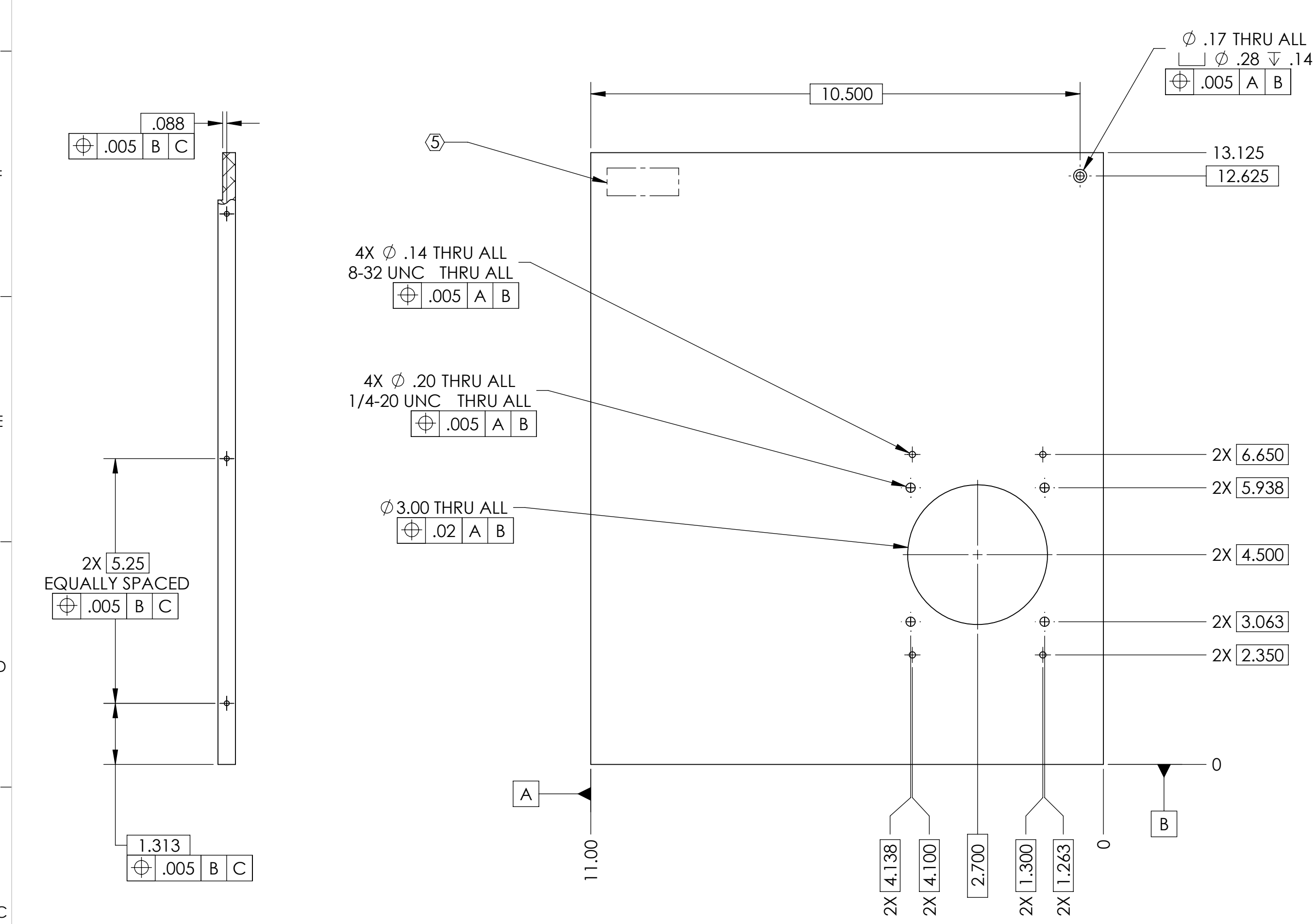
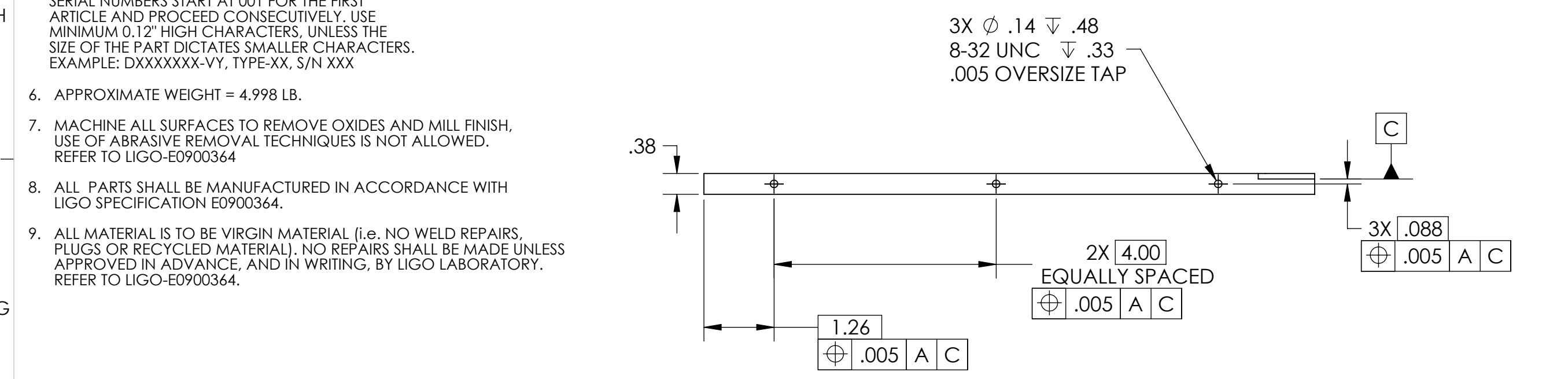

NOTES AND TOLERANCES: (UNLESS OTHERWISE SPECIFIED)

- INTERPRET DRAWING PER ASME Y14.5-1994.
- REMOVE ALL SHARP EDGES, .005-.015, FOR MACHINED PARTS. ROUND ALL EDGES APPROXIMATELY R.02 FOR SHEET METAL PARTS.
- DO NOT SCALE FROM DRAWING.
- ALL MACHINING FLUIDS MUST BE FULLY SYNTHETIC, FULLY WATER SOLUBLE AND FREE OF SULFUR, SILICONE, AND CHLORINE.

DIMENSIONS ARE IN INCHES

TOLERANCES:
 .XX ± .01
 .XXX ± .005

ANGULAR ± 1.0°

MATERIAL 6061 Alloy **FINISH** 63 μinch

SYSTEM CALIFORNIA INSTITUTE OF TECHNOLOGY MASSACHUSETTS INSTITUTE OF TECHNOLOGY **PART NAME** VP ENCLOSURE TOP WALL, CO2P

ADVANCED LIGO **AOS**

DESIGNER A. COLE 02 DEC 2010 **SIZE** DWG. NO. **REV.** v1

DRAFTER A. LYNCH 11 JUL 2011 **D** **D1003214**

CHECKER M. JACOBSON 11 JUL 2011 **SCALE:** 1:2 **PROJECTION:** **SHEET 1 OF 1**

APPROVAL P. WILLEMS 11 JUL 2011 **NEXT ASSY** D1003193

D1003214_VP ENCLOSURE TOP WALL CO2P PART PDM REV. X-0302 DRAWING PDM REV. X-012