

NOTES CONTINUED:

- 5. FULL WELDED CONSTRUCTION.
- 6. PART NUMBER (DRAWING NO. PLUS REVISION AND "SET #") TO BE CLEARLY MARKED ON THE PART
EXAMPLE: **D1002126 V1 SET OF 4 # 1** (~ 1" CHARACTERS) (ONE SET IS 4 LEGS)
- 7. BEFORE FINISHING REMOVE ALL: MILL SCALE, OXIDATION, GREASE, OIL, DIRT, FINGER PRINTS, ETC.
- 8. PRIME WITH SHERWIN WILLIAMS INDUSTRIAL WASH PRIMER "**P60G2**" PER SPECIFICATION.
- 9. PAINT SMOOTH WHITE, SHERWIN WILLIAMS "**POLANE HS-PLUS**" POLYURETHANE ENAMEL P/N F63W66.

REV.	DATE	DCN #	DRAWING TREE #
V1	20 OCT 2010	E1000340	-
-	-	-	-
-	-	-	-

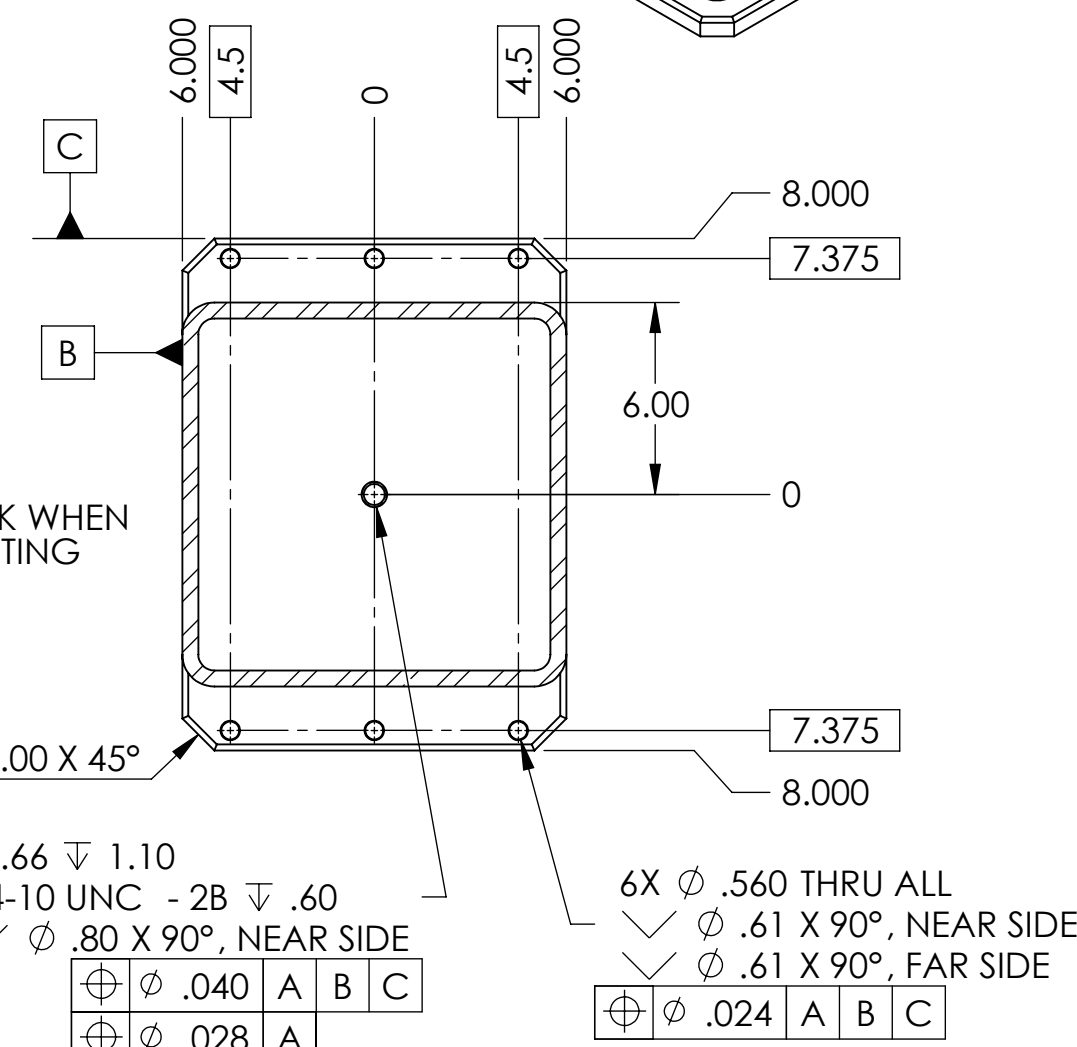
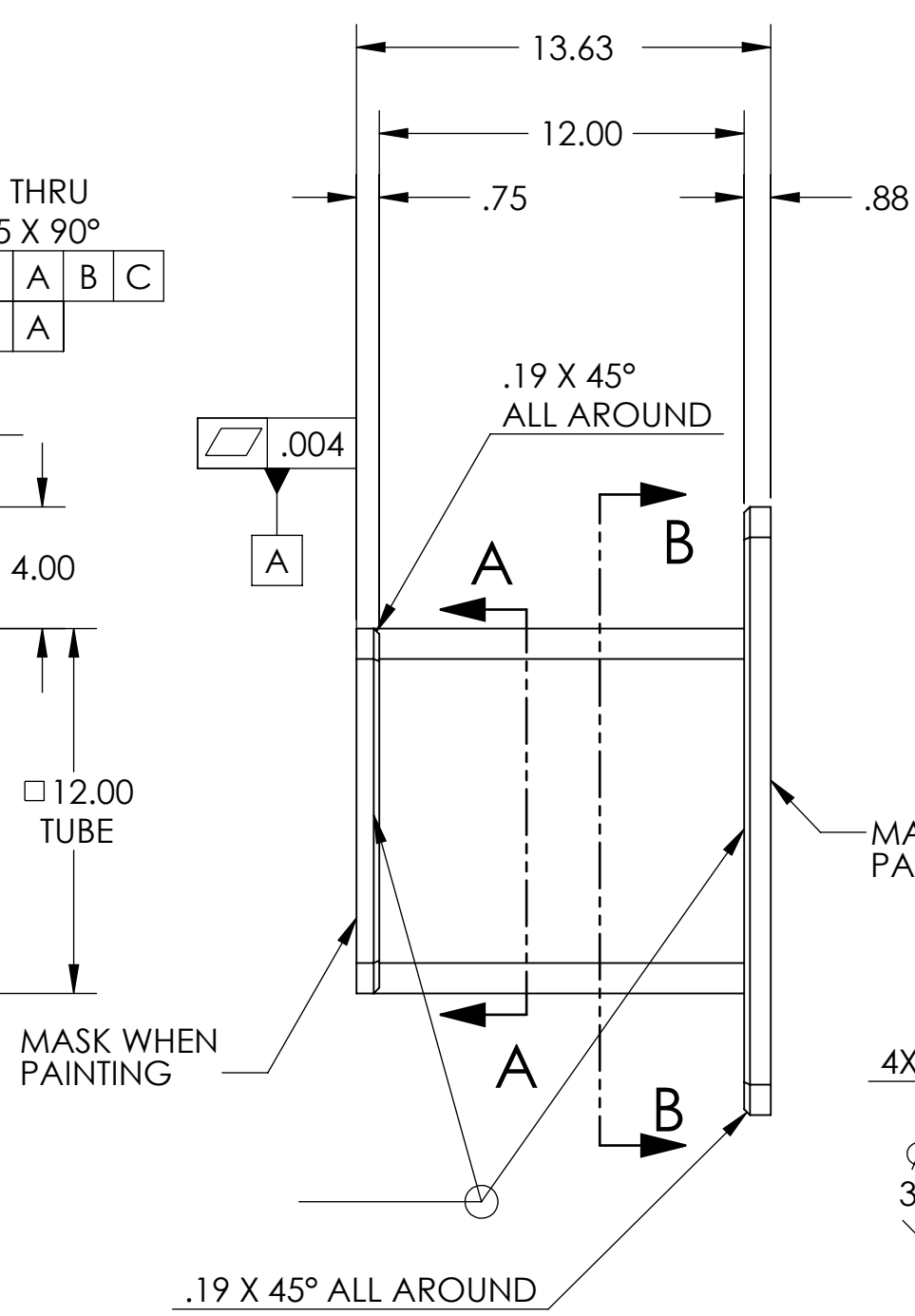
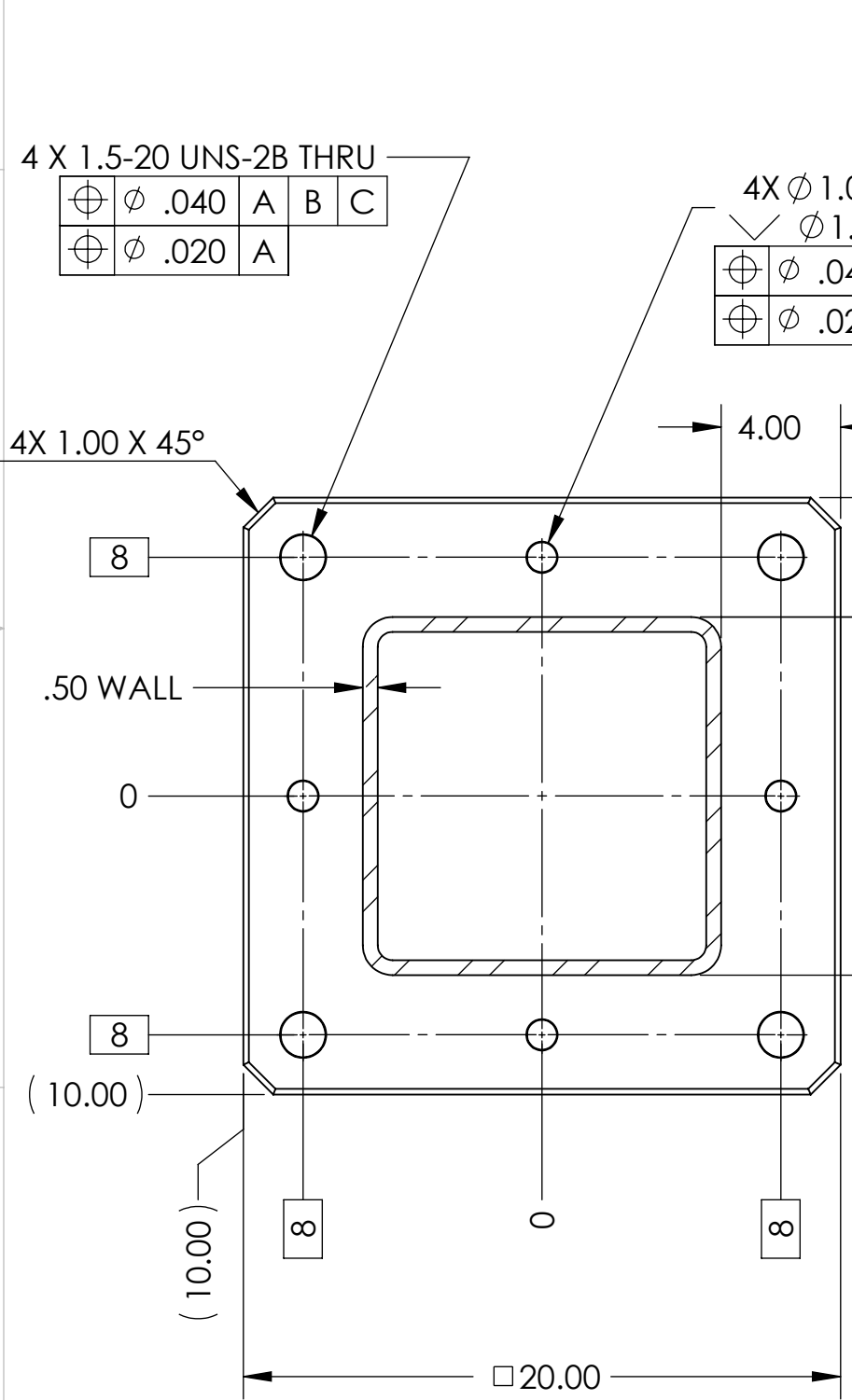
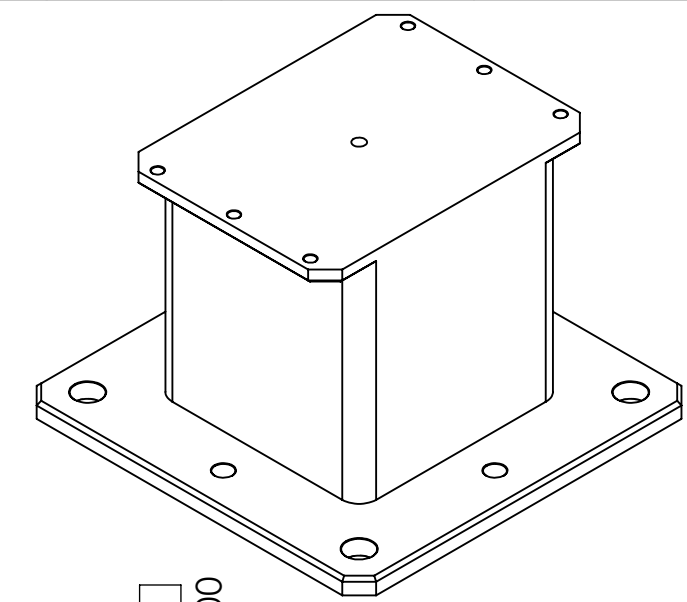

SECTION B-B

SECTION A-A

NOTES AND TOLERANCES: (UNLESS OTHERWISE SPECIFIED)

DIMENSIONS ARE IN INCHES
 TOLERANCES:
 .XX ± .025
 .XXX ± .010
 ANGULAR ± .5°

1. INTERPRET DRAWING PER ASME Y14.5-1994.
 2. REMOVE ALL SHARP EDGES, R.02 MIN.
 3. DO NOT SCALE FROM DRAWING.
 4. ALL MACHINING FLUIDS MUST BE FULLY SYNTHETIC, FULLY WATER SOLUBLE AND FREE OF SULFUR, SILICONE, AND CHLORINE.

MATERIAL ASTM a500 Grade-B **FINISH** 125 μinch

LIGO CALIFORNIA INSTITUTE OF TECHNOLOGY
 MASSACHUSETTS INSTITUTE OF TECHNOLOGY

SYSTEM ADVANCED LIGO **SUB-SYSTEM** SEI

NEXT ASSY D1002124

PART NAME Foot, Stand, Test, BSC-ISI+Quad + HAM-ISI, aLIGO

DESIGNER sbarnum 10 Aug 2010 **SIZE** DWG. NO. **B**
DRAFTER SBARNUM 12 OCT 2010 **D1002661**
CHECKER MHILLARD 19 OCT 2010 **REV.** v1
APPROVAL KMASON 20 OCT 2010 **SCALE:** 1:6 **PROJECTION:** **SHEET 1 OF 1**

D1002661 Foot, Stand, Test, BSC-ISI+Quad + HAM-ISI, aLIGO, PART PDM REV: X-000, DRAWING PDM REV: