

6 5 4 3 2 1

NOTES: (UNLESS OTHERWISE SPECIFIED)  
~~Liquid contaminants/Machining Lubricants~~  
 Liquids containing hydrocarbons or other contaminants, other than the machining fluids specified herein, shall not be allowed to come into contact with suspension material at any time. All machining fluids shall be water soluble and free of sulfur, chlorine and silicone; such as Cincinnati Milacron's Cimtech 410 (stainless steel).

*Identification Serial Number*  
 A serial number shall be etched, or scribed on the part see note drawing note.

*Serial Number Format*  
 The Serial number shall be of the format:  
 D99xxxx-x-001

Example: D990021-A-001  
 The drawing number, The revision number, The sequential part number

Bag and Tag W/ Part No.

0.62  
 2 Pl.  
 S Stl Purchase Part  
 McMaster 1125A240

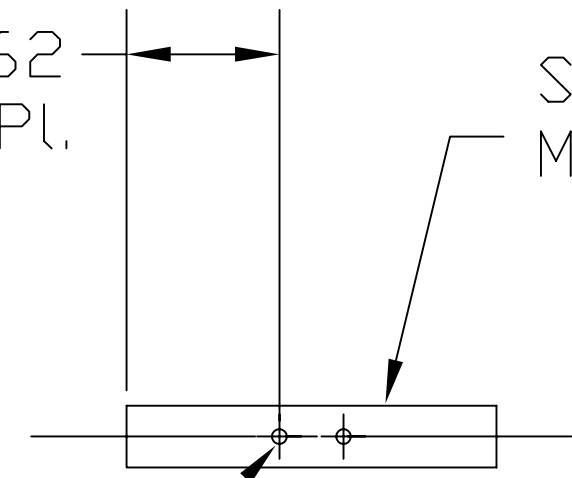

.06 Dia. Thru 2 Pl.

Modify: Drill Hole As Shown

Qty. Make 3 Per Assembly

| 4    | 1    | -                | -                           | -        |
|------|------|------------------|-----------------------------|----------|
| 3    | 2    | -                | -                           | -        |
| 2    | 1    | -                | -                           | -        |
| 1    | 1    | -                | -                           | -        |
| REF. | QTY. | PART or DRWG No. | NOMENCLATURE or DESCRIPTION | MATERIAL |

|                    |  |   |  |   |  |                 |  |                   |  |  |  |
|--------------------|--|---|--|---|--|-----------------|--|-------------------|--|--|--|
|                    |  | UNLESS OTHERWISE SPECIFIED DIMENSIONS ARE IN INCHES   |  |   |  |                 |  |                   |  | LIGO CALIFORNIA INSTITUTE OF TECHNOLOGY<br>MASSACHUSETTS INSTITUTE OF TECHNOLOGY |  |
|                    |  | TOLERANCES:<br>FRACTIONAL ± 1/32<br>THREE PLACE DECIMAL ± .005<br>TWO PLACE DECIMAL ± .01<br>ANGULAR ± 1 deg. |  | FINISHED SURFACE RMS 63<br>BREAK CORNERS and EDGES<br>ANGULAR MACH ± BEND ±--<br>REMOVE ALL BURRS |  |                 |  |                   |  | TITLE<br>PICK OFF MIRROR<br>Post, Mirror Clamp                                   |  |
|                    |  | MATERIAL:<br>S Stl Purchase Part<br>McMaster 1125A240   |  | HEAT TREAT:<br>none   |  | FINISH:<br>none |  | 00                |  | KEM 6/28/99  |  |
| DWG. NO.           |  | DESCRIPTION   |  | USED ON: XXX  |  | NEXT ASS'Y: XXX |  | REV               |  | Kmiland 5/24/99  |  |
| REFERENCE DRAWINGS |  |   |  |   |  |                 |  | ISSUE DESCRIPTION |  | SCALE FULL   |  |

6 5 4 3 2 1