

NOTES: (UNLESS OTHERWISE SPECIFIED)

1. INTERPRET DRAWING PER ANSI Y14.5M-1982

△ MATERIAL: 6061-T6 ALUMINUM
 MAKE FROM TIERNAY METALS #10133-0503
 OR EQUIVALENT .625 X .625 X .094 X 90° <. FOR VENDOR INFORMATION, SEE TOP ASSEMBLY MATERIALS LIST D970006 OR D970007.

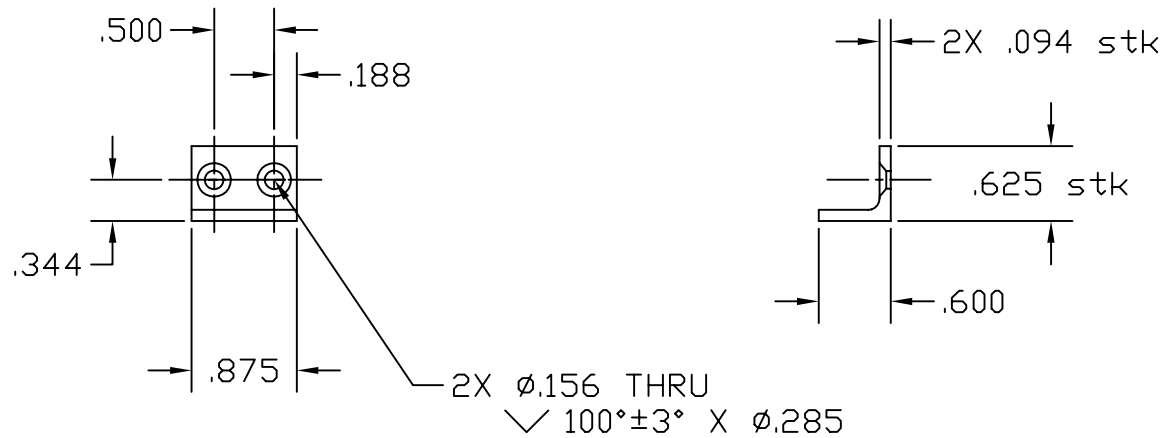

UNLESS OTHERWISE SPECIFIED
 DIMENSIONS ARE IN INCHES

TOLERANCES:
 FRACTIONAL ±
 ANGULAR ± 0.5°
 ANGULAR MACH ± BEND ±
 TWO PLACE DECIMAL ± .03

THREE PLACE DECIMAL ± .005
 FINISHED SURFACE 32 microinch average
 BREAK CORNERS IN OUT: .005-.010
 REMOVE ALL BURRS

LIGO CALIFORNIA INSTITUTE OF TECHNOLOGY
 MASSACHUSETTS INSTITUTE OF TECHNOLOGY

CORE OPTIC COMPONENT CARRIER
 LONG PAD GUIDE

MATERIAL: △	HEAT TREAT:	FINISH:
USED ON:	NEXT ASS'Y: D961450 & D961468	

REV	DESCRIPTION	CHECK	DATE	DRWN	DATE
A	DCN E980214-00			C. Conley	9-14-98

CAD FILE	SIZE	DWG. NO.
D980367-A.dwg	A	D980367-A-D
SCALE	NTS	SHEET 1 OF 1

ISSUE DESCRIPTION