

- DC - DIRECT CURRENT
- - PRIMARY POWER VAULT
- PS - POWER SUPPLY
- RET. - DC CABLE RETURN CONNECTION
- POS. - DC CABLE POSITIVE CONNECTION
- STA - PORT & STIFFENER RING STATION #'S  
WA, LA (IN METERS)
- ⊕ - PUMP PORT
- ⊥ - FIXED BEAM TUBE SUPPORT  
RING FOR DC CABLE CONNECTION

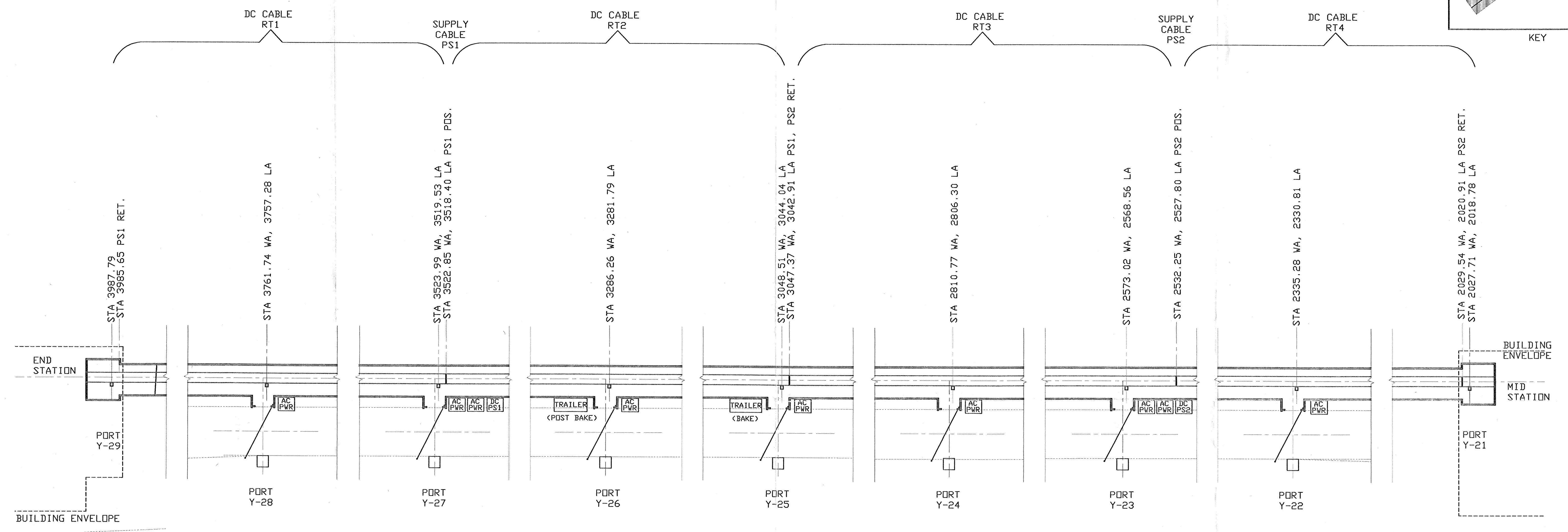
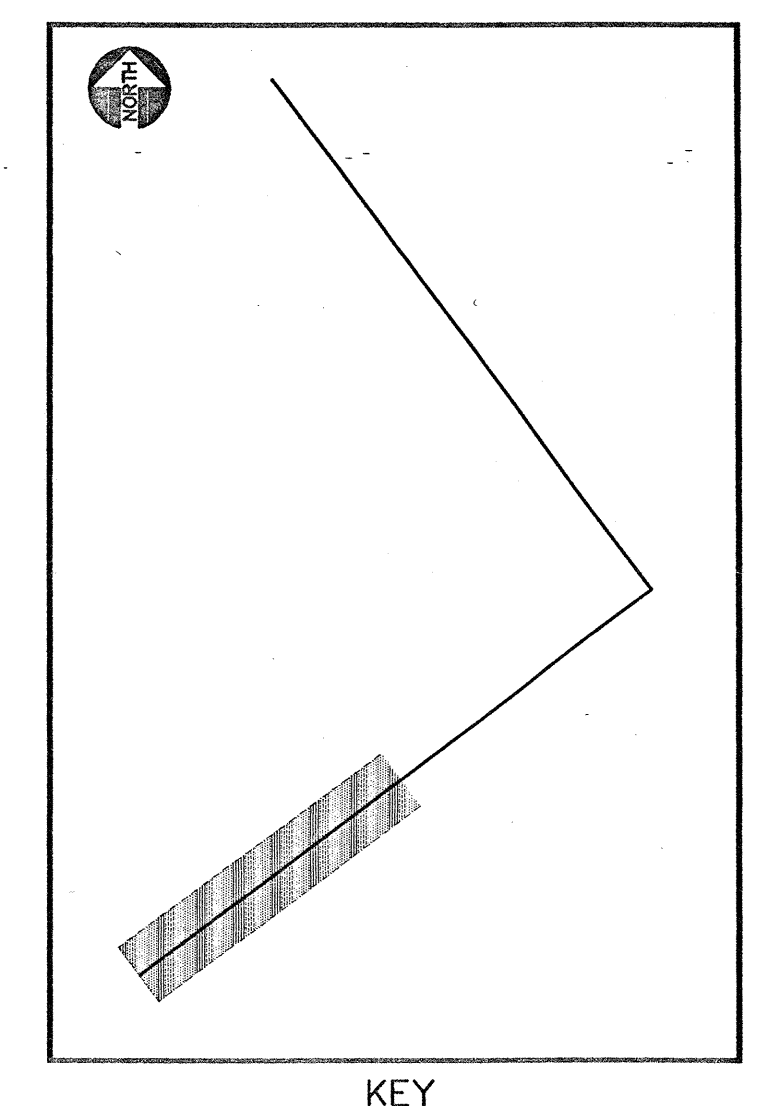

ASSEMBLY	QTY
A2	1
D	1
H1	2
H2	1
H3	1
H4	1
HJ1	5
HC	77
I	1
C11	3
C5	9
C7	1
HJ2	13

ASSEMBLY	QTY
A1	1
F1	1
E	1
H1	1
HJ1	1
HC	7
C2	6
C4	1

ASSEMBLY	QTY
A1	1
F2	1
E	1
B2	1
F3	1
D	1
H1	2
HJ1	1
HC	8
C4	2
C2	13

ASSEMBLY	QTY
A3	1
F1	1
E	1
H1	4
HJ1	2
HC	13
C2	15
C1	1
C4	1

ASSEMBLY	QTY
A3	1
F1	1
E	1
H1	5
HJ1	2
HC	14
D	1
C2	16
I	1
C1	1

ASSEMBLY	QTY
A1	1
F1	1
E	1
H1	1
HJ1	1
HC	7
C2	6
C4	1

ASSEMBLY	QTY
A1	1
F2	1
E	1
B1	1
F3	1
D	1
H1	2
HJ1	2
HC	11
C4	2
C2	11
C12	2

ASSEMBLY	QTY
A1	1
F1	1
E	1
H1	1
HJ1	1
HC	7
C2	6
C4	1

ASSEMBLY	QTY
A2	1
D	1
H1	2
H2	1
H3	1
H4	1
HJ1	5
HC	77
I	1
C11	3
C5	8
C7	1
C7	1
HJ2	13

NOTES

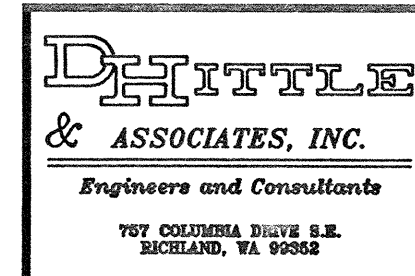
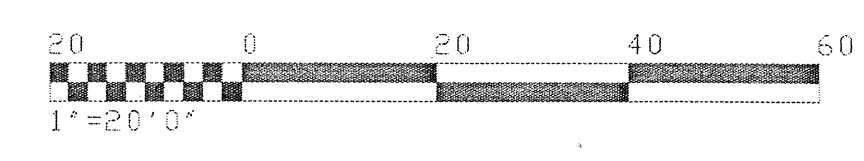

**LIGO**  
**HANFORD, WA AND LIVINGSTON, LA**

PLAN VIEW - BAKEOUT EQPT. ARRANGEMENT  
Y-2 MODULE  
LIGO-D 980097-00-W

DWN BY: GLM    DSN BY: GDW    CHK BY: JAS    DATE: 1/98    FILE: SECY1Y2    SCALE: 1"=20'0"