

8 7 6 5 4 3 2 1

REVISIONS			
REV.	DESCRIPTION	DATE	APPROVED

D

D

C

C

B

B

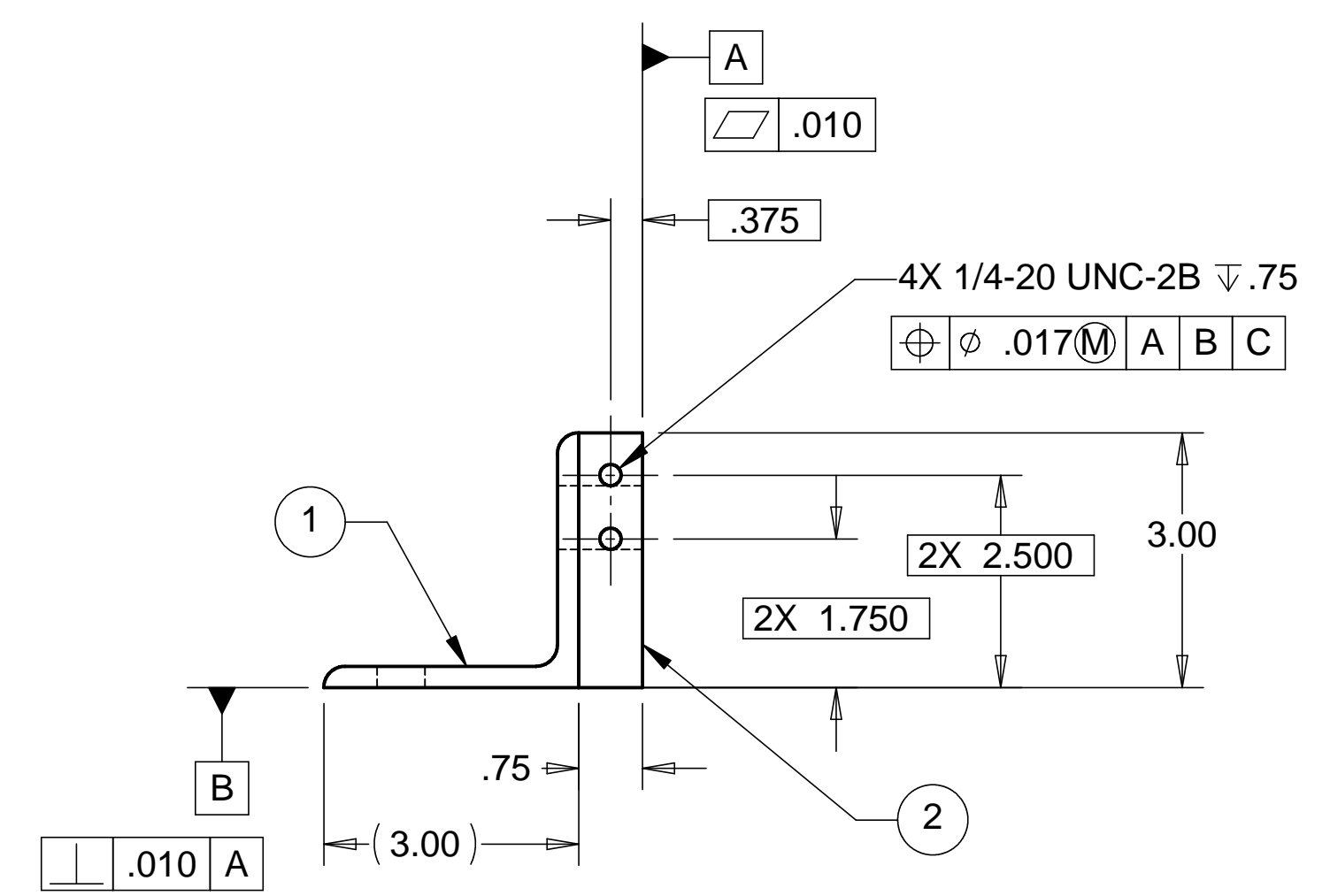
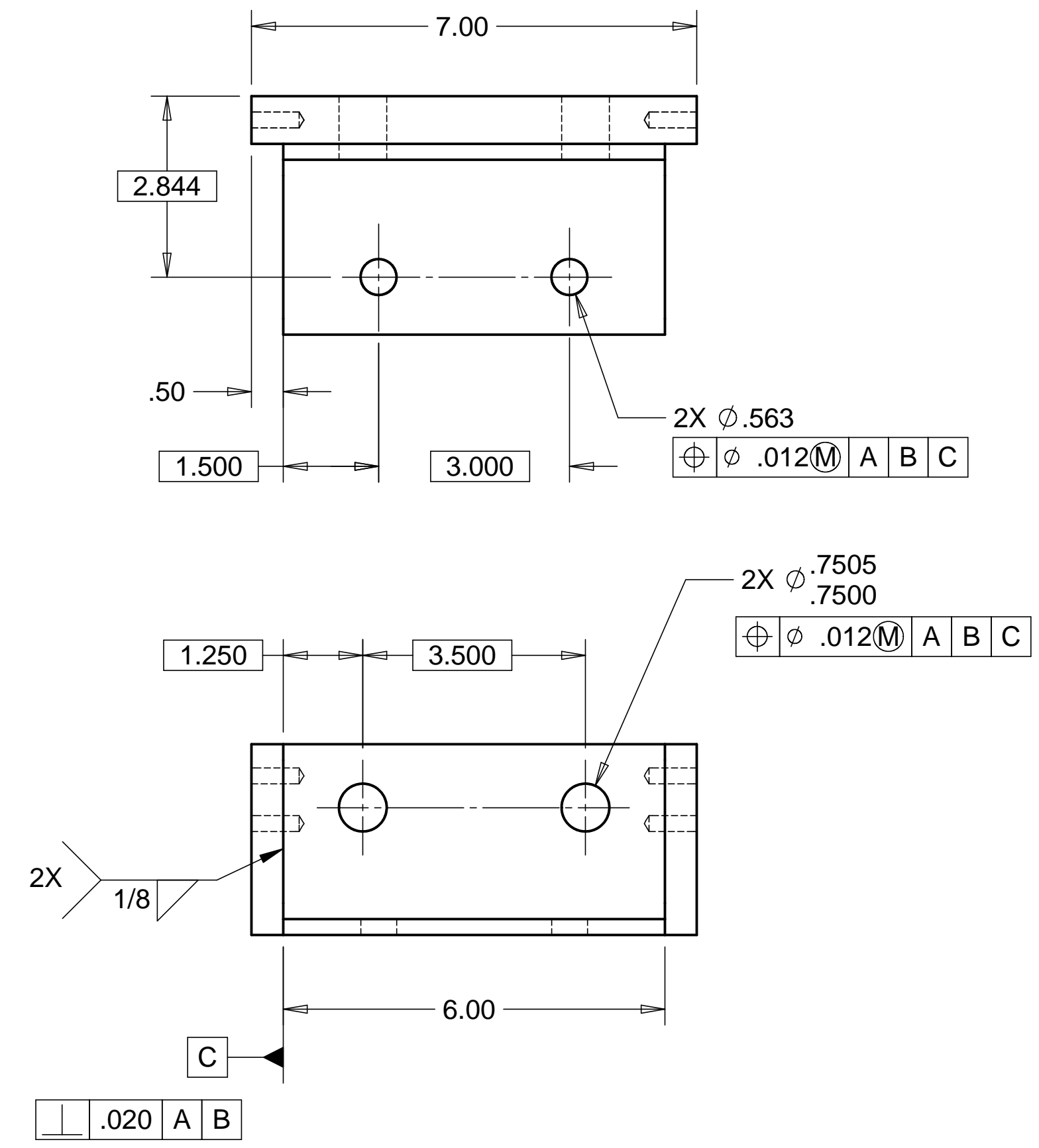

MATL: 304 SST

NOTES: UNLESS OTHERWISE SPECIFIED

1. ALL DIMENSIONS IN INCHES
2. DIMENSIONS AND TOLERANCING PER ASME Y14.5M-1994
3. SURFACE TEXTURE PER ANSI/ASME B 46.1-1985
4. REMOVE ALL BURRS AND BREAK SHARP EDGES TO A MAXIMUM OF .015
5. ALL INSIDE CORNERS TO BE .015 RADIUS MAX
6. COUNTERSINK 82 DEGREES ALL TAPPED HOLES TO MAJOR DIAMETER
7. COUNTERSINK 82 DEGREES APPROXIMATELY .015 DEEP ALL DRILLED HOLES
8. PARTS TO BE THOROUGHLY CLEANED TO REMOVE ALL OIL, GREASE, DIRT, AND CHIPS.
9. PART NUMBER (DRAWING NO. PLUS DASH NO. PLUS SERIAL NO.) TO BE CLEARLY MARKED ON THE PART ITSELF.
10. PART WEIGHS 5.8 Lbs.

ITEM NO.	QTY.	DESCRIPTION	MATERIAL
1	1	ANGLE, 3 X 3 X .25	304 SST
2	1	PLATE	304 SST

PARTS LIST

UNLESS OTHERWISE SPECIFIED: DIMENSIONS ARE IN INCHES -TOLERANCES- DECIMALS      ANGULAR = +/- .30' .XX = +/- .03      SURFACE FINISH = 250 .XXX = +/- .010	CAD GENERATED DRAWING, DO NOT MANUALLY UPDATE DO NOT SCALE DRAWING		<b>HYTEC, INC</b>						
	FINISH		TITLE <b>HAM RAIL SYSTEM          MINOR RAIL ROLLER          ANGLE BRACKET</b>						
PART NO. <b>D972942-1</b>	DESIGNED	W. K. MILLER	DATE	1/3/98					
	DRAWN	W. K. MILLER	DATE	1/3/98					
	CHECKED	HARRY SALAZAR	DATE	2/4/98					
	ENGR.	T. THOMPSON	DATE	2/4/98					
APPROVED	T. THOMPSON	DATE	2/4/98	DWG. NO.	D972942	SIZE	D	SHEET NO.	1 of 1
SCALE		1/2	REVISION						

8 7 6 5 4 3 2 1

A

A