

8 7 6 5 4 3 2 1

REVISIONS			
REV.	DESCRIPTION	DATE	APPROVED

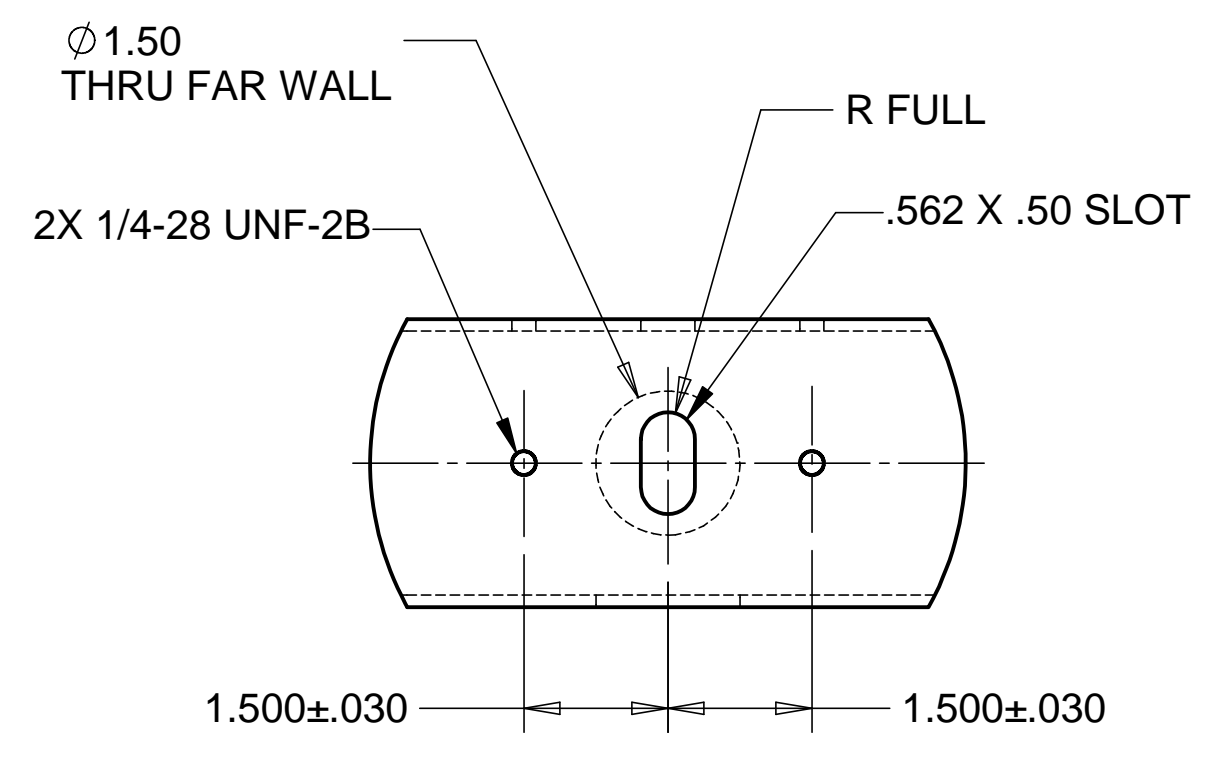

DETAIL A
SCALE 1/2
TYP. 18 PLACES

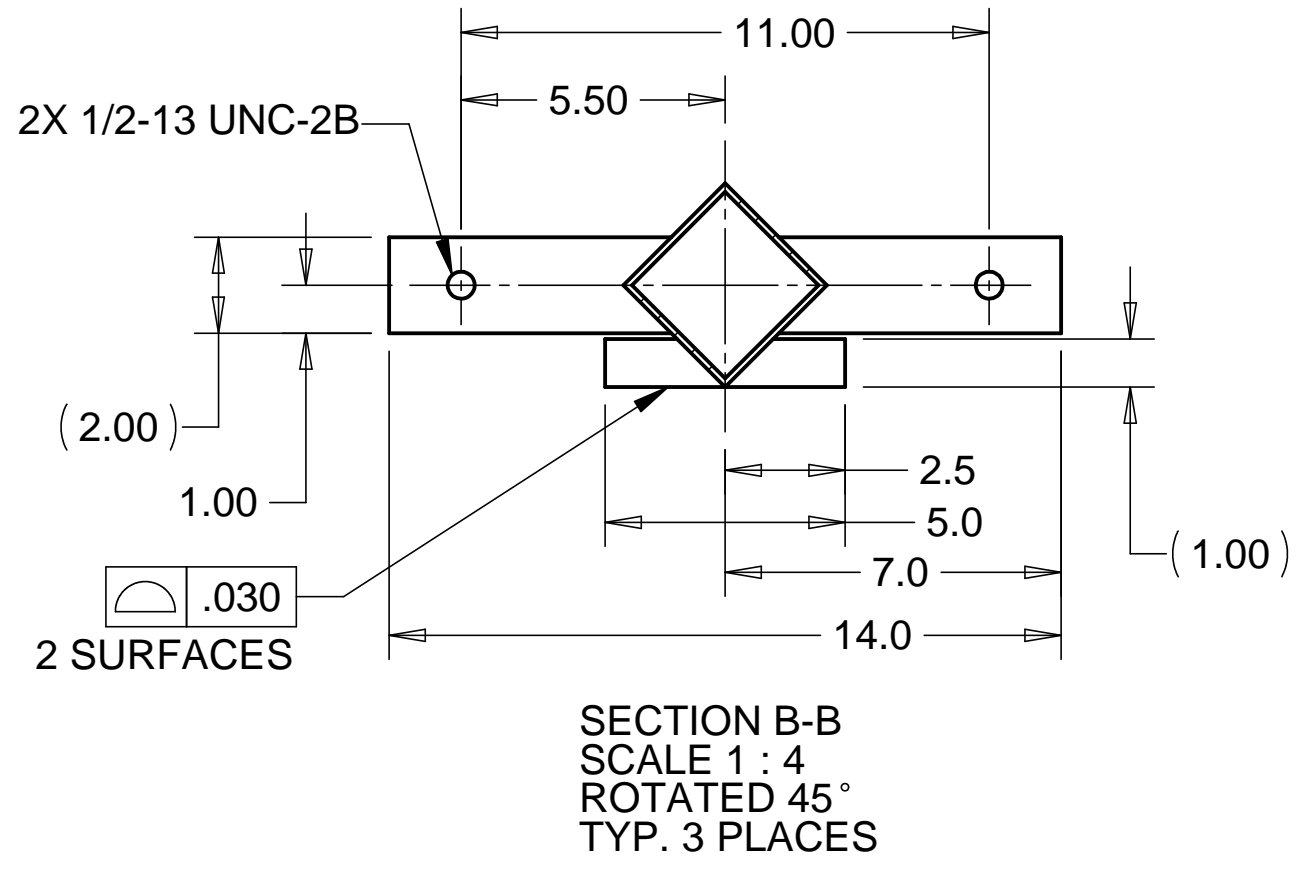

SECTION B-B
SCALE 1 : 4
ROTATED 45°
TYP. 3 PLACES

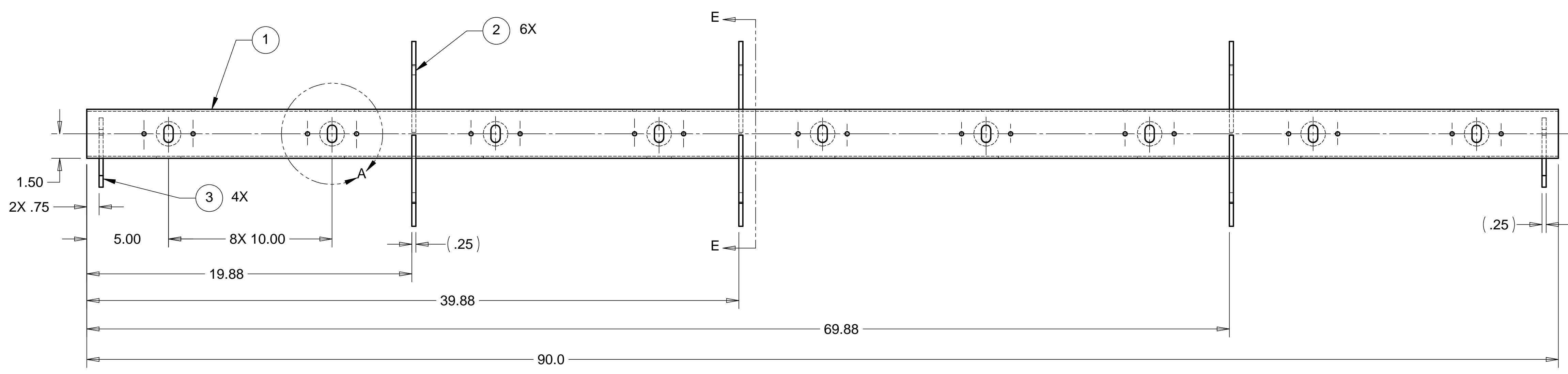
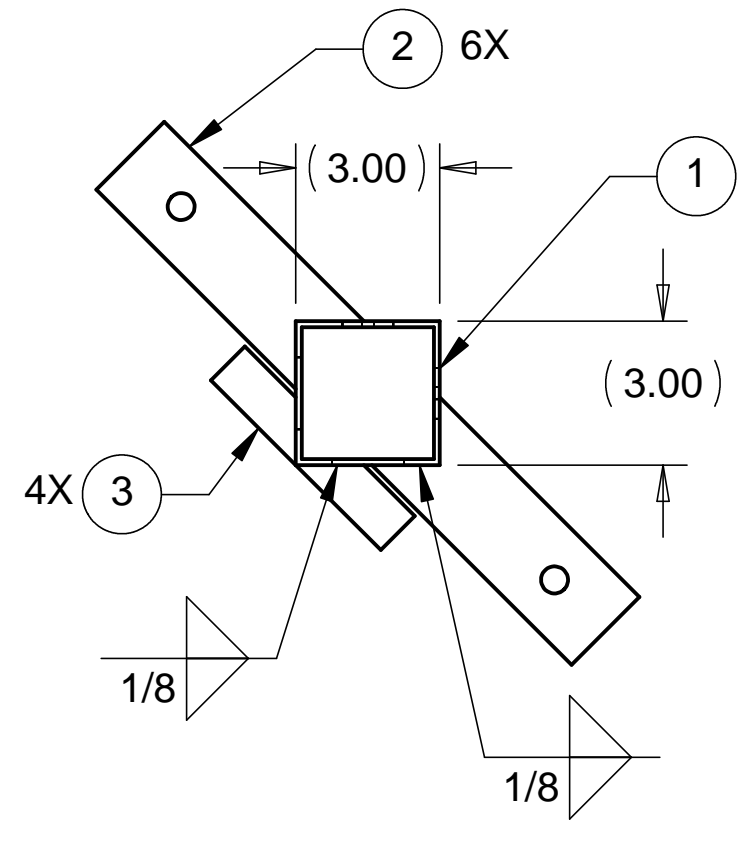
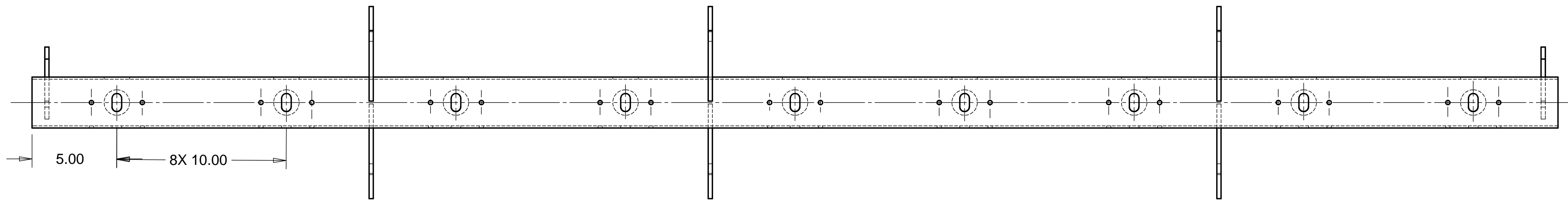

NOTES: UNLESS OTHERWISE SPECIFIED

1. ALL DIMENSIONS IN INCHES
2. DIMENSIONS AND TOLERANCING PER ASME Y14.5M-1994
3. SURFACE TEXTURE PER ANSI/ASME B 46.1-1985
4. REMOVE ALL BURRS AND BREAK SHARP EDGES TO A MAXIMUM OF .015
5. ALL INSIDE CORNERS TO BE .015 RADIUS MAX
6. COUNTERSINK 82 DEGREES ALL TAPPED HOLES TO MAJOR DIAMETER
7. COUNTERSINK 82 DEGREES APPROXIMATELY .015 DEEP ALL DRILLED HOLES
8. PARTS TO BE THOROUGHLY CLEANED TO REMOVE ALL OIL, GREASE, DIRT AND CHIPS
9. PART NUMBER (DRAWING NO. PLUS DASH NO. PLUS SERIAL NO.) TO BE CLEARLY MARKED ON THE PART ITSELF.
10. PART WEIGHS 41 Lbs.
11. PAINT PART USING SHERMAN WILLIAMS MEDIUM TEXTURED BEIGE (D13 POLANE T-PLUS, POLYURETHANE ENAMEL, F63 SERIES, #SW-F63TX-H-1651-5864).

ITEM NO.	QTY.	DESCRIPTION	MATERIAL
1	1	TUBING, 3 X 3 X .125 WALL	A36 STEEL
2	6	FLAT STOCK, 2.0 X .25 THK	A36 STEEL
3	4	FLAT STOCK, 1.0 X .25 THK	A36 STEEL

PARTS LIST				HYTEC, INC	
UNLESS OTHERWISE SPECIFIED: DIMENSIONS ARE IN INCHES -TOLERANCES-		CAD GENERATED DRAWING, DO NOT MANUALLY UPDATE DO NOT SCALE DRAWING		TITLE HAM ROLLER SYSTEM BEAM	
DECIMALS X = +/- .1 .XX = +/- .060	ANGULAR = +/- .30° SURFACE FINISH = 250	SIGNATURE	DATE	DWG. NO.	SIZE SHEET NO.
FINISH		DESIGNED W. K. MILLER	12/18/97	D972931	D 1 of 1
		DRAWN W. K. MILLER	12/18/97		
		CHECKED HARRY SALAZAR	2/2/98		
		ENGR. T. THOMPSON	2/2/98		
PART NO. D972931-1		APPROVED T. THOMPSON	2/2/98	SCALE 1/4	REVISION

8 7 6 5 4 3 2 1