

8 7 6 5 4 3 2 1

REV	DESCRIPTION	REVISIONS	DATE	APPROVED

D

D

C

C

B

B

A

A

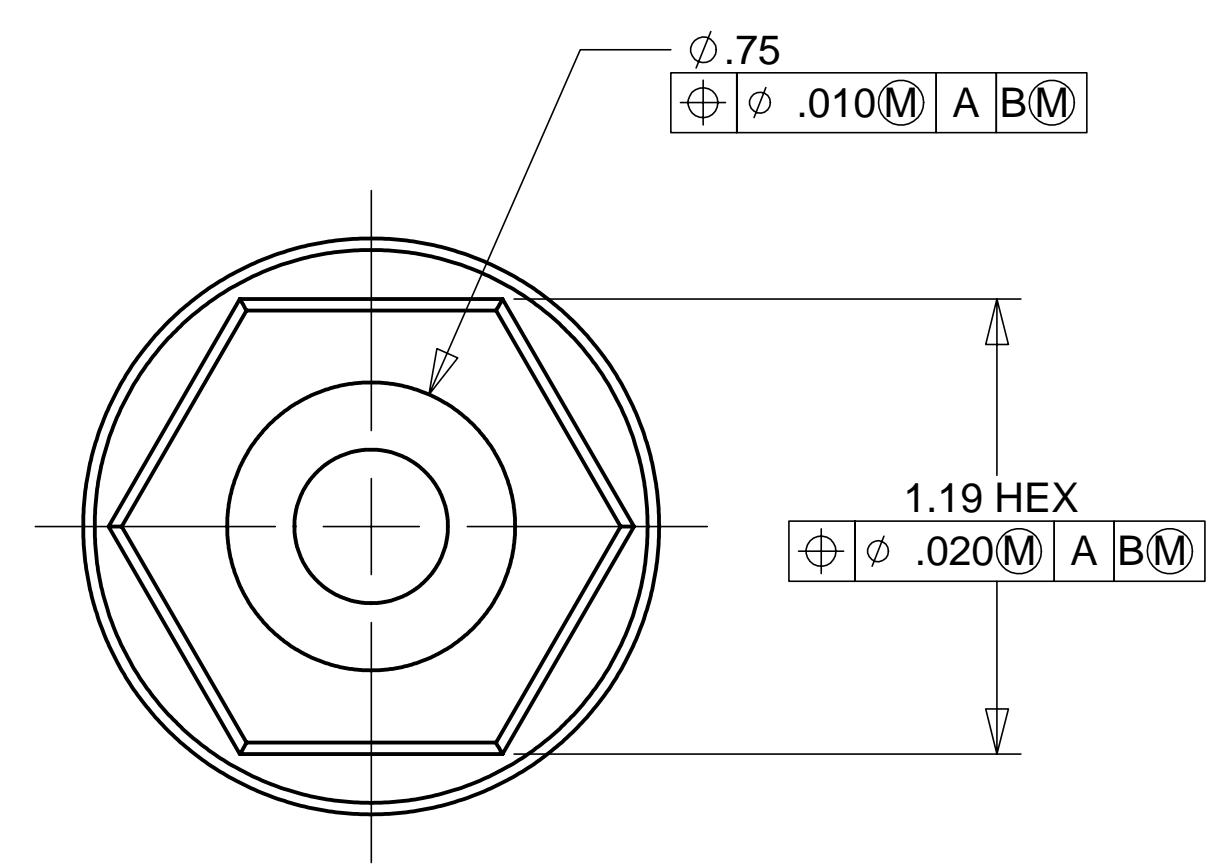
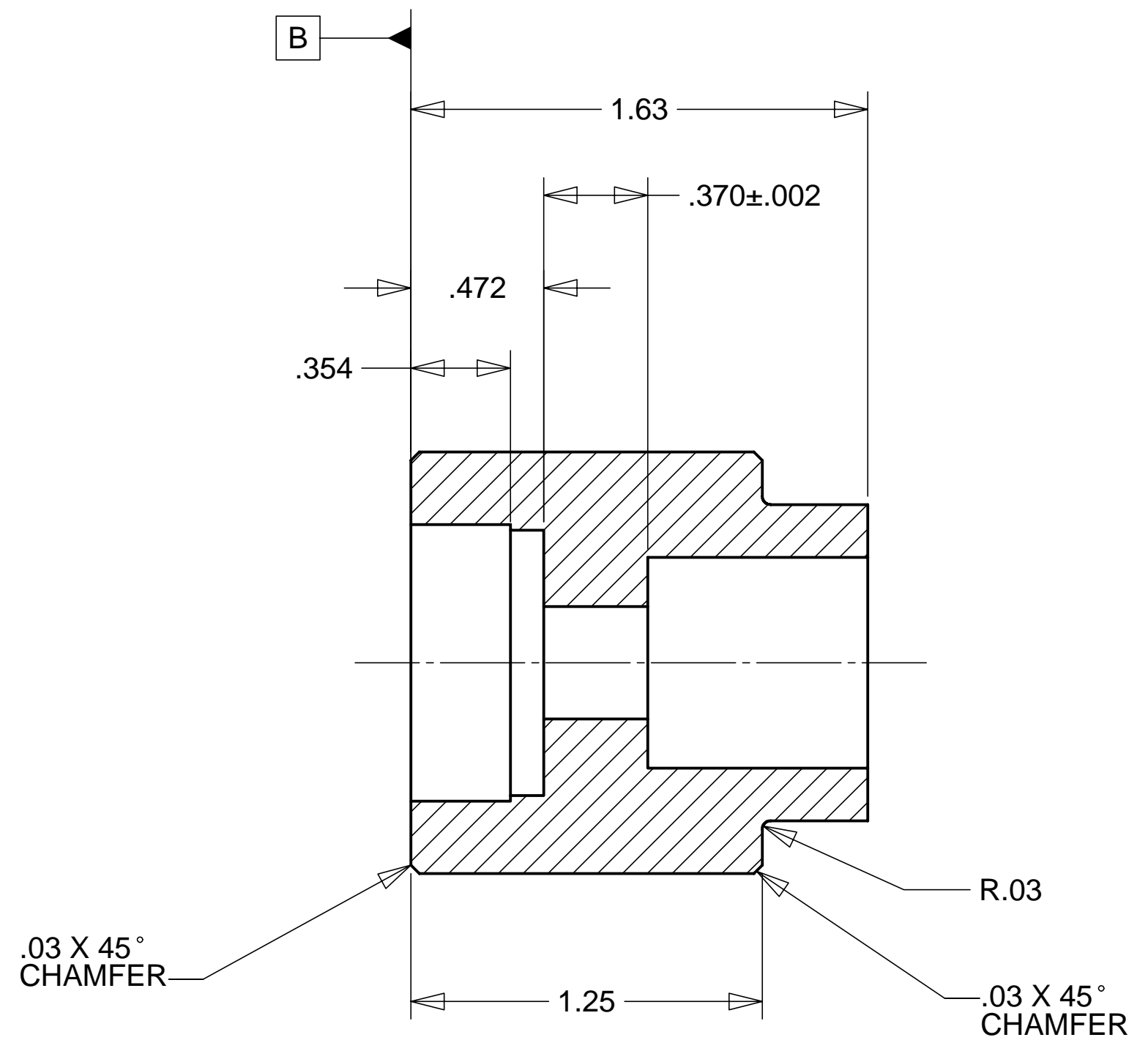
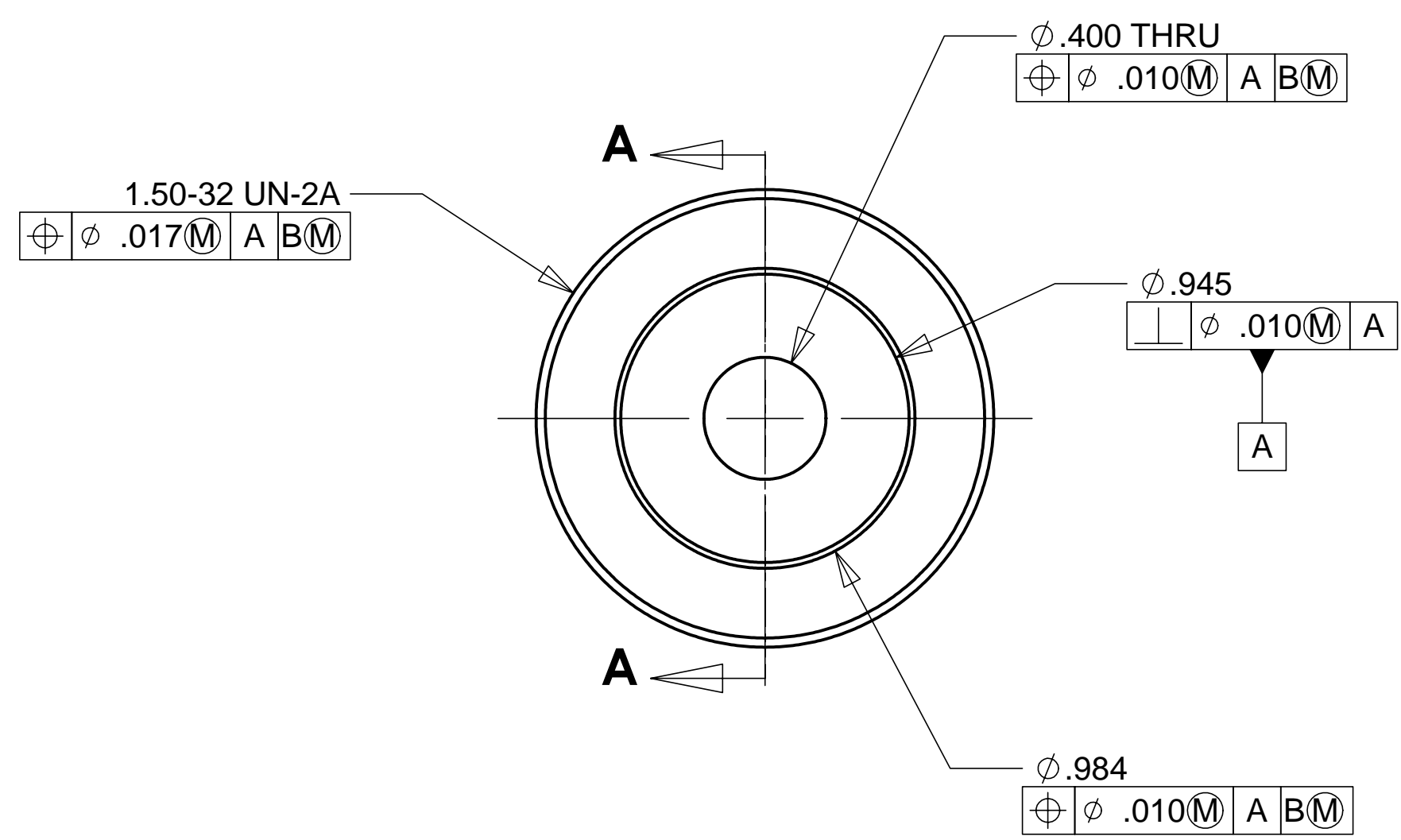

MATERIAL: 303 STAINLESS STEEL
WEIGHT: .17 POUNDS

NOTES: UNLESS OTHERWISE SPECIFIED

- ALL DIMENSIONS IN INCHES
- DIMENSIONS AND TOLERANCING PER ANASI Y14.5M-1994
- SURFACE TEXTURE PER ANI/ASME B 46.1-1985
- REMOVE ALL BURRS AND BREAK SHARP EDGES TO A MAXIMUM OF .015
- ALL INSIDE CORNERS TO BE .015 RADIUS MAX
- COUNTERSINK 82 DEGREES ALL TAPPED HOLES TO MAJOR DIAMETER
- COUNTERSINK 82 DEGREES APPROXIMATELY .03/.06 DEEP ALL DRILLED HOLES
- PARTS TO BE THOROUGHLY CLEANED TO REMOVE ALL OIL, GREASE, DIRT AND CHIPS
- PART NUMBER (DRAWING NO., DASH NO., REVISION NO., SERIAL NO.) TO BE CLEARLY MARKED ON THE PART ITSELF.

ITEM NO.	QTY.	PART NO.	DESCRIPTION
PARTS LIST			
UNLESS OTHERWISE SPECIFIED: DIMENSIONS ARE IN INCHES -TOLERANCES-		CAD GENERATED DRAWING, DO NOT MANUALLY UPDATE DO NOT SCALE DRAWING	
DECIMALS .X = +/- .1 .XX = +/- .03 .XXX = +/- .010		ANGULAR = +/- .30' SURFACE FINISH = 250	
FINISH	DESIGNED	SIGNATURE	DATE
	DRAWN	ROGER L. SMITH	1-8-99
	CHECKED	H. SALAZAR	1-9-99
	ENGR.	ROGER L. SMITH	1-12-99
	APPROVED	ERIC PONSLET	1-8-99
PART NO.	T. THOMPSON		1-15-99
D972153-1	SCALE 2/1		REVISION
HYTEC, INC			TITLE
LIGO BEARING HOUSING			DWG. NO.
D972153			SIZE SHEET NO.
D			1 of 1

8 7 6 5 4 3 2 1