

8

7

6

5

4

3

2

1

REVISIONS			
REV	DESCRIPTION	DATE	APPROVED
A	SEE ECN# D972135-A FOR CHANGE LIST	11/03/97	T. THOMPSON
B	SEE ECN# D972135-B FOR CHANGE LIST	01/23/98	T. THOMPSON
C	SEE ECN# D972135-C FOR CHANGE LIST	03/21/98	T. THOMPSON
D	SEE ECN# D972135-D FOR CHANGE LIST	04/23/99	T. THOMPSON

D

D

C

C

B

B

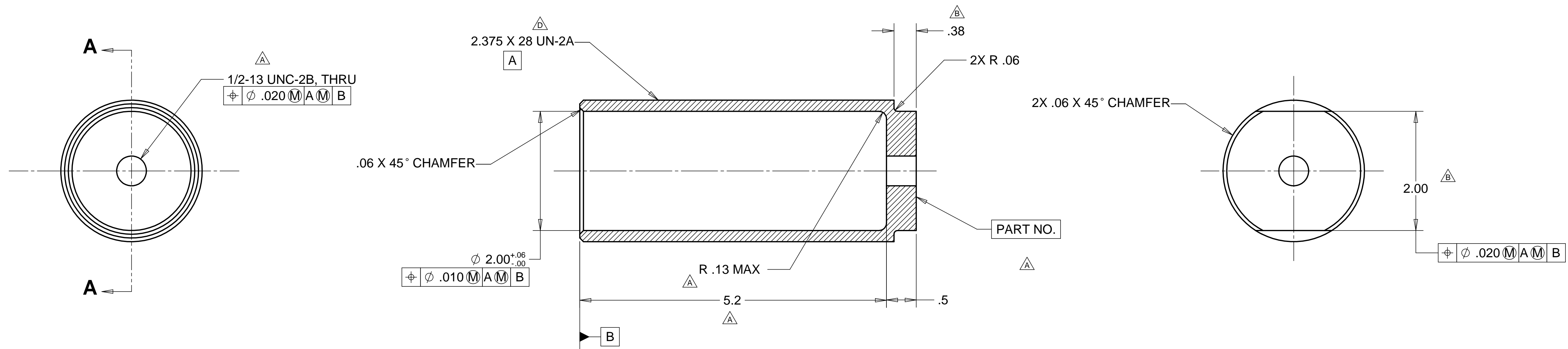

MATL: BRASS
 WEIGHT: 2.6 lbs.

NOTES: UNLESS OTHERWISE SPECIFIED

- ALL DIMENSIONS IN INCHES
- DIMENSIONS AND TOLERANCING PER ASME Y14.5M-1994
- SURFACE TEXTURE PER ANSI/ASME B 46.1-1985
- REMOVE ALL BURRS AND BREAK SHARP EDGES TO A MAXIMUM OF .015
- ALL INSIDE CORNERS TO BE .015 RADIUS MAX
- COUNTERSINK 82 DEGREES ALL TAPPED HOLES TO MAJOR DIAMETER
- COUNTERSINK 82 DEGREES APPROXIMATELY .015 DEEP ALL DRILLED HOLES
- PARTS TO BE THOROUGHLY CLEANED TO REMOVE ALL OIL, GREASE, DIRT AND CHIPS
- PART NUMBER (DRAWING NO. PLUS DASH NO. PLUS SERIAL NO.) TO BE CLEARLY MARKED ON THE PART.

PARTS LIST			
UNLESS OTHERWISE SPECIFIED: DIMENSIONS ARE IN INCHES -TOLERANCES- DECIMALS ANGULAR = +/- .30° .X = +/- .1 .XX = +/- .03 .XXX = +/- .010 SURFACE FINISH = 250	CAD GENERATED DRAWING, DO NOT MANUALLY UPDATE DO NOT SCALE DRAWING		HYTEC, INC TITLE LIGO SCISSOR TABLE SPRING CUP
	FINISH PART NO. D972135-1	SIGNATURE DESIGNED: ROGER L. SMITH DRAWN: ROGER L. SMITH CHECKED: HARRY SALAZAR ENGR: T. THOMPSON APPROVED: T. THOMPSON	DATE 5-28-97 5-28-97 8-5-97 8-6-97 8-6-97

8

7

6

5

4

3

2

1

A

A