

8 7 6 5 4 3 2 1

REVISIONS			
REV.	DESCRIPTION	DATE	APPROVED
A	SEE ECN# D972105-A FOR CHANGE LIST	05-04-98	T. THOMPSON

D

D

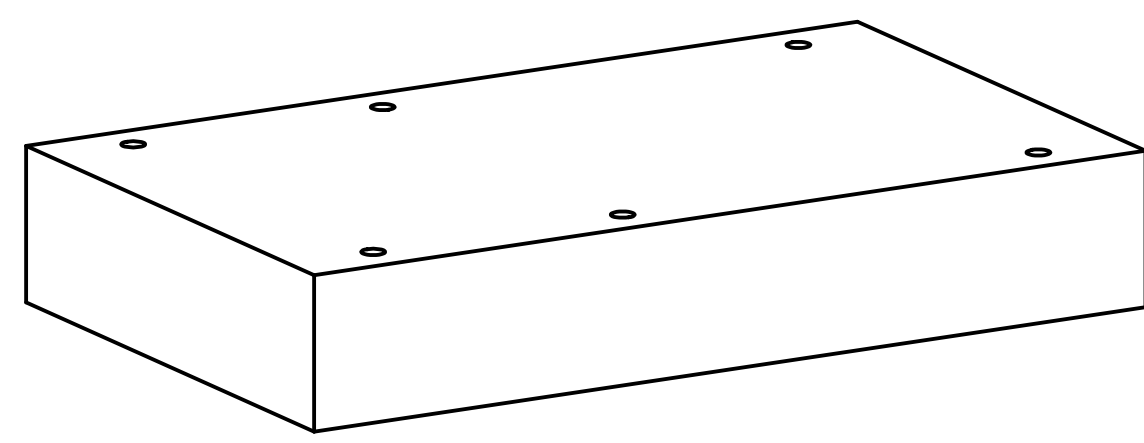
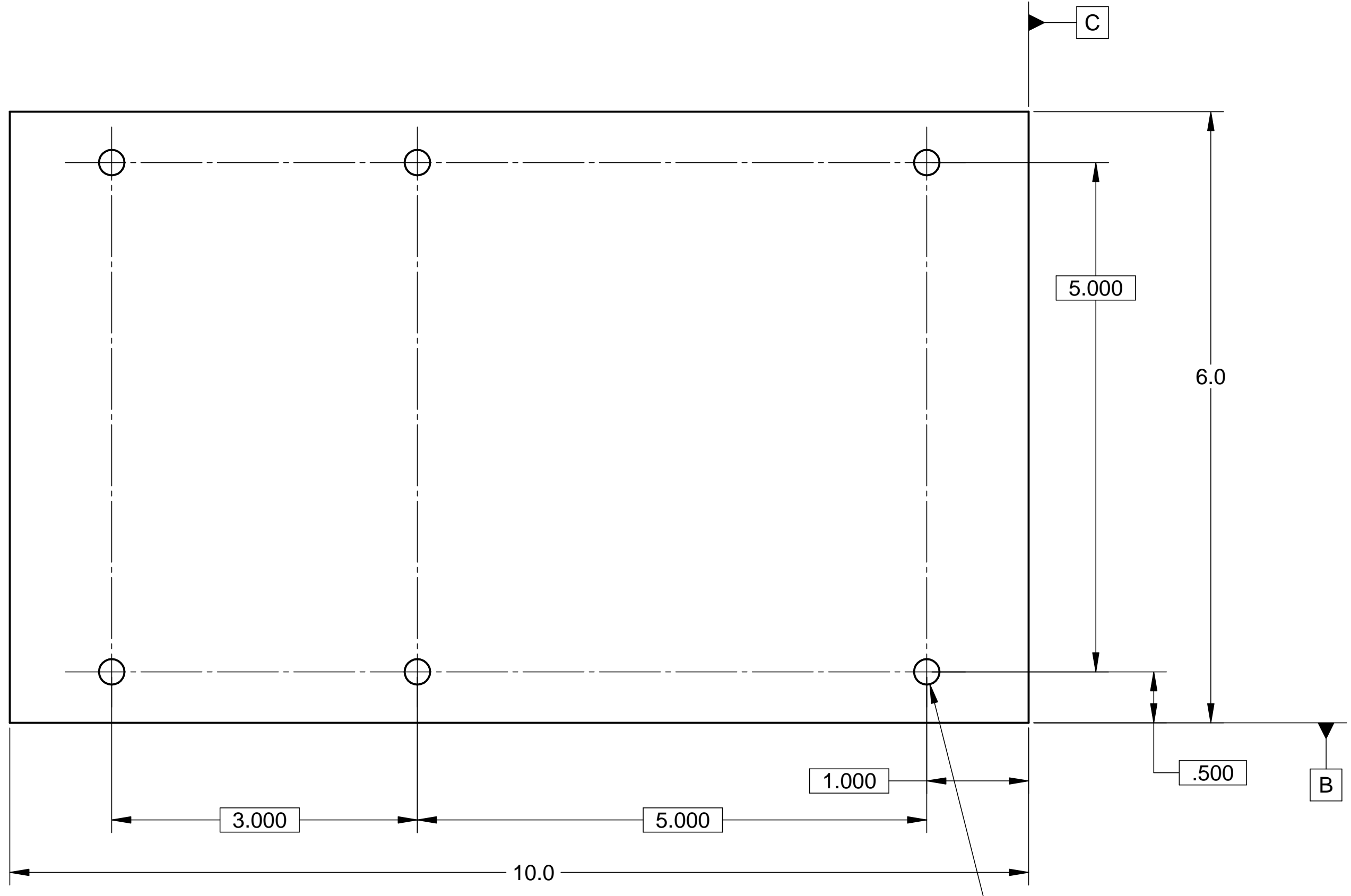

C

C

B

B

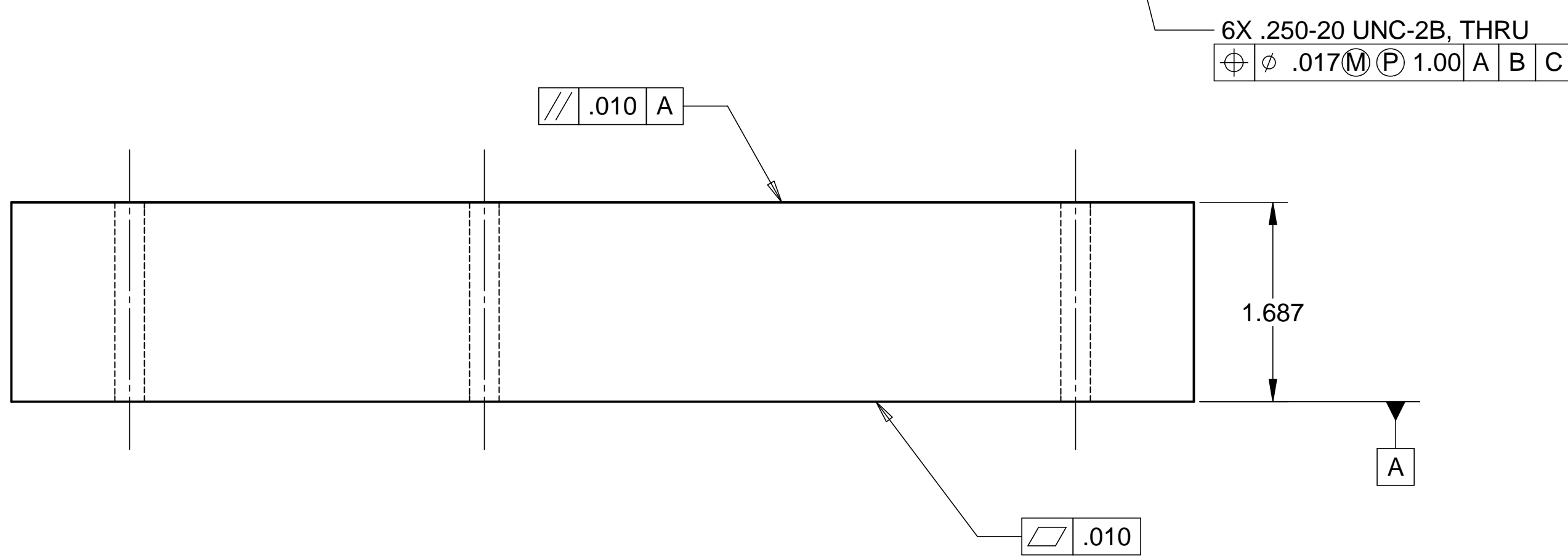

6X .250-20 UNC-2B, THRU
 $\varnothing \phi .017 \text{ (M)} \text{ (P)} 1.00 \text{ A B C}$

△ MATERIAL: ALUM. 6061-T6
 △ WEIGHT: 9.7 lbs

NOTES: UNLESS OTHERWISE SPECIFIED

1. ALL DIMENSIONS IN INCHES
2. DIMENSIONS AND TOLERANCING PER ANAS1 Y14.5M-1994
3. SURFACE TEXTURE PER ANI/ASME B 46.1-1985
4. REMOVE ALL BURRS AND BREAK SHARP EDGES TO A MAXIMUM OF .015
5. ALL INSIDE CORNERS TO BE .015 RADIUS MAX
6. COUNTERSINK 82 DEGREES ALL TAPPED HOLES TO MAJOR DIAMETER
7. COUNTERSINK 82 DEGREES APPROXIMATELY .03/.06 DEEP ALL DRILLED HOLES
8. PARTS TO BE THOROUGHLY CLEANED TO REMOVE ALL OIL, GREASE, DIRT AND CHIPS
9. PART NUMBER (DRAWING NO. PLUS DASH NO. PLUS SERIAL NO.) TO BE CLEARLY MARKED ON THE PART ITSELF.

△

A

A

8 7 6 5 4 3 2 1

PARTS LIST			
UNLESS OTHERWISE SPECIFIED: DIMENSIONS ARE IN INCHES -TOLERANCES-	CAD GENERATED DRAWING, DO NOT MANUALLY UPDATE DO NOT SCALE DRAWING		HYTEC, INC TITLE LIGO COARSE X-Y TRANSLATION SPACER BLOCK
	DECIMALS	ANGULAR = +/- 30'	
.X = +/- .1		DESIGNED	ROGER L. SMITH
.XX = +/- .03		DRAWN	ED PIOTROWICZ
.XXX = +/- .010	SURFACE FINISH = 250	CHECKED	HARRY SALAZAR
FINISH		ENGR.	T. THOMPSON
PART NO.	D972105-1	APPROVED	T. THOMPSON
		DATE	8/22/97
		DATE	8/25/97
		DATE	8/25/97
		DATE	8/25/97
		SCALE	1/1
		SHEET NO.	1 of 1
		REVISION	A