

Pump Port "O" Ring Seating Plate
Make from 6061-T6 Alum.
(2 pieces req'd.)

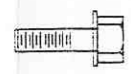

Also provide 16 pcs. of pc. #5, 7/16"-18UNC x 2" long ss bolts and washers

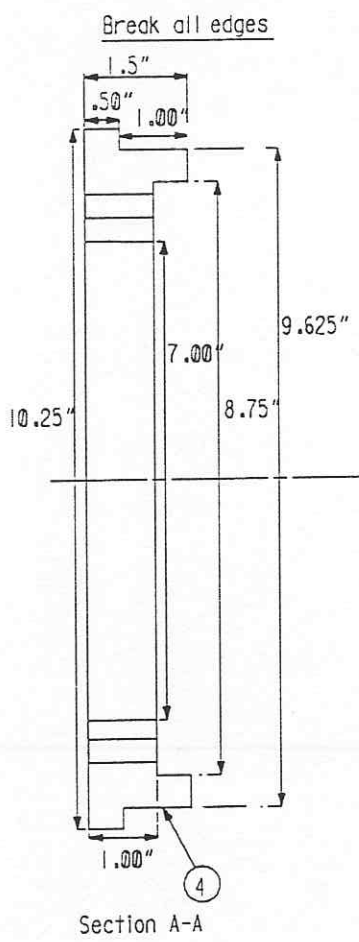

Retainer Port Retainer Ring
Make from 6061-T6 Alum.
(2 pcs. req'd.)

Supplier's/Purchaser's No.		CBI 1160-D970059-00-B	
LIGO-BEAM TUBE HANFORD, WA & LIVINGSTON, LA			
TUBE SECTION LEAK TEST PUMP PORT LEAK TEST FIXTURE			
Customer's No.		Contract No.	
By CLD Ckd M.L. TELLALIAN Date 6-6-96		953571	
M. L. TELLALIAN Engineering Supervisor		Dwg. ER606	Rev. 0
Sheet		THIS DRAWING HAS BEEN PREPARED FOR AND IS THE PROPERTY OF CBI AND IS TO BE USED ONLY IN CONNECTION WITH PERFORMANCE OF WORK BY CBI. REPRODUCTION IN WHOLE OR IN PART FOR ANY OTHER PURPOSE IS EXPRESSLY FORBIDDEN.	
Revisions		THIS DRAWING HAS BEEN PREPARED BY ROSSIGNOL CONSTRUCTION SERVICES RPT. (24)	

INDICATES CHANGE FROM PREVIOUS ISSUE