

NOTES: (UNLESS OTHERWISE SPECIFIED)

1. DIAMETER OF PROTRUDING CYLINDRICAL FEATURE MAY BE UNDERCUT $\phi 0.04$ MAX ON NOTED SECTION.

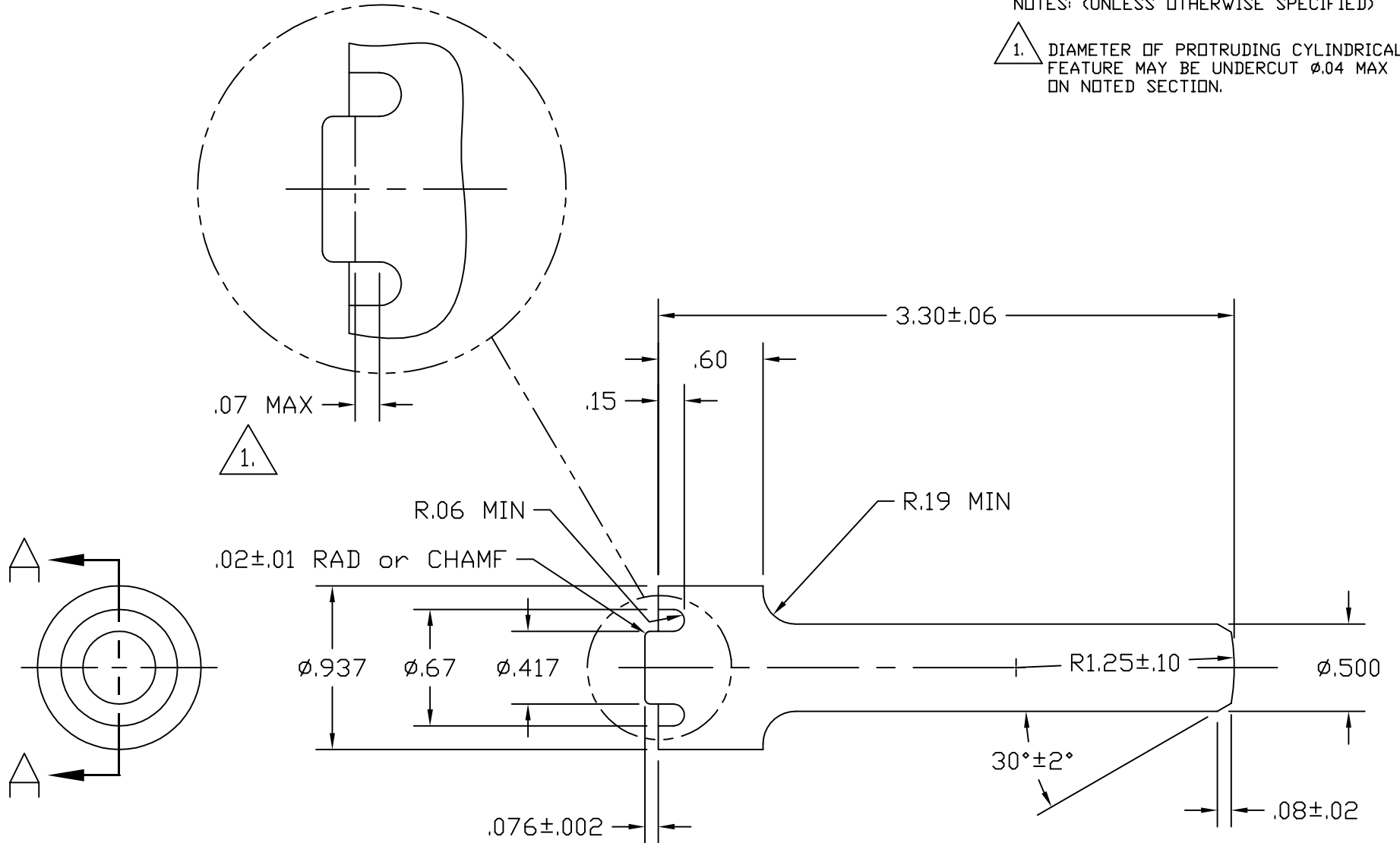

SECTION A-A

UNLESS OTHERWISE SPECIFIED
DIMENSIONS ARE IN INCHES

TOLERANCES:
FRACTIONAL ±
ANGULAR ± 0.5°
ANGULAR MACH ± BEND ±
TWO PLACE DECIMAL ± .03

THREE PLACE DECIMAL ± .005
FINISHED SURFACE 63 MICRINCH AVERAGE
BREAK CORNERS IN: OUT: .005-.010
REMOVE ALL BURRS

MATERIAL:
1018 STEEL BAR
PER ASTM-A108

HEAT TREAT:
CASE HARDEN TO 52-56 Rc
.02-.03 DEPTH

FINISH:

| REV | DESCRIPTION | DCC | SYS | DET | CDS | VE | CC | BT | CHECK | DRWN | DATE |
|-----|-----------------|-----|-----|-----|-----|----|----|----|-------|--------|----------|
| B | DCN E970046 | | | | | | | | | | |
| A | DCN E960157 | | | | | | | | | | |
| 00 | RELEASE FOR FAB | | | | | | | | | CONLEY | 01-17-97 |

LIGO CALIFORNIA INSTITUTE OF TECHNOLOGY
MASSACHUSETTS INSTITUTE OF TECHNOLOGY

CORE OPTIC COMPONENT CARRIER
EXPANSION PLUG INSTALLATION TOOL

CAD FILE: D970004-B.dwg SIZE: DWG. NL: A SHEET: D970004-B-D
SCALE: NTS SHEET: 1 OF 1

USED ON: NEXT ASS'Y: N/A

ISSUE DESCRIPTION