

5

4

3

2

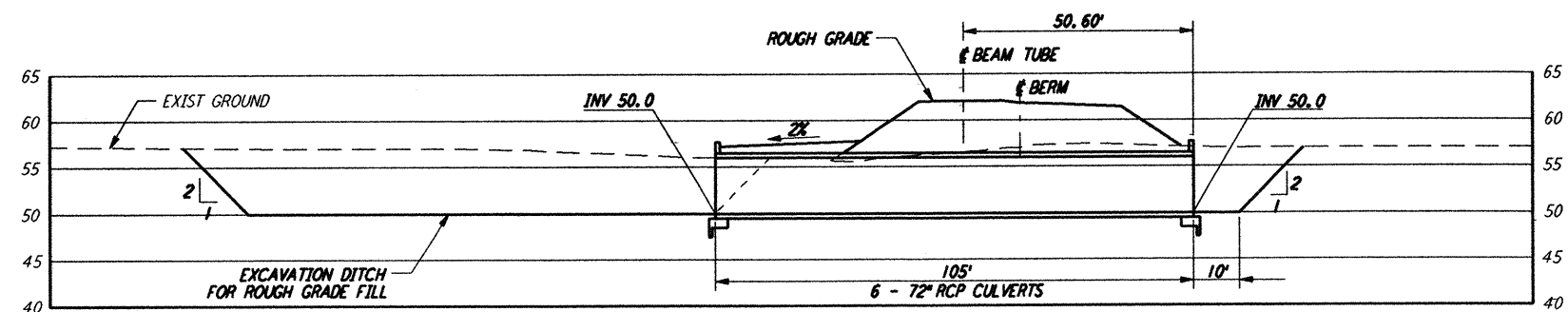

STA 27+40.00 (A)
 SCALES: HORIZ: 1" = 20'
 VERT: 1" = 2'

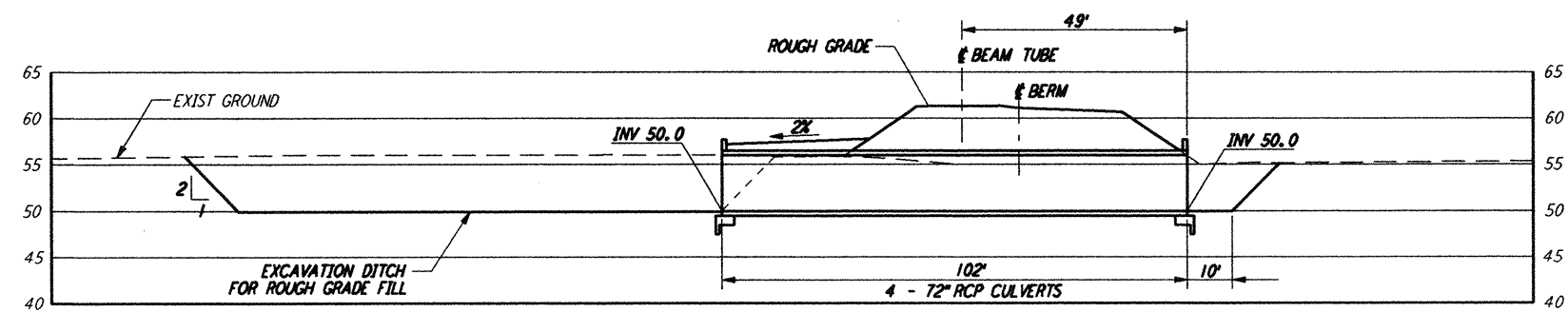

STA 43+80.00 (B)
 SCALES: HORIZ: 1" = 20'
 VERT: 1" = 2'

NOTES:
 1. SEE SHEET RG-C-002 FOR GENERAL NOTES, LEGEND AND ABBREVIATIONS.

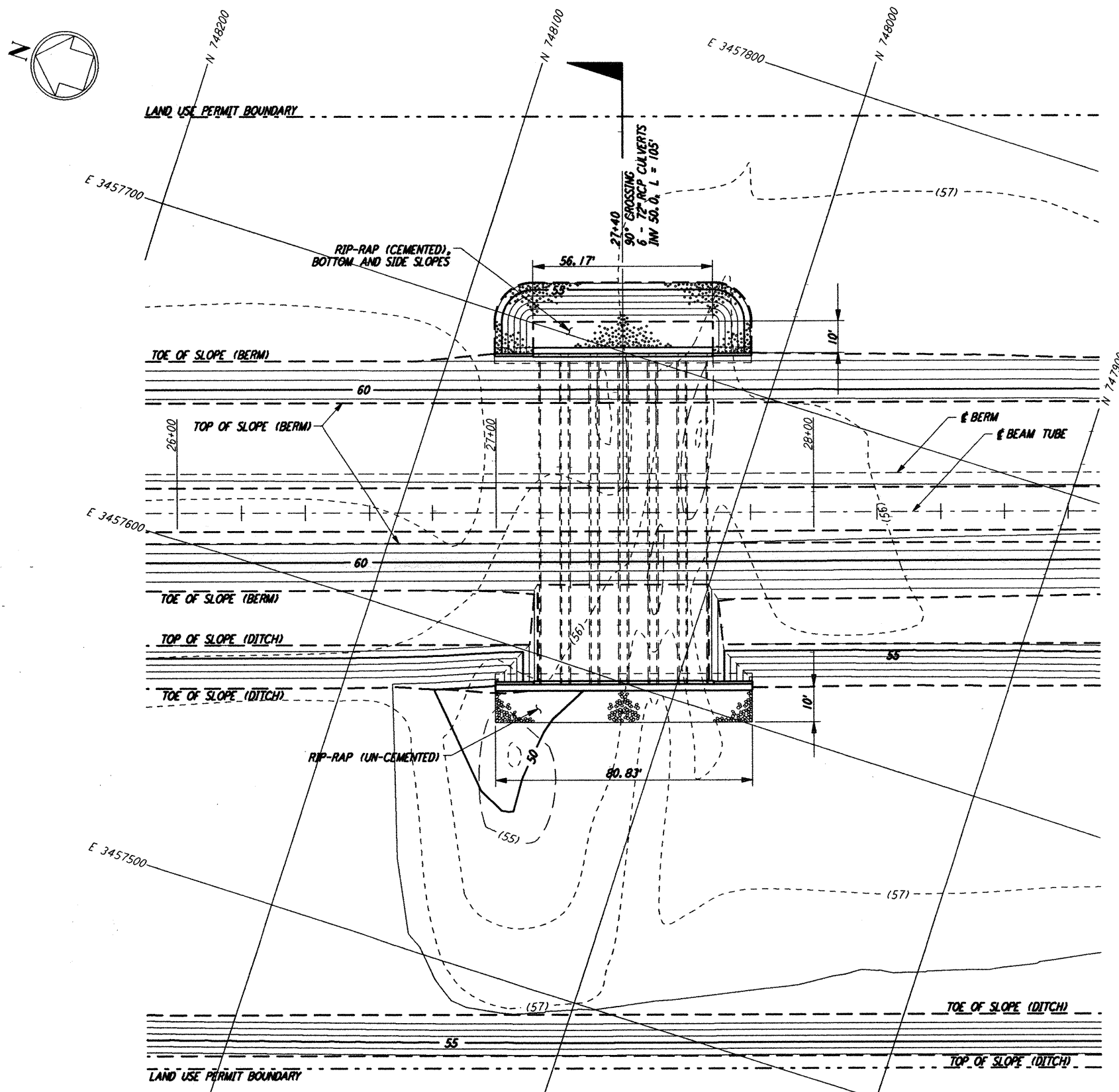

(A)

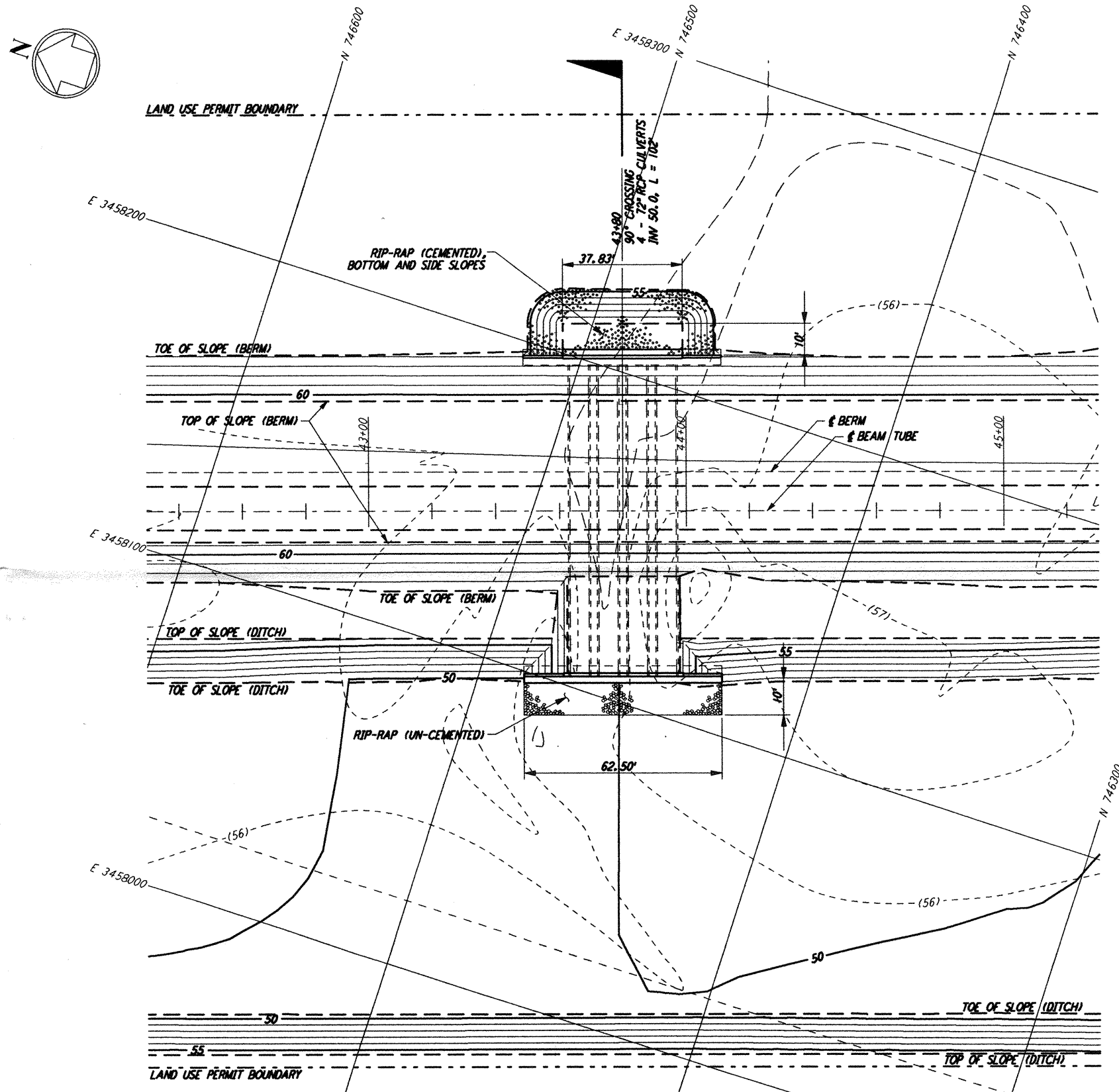

(B)

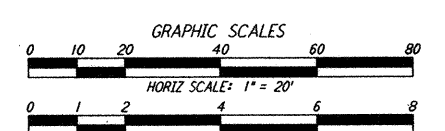

LIGO-0961752-A-0

NO.	DATE	APRD BY	DESCRIPTION OF REVISION
9			
8			
7			
6			
5			
4			
3			
2			
1			

NO.	DATE	APRD BY	ISSUED FOR
1	8/11/95	JJB	FINAL DESIGN REVIEW

DATE	8/11/95
DRAWN	WRB WRS
CHECKED	MGP TJP
SECT HD	
PROJ MGR	
CLIENT	

PARSONS
 100 WEST WALNUT STREET
 PASADENA, CALIFORNIA

LIGO
 CALIFORNIA INSTITUTE OF TECHNOLOGY
 MASSACHUSETTS INSTITUTE OF TECHNOLOGY

LASER INTERFEROMETER
 GRAVITATIONAL-WAVE OBSERVATORY
 ROUGH GRADING - LIVINGSTON, LA

TITLE	SCALE	CONTRACT NUMBER	PROJECT NUMBER
ROUGH GRADING SOUTHEAST ARM CULVERT GENERAL ARRANGEMENTS	AS NOTED	PP150969	8094
SHEET NUMBER	REVISIONS		
RG-C-047			

This document and the design it covers are the property of PARSONS. They are loaned only with the borrower's expressed written agreement that they will not be reproduced, copied, loaned, exhibited, or used in any other way, except by written consent from PARSONS to the borrower.

Sun Aug 13 21:33:42 1995 s3-v18b2 K:\PLOTS\QUEUES\18B2\CE047.PRF