

This document and the design it covers are the property of PARSONS. They are loaned only with the borrower's expressed written agreement that they will not be reproduced, copied, loaned, exhibited, or used in any other way, except by written consent from PARSONS to the borrower.

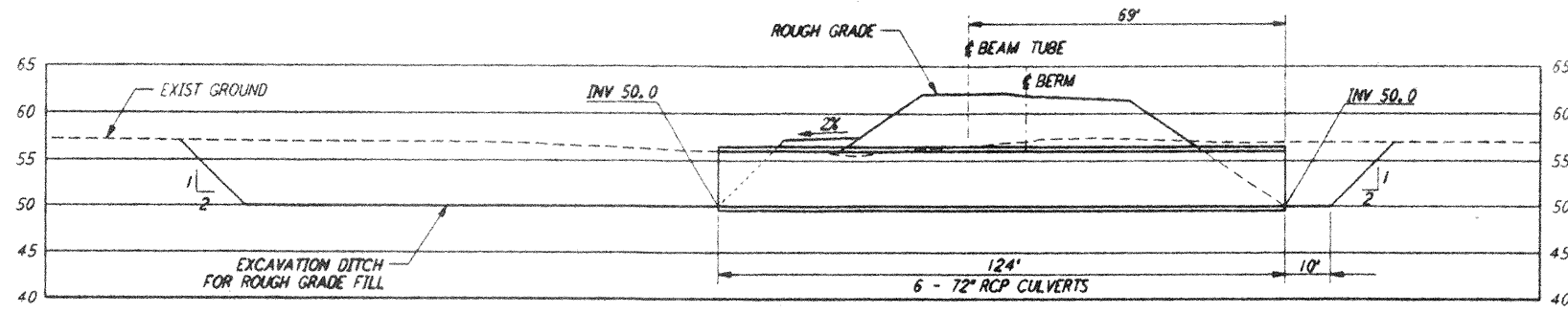

STA 27+40.00 (A)  
 SCALES: HORIZ: 1" = 20'  
 VERT: 1" = 2'

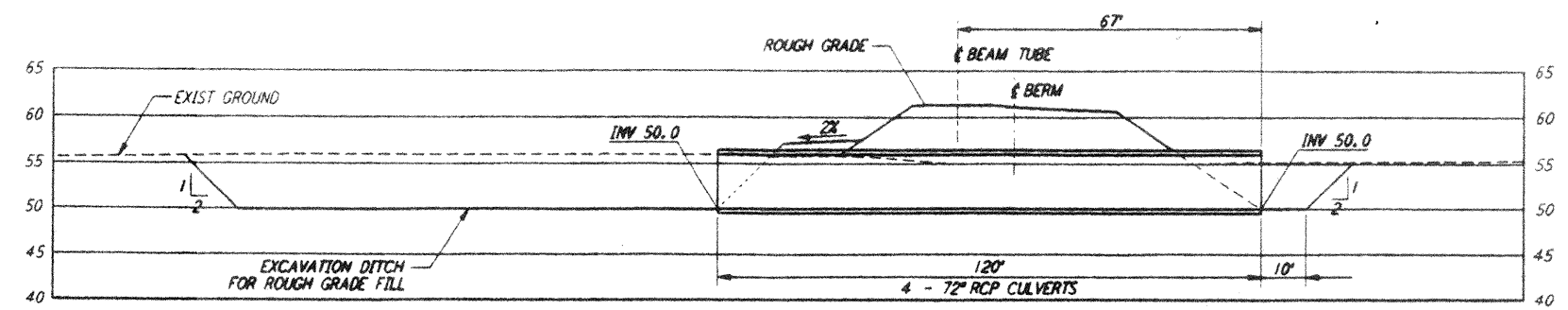

STA 43+80.00 (B)  
 SCALES: HORIZ: 1" = 20'  
 VERT: 1" = 2'

- NOTES:  
 1. SEE SHEET RG-C-002 FOR GENERAL NOTES, LEGEND AND ABBREVIATIONS.  
 2. SEE SHEET RG-C-004 FOR TYPICAL SECTIONS AND DETAILS.

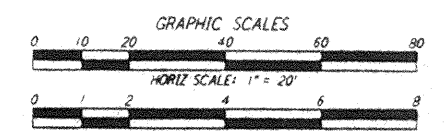
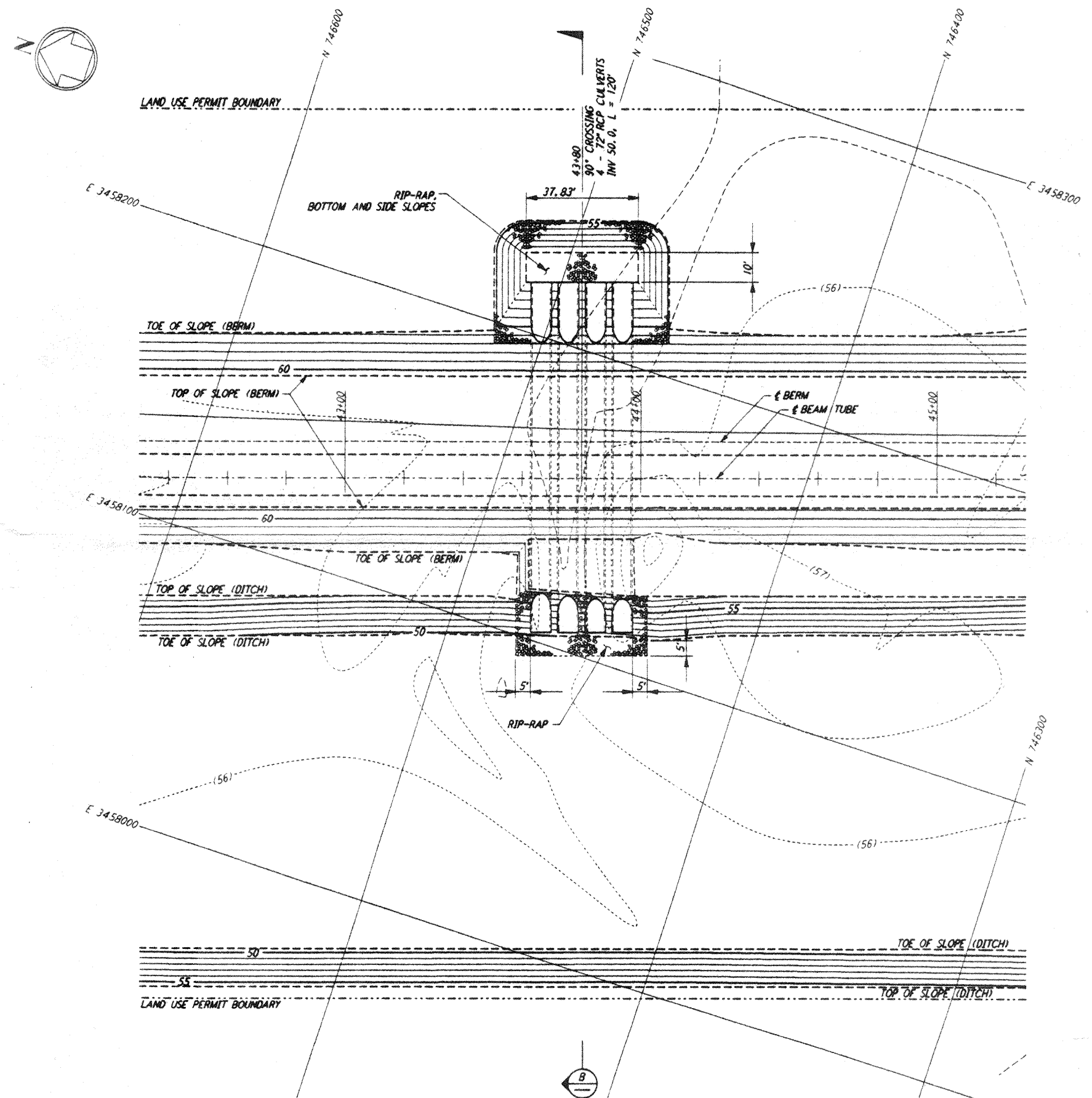
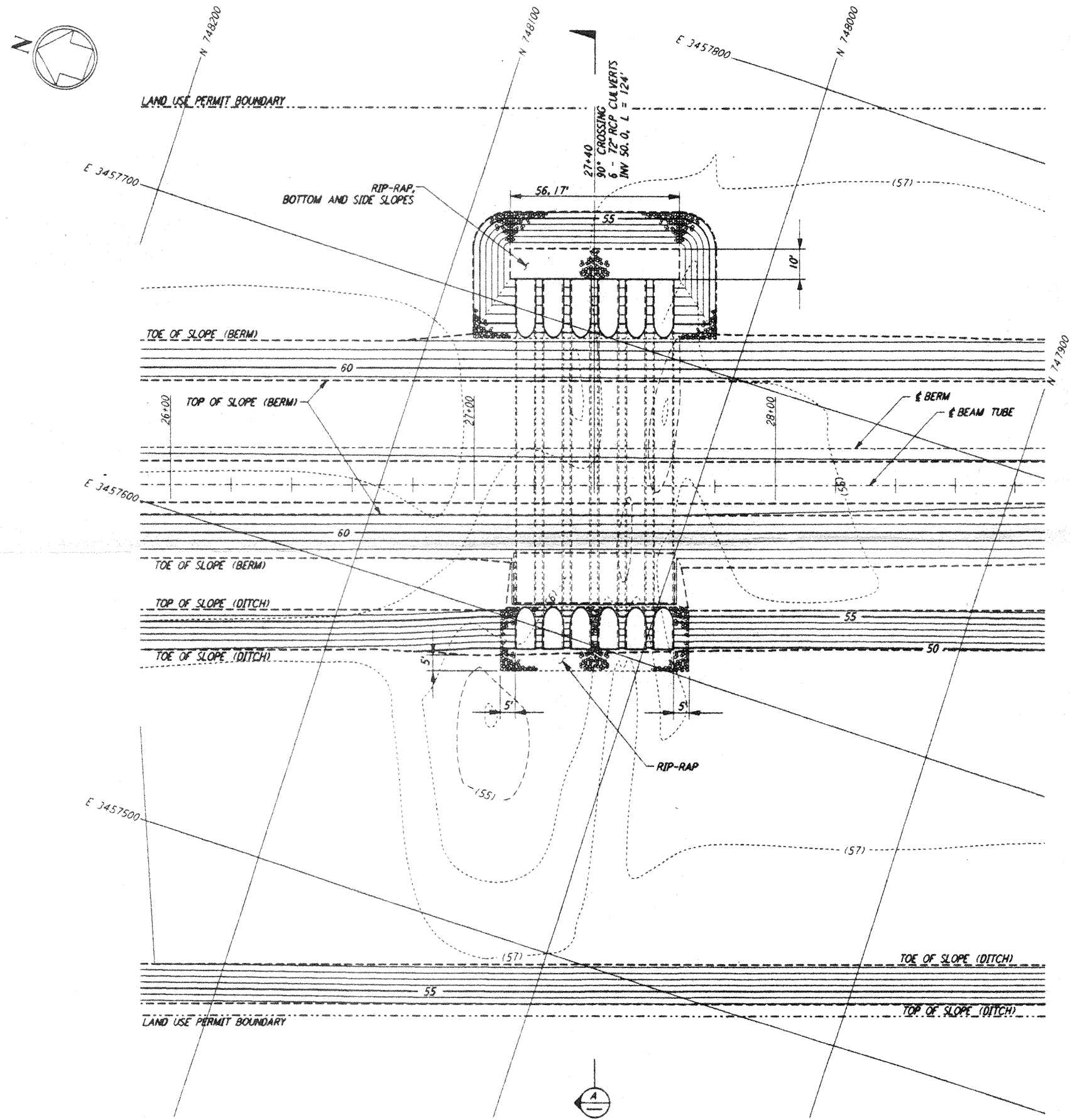

LIGO-0961752-01-D

NO.	DATE	APPRO BY	DESCRIPTION OF REVISION
1	11/1/95	Tom	NO REVISIONS

NO.	DATE	APPRO BY	ISSUED FOR
2	11/1/95	Tom	ISSUED FOR CONSTRUCTION
1	8/28/95	Tom	ISSUED FOR BID

DATE	BY
8/11/95	WRB
8/8/95	MCP
8/28/95	WJG
8/28/95	WJG

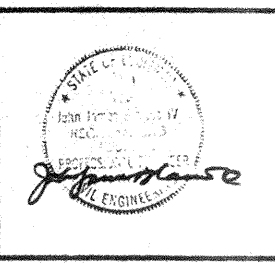

**PARSONS**  
 100 WEST WALNUT STREET  
 PASADENA, CALIFORNIA

**LIGO**  
 CALIFORNIA INSTITUTE OF TECHNOLOGY  
 MASSACHUSETTS INSTITUTE OF TECHNOLOGY

LASER INTERFEROMETER  
 GRAVITATIONAL-WAVE OBSERVATORY  
 ROUGH GRADING - LIVINGSTON, LA

TITLE: AS NOTED  
 SHEET NUMBER: PP150969  
 PROJECT NUMBER: 8094  
 REVISION: **RG-C-047**