

STA 6+00.00

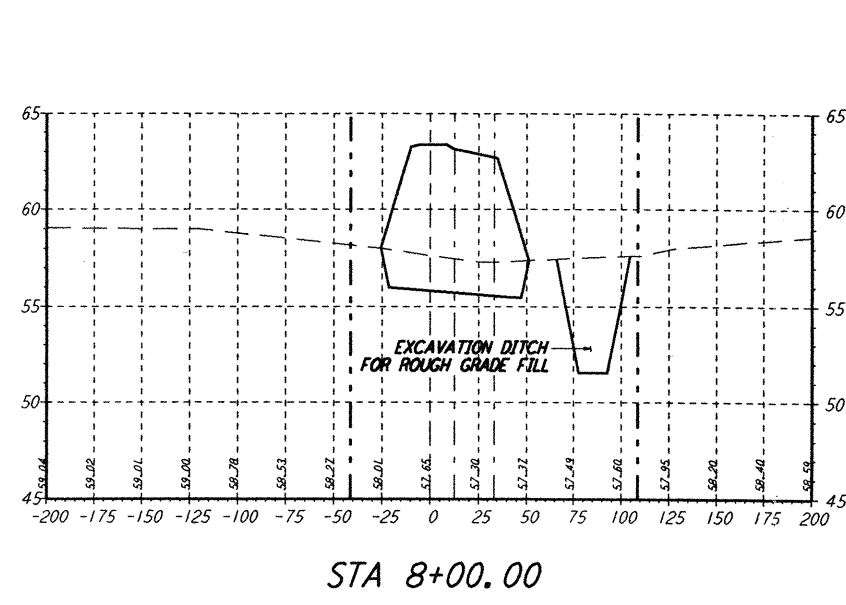

STA 8+00.00

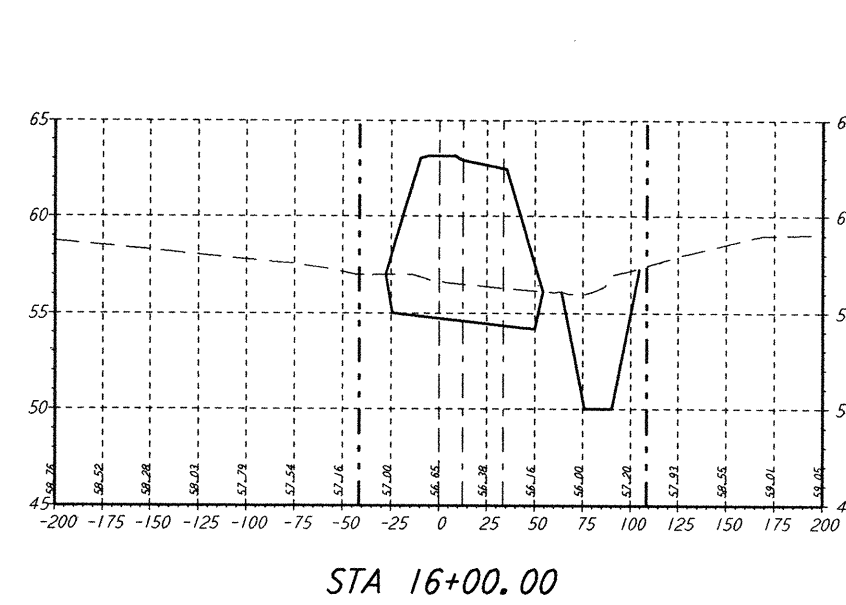

STA 16+00.00

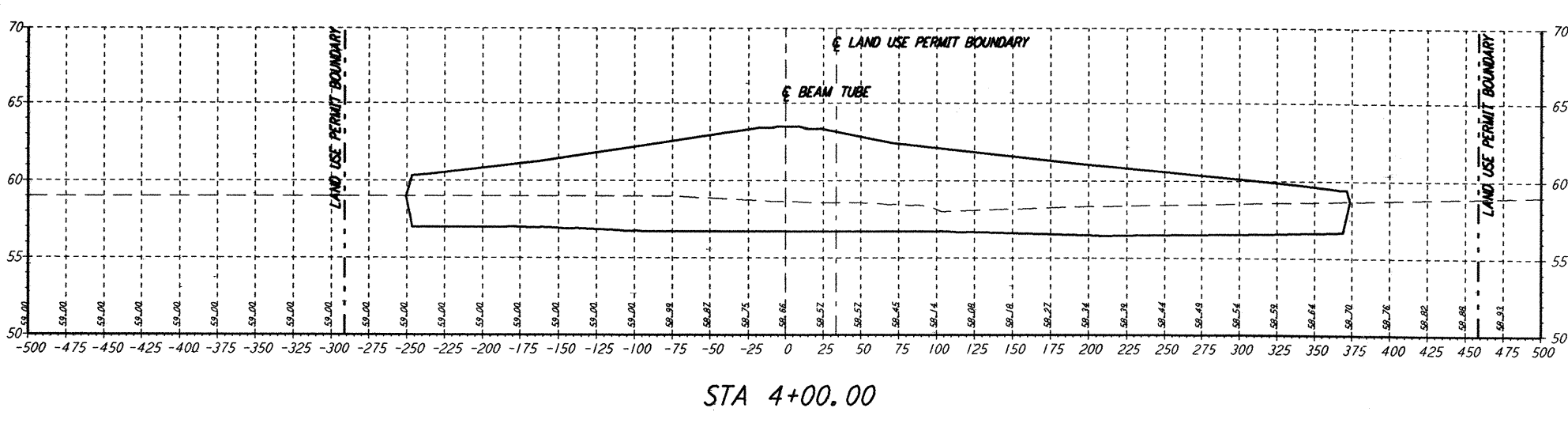

STA 4+00.00

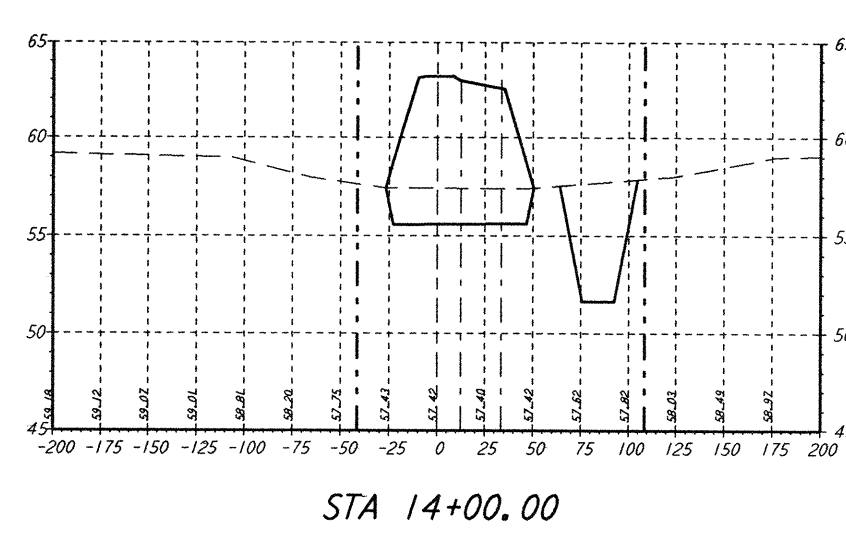

STA 14+00.00

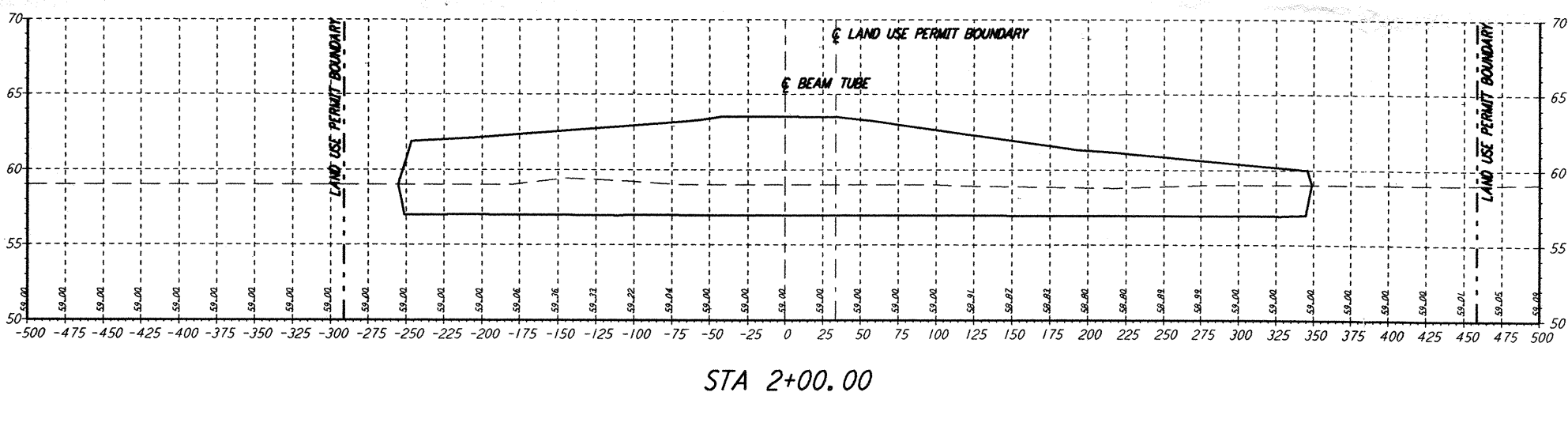

STA 2+00.00

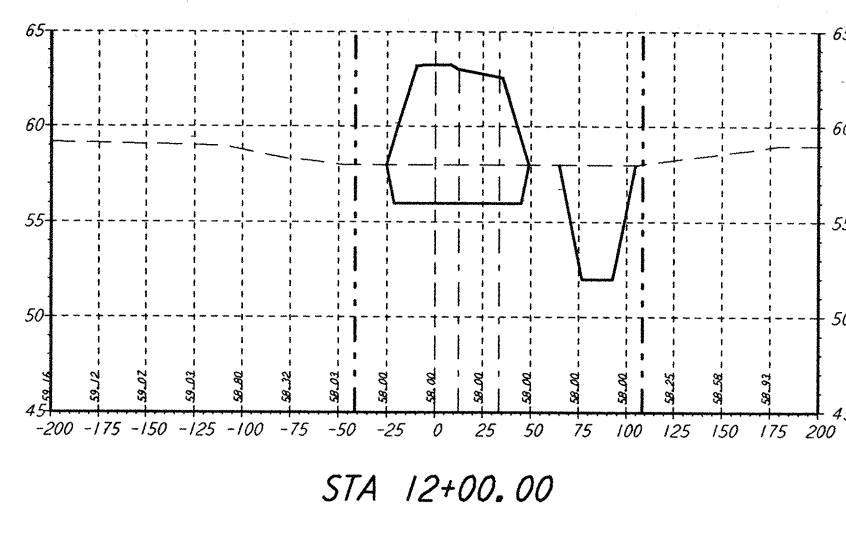

STA 12+00.00

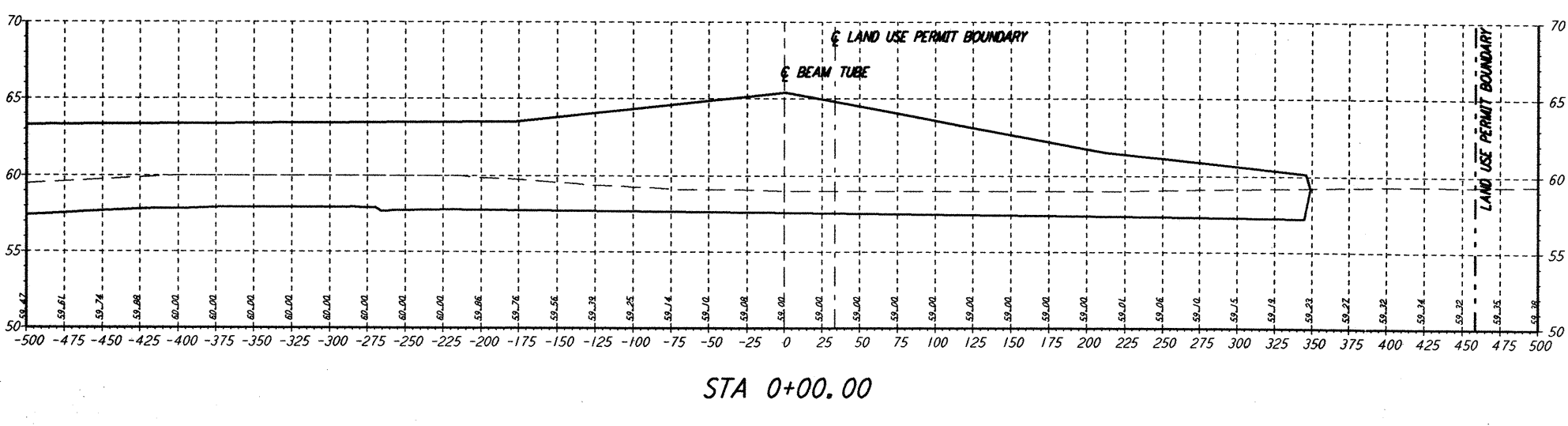

STA 0+00.00

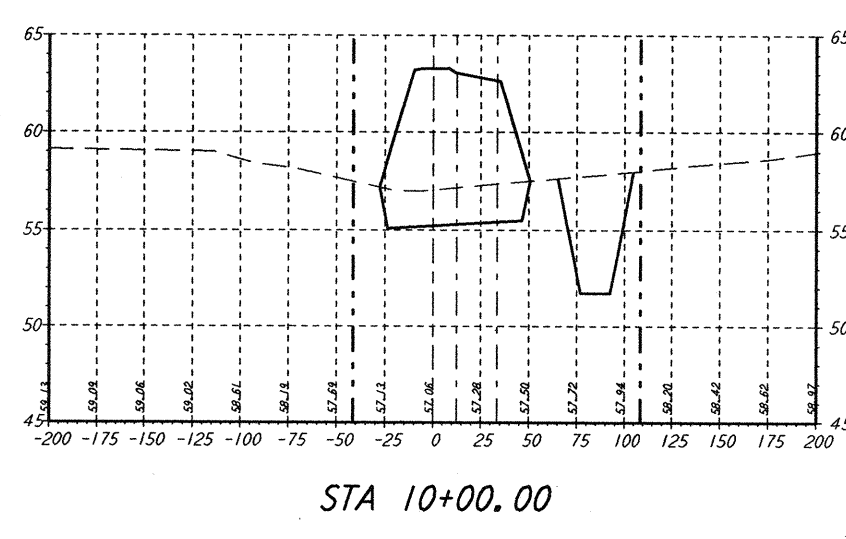

STA 10+00.00

- NOTES:  
1. SEE SHEET RG-C-002 FOR GENERAL NOTES, LEGEND AND ABBREVIATIONS.  
2. CALLOUTS TYPICAL FOR ALL SECTIONS UNLESS OTHERWISE NOTED.

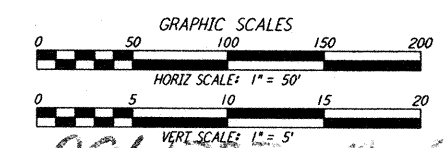

L360-0961777-A-C

not be reproduced, copied, loaned, exhibited, or used in any other way, except by written consent from PARSONS to the borrower.

This document and the design it covers are the property of PARSONS. They are loaned only with the borrower's expressed written agreement that they will

NO.	DATE	APPROVED BY	DESCRIPTION OF REVISION

NO.	DATE	APPROVED BY	ISSUED FOR
1	8/11/95	JUB	FINAL DESIGN REVIEW

DATE	8/11/95
DRAWN	WRB WRS
CHECKED	MGP
SECT HD	
PROJ MGR	
CLIENT	

100 WEST WALNUT STREET  
PASADENA, CALIFORNIA

CALIFORNIA INSTITUTE OF TECHNOLOGY  
MASSACHUSETTS INSTITUTE OF TECHNOLOGY

LASER INTERFEROMETER  
GRAVITATIONAL-WAVE OBSERVATORY  
ROUGH GRADING - LIVINGSTON, LA

TITLE: **ROUGH GRADING SOUTHWEST ARM SECTIONS STA 0+00 TO STA 16+00**

AS NOTED: **PP150969 8094**

SHEET NUMBER: **RG-C-021**

Sun Aug 13 20:26:21 1995 s3-v18b2 K:\PLOTS\QUEUES\18B2\CE021A.PRF