

REVISIONS			
REV.	DESCRIPTION	APPROVED	DATE
A	RELEASED	AJL	10/1/96

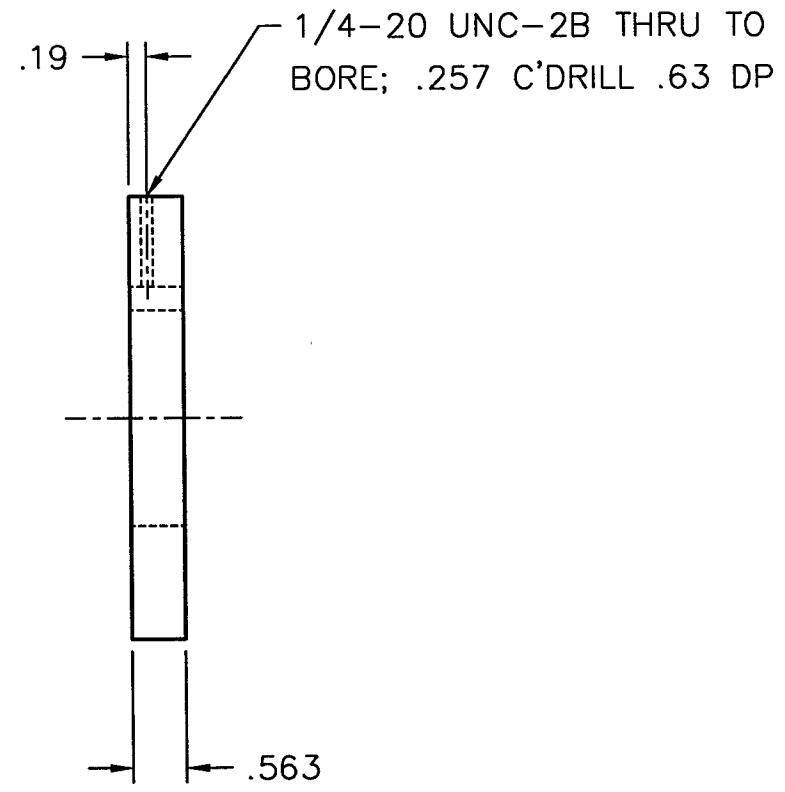
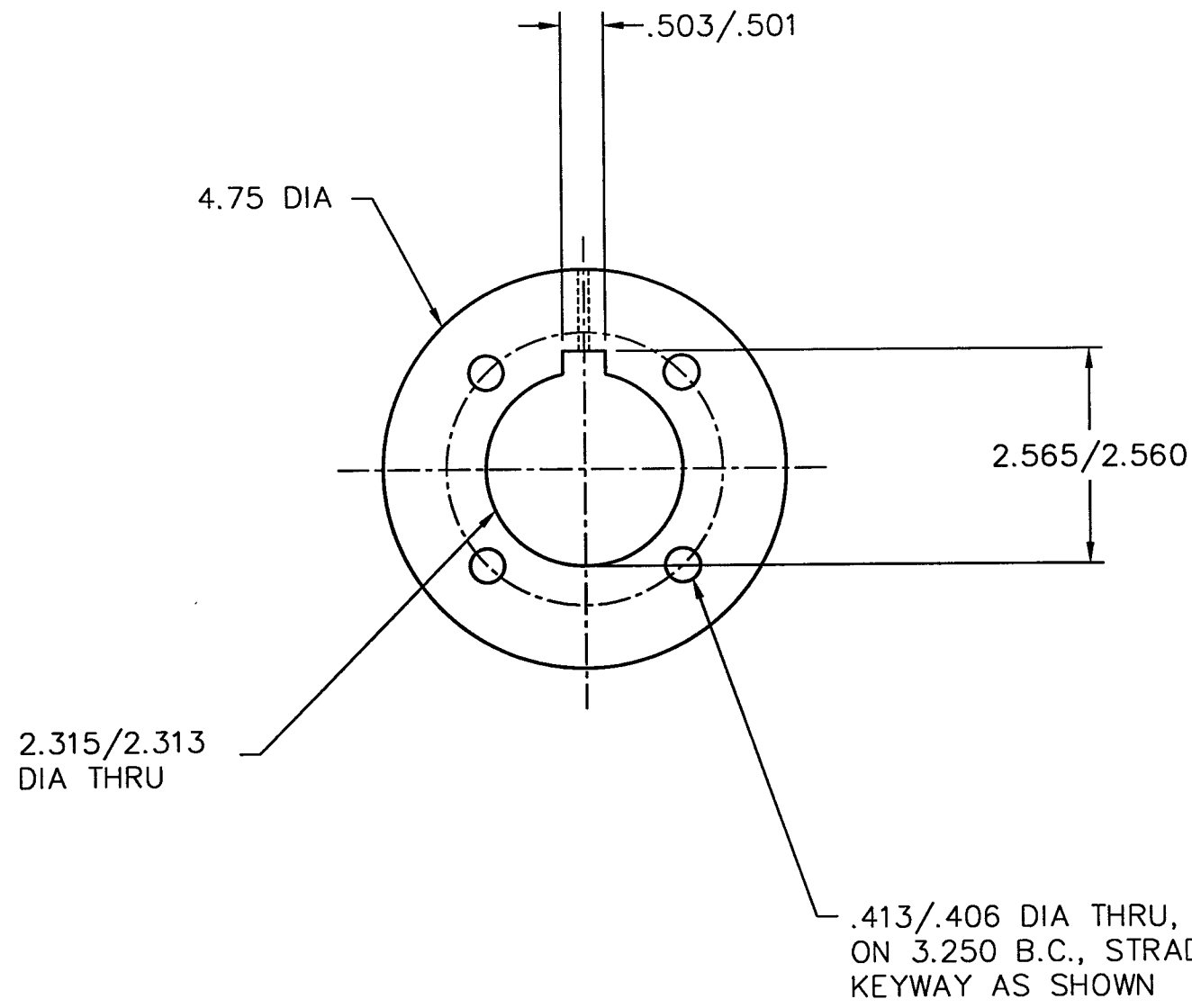

DEC 1 9 96

PSI DWG # V049-8-551
M60-D961667-A-V

B103786
USED ON

ITEM	QTY.	PART NO.	DESCRIPTION
PART LIST			MATERIAL SPECIFICATION: MATL
<small>UNLESS OTHERWISE SPECIFIED DIMENSIONS ARE IN INCHES TOLERANCES ARE: DECIMALS ANGLES FINISH .XX ± .01 ± 10' 32/ .XXX ± .005</small>		CONTRACT OR SALES ORDER NO. J	GNB Corporation <small>SCIENTIFIC AND INDUSTRIAL EQUIPMENT 30971 San Benito Ct. HAYWARD, CALIFORNIA 94544 (510) 441-1900 FAX: (510) 441-0939</small>
<small>UNSPECIFIED FILLETS: R.015 BREAK EDGES: Ø10 ± 45° REMOVE ALL BURRS</small>		APPROVALS DATE	
<small>THIRD ANGLE PROJECTION</small> 		DRAFTER	
<small>DO NOT SCALE DRAWING</small>		CHECKER	
CADD FILE NAME		ENGINEER	TITLE
B103742A		AJL 10/1/96	ALUMINUM SPACER PLATE, CLUTCH, LIGO G44E, G48E
			B DWG. NO. 103742
			SCALE: NONE
			SHEET 1 OF 1
			REV. A

NOTES:
FINAL CLEANING TO MEET
GNB SPEC. PER UHV