

REVISIONS			
REV.	DESCRIPTION	APPROVED	DATE
A	RELEASED	AJL	10-22-96

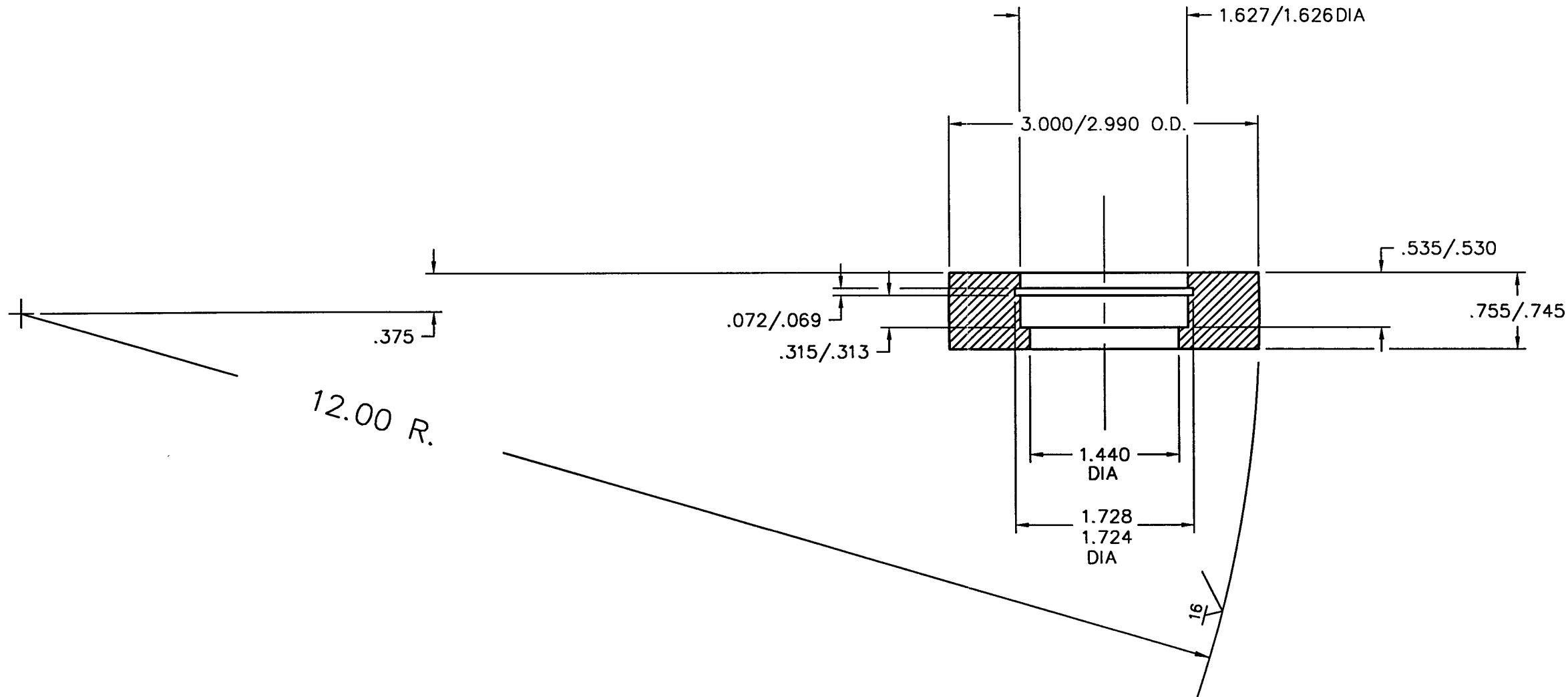

DEC 19 1996

LIGO-D961663-A-V

PSI DWG # V049-8-547

ITEM	QTY.	PART NO.	DESCRIPTION
			17-4 PH STAINLESS, 3" DIA BAR
PART LIST			MATERIAL SPECIFICATION: SEE ABOVE
UNLESS OTHERWISE SPECIFIED DIMENSIONS ARE IN INCHES TOLERANCES ARE: DECIMALS .01 ± .01 ANGLES 32' XXX ± .005		CONTRACT OR SALES ORDER NO.	
UNSPECIFIED FILLETS: R.015 BREAK EDGES .010 ± .45° REMOVE ALL BURRS		APPROX. WT.	
THIRD ANGLE PROJECTION		APPROVALS DATE	
DO NOT SCALE DRAWING		DRAFTER AJL 10-22-96	
CAD FILE NAME		CHECKER	
B103736A		ENGINEER	
GNB Corporation SCIENTIFIC AND INDUSTRIAL EQUIPMENT 30971 San Benito Ct. HAYWARD, CALIFORNIA 94544 (510) 441-1900 FAX: (510) 441-0939			TITLE
GUIDE WHEEL LIGO G44, G48			B DWG. NO. 103736
SCALE: NONE			REV. A
SHEET 1 OF 1			

NOTES:

1. PROTECT ALL SURFACES FROM SCRATCHES, GOUGES AND TOOLING MARKS DURING HANDLING
2. MATERIAL IS TYPE 17-4 STAINLESS. HEAT TREAT TO CONDITION H900 BEFORE MACHINING.

C103255

USED ON