

103211

| REVISIONS | | | |
|-----------|---|----------|----------|
| REV. | DESCRIPTION | APPROVED | DATE |
| A | RELEASED | ZH | 1-17-96 |
| B | REDRAWN TO SCALE | AH | 4-15-96 |
| C | REVISED AND REDRAWN SHOWING VENT GROOVES | AJL | 10-29-96 |
| D | ADDED 8.500, -8.500, 31.375, AND -31.375 DIMS | AJL | 11-13-96 |

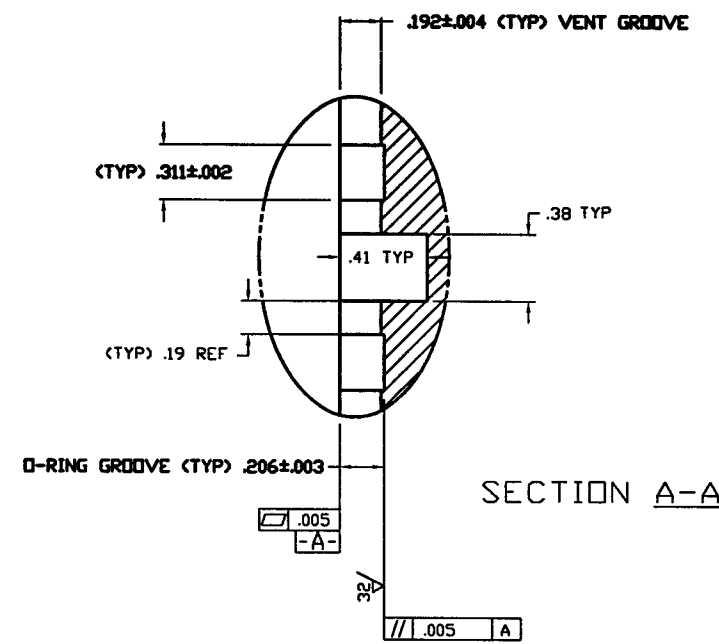
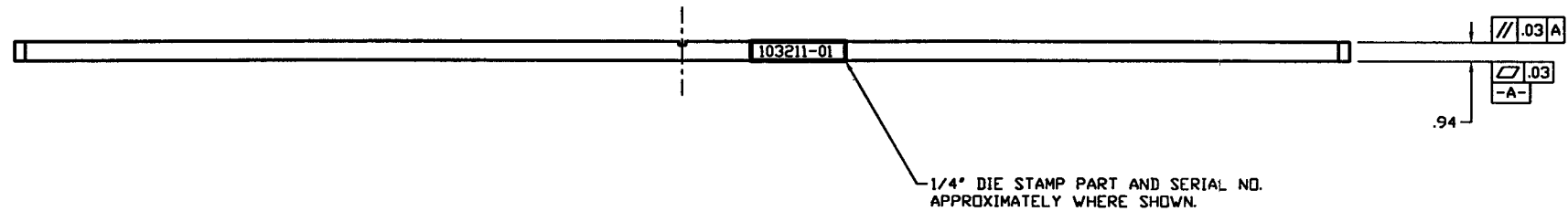
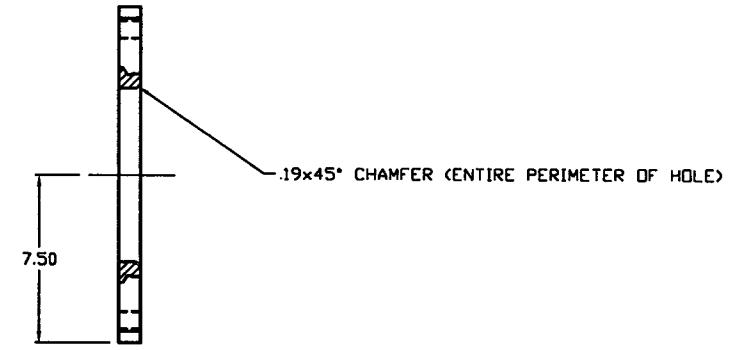
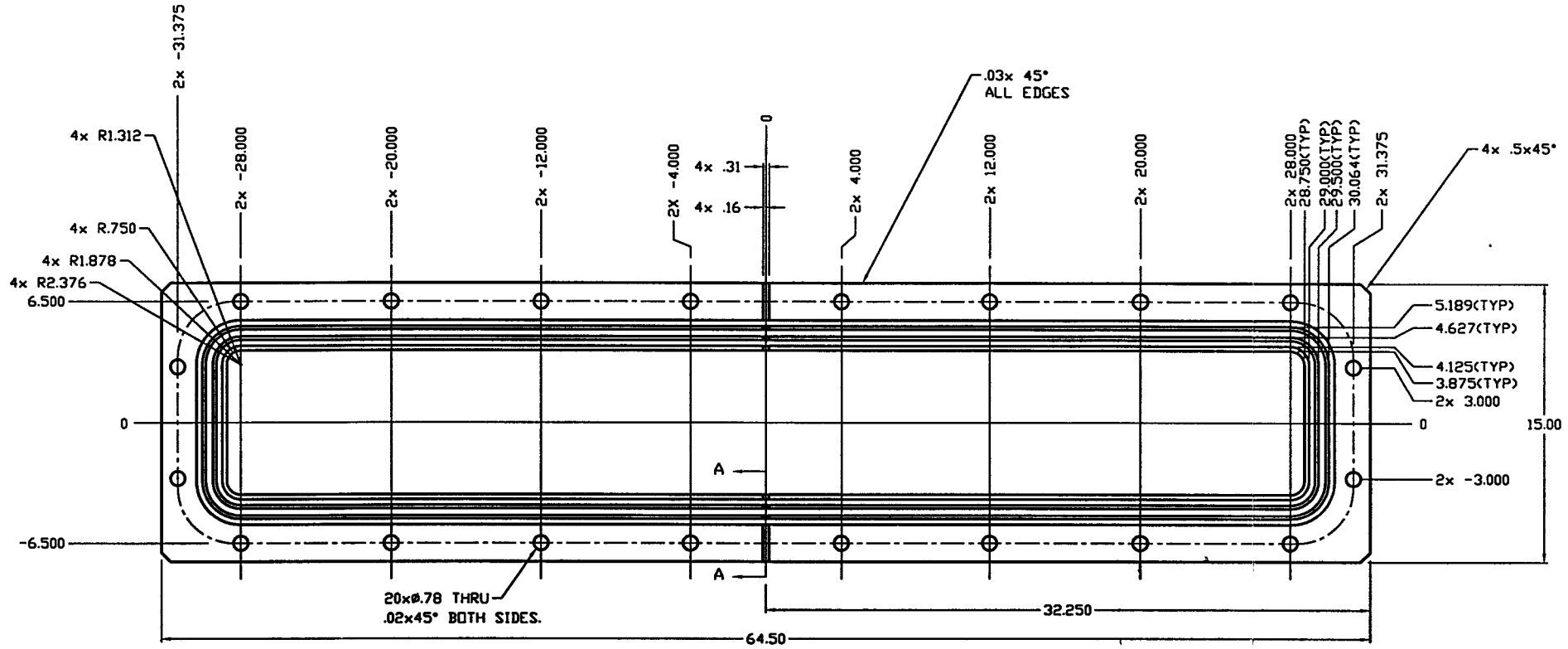

DEC 19 1996

PSI DWG # V049-8-155
L190-D961595-D-V

- NOTES:
1. DEBUR AND HAND FINISH ALL SURFACES. NO SNAGGING SHALL OCCUR WHILE WIPING WITH CLEAN COTTON CLOTH.

| ITEM | QTY. | PART NO. | DESCRIPTION |
|-------------|------|-------------------|-------------------------------|
| PART LIST | | | MATERIAL SPECIFICATION: T304L |
| | | | |
| 4103225 | | 1" PLATE | |
| USED ON | | D103211D | |
| DATE | | 4-15-96 | |
| DRAWN BY | | AH | |
| CHECKED BY | | AH | |
| APPROVED BY | | AH | |
| DATE | | 4-15-96 | |
| PART NO. | | 103211 | |
| REV. | | D | |
| DESCRIPTION | | BONNET FLANGE G44 | |
| MATERIAL | | T304L | |
| QUANTITY | | 1 | |
| UNIT | | NONE | |
| DRAWN BY | | AH | |
| CHECKED BY | | AH | |
| APPROVED BY | | AH | |
| DATE | | 4-15-96 | |

103211

103211