

NOTES: UNLESS OTHERWISE SPECIFIED
 1. REMOVE ALL BURRS AND SHARP EDGES.
 ② 1/4 OR 3/8 HEX STOCK MAY BE USED.

REV	DATE	DRAWN BY	CHECKED	DCC	DCN/DESCRIPTION
A	7-28-97	J. Hazel			E970121/INITIAL RELEASE

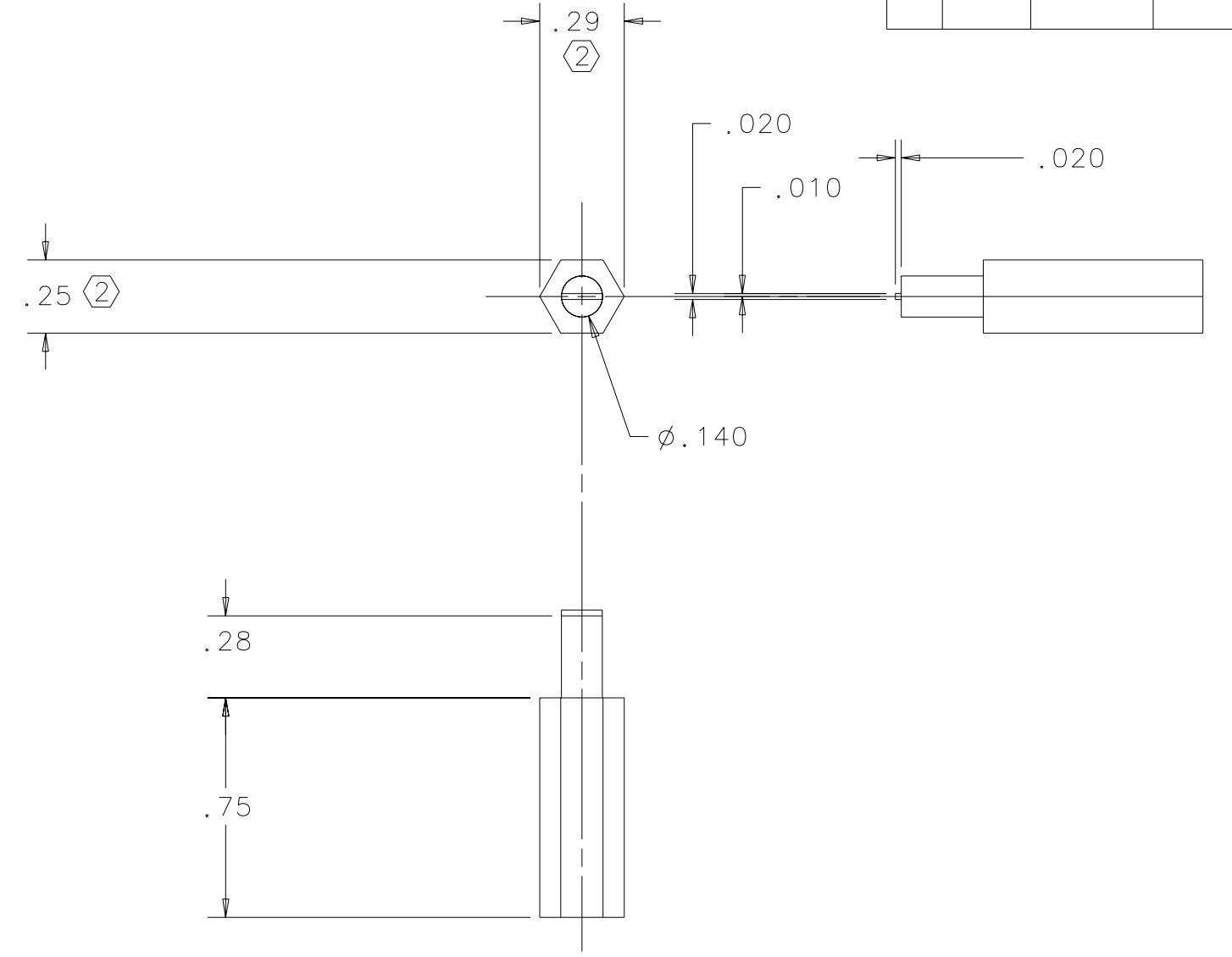

QTY REQD	FSCM NO	PART OR IDENTIFYING NO	NOMENCLATURE OR DESCRIPTION	MATERIAL SPECIFICATION	ITEM NO
			PARTS LIST		
UNLESS OTHERWISE SPECIFIED DIMENSIONS ARE IN IN (mm) TOLERANCES ARE: FRACTIONS DECIMALS .XX=±.03 .XXX=±.005 ANGLES=±.5° DO NOT SCALE DRAWING			APPROVALS DRAWN J. Hazel GROUP CHECKED	DATE 6/97	CALIFORNIA INSTITUTE OF TECHNOLOGY MASSACHUSETTS INSTITUTE OF TECHNOLOGY TITLE SOS SET SCREW TOOL
MATERIAL	ALUM OR STEEL			SIZE B	DWG NO. D961412-A-D
FINISH	NONE			SCALE 2/1	FILENAME /home/dcc/docs/D961412.pdf
					SHEET 1 OF 1