

- LEGEND**
- [A] 3 WAY ANCHOR
  - [SG] SUPPORT/GUIDE (AXIALLY FLEXIBLE)
  - [S] VALVE SUPPORT
  - [ ] GATE VALVE ION PUMP LOCATION
  - [VS] VALVE SEAL SIDE OF LARGE GATE VALVE

- NOTES:**
1. ALL GATE VALVES ARE SUPPLIED BY PSI.
  - NOTE: SPECIAL BOLTS AND WASHERS ARE REQUIRED TO CONNECT SPOOL FLANGES TO 44" AND 48" GATE VALVES. USE PSI P/N 203567 FOR BOLTS AND PSI P/N 203568 FOR WASHERS. SEE BUILDING BOM V049100WA FOR MATERIALS.
  - FOR ORIENTATION OF LARGE GATE VALVES SEE SIDE OF VALVE NOTED BY SYMBOL 'VS' IN PLAN BELOW. ALL 6", 10" & 14" GATE VALVES ARE TO HAVE SEAL SIDE MOUNTED TOWARD VESSEL.
  2. SEE SPEC. V049-2-021 FOR INSTALLATION/ COMMISSIONING INFORMATION.
  3. FOR TUBING/ PIPE SUPPORT REQUIREMENTS, SEE SPEC. V049-2-021, SECTION 10.
  4. SEE DWG. D V049-4-011 FOR TURBO PUMP CART INSTALLATION. 2 UNITS REQUIRED IN CORNER STATION.
  5. SEE DWG. D V049-4-010 FOR MAIN ROUGHING PUMP CART INSTALLATION. 2 UNITS REQUIRED IN CORNER STATION.
  6. LN<sub>2</sub> TANK ANCHOR BOLTS INSTALLED BY OTHERS.
  7. ORIENTATION OF BSC'S IS TO HAVE 0° CENTERLINE POSITIONED AS SHOWN.

NOTE: FOR ANCHOR BOLTS AND VIBRATION ISOLATION PAD REQUIREMENTS UNDER MECH. ROOM EQUIPMENT AND ELECTRICAL CABINETS, SEE DWG. V049-5-014, SHT 2 DF 3.

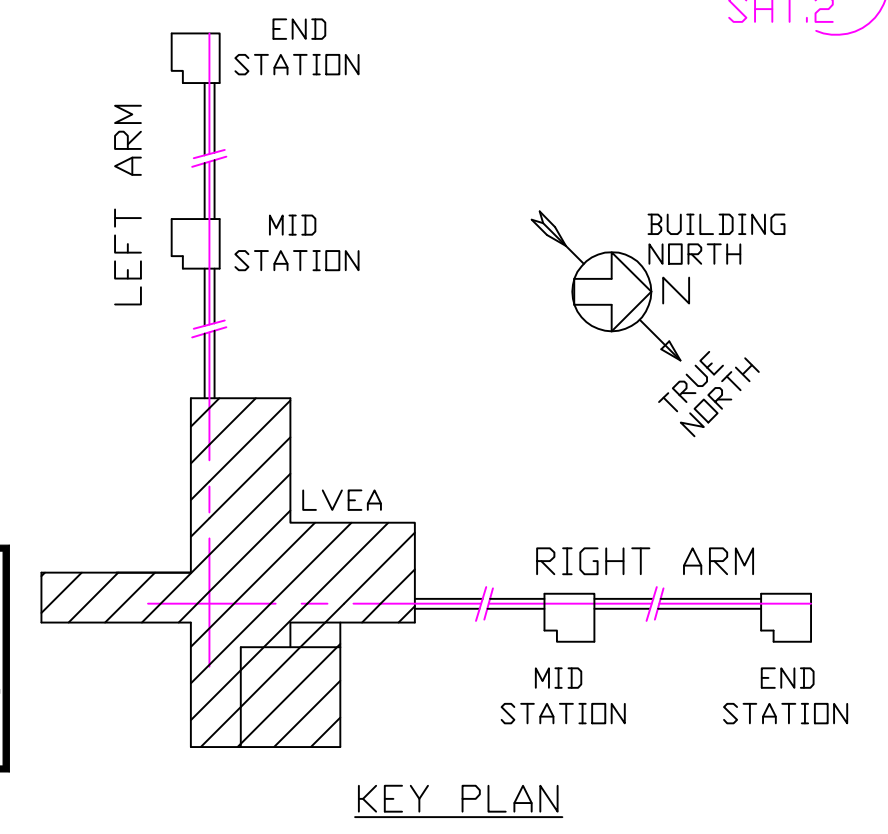

<p>PROPRIETARY AND CONFIDENTIAL</p> <p>THIS DOCUMENT CONTAINS PROPRIETARY INFORMATION BELONGING TO PROCESS SYSTEMS INTERNATIONAL, INC. OR ITS AFFILIATED COMPANIES AND SHALL BE USED ONLY FOR THE PURPOSE FOR WHICH IT WAS SUPPLIED. IT SHALL NOT BE COPIED, REPRODUCED OR OTHERWISE USED, NOR SHALL SUCH INFORMATION BE FURNISHED IN WHOLE OR IN PART TO OTHERS EXCEPT IN ACCORDANCE WITH THE TERMS OF ANY AGREEMENT UNDER WHICH IT WAS SUPPLIED OR WITH THE PRIOR WRITTEN CONSENT OF PROCESS SYSTEMS INTERNATIONAL, INC. AND SHALL BE RETURNED UPON REQUEST.</p>		<p>V049-0-100 DRAWING TREE/BOM STRUCTURE</p> <p>V049-0-001 P&amp;ID LIGO VACUUM EQUIPMENT</p> <p>V049-2-021 SPEC. FOR INSTALLATION &amp; COMMISSIONING.</p> <p>WA-A-501 PARSONS ARCHITECTURAL CORNER STATIONS</p> <p>LVEA FLOOR PLAN</p> <p>1101100 LIGO VACUUM EQUIPMENT CORNER STATION</p>	<p>UNLESS OTHERWISE SPECIFIED DIMENSIONS ARE IN INCHES</p> <p>TOLERANCES:</p> <p>FRACTIONAL ±</p> <p>ANGULAR/ARCH ± BEND ±</p> <p>TWO PLACE DECIMAL ±</p> <p>THREE PLACE DECIMAL ±</p> <p>FINISHED SURFACE RMS BREAK CORNERS IN OUT: REMOVE ALL BURRS</p> <p>DO NOT SCALE THIS DRAWING</p> <p>USED ON:</p> <p>NEXT ASS'Y:</p>	<p>5 AS-BUILT</p> <p>4 REISSUED FOR CONSTRUCTION AS NOTED</p> <p>3 REISSUED FOR CONSTRUCTION AS NOTED</p> <p>2 ISSUED FOR CONSTRUCTION</p> <p>1 ISSUED FOR FDR UPDATE &amp; BID</p> <p>0 ISSUED FOR FDR</p>	<p>GW 6/26/98 0623</p> <p>DMW RDC REC DA 6/26/97 0507</p> <p>DMW RDC REC SPIDER 6/6/97 0497</p> <p>DMW RDC REC PV 4/14/97 0465</p> <p>DMW RDC REC P.V. 2/4/97 0356</p> <p>DMW RDC REC MA 04/27/96 0147</p>	<p>PROCESS SYSTEMS INTERNATIONAL, INC.</p> <p>20 WALKUP DR. WESTBOROUGH, MASSACHUSETTS 01581 USA</p> <p>EQUIPMENT ARRANGEMENT PLAN AREA 100 CORNER STATION WASHINGTON LIGO VACUUM EQUIPMENT</p> <p>CAD FILE V0495001/5001S1 SIZE D DWG. NO. V049-5-001 REV 5</p> <p>SCALE 1"=10' SHEET 1 OF 2</p>
--	--	--	---	---	--	---

EDUCATION VERSION - NOT FOR COMMERCIAL USE

May 22, 1998 - 10:10:18



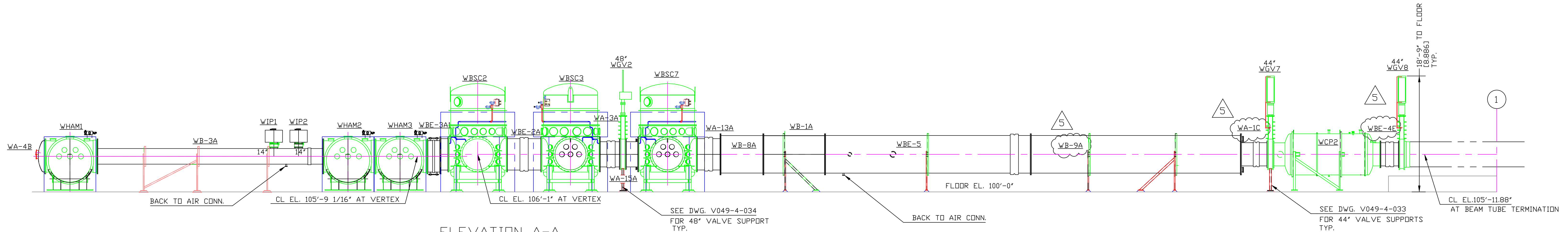

ELEVATION A-A  
VERTEX SECTION - RIGHT BEAM MANIFOLD

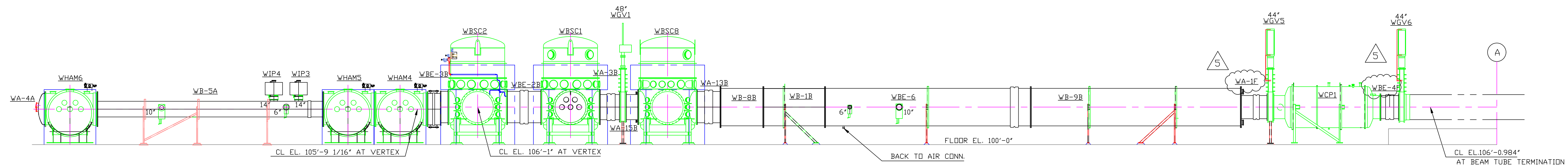

ELEVATION B-B  
VERTEX SECTION - LEFT BEAM MANIFOLD

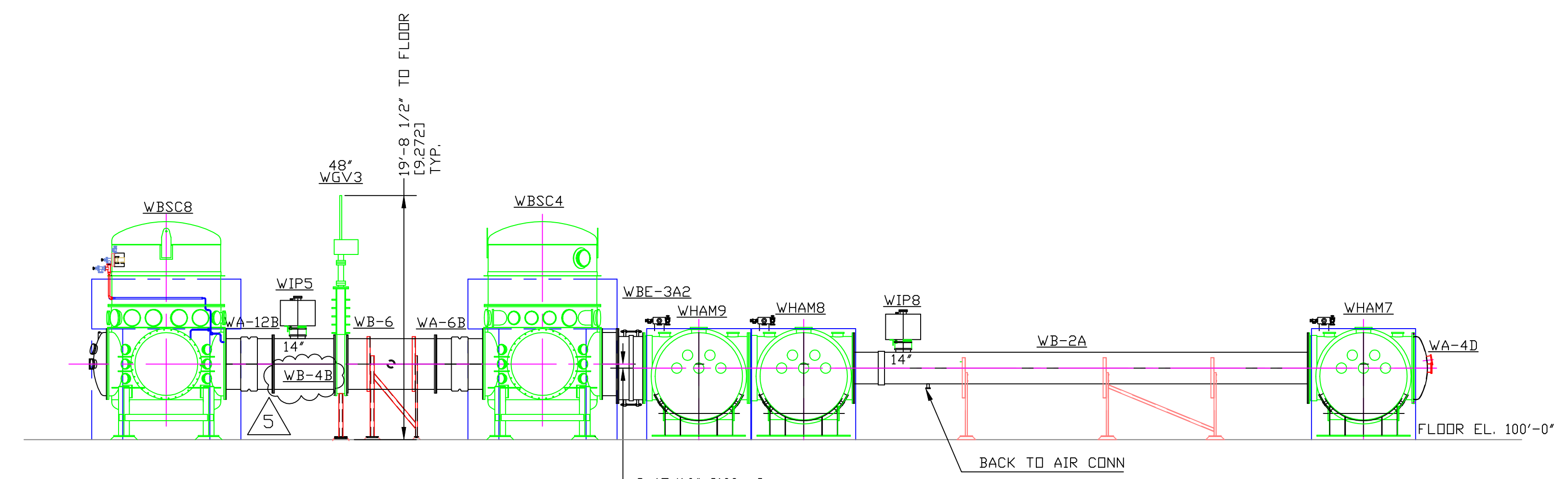

ELEVATION C-C  
RIGHT BEAM MANIFOLD - DIAGONAL SECTION

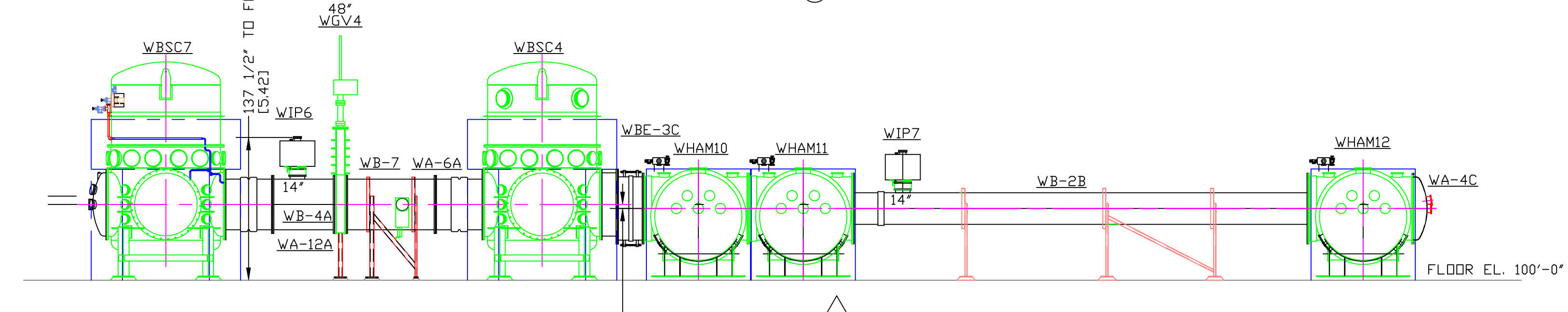

ELEVATION D-D  
LEFT BEAM MANIFOLD - DIAGONAL SECTION

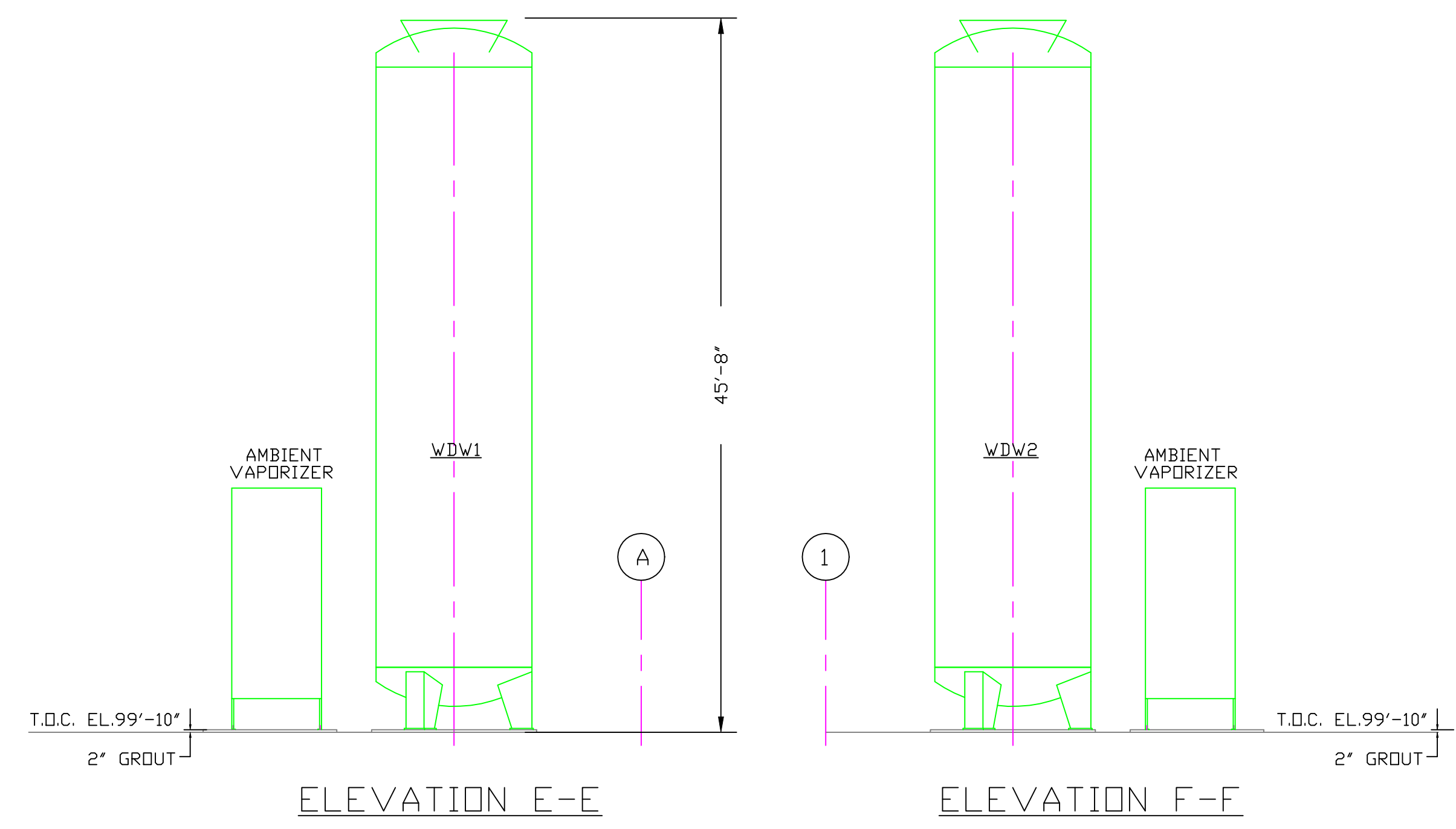

ELEVATION E-E

ELEVATION F-F

<b>PROCESS SYSTEMS INTERNATIONAL INC.</b> 20 WALKUP DR. WESTBOROUGH, MASSACHUSETTS 01581 USA			
<b>EQUIPMENT ARRANGEMENT ELEVATION</b> <b>CORNER STATION WASHINGTON LIGD VACUUM EQUIPMENT</b>			
CAD FILE	SIZE	DWG. NO.	REV.
V0495001/5001S2	D	V049-5-001	5
SCALE	SHEET		
1/8" = 1'-0"	2 OF 2		

MAY 22, 1998 - 101908

EDUCATION VERSION - NOT FOR COMMERCIAL USE

8 | 7 | 6 | 5 | 4 | 3 | 2 | 1