

SCALE: 1 1/2 -1'-0

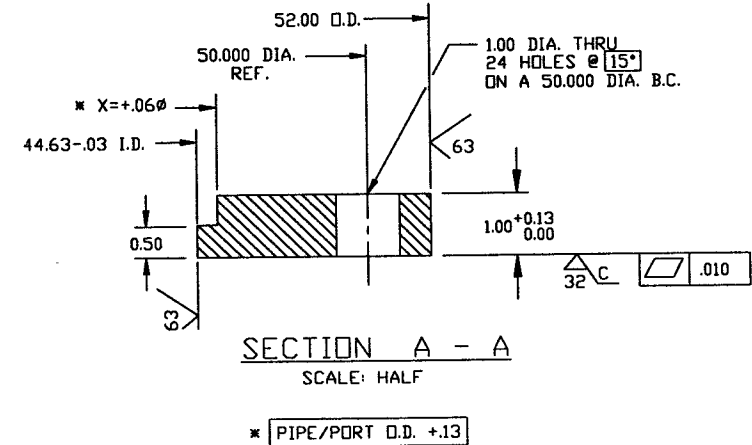

- NOTE:**
- 1: FLANGES WILL BE USED IN ULTRA HIGH VACUUM SERVICE SEE SPECIFICATION V049-2-040 FOR MATERIAL REQUIREMENTS
 - 2: ALL MATERIAL TO BE 304L STAINLESS STEEL
 - 3: FLANGES MUST BE PACKAGED, HANDLED, AND SHIPPED IN SUCH A MANNER AS TO MAINTAIN SPECIFIED SURFACE FINISHES AND FLATNESS TOLERANCES.
 - 4: MACHINE TOOL LAY TO BE CONCENTRIC ON ALL SURFACES THAT REQUIRE A 32 RMS FINISH
 - 5: NO ABRASIVE STONES, CLOTHS OR GRINDING WHEELS MAY BE USED.
 - 6: NO OIL BASED OR HYDROCARBON BASED CUTTING FLUIDS TO BE USED.
 - 7: NO CARBON STEEL OR OTHER SOURCE OF IRON CONTAMINATION ARE TO COME IN CONTACT WITH FLANGES DURING MANUFACTURING OR HANDLING.
 - 8: STEAM CLEAN & WRAP IN POLYETHELENE TO PREVENT CONTAMINATION DURING SHIPPING.

NOT FOR CONSTRUCTION

Raymond O. Liatto, PE
 5/6/96
 LIGO D961124-00-V

PRO AND CONFIDENTIAL THIS CONTAINS PROPRIETARY INFORMATION BELONGING TO PROCESS SYSTEMS INTERNATIONAL, INC. OR ITS AFFILIATED COMPANIES AND SHALL BE USED ONLY FOR THE PURPOSE FOR WHICH IT WAS SUPPLIED. IT SHALL NOT BE COPIED, REPRODUCED OR OTHERWISE USED, NOR SHALL SUCH INFORMATION BE FURNISHED IN WHOLE OR IN PART TO OTHERS EXCEPT IN ACCORDANCE WITH THE TERMS OF ANY AGREEMENT UNDER WHICH IT WAS SUPPLIED OR WITH THE PRIOR WRITTEN CONSENT OF PROCESS SYSTEMS INTERNATIONAL, INC. AND SHALL BE RETURNED UPON REQUEST.	UNLESS OTHERWISE SPECIFIED										PROCESS SYSTEMS INTERNATIONAL, INC. 20 WALKUP DR. WESTBOROUGH, MASSACHUSETTS 01581 USA		
	DIMENSIONS ARE IN INCHES		TOLERANCES:		FRACTIONAL ± 1/16		ANGULAR DIMS 40°-90° BIDS ± 2°		TWO PLACE DECIMAL ± .010		THREE PLACE DECIMAL ± .005		FINISHED SURFACE BIDS 63 BREAK CORNERS - INCHES OUT .005 REMOVE ALL BURRS
DWG. NO.	DESCRIPTION	USED ON:	REV.	DESCRIPTION	ISSUE DESCRIPTION	CHKD	DRAWN	DATE	DEC	CAD FILE	SIZE	DWG. NO.	REV.
	REFERENCE DRAWINGS	NEXT ASS'Y:	0	ISSUED FOR FDR		REG	PV	5-1-96	0150	V0494042	C	V049-4-042	0
										SCALE AS NOTED		SHEET 1 OF 1	

Oct 02, 1995 - 09:35:21