

SCALE: 1 1/2 -1'-0

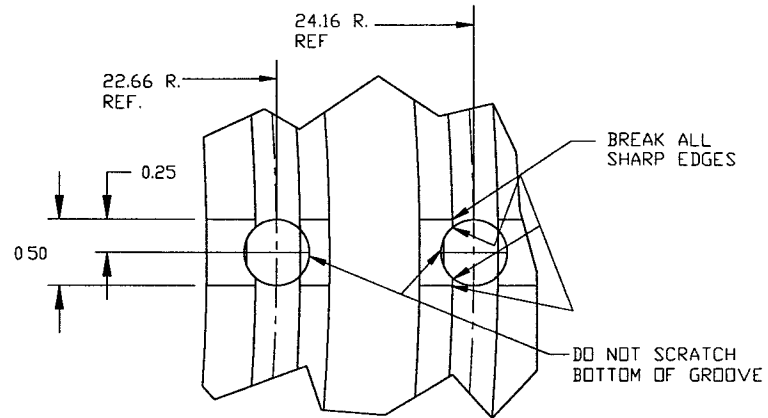

DETAIL C  
SCALE: FULL  
TYP. 2 PLACES @ 180°

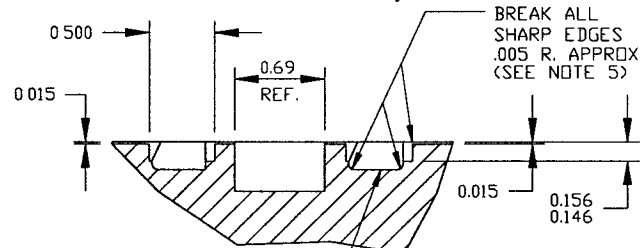

DETAIL D  
2 PLACES  
SCALE: 2x

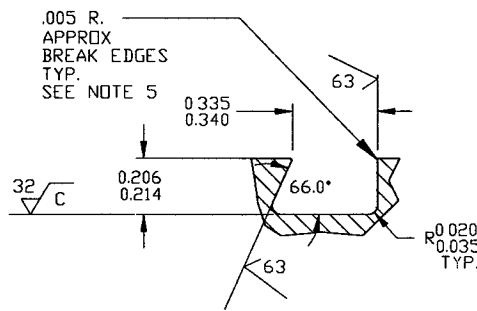

DETAIL E  
2 PLACES  
SCALE: 2x

- NOTE:
- 1: FLANGES WILL BE USED IN ULTRA HIGH VACUUM SERVICE SEE SPECIFICATION V049-2-040 FOR MATERIAL REQUIREMENTS
  - 2: ALL MATERIAL TO BE 304L STAINLESS STEEL
  - 3: FLANGES MUST BE PACKAGED, HANDLED, AND SHIPPED IN SUCH A MANNER AS TO MAINTAIN SPECIFIED SURFACE FINISHES AND FLATNESS TOLERANCES.
  - 4: MACHINE TOOL LAY TO BE CONCENTRIC ON ALL SURFACES THAT REQUIRE A 32 RMS FINISH
  - 5: NO ABRASIVE STONES, CLOTHS OR GRINDING WHEELS MAY BE USED.
  - 6: NO OIL BASED OR HYDROCARBON BASED CUTTING FLUIDS TO BE USED.
  - 7: NO CARBON STEEL OR OTHER SOURCE OF IRON CONTAMINATION ARE TO COME IN CONTACT WITH FLANGES DURING MANUFACTURING OR HANDLING.
  - 8: FLANGE FINAL FACE CUTS AND O-RING GROOVES MUST BE MACHINED DURING THE SAME SETUP.
  - 9: STEAM CLEAN & WRAP IN POLYETHYLENE TO PREVENT CONTAMINATION DURING SHIPPING.

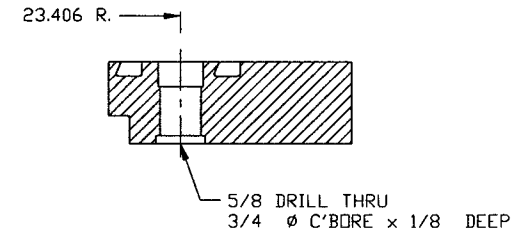

SECTION A - A  
2 PLACES @ 180°  
SCALE: HALF

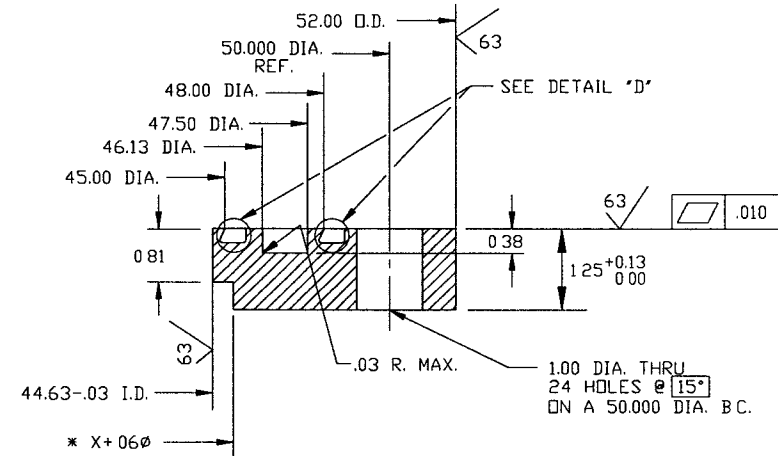

SECTION B - B  
SCALE: HALF

\* X=PORT/PIPE O.D. +.13

**NOT FOR CONSTRUCTION**

*Raymond S. Leath, P.E.*  
5/6/96 LIGO D961101-00-V

INNER O-RING .275 DIA. STOCK x 140 3/4' LG. VULCANIZED - BAKED VITON E-60C  
OUTER O-RING .275 DIA. STOCK x 150' LG. VULCANIZED - BAKED VITON E-60C

PRO AND CONFIDENTIAL  
THIS CONTAINS PROPRIETARY INFORMATION BELONGING TO PROCESS SYSTEMS INTERNATIONAL, INC. OR ITS AFFILIATED COMPANIES AND SHALL BE USED ONLY FOR THE PURPOSE FOR WHICH IT WAS SUPPLIED. IT SHALL NOT BE COPIED, REPRODUCED OR OTHERWISE USED, NOR SHALL SUCH INFORMATION BE FURNISHED IN WHOLE OR IN PART TO OTHERS EXCEPT IN ACCORDANCE WITH THE TERMS OF ANY AGREEMENT UNDER WHICH IT WAS SUPPLIED OR WITH THE PRIOR WRITTEN CONSENT OF PROCESS SYSTEMS INTERNATIONAL, INC AND SHALL BE RETURNED UPON REQUEST.

UNLESS OTHERWISE SPECIFIED  
DIMENSIONS ARE IN INCHES  
TOLERANCES:  
FRACTIONAL ± 1/16  
ANGULAR ± 0°-30' BEND ± 2°  
TWO PLACE DECIMAL ± .010  
THREE PLACE DECIMAL ± .005  
FINISHED SURFACE RMS 63  
BREAK CORNERS .125 ± .005  
REMOVE ALL BURRS

| REV | DESCRIPTION    | CHKD | DRAWN  | DATE     | DEO  |
|-----|----------------|------|--------|----------|------|
| 0   | ISSUED FOR FDR |      | Dhanes | 04/30/96 | 0150 |
| P3  | PRELIMINARY    |      |        | 12/28/95 |      |
| P2  | PRELIMINARY    |      |        | 12/5/95  |      |
| P1  | PRELIMINARY    |      |        | 10-24-95 |      |

|   |                 |                        |          |
|---|-----------------|------------------------|----------|
| PROCESS SYSTEMS INTERNATIONAL INC.<br>20 WALKUP DR WESTBOROUGH, MASSACHUSETTS 01581 USA |                 |                        |          |
| 44 5/8" I.D. FLANGE DETAIL<br>(GROOVED)<br>LIGO VACUUM EQUIPMENT                        |                 |                        |          |
| CAD FILE<br>V0494017  | SIZE<br>C       | DWG. NO.<br>V049-4-017 | REV<br>0 |
| SCALE<br>AS NOTED   | SHEET<br>1 OF 1 |                        |          |

10/02/1995 - 09:35:21