

This document and the design it covers are the property of PARSONS. They are loaned only with the borrower's expressed written agreement that they will not be reproduced, copied, loaned, exhibited, or used in any other way, except by written consent from PARSONS to the borrower.

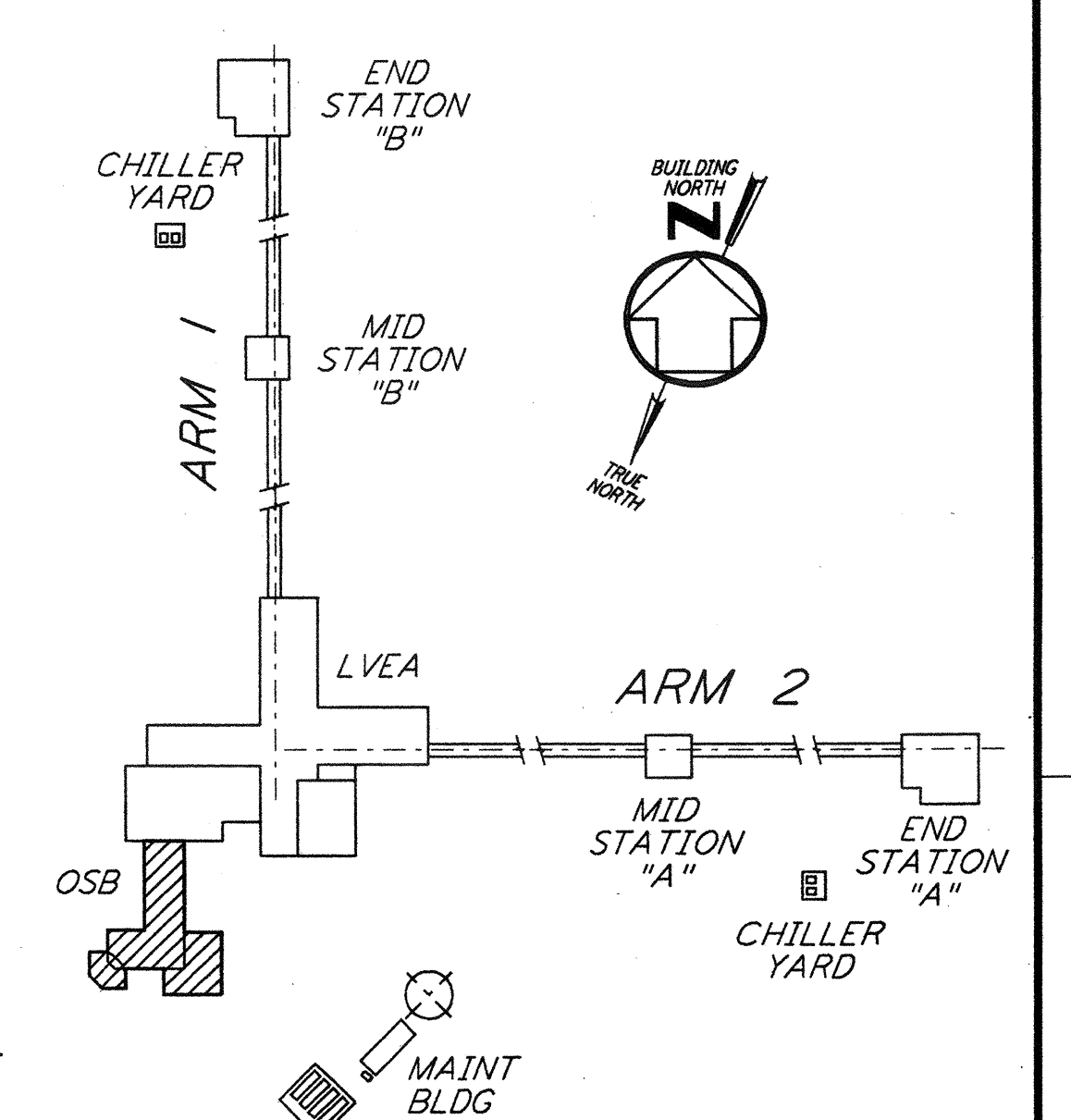
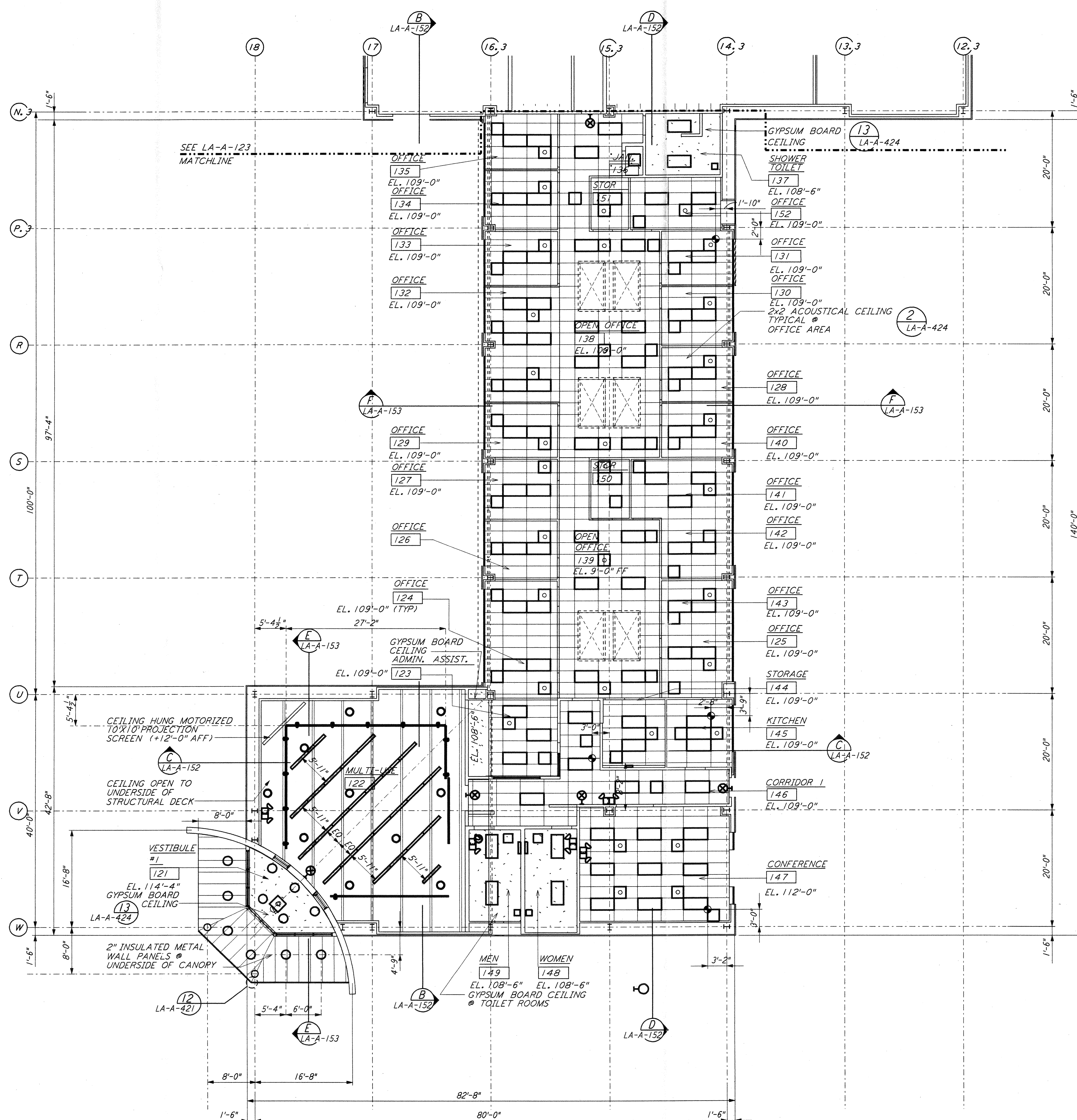
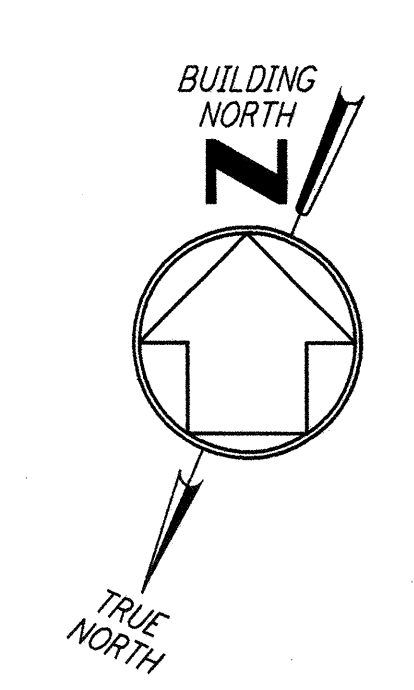

0 8 16 24 32FT
 $\frac{1}{8}'' = 1'-0''$
 DATUM POINT EL +100.00 = 61.44' (LVEA)
 DATUM POINT EL +100.00 = 61.44' (OSB)

KEY PLAN
LIGO-D960879-02-0

NO.	DATE	BY	CHKD	ENGR	PROJ	DESCRIPTION
2	08-07-98	SJM	CKT	AK	TDM	ISSUED FOR AS-BUILT
1	2-28-97	CKT	TB	AK	TDM	OSB REVISION

ISSUED FOR CONSTRUCTION
 DRAWN CKT 11-15-96
 CHECKED TB 11-15-96
 ENGINEER SF 11-15-96
 PROJ MDW 11-15-96

AS-BUILT DRAWINGS

PARSONS
 100 WEST WALNUT STREET
 PASADENA, CALIFORNIA

LIGO
 CALIFORNIA INSTITUTE OF TECHNOLOGY
 MASSACHUSETTS INSTITUTE OF TECHNOLOGY

LASER INTERFEROMETER GRAVITATIONAL-WAVE OBSERVATORY SITE NO. 2 - LIVINGSTON, LOUISIANA		
TITLE	SHEET NUMBER	PROJECT NUMBER
ARCHITECTURAL CORNER STATION OSB PARTIAL REFLECTED CEILING PLAN SHEET I	AS NOTED PP150969	8094
LA-A-122		