

GENERAL NOTES

A. GENERAL CONTRACTOR

1. THE CONTRACTOR SHALL VISIT THE SITE AND BE KNOWLEDGEABLE OF CONDITIONS THEREOF. HE SHALL INVESTIGATE, VERIFY AND BE RESPONSIBLE FOR ALL CONDITIONS OF THE PROJECT AND SHALL NOTIFY CONSTRUCTION MANAGER OF ANY CONDITION REQUIRING MODIFICATION BEFORE PROCEEDING WITH WORK.
2. ALL DIMENSIONS SHALL BE VERIFIED IN THE FIELD BEFORE PROCEEDING WITH THE WORK. THE CONSTRUCTION MANAGER SHALL BE NOTIFIED OF ANY CORRECTION.
3. DIMENSIONS SHOWN ON FLOOR PLANS, SECTIONS AND DETAILS ARE TO FACE OF FINISH, COLUMN GRID LINES OR FACE OF CONCRETE AND BLOCK WALLS, UNLESS OTHERWISE NOTED OR SHOWN.
4. ALL DISTANCES, DATA AND EXISTING STRUCTURES AND UTILITIES ABOVE OR BELOW GROUND WITHIN THE LIMITS OF THIS PROJECT SHALL BE CHECKED BY THE CONTRACTOR. IN CASES OF CONFLICT THE CONSTRUCTION MANAGER SHALL BE NOTIFIED IMMEDIATELY IN ORDER THAT CLARIFICATION MAY BE MADE.
5. ALL ELEVATIONS SHOWN REFER TO FINISHED SURFACE, UNLESS NOTED OTHERWISE.
6. ALL DIMENSIONS SHALL HAVE PREFERENCE OVER SCALE; DO NOT SCALE DRAWINGS. LARGE SCALE DETAILS GOVERN OVER SMALL SCALE DETAILS.
7. ALL SYMBOLS AND ABBREVIATIONS USED ON THE DRAWINGS ARE CONSIDERED CONSTRUCTION STANDARDS. IF THE CONTRACTOR HAS QUESTIONS REGARDING SAME, OR THEIR EXACT MEANING, THE CONSTRUCTION MANAGER SHALL BE CONSULTED FOR CLARIFICATION.
8. DETAILS ARE INTENDED TO SHOW DESIGN INTENT OF ACCOMPLISHING WORK. MINOR MODIFICATIONS MAY BE REQUIRED TO SUIT JOB CONDITIONS AND SHALL BE INCLUDED AS PART OF THE WORK.
9. DETAILS NOT SHOWN ARE SIMILAR IN CHARACTER TO THOSE DETAILED. WHERE SPECIFIC DIMENSIONS, DETAILS OR DESIGN INTENT CAN NOT BE DETERMINED, CONSULT THE CONSTRUCTION MANAGER BEFORE PROCEEDING WITH THE WORK.
10. ALL WORK SHALL CONFORM TO THE BEST PRACTICE OF EACH TRADE, UNLESS SHOWN OR NOTED OTHERWISE. USE CONSTRUCTION DETAILS AND PRACTICES COMMON TO THE STANDARDS OF THE TRADES.
11. THE CONTRACTOR SHALL PROVIDE ALL THE NECESSARY BLOCKING, BACKING, FRAMING, HANGERS, OR OTHER SUPPORT FOR ALL ITEMS REQUIRING THE SAME.
12. ALL WORK SHALL CONFORM TO THE APPLICABLE CODES AND AUTHORITIES INCLUDING BUT NOT LIMITED TO UBC, NFPA, ADA AND OSHA.
13. THE CONTRACTOR SHALL OBTAIN ALL NECESSARY PERMITS REQUIRED FOR THE WORK SHOWN ON THE DRAWINGS. APPLICATIONS FOR SUCH PERMITS SHALL BE OBTAINED BEFORE STARTING WORK.
14. CONTRACTOR SHALL VERIFY AND MAINTAIN ALL THE REQUIRED CLEARANCES AROUND INSTALLED EQUIPMENT.
15. WHERE DISCREPANCIES EXIST BETWEEN THE DRAWINGS OF THE VARIOUS DISCIPLINES, THE ARCHITECTURAL DRAWINGS SHALL GENERALLY GOVERN. CONSULT THE CONSTRUCTION MANAGER TO VERIFY BEFORE PROCEEDING WITH THE WORK.
16. MANUFACTURERS SPECIFIED HEREIN MAY BE SUBSTITUTED ONLY WITH THE APPROVAL FROM CONSTRUCTION MANAGER.
17. SEE SPECIFICATIONS FOR DOOR, WINDOW, KITCHEN/RESTROOM EQUIPMENT AND FINISH SCHEDULES.

B. EGRESS AND SECURITY

1. ALL EGRESS MUST COMPLY WITH NFPA 101, LIFE SAFETY CODE, 1991 EDITION REQUIREMENTS.
2. REQUIRED EXIT DOORS SERVING AN OCCUPANT LOAD OF 50 OR MORE SHALL OPEN ONLY IN THE DIRECTION OF EXIT AND SHALL BE OPENABLE FROM THE INSIDE WITHOUT THE USE OF A KEY, OR SPECIAL KNOWLEDGE OR EFFORT. FLUSH BOLTS OR SURFACE BOLTS ON THESE DOORS ARE PROHIBITED.
3. PANIC HARDWARE SHALL BE PROVIDED ON EXIT DOORS SERVING ROOMS, CORRIDORS, OR STAIRWAYS HANDLING AN OCCUPANT CAPACITY OF 50 OR MORE PERSONS.
4. DOOR LOCATIONS NOT ESTABLISHED BY DIMENSION SHALL BE CENTERED IN WALL OR 6" FROM FINISH WALL.
5. AISLES LEADING TO EXITS SHALL BE 3'-8" MINIMUM CLEAR WIDTH. EXIT DOORWAYS SHALL NOT BE LESS THAN 3'-0" WIDE AND 8'-0" HIGH. PROJECTIONS SHALL NOT REDUCE THE CLEAR WIDTH OPENING TO LESS THAN 2'-8". DOORS SHALL NOT PROJECT MORE THAN 7" INTO THE REQUIRED CORRIDOR WIDTH.
6. LATCHED AND LOCKED DOORS THAT ARE HAND ACTIVATED AND WHICH ARE IN THE PATH OF TRAVEL, SHALL BE OPERABLE WITH A SINGLE EFFORT BY LEVER TYPE HARDWARE, PANIC BARS, PUSH/PULL ACTIVATING BARS OR OTHER HARDWARE DESIGNED FOR PASSAGE WITHOUT REQUIRING THE ABILITY TO GRASP THE OPENING HARDWARE. LOCKED EXIT DOORS SHALL OPERATE AS ABOVE IN THE EGRESS DIRECTION.

A. SWING DOORS

1. DOOR STOPS IN IN-SWINGING DOORS SHALL BE ONE-PIECE CONSTRUCTION WITH THE JAMB, OR JOINTED BY RABBIT TO THE JAMB.
2. REMOVABLE PIN-TYPE HINGES SHALL BE USED FOR ALL DOORS EXCEPT IN SECURED AREAS WHERE DOORS SHALL HAVE NON-REMOVABLE HINGE PINS. THEY SHALL HAVE MINIMUM 1/4" DIAMETER STEEL JAMB STUD WITH MINIMUM 1/4" PROJECTION UNLESS THE HINGES ARE SHAPED TO PREVENT REMOVAL OF THE DOOR IF THE HINGE PINS ARE REMOVED.
3. DEAD BOLTS SHALL CONTAIN HARDENED INSERT; DEADLOCKING LATCH KEY-OPERATED EXTERIOR LOCKS; LOCKS OPERABLE WITHOUT KEY, SPECIAL KNOWLEDGE OR SPECIAL EFFORT FROM INTERIOR.
4. STRAIGHT DEAD BOLTS SHALL HAVE A MINIMUM THROW OF 1" AND AN EMBOSMENT 5/8".
5. DEAD BOLTS SHALL HAVE A MINIMUM THROW OF 3/4".
6. WOOD FLUSH TYPE DOORS SHALL BE 1 3/4" THICK WITH SOLID CORE CONSTRUCTION.

B. CYLINDER GUARDS

1. CYLINDER GUARDS SHALL BE INSTALLED ON ALL CYLINDER LOCKS WHENEVER THE CYLINDER PROJECTS BEYOND THE FACE OF THE DOOR OR IS OTHERWISE ACCESSIBLE TO GRIPPING TOOLS.

C. DOORS

1. ALL LABELED DOORS SHALL HAVE A COMPLETE FIRE RATED HARDWARE ASSEMBLY.
2. ALL EXTERIOR DOORS SHALL LIMIT AIR LEAKAGE AROUND THEIR PERIMETER WHEN IN CLOSED POSITION.
  - A. PROVIDE SEAL AT HEAD, SILL AND JAMBS.
  - B. MEETING PORTIONS OF DOUBLE DOORS SHALL BE PROVIDED WITH A WEATHER-TIGHT ASTRAGAL OR SEAL.
3. INTERIOR AND EXTERIOR THRESHOLDS TO BE 1/2" MAXIMUM ABOVE THE ADJACENT FLOOR. EXPOSED EDGES SHALL BE LEVELED OR SLOPED TO MAXIMUM 45 DEGREES WITH 1/4" MAXIMUM CHANGE IN VERTICAL ELEVATION.
4. THE BOTTOM 10 INCHES OF ALL SWINGING DOORS SHALL HAVE A SMOOTH UNINTERRUPTED SURFACE TO ALLOW THE DOOR TO BE OPENED BY A WHEELCHAIR FOOTREST, UNLESS OTHERWISE NOTED.

D. PARTITIONS

1. WALL AND COLUMN GYPSUM BOARD FACING SHALL EXTEND TO UNDERSIDE OF STRUCTURE. FOR DETAILS SEE WALL TYPE SCHEDULES (LA-A-499).

E. AIR LEAKAGE

1. EXTERIOR JOINTS AROUND WINDOWS AND DOOR FRAMES, OPENINGS BETWEEN WALLS AND FOUNDATION, BETWEEN WALLS AND ROOF AND WALL PANELS, OPENINGS AT PENETRATIONS OF UTILITY SERVICES THROUGH WALLS, FLOORS AND ROOFS, AND ALL OTHER OPENINGS IN THE BUILDING ENVELOPE SHALL BE SEALED, CAULKED, GASKETED OR WEATHERSTRIPPED TO LIMIT AIR LEAKAGE.

F. INSULATED METAL PANEL

1. PROVIDE BACKING ANGLES AT THE INTERIOR SIDE OF ALL NON REINFORCED PANEL OPENINGS AS REQUIRED BY MANUFACTURER.

PROJECT PLANS

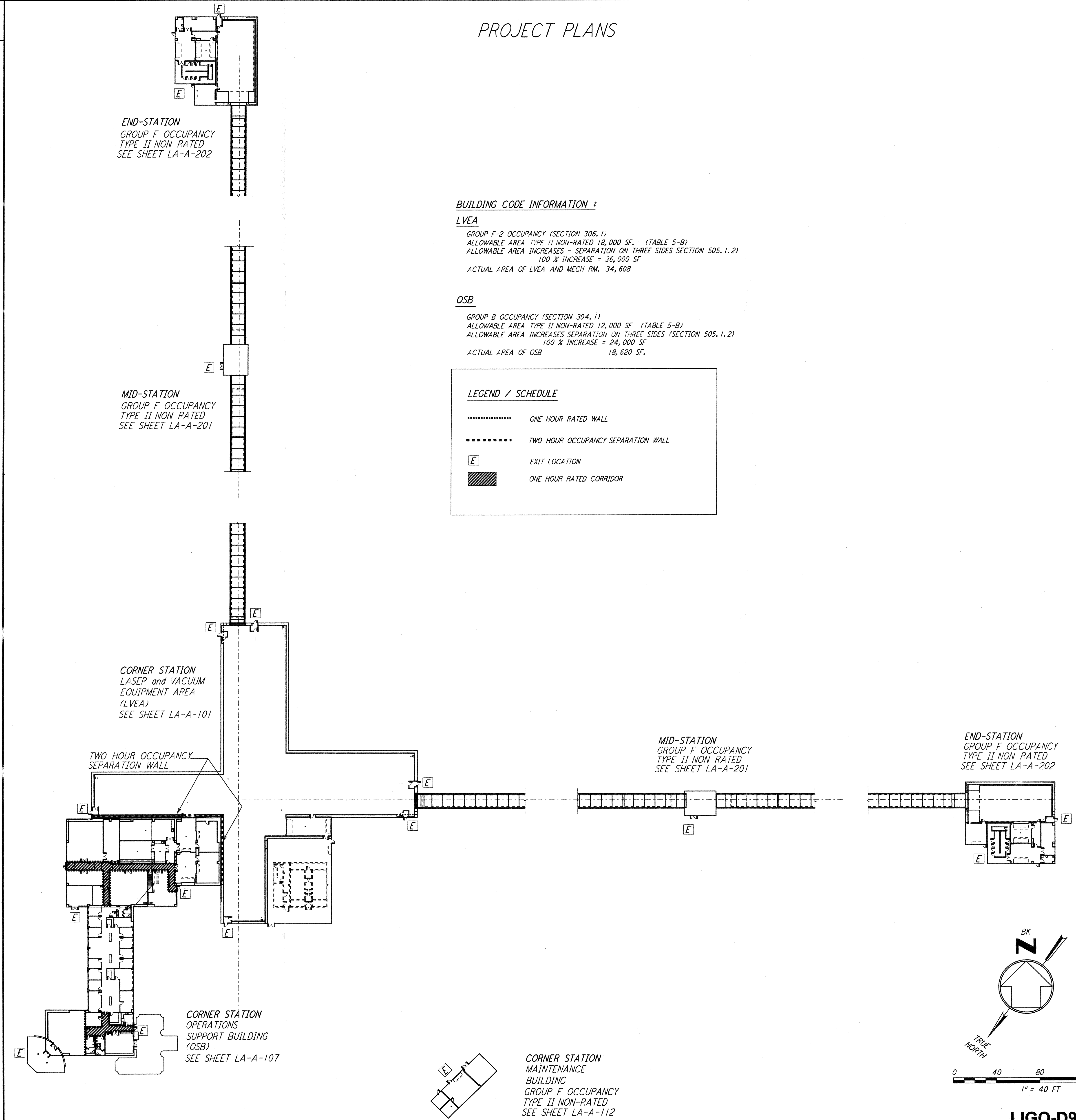

This document and the design it covers are the property of PARSONS. They are loaned only with the borrower's expressed written agreement that they will not be reproduced, copied, loaned, exhibited, or used in any other way, except by written consent from PARSONS to the borrower.

NO.	DATE	BY	CHKD	ENGR	PROJ	DESCRIPTION
1	08-07-98	SJM	CKT	RAK	TWD	ISSUED FOR AS-BUILT

ISSUED FOR CONSTRUCTION	CKT	11-15-96
DRAWN	TB	11-15-96
CHECKED	SF	11-15-96
ENGINEER	TDM	11-15-96
PROJ		

**AS-BUILT DRAWINGS**

**PARSONS**

100 WEST WALNUT STREET  
PASADENA, CALIFORNIA

**LIGO**

CALIFORNIA INSTITUTE OF TECHNOLOGY  
MASSACHUSETTS INSTITUTE OF TECHNOLOGY

**LIGO-D960866-01-0**

LASER INTERFEROMETER  
GRAVITATIONAL-WAVE OBSERVATORY  
SITE NO. 2 - LIVINGSTON, LOUISIANA

TITLE	SCALE	CONTRACT NUMBER	PROJECT NUMBER
ARCHITECTURAL GENERAL NOTES & LIFE SAFETY PLAN	AS NOTED	PP150969	8094
SHEET NUMBER	REVISIONS		
<b>LA-A-002</b>			