

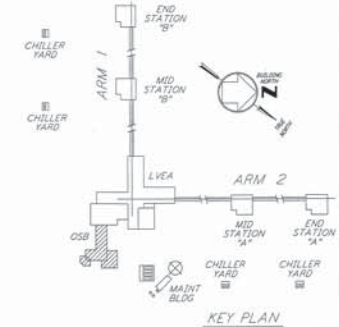

- NOTES:**
1. FOR PLAN SYMBOLS SEE DWG WA-E-002
 2. WIRING FOR FIRE DETECTION SHALL BE CLASS 'A', FOR FIRE ALARM DEVICES SHALL BE CLASS 'B'.
 3. DUCT MOUNTED SMOKE DETECTORS SHALL BE PROVIDED WITH AN AUXILIARY RELAY CONTACT (R.C.) FOR EQUIPMENT SHUT-DOWN.
 4. NOT USED.
 5. COORDINATE ARM LOCATIONS AND DUCT MOUNTED SMOKE DETECTORS.

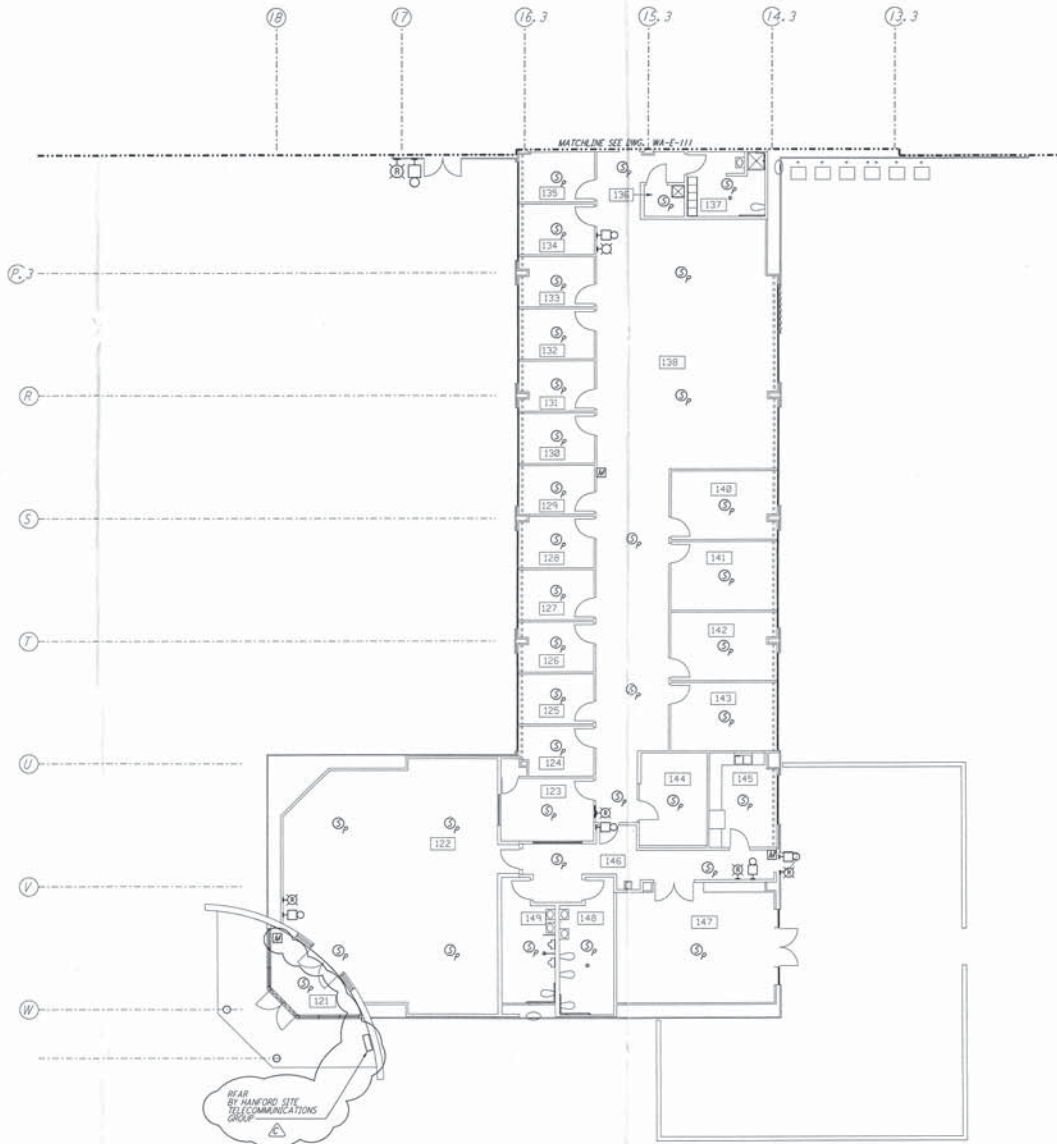

This document and the design it covers are the property of PARSONS. They are loaned only with the borrower's expressed written agreement that they will not be reproduced, copied, loaned, exhibited, or used in any other way, except by the written consent from PARSONS to the borrower.

NO.	DATE	BY	CHKD	ENGR	PROJ	DESCRIPTION
C	5-22-96	SAE	TA	TDM		BID ADDENDUM #2
B	4-19-96			TDM		FINAL DESIGN REVIEW & BID
A	10-31-95			TDM		PRELIMINARY DESIGN REVIEW

DRAWN	J.G.
CHECKED	
ENGINEER	
PROJ	

PARSONS
 100 WEST WALNUT STREET
 PASADENA, CALIFORNIA

LIGO
 CALIFORNIA INSTITUTE OF TECHNOLOGY
 MASSACHUSETTS INSTITUTE OF TECHNOLOGY

LASER INTERFEROMETER
 GRAVITATIONAL-WAVE OBSERVATORY
 SITE NO. 1 - HANFORD, WASHINGTON

ELECTRICAL
 CORNER STATION
 OFFICE AREA FIRE DET
 & SECURITY PLAN

AS NOTED PP150969 8094
WA-E-110